

B SIZE 11" x 17" (279mm x 432mm)

PLOT: 08/10/16 9:12:39 AM

UMA FILE NAME: D265-228-02_01-C-1007_RX.dwg Saved By: berardk

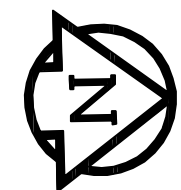
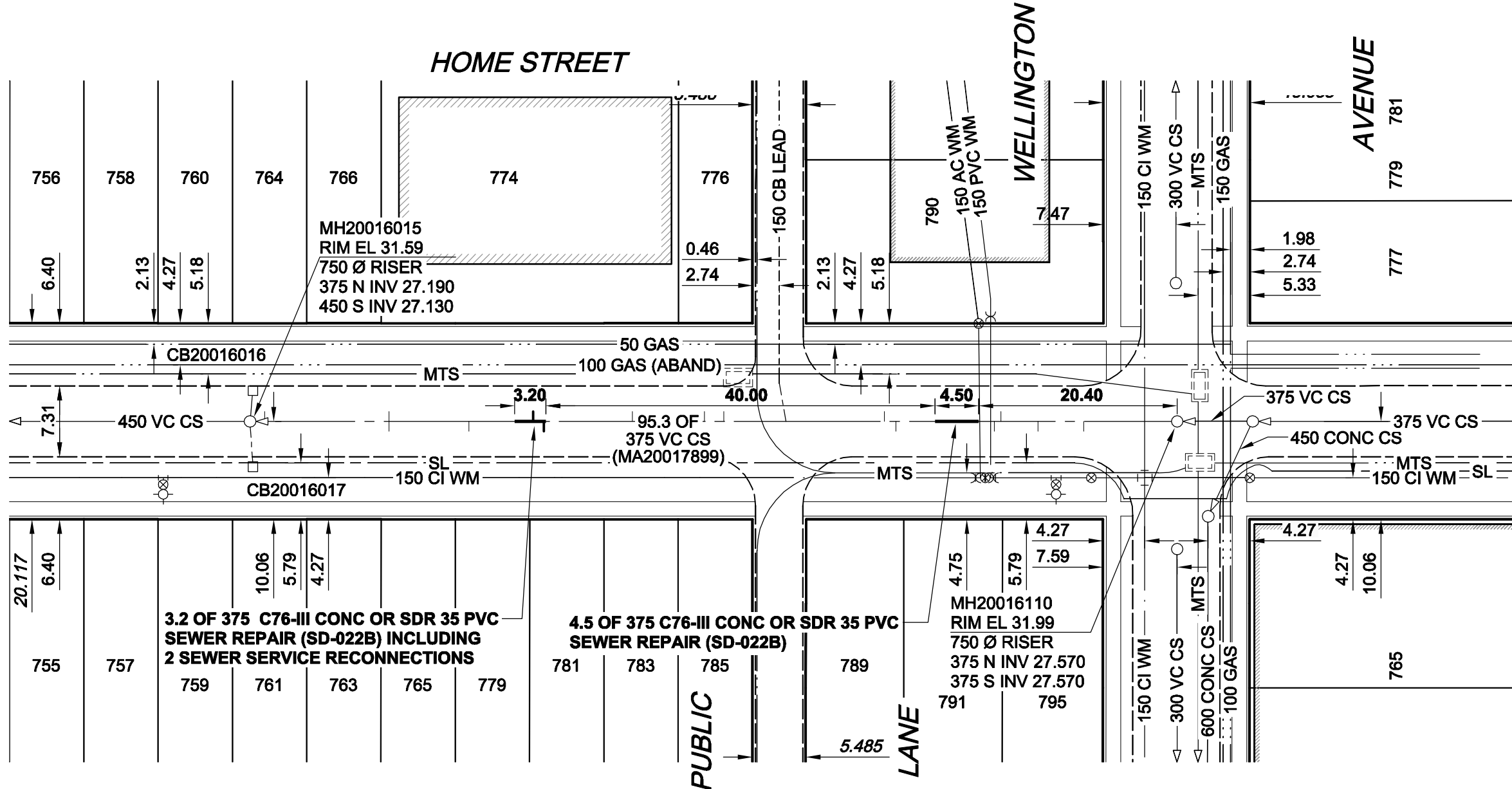

SEWER JUNCTION INFORMATION

REF. MH*	DIST FROM* REF. MH	SIZE*	CLOCK AT*
MH20016110	9.60	1500	11
MH20016110	14.30	1500	11
MH20016110	18.10	1500	02
MH20016110	18.80	1500	11
MH20016110	28.90	1500	11
MH20016110	30.10	1500	02
MH20016110	40.20	1500	02
MH20016110	46.60	1500	01
MH20016110	48.60	1500	02
MH20016110	50.60	1500	10
MH20016110	56.00	1500	02
MH20016110	65.10	1500	10
MH20016110	66.20	750	02
MH20016110	72.80	1500	11
MH20016110	81.00	1500	11
MH20016110	81.00	1500	01
MH20016110	93.80	1500	02

*JUNCTION INFORMATION FROM VIDEO INSPECTION

WARNING

IF POWER EQUIPMENT OR EXPLOSIVES ARE TO BE USED FOR EXCAVATION ON THIS PROJECT, THE CONTRACTOR MUST:
 1) NOTIFY THE GAS COMPANY OF THE PROPOSED LOCATION OF EXCAVATION.
 2) TAKE PRECAUTION TO AVOID DAMAGE TO GAS COMPANY INSTALLATIONS.
 SEE PROVINCIAL REGULATION 140/92 FOR DETAILS

METRIC
 WHOLE NUMBERS INDICATE MILLIMETRES
 DECIMALIZED NUMBERS INDICATE METRES

APEGM
 Certificate of Authorization
 UMA Engineering Ltd. (MB)
 No. 256 Date: 08/10/16

CONSTRUCTION NOTES:

1. ALL SEWER AND WATER SERVICES WITHIN THE REPAIR LIMITS TO BE LOCATED IN THE FIELD BY THE CONTRACTOR

BID OPPORTUNITY NO. 651-2008

LOCATION APPROVED UNDERGROUND STRUCTURES

SUPR. U/G STRUCTURES COMMITTEE	DATE

NOTE:
 LOCATION OF UNDERGROUND STRUCTURES AS SHOWN ARE BASED ON THE BEST INFORMATION AVAILABLE. BUT NO GUARANTEE IS GIVEN THAT ALL EXISTING UTILITIES ARE SHOWN OR THAT THE GIVEN LOCATIONS ARE EXACT. CONFIRMATION OF EXISTENCE AND EXACT LOCATION OF ALL SERVICES MUST BE OBTAINED FROM THE INDIVIDUAL UTILITIES BEFORE PROCEEDING WITH CONSTRUCTION.

BM 36-056 ELEV 231.946m	N.W. Cor. Wellington Ave. & Simcoe St., Tbt. in 13.5 m Conc. pile 2.3 m S. of N.L. of Wellington Ave. & 0.3 m W. of W.L. Simcoe Sr.		
0	ISSUED FOR CONSTRUCTION	08/10/14	KMB
NO.	REVISIONS	YY/MM/DD	BY

DESIGNED BY	ALD	CHECKED BY	FMI
DRAWN BY	KMB	APPROVED BY	BRYAN WEBER
HOR. SCALE	1:500	RELEASED FOR CONSTRUCTION	KZ
VERT. SCALE			
DATE	08/10/16	DATE	OCT 16/08

PROFESSIONAL'S SEAL
 ISSUED FOR CONSTRUCTION WAS SEALED BY
 A. NAGY AND DATED 08/10/16
 CONSULTANT DRAWING NO.
 D265-228-02_01-C-1007_RX.dwg

THE CITY OF WINNIPEG WATER AND WASTE DEPARTMENT

2008 COMBINED SEWER RENEWALS BY EXTERNAL POINT REPAIRS AND REPLACEMENTS CONTRACT 30

HOME STREET
 251m N OF SARGENT AVENUE TO WELLINGTON AVENUE

SHEET 7 OF 18
 CITY DRAWING NUMBER
8678 REV 0