

**STAGE 2 PROPOSED EXIT LANE**  
From Pembina Highway Northbound  
Control Line = Proposed Detour S Edge Lane

Control Point	Station	Coordinate		Parameter	Curve Data	
		Northing	Easting		C10	C11
BC	20+12.83	254.415	2020.846	R	2082.10	303.70
PCC	20+53.25	252.495	2061.611	Δ	1°07'23"	11°39'29"
PT	21+13.29	255.261	2123.236	Tan	20.41	31.00
PT	21+63.30	262.639	2173.199	L	40.81	61.79
PT	22+11.70	273.367	2220.633			

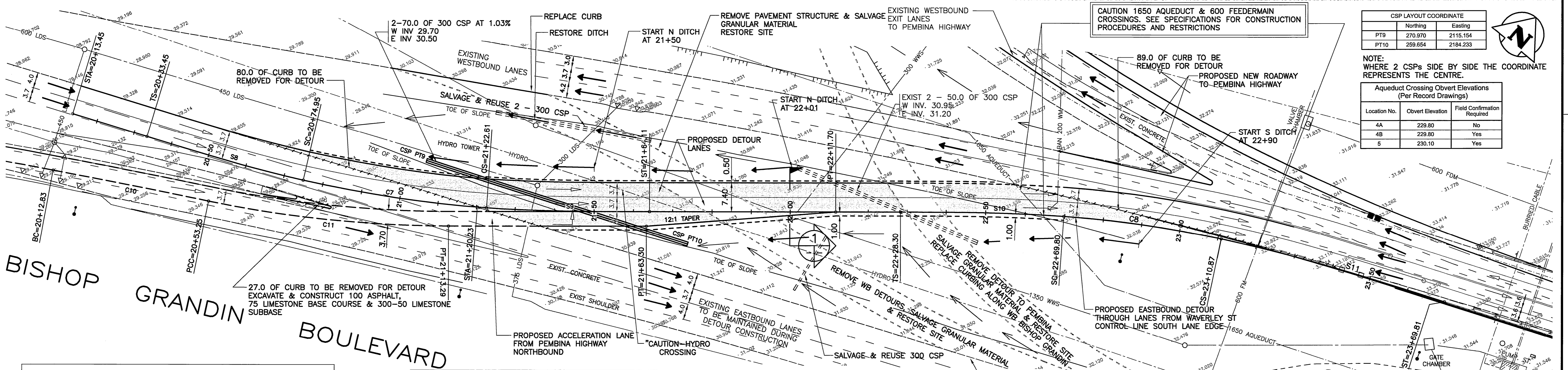

**CSP LAYOUT COORDINATE**

	Northing	Easting
PT9	270.970	2115.154
PT10	259.654	2184.233

**NOTE:** WHERE 2 CSPs SIDE BY SIDE THE COORDINATE REPRESENTS THE CENTRE.

**Aqueduct Crossing Obvert Elevations (Per Record Drawings)**

Location No.	Obvert Elevation	Field Confirmation Required
4A	229.80	No
4B	229.80	Yes
5	230.10	Yes

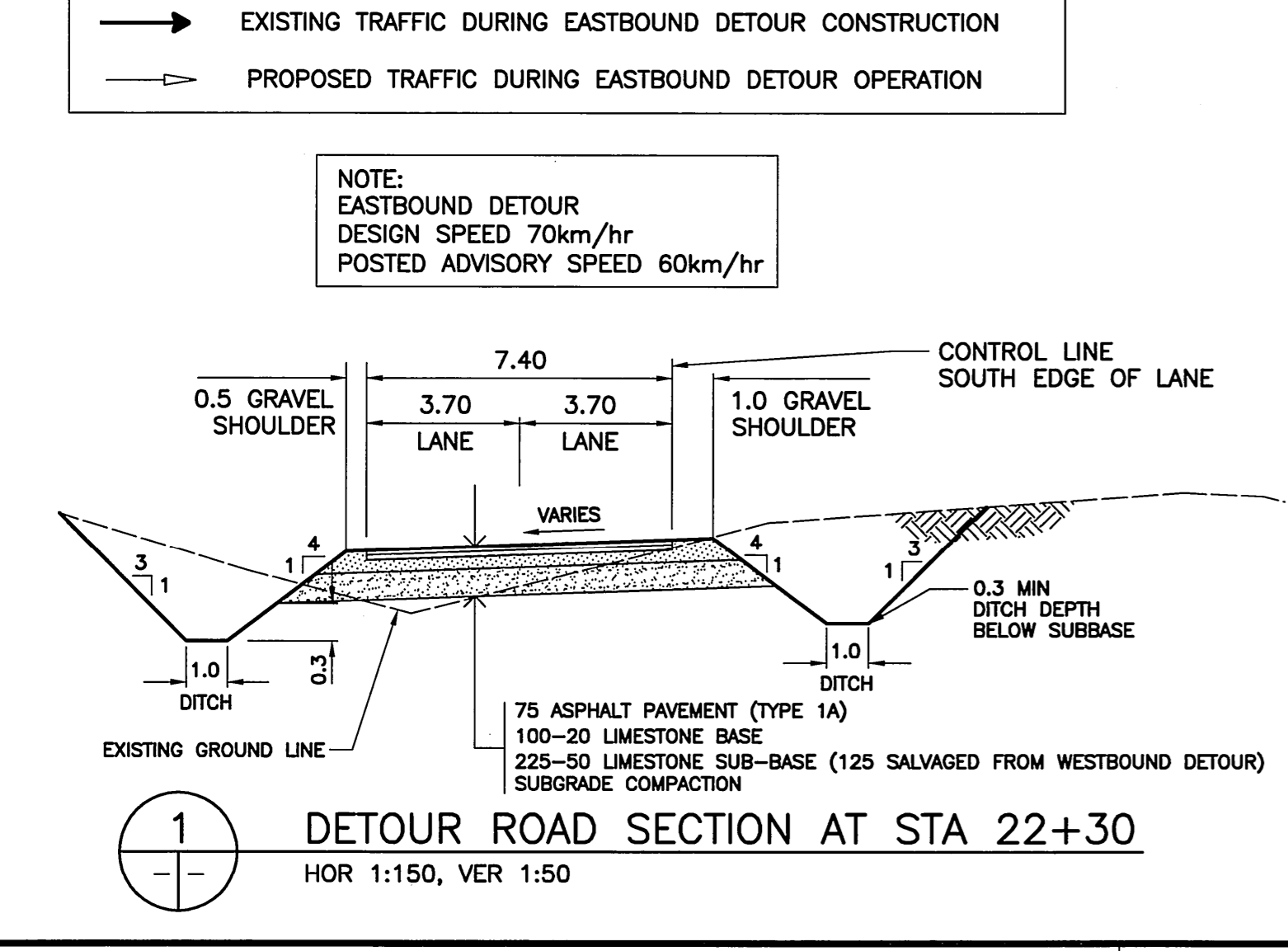

**PROPOSED EASTBOUND DETOUR**  
Aligned with Bishop Grandin Boulevard  
Detour Road Control Line = S Edge of Lane

Control Point	Station	Coordinate		Parameter	Curve Data	
		Northing	Easting		C7	C8
STA	20+13.45	269.478	2023.725	R	302.40	295.00
TS	20+33.45	266.524	2043.506	Δ	9°01'49"	7°58'38"
SC	20+74.95	261.336	2084.671	Tan	23.88	20.57
STA	21+20.23	261.120	2129.912	L	47.66	41.07
CS	21+22.61	261.296	2132.283	Spiral Data		
ST	21+64.11	266.417	2173.458	S8-S9	S10	S11
TS	22+28.30	275.794	2236.962	R	302.40	295.00
SC	22+69.80	280.891	2278.138	L	41.50	58.86
CS	23+10.87	281.163	2319.177	Theta	3°55'53"	4°01'48"
ST	23+69.81	273.547	2377.615	P	0.24	0.49
				K	20.75	29.47
				A	112.02	110.65

**Coordinate Control Survey Monuments**

No.	Wardrop Coordinate		NAD 83 Grid Coordinate		Description
	Northing	Easting	Northing	Easting	
CP1	200.457	2451.508	5520387.945	633474.139	GBM 76-026
CP2	143.191	2457.394	5520340.999	633507.459	BRASS CAP
CP3	324.616	2489.426	5520514.681	633446.010	BRASS CAP
CP6	289.245	2935.557	5520703.561	633851.730	BRASS CAP
CP7	300.000	3000.000	5520744.652	633902.628	IRON BAR
CP9	132.015	3114.711	5520654.917	634085.076	HCM

**NOTE:** CONTRACTOR TO PROVIDE CITY OF WINNIPEG 48 HOURS NOTICE PRIOR TO CROSSING OR WORKING IN VICINITY OF 1650 AQUEDUCT OR 600 FEEDERMAIN.

**APEGN**  
Certificate of Authorization  
**Wardrop Engineering Inc.**  
No. 195 Expiry: April 30, 2008

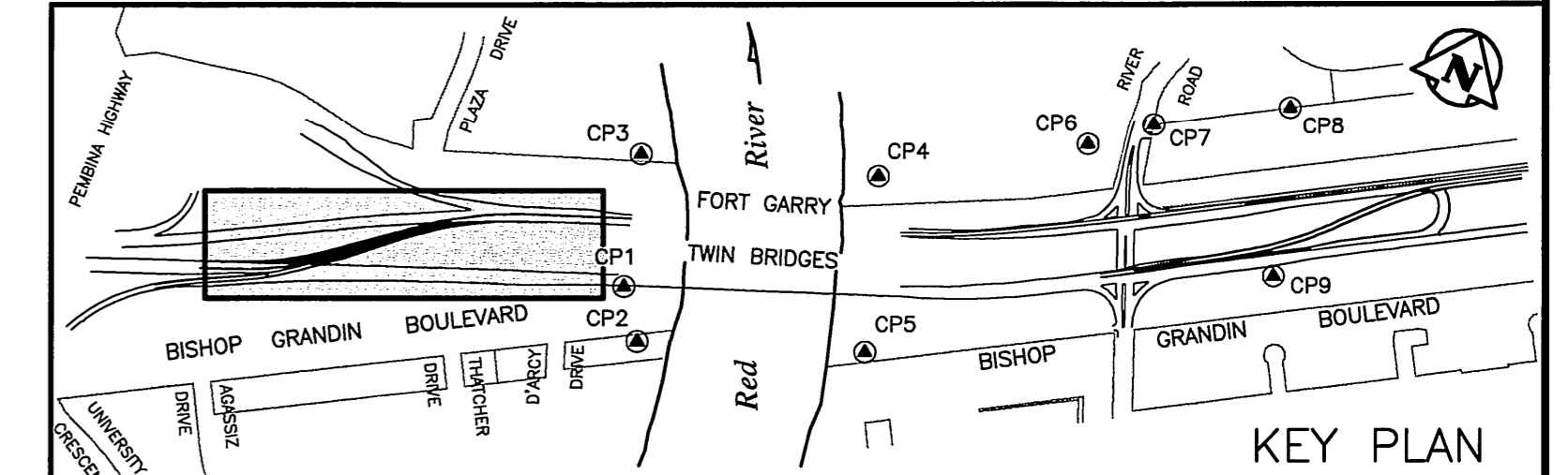

B.M. ELEV. F.B.

**WARDROP** Engineering Inc.

DESIGNED BY: DAL CHECKED BY: [Signature]  
DRAWN BY: NL APPROVED BY: [Signature]  
HOR. SCALE: 1:500  
VERTICAL: 1:20

00 ISSUED FOR TENDER 08.02.04  
NO. REVISIONS DATE

CONTRACTOR: RANDY FINKE, P. ENG. BRIDGES PROJECTS ENGINEER

**PROVINCE OF MANITOBA**  
W.J. FUNK  
REGISTERED ENGINEER

**THE CITY OF WINNIPEG**  
PUBLIC WORKS DEPARTMENT  
TRANSPORTATION ENGINEERING DIVISION

FORT GARRY BRIDGE REHABILITATION

EASTBOUND DETOUR LANES FOR 2009 OPERATIONS THROUGH LANES FROM WAVERLEY STREET CONSTRUCTION SEPT 1, 2008 TO NOV 1, 2008

CITY DRAWING NUMBER: B173-08-052W  
SHEET OF: 52 54  
C0009