

**PAVEMENT RECONSTRUCTION PLAN**

**CONSTRUCTION NOTES**

1. CONSTRUCT NEW 200mm REINFORCED CONCRETE PAVEMENT. SEE SD-217
2. CONSTRUCT NEW ASPHALT COLDMIX PAVEMENT PATCH. SEE DETAIL A ON SHEET 9
3. CONSTRUCT NEW 100mm PLAIN CONCRETE SIDEWALK
4. CONSTRUCT NEW 180mm HT PINNED CONCRETE BARRIER CURB. SEE SD-205
5. REINSTALL BALANCED ALUMINUM BARRIER.
6. SAWCUT EXISTING ASPHALT. EXISTING ASPHALT EDGE TO BE PRESERVED AFTER REMOVAL. REPAIR TO ORIGINAL OR BETTER CONDITION IF DAMAGED. SEE DETAIL ON SHEET 9.
7. GRADE AS SHOWN C/W 75mm TOPSOIL AND SEED
8. INSTALL NEW 800mm C75 CL IV CONCRETE PIPE. INVERTS TO MATCH EXISTING. CONNECTIONS TO BE GROUTED INSIDE AND OUT. ALL WORKS TO CONFORM TO CW 2130-R11.
9. INSTALL NEW 100mm INSULATION TYPE SM AND 100mm FOAM BOARD ABOVE NEW 600 CONCRETE SEWER PIPE AND EXISTING 600 FEEDERMAIN. SEE DETAIL 'B' ON SHEET 6.
10. INSTALL NEW CHAIN LINK FENCE. SEE DETAILS ON SHEET 4
11. PROVIDE PROTECTION AND SHORING FOR EXISTING HYDRO POLE WITHIN EXCAVATION LIMITS NEAR WEST END OF SOUTH BARRIER.

**METRIC**  
WHOLE NUMBERS INDICATE MILLIMETRES  
DECIMALIZED NUMBERS INDICATE METRES

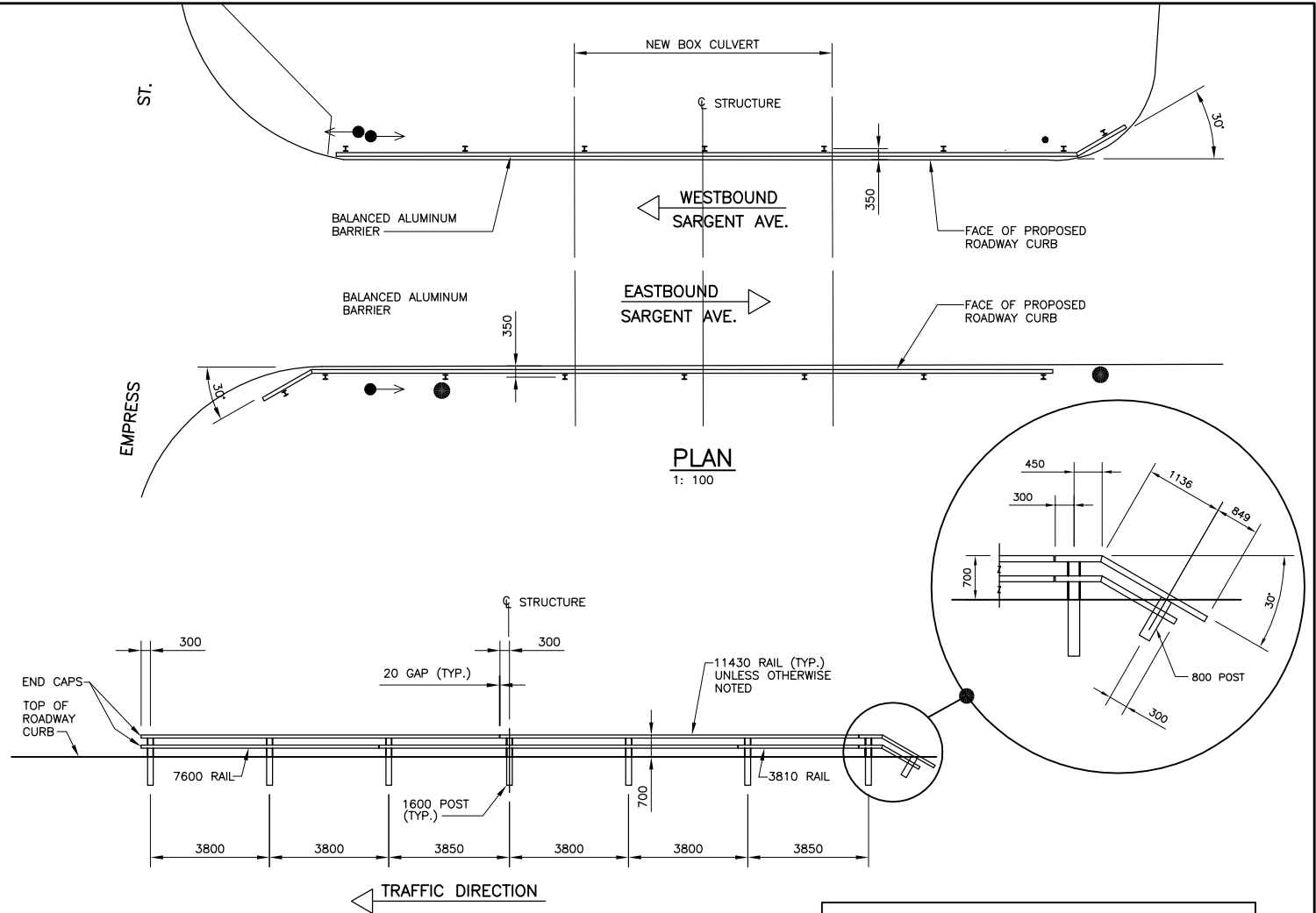

**WESTBOUND BALANCED ALUMINUM BARRIER ELEVATION**  
1: 100 (EASTBOUND OPPOSITE HAND)

**NOTE:**  
FOR BALANCED ALUMINUM BARRIER STANDARD DETAILS SEE SHEET NO. C316-08-10.

**BALANCED ALUMINUM BARRIER**  
QUANTITIES TO BE SALVAGED FROM WESTBOUND (EASTBOUND IS SIMILAR.)

ITEM	QUANTITY
13-13 x 25mm LONG STAINLESS STEEL HEX HEAD CAP SCREW	80
27 O.D. x 14mm I.D. x 2mm THICK STAINLESS STEEL WASHER	80
RAIL CLAMP BAR	32
SPLICE BAR	4
BARRIER POST 1600 mm	7
BARRIER POST 800 mm	1
RAIL END CAPS	2
BARRIER RAIL 11430 mm	4
BARRIER RAIL END SECTION	1

**NOTE:**  
QUANTITIES SHOWN ARE AVAILABLE FROM EXISTING SITE. REPLACE EXISTING DAMAGED COMPONENTS IF REQUIRED. REPLACEMENT ITEMS TO BE SUPPLIED BY CITY OF WINNIPEG AND TO BE INSTALLED BY CONTRACTOR.

UNDERGROUND STRUCTURES		B.M. ELEV.	DESIGNED BY
SUPV. U/G STRUCTURES COMMITTEE	DATE		DRAWN BY
			CHECKED BY
			APPROVED BY
NOTE: LOCATION OF UNDERGROUND STRUCTURES AS SHOWN ARE BASED ON THE BEST INFORMATION AVAILABLE. BUT NO GUARANTEE IS GIVEN THAT ALL EXISTING UTILITIES ARE SHOWN OR THAT THE GIVEN LOCATIONS ARE EXACT. CONFIRMATION OF EXISTENCE AND EXACT LOCATION OF ALL SERVICES MUST BE OBTAINED FROM THE INDIVIDUAL UTILITIES BEFORE PROCEEDING WITH CONSTRUCTION.		2 ISSUED FOR TENDER	12/08/08 N.B.G.
		1 ISSUED FOR CITY REVIEW	11/21/08 N.B.G.
NO. REVISIONS	DATE	BY	DATE
			NOV. 21, 2008

**DILLON CONSULTING**

RELEASED FOR CONSTRUCTION  
ORIGINAL SIGNED BY B.A. NEIRINCK  
DATE DECEMBER 10, 2008

ENGINEER'S SEAL  
PROVINCE OF MANITOBA  
REGISTERED PROFESSIONAL ENGINEER  
**J.S. BETKE**  
DEC. 10, 2008  
Member 22412

CONSULTANT PROJECT NO.  
**04-3330-2000**

**THE CITY OF WINNIPEG**  
PUBLIC WORKS DEPARTMENT

**OMAND'S CREEK CULVERT THROUGH SARGENT AVENUE**

ROADWAY RECONSTRUCTION AND EMBANKMENT PLAN  
BALANCED ALUMINUM BARRIER LAYOUT

CITY DRAWING NUMBER  
**C316-08-08**  
SHEET 8 OF 10

BID OPPORTUNITY  
**859-2008**