

- CONSTRUCTION NOTES FOR ROADWAY:**
- STATIONING IN SOUTH GUTTER OF BISHOP GRANDIN BLVD. UNLESS NOTED OTHERWISE.
 - STATIONING CONTINUES FROM 2007 REHABILITATION, SEE P-3284.
 - SEE P-3300-22 FOR TYPICAL CROSS SECTIONS AND DETAILS.
 - FINAL CURB HEIGHT TYPICALLY 75-100 mm. CURB TO BE REPLACED AS DIRECTED BY CONTRACT ADMINISTRATOR IF FINAL REVEAL IS LESS THAN 75 mm.
 - ALL DIMENSIONS ARE TO BACK OF CURB.
 - ADJUST OR REPLACE EXISTING DRAINAGE INLETS WITH NEW SD-024 OR SD-023 AS DIRECTED BY THE CONTRACT ADMINISTRATOR.
 - ISOLATE MISCELLANEOUS ITEMS IN NEW CONCRETE WORKS AS PER SD-228C.
 - PLANE HEADERS AT ALL INTERSECTING PUBLIC STREETS.
 - LEGAL PLAN AND UNDERGROUND INFORMATION FROM CITY OF WINNIPEG LBIS.
 - TRAFFIC SIGNAL POLES, CONTROLLERS AND UNDERGROUND APPURTENANCES IN PROJECT AREA TO BE UPGRADED BY OTHERS.
 - CONTRACTOR TO TAKE PRECAUTIONARY STEPS TO AVOID DAMAGE FROM CONSTRUCTION ACTIVITIES TO TREES WITHIN THE LIMITS OF CONSTRUCTION.
 - LOCATION OF EXISTING SERVICES TO BE CONFIRMED IN THE FIELD BY THE CONTRACTOR.
 - PLANE EXISTING ASPHALT OVERLAY WITHIN CONTRACT LIMITS TO DEPTH INDICATED BY THE CONTRACT ADMINISTRATOR.
 - LIMITS OF CURB AND GUTTER REPLACEMENT, JOINT AND SLAB REPAIRS, GRANULAR SHOULDER REGRADING, AND TIE INS TO BE FINALIZED IN THE FIELD BY THE CONTRACT ADMINISTRATOR.

METRIC

WHOLE NUMBERS INDICATE MILLIMETRES
DECIMALIZED NUMBERS INDICATE METRES

WARNING

IF POWER EQUIPMENT OR EXPLOSIVES ARE TO BE USED FOR EXCAVATION ON THIS PROJECT THE CONTRACTOR MUST:

- NOTIFY THE GAS COMPANY OF THE PROPOSED LOCATION OF EXCAVATION.
- TAKE PRECAUTION TO AVOID DAMAGE TO GAS COMPANY INSTALLATIONS SEE PROVINCIAL REGULATION 210/72 FOR DETAILS.

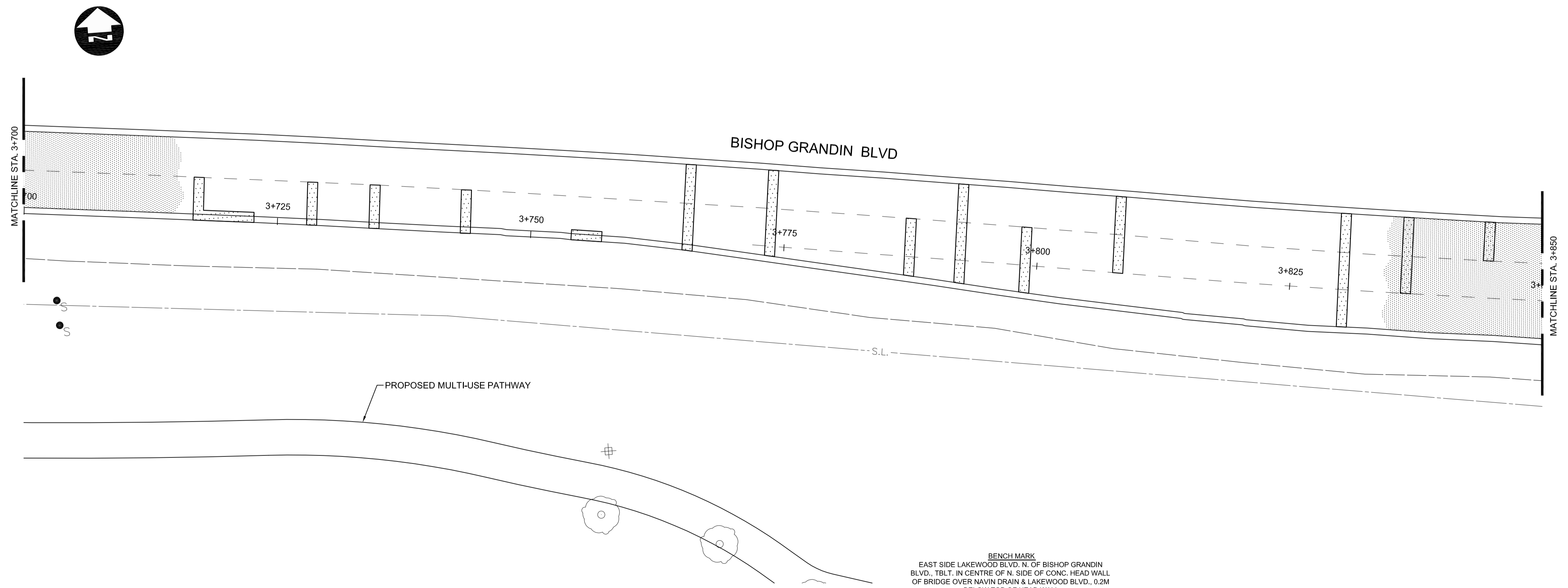

G:\CAD\081175\Contract\Roadway\081175-BISHOP-PAVEMENT1.dwg

150 WM	WATERMAIN	150 WM	HYDRO	HYDRO	HYDRO	150 mm W.M.	WATERMAIN	150 mm W.M.
⊕	HYDRANT	⊕	MTS	MTS	MTS	+	HYDRANT	+
⊗	VALVE	⊗				×	VALVE	×
300 LDS	LAND DRAINAGE SEWER	300 LDS				300 mm L.D.S.	LAND DRAINAGE SEWER	300 mm L.D.S.
250 WWS	WASTE WATER SEWER	250 WWS				250 mm W.W.S.	WASTE WATER SEWER	250 mm W.W.S.
○	MANHOLE	●				— · — · —	MANHOLE	— · — · —
□	CATCH BASIN	■				— — — — —	CATCH BASIN	— — — — —
▽	CURB INLET	▽				— — — — —	CURB INLET	— — — — —
+	JUNCTIONS	+				— · — · —	JUNCTIONS	— · — · —
— · — · —	CULVERT	— · — · —				— · — · —	CULVERT	— · — · —
100 GAS	GAS	100 GAS				— · — · —	GAS	— · — · —
EXISTING	LEGEND-PLAN	PROPOSED	EXISTING	LEGEND-PLAN	PROPOSED	EXISTING	LEGEND-PROFILE	PROPOSED

UNDERGROUND STRUCTURES

SUPPLY, U/G STRUCTURES COMMITTEE DATE

NOTE:
LOCATION OF UNDERGROUND STRUCTURES AS SHOWN ARE BASED ON THE BEST INFORMATION AVAILABLE, BUT NO GUARANTEE IS GIVEN THAT ALL EXISTING UTILITIES ARE SHOWN OR THAT THE GIVEN LOCATIONS ARE EXACT. CONFIRMATION OF EXISTENCE AND EXACT LOCATION OF ALL SERVICES MUST BE OBTAINED FROM THE INDIVIDUAL UTILITIES BEFORE PROCEEDING WITH CONSTRUCTION.

B.M. ELEV.				
DESIGNED BY	SPC			
DRAWN BY	TJH			
CHECKED BY	DBW			
APPROVED BY	DPK			
HOR. SCALE	1:250			
VERTICAL	1:10			
RELEASSED FOR CONSTRUCTION				
DATE				

3	ISSUED FOR TENDER	04-29-09	TJH
2	ISSUED FOR REVIEW	03-20-09	TJH
1	ISSUED FOR 50% REVIEW	03-05-09	TJH
NO.	REVISIONS	DATE	BY

DESIGNED BY: SPC
DRAWN BY: TJH
CHECKED BY: DBW
APPROVED BY: DPK

HOR. SCALE: 1:250
VERTICAL: 1:10

RELEASED FOR CONSTRUCTION

DATE

DILLON CONSULTING

ENGINEER'S SEAL
PROVINCE OF MANITOBA
REGISTERED PROFESSIONAL ENGINEER
D.B. WIEBE
04/29/09
Member 22480

CONSULTANT PROJECT NUMBER
08-1175

THE CITY OF WINNIPEG
PUBLIC WORKS DEPARTMENT

BISHOP GRANDIN BLVD - EASTBOUND
LAKEWOOD TO LAGIMODIERE

PAVEMENT REHABILITATION - STA. 3+700 TO STA. 3+850

CITY DRAWING NUMBER: P-3300-11
SHEET 11 OF 27
CONSULTANT DRAWING NUMBER: -

APEGM
Certificate of Authorization
Dillon Consulting Limited (MB)
No. 1789 Date: _____