



- CONSTRUCTION NOTES FOR PATHWAY:**
1. STATIONING ON SOUTH EDGE OF PROPOSED PATHWAY.
 2. STATIONING 1+000 AT ISLAND SHORE BOULEVARD GUTTER.
 3. SEE P-3300-22 FOR TYPICAL CROSS SECTIONS AND DETAILS.
 4. LEGAL PLAN AND UNDERGROUND INFORMATION FROM CITY OF WINNIPEG LBIS.
 5. CONTRACTOR TO TAKE PRECAUTIONARY STEPS TO AVOID DAMAGE FROM CONSTRUCTION ACTIVITIES TO TREES WITHIN THE LIMITS OF CONSTRUCTION.
 6. LOCATION OF EXISTING SERVICES TO BE CONFIRMED IN THE FIELD BY THE CONTRACTOR.
 7. LIMITS OF PATHWAY, DITCH, AND BOULEVARD WORK TO BE FINALIZED IN THE FIELD BY THE CONTRACT ADMINISTRATOR.
 8. PATHWAY MAX CROSS SLOPE OF 2% AND MAX LONGITUDINAL SLOPE OF 5%.
 9. SEED DITCH AND SOD BERM AFTER FINAL GRADING AND TOPSOIL COMPLETE.

METRIC

WHOLE NUMBERS INDICATE MILLIMETRES
DECIMALIZED NUMBERS INDICATE METRES

WARNING

IF POWER EQUIPMENT OR EXPLOSIVES ARE TO BE USED FOR EXCAVATION ON THIS PROJECT THE CONTRACTOR MUST:

1. NOTIFY THE GAS COMPANY OF THE PROPOSED LOCATION OF EXCAVATION.
2. TAKE PRECAUTION TO AVOID DAMAGE TO GAS COMPANY INSTALLATIONS SEE PROVINCIAL REGULATION 210/72 FOR DETAILS.

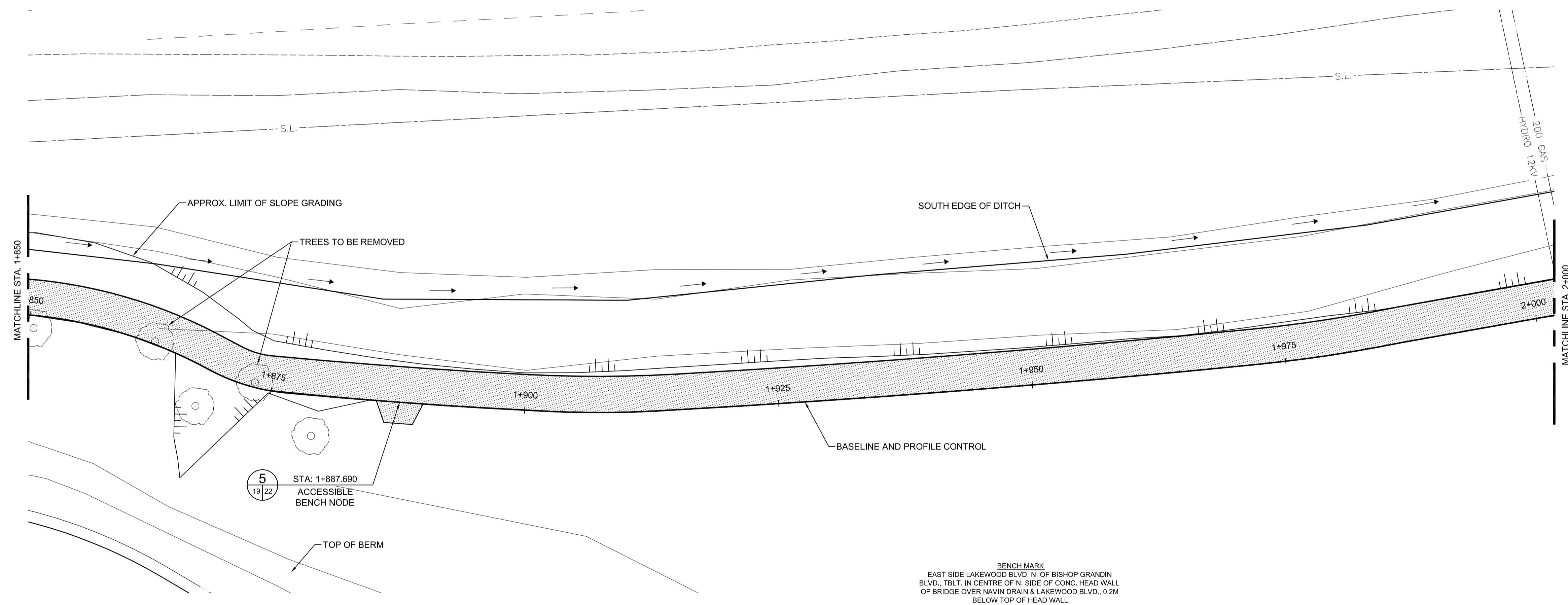

APEGM
Certificate of Authorization
Dillon Consulting Limited (MB)
No. 1789 Date: _____

150 WM	WATERMAIN	150 WM	HYDRO	HYDRO	HYDRO	150 mm W.M.	WATERMAIN	150 mm W.M.
⊕	HYDRANT	⊕	MTS	MTS	+	+	HYDRANT	+
⊗	VALVE	⊗			⊗	⊗	VALVE	⊗
300 LDS	LAND DRAINAGE SEWER	300 LDS			300 mm L.D.S.	300 mm L.D.S.	LAND DRAINAGE SEWER	300 mm L.D.S.
250 WWS	WASTE WATER SEWER	250 WWS			250 mm W.W.S.	250 mm W.W.S.	WASTE WATER SEWER	250 mm W.W.S.
○	MANHOLE	●			---	---	MANHOLE	---
□	CATCH BASIN	■			▨	▨	CATCH BASIN	▨
▽	CURB INLET	▽			---	---	CURB INLET	---
+	JUNCTIONS	+			---	---	JUNCTIONS	---
⊕	CULVERT	⊕			---	---	CULVERT	---
100 GAS	GAS	100 GAS			---	---	GAS	---
---	EXISTING	---	---	---	---	---	LEGEND-PLAN	---
---	LEGEND-PLAN	---	---	---	---	---	PROPOSED	---
---	EXISTING	---	---	---	---	---	LEGEND-PROFILE	---
---	LEGEND-PROFILE	---	---	---	---	---	PROPOSED	---

UNDERGROUND STRUCTURES

SUPPLY, U/G STRUCTURES COMMITTEE DATE

NOTE:
LOCATION OF UNDERGROUND STRUCTURES AS SHOWN ARE BASED ON THE BEST INFORMATION AVAILABLE, BUT NO GUARANTEE IS GIVEN THAT ALL EXISTING UTILITIES ARE SHOWN OR THAT THE GIVEN LOCATIONS ARE EXACT. CONFIRMATION OF EXISTENCE AND EXACT LOCATION OF ALL SERVICES MUST BE OBTAINED FROM THE INDIVIDUAL UTILITIES BEFORE PROCEEDING WITH CONSTRUCTION.

B.M. ELEV.			
DESIGNED BY	SPC		
DRAWN BY	TJH		
CHECKED BY	DBW		
APPROVED BY	DPK		
HOR. SCALE	1:250		
VERTICAL	1:25		
RELEASED FOR CONSTRUCTION			
DATE			

3	ISSUED FOR TENDER	04-29-09	TJH
2	ISSUED FOR REVIEW	03-20-09	TJH
1	ISSUED FOR 50% REVIEW	03-05-09	TJH
NO.	REVISIONS	DATE	BY

ENGINEER'S SEAL
PROVINCE OF MANITOBA
REGISTERED PROFESSIONAL ENGINEER
D.B. WIEBE
04/29/09
Member 22480
CONSULTANT PROJECT NUMBER
08-1175

THE CITY OF WINNIPEG
PUBLIC WORKS DEPARTMENT

BISHOP GRANDIN BLVD - EASTBOUND
LAKEWOOD TO LAGIMODIERE

CITY DRAWING NUMBER
P-3300-19
SHEET 19 OF 27
CONSULTANT DRAWING NUMBER
-

MULTI-USE PATHWAY CONSTRUCTION
STA. 1+850 TO STA. 2+000

G:\CAD\081175\Contract\Current\Roadway\081175-BSHOP-FATHWAY.dwg