

Westbound Corydon, F/S Edgeland
Stop 60458 Edgeland

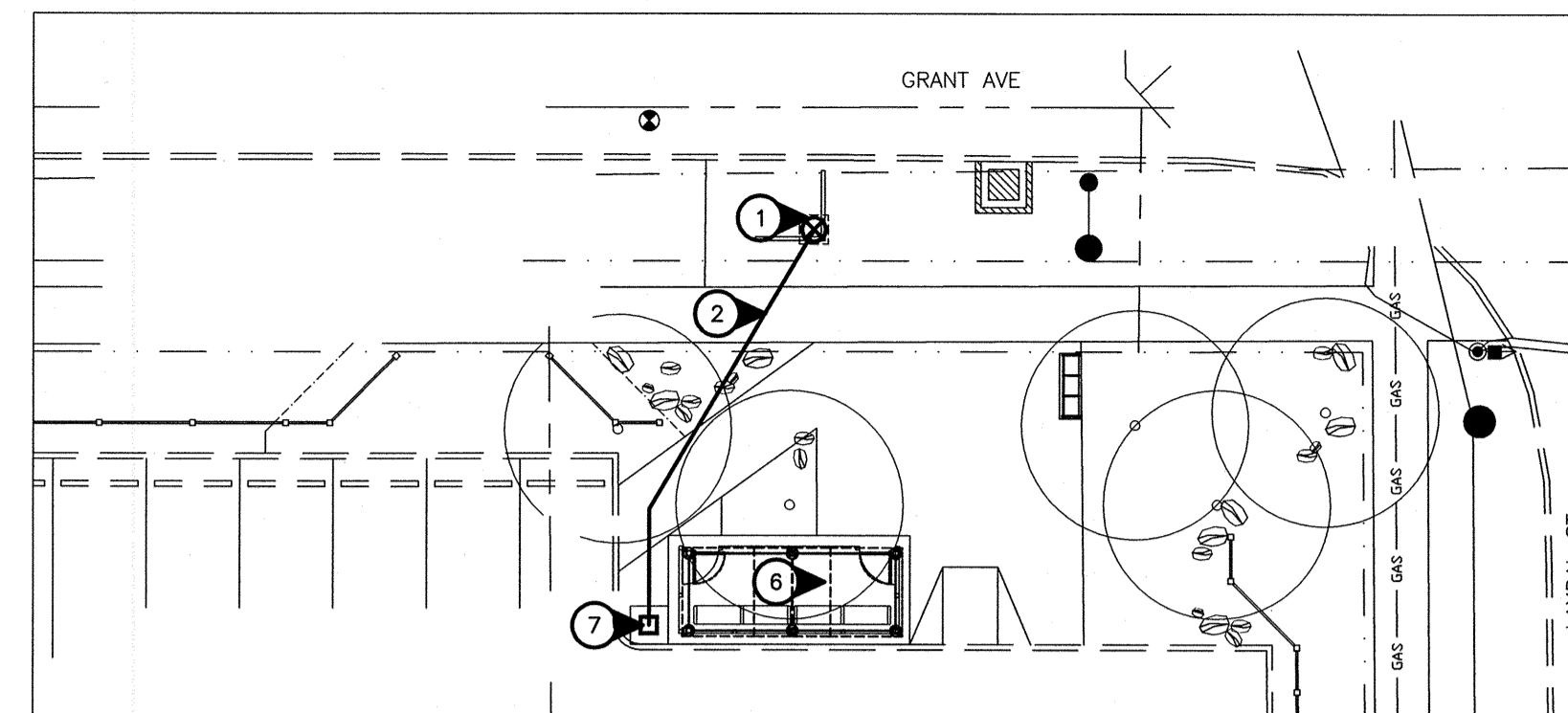

Eastbound Grant, N/S Laxdal
Stop 60532 Laxdal

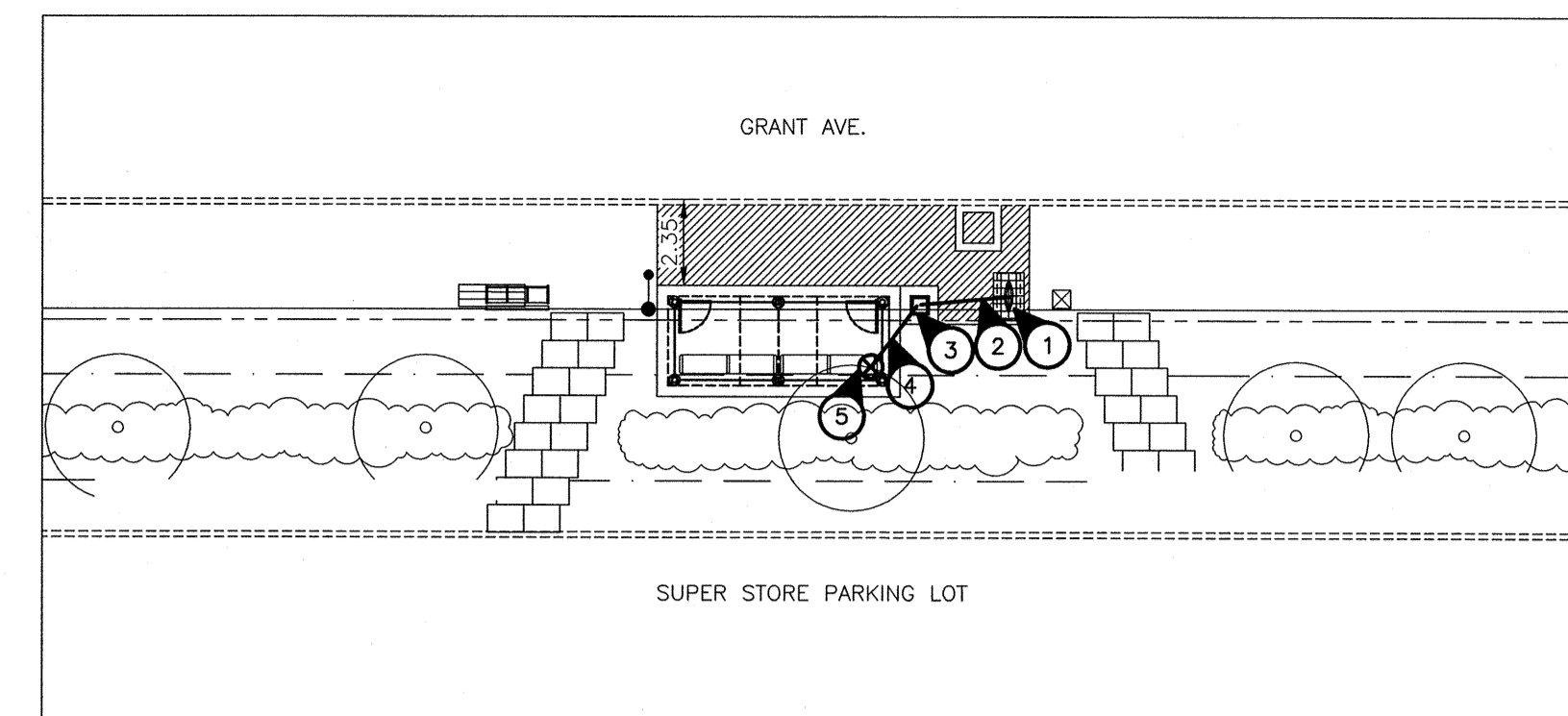
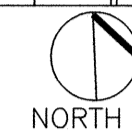

Eastbound Grant, F/S Kenaston
Stop 60408 Kenaston

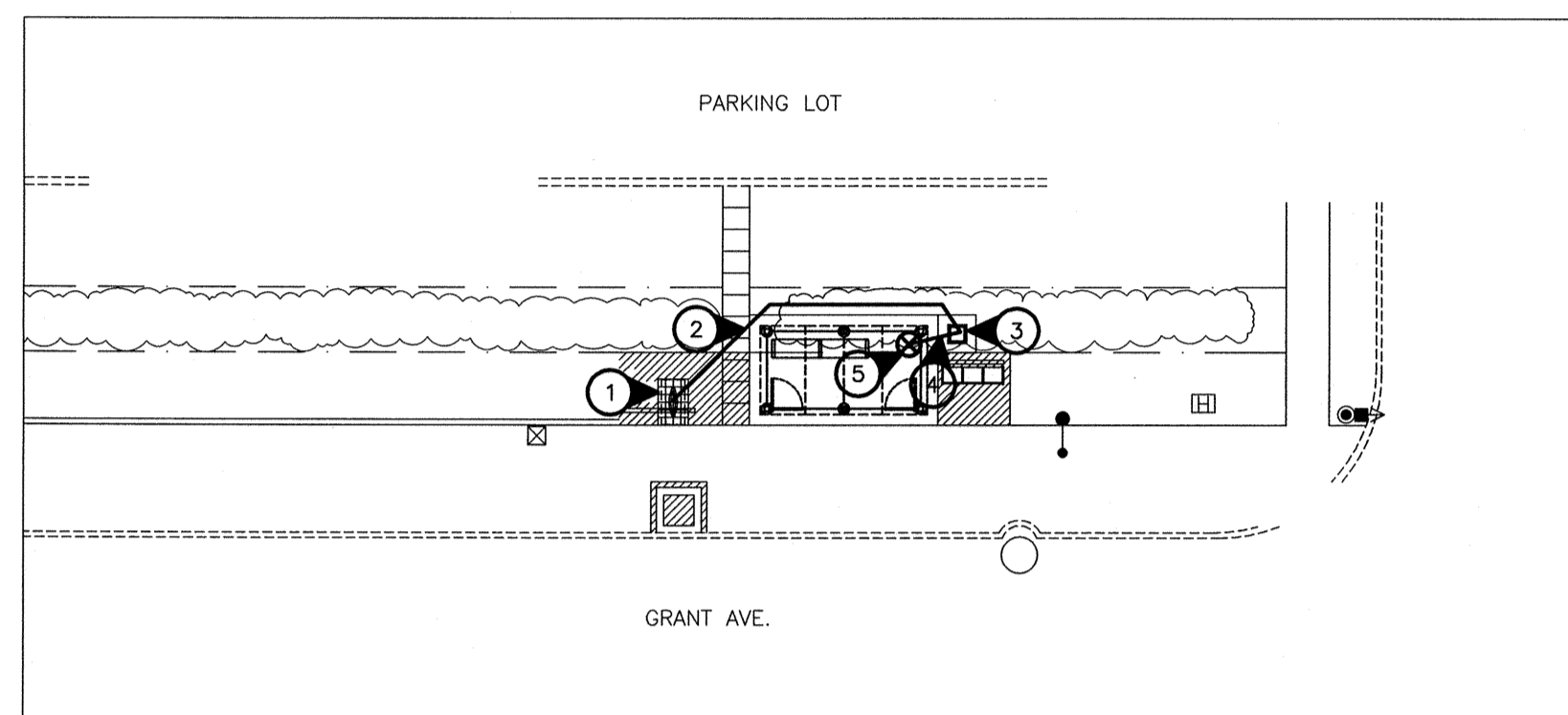
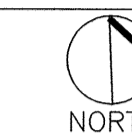

Westbound Grant, N/S Kenaston
Stop 60426 Kenaston East

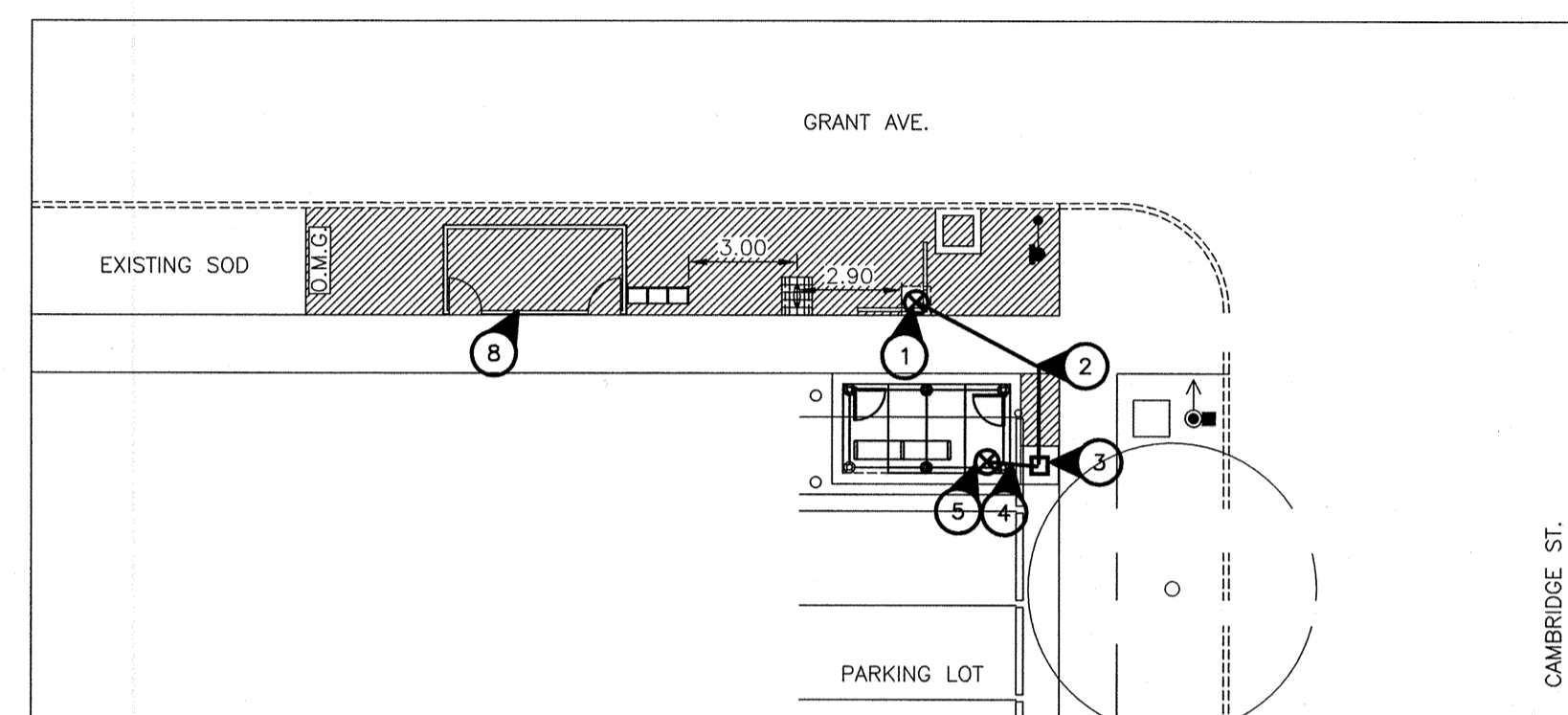

Eastbound Grant, N/S Cambridge
Stop 60290 Cambridge

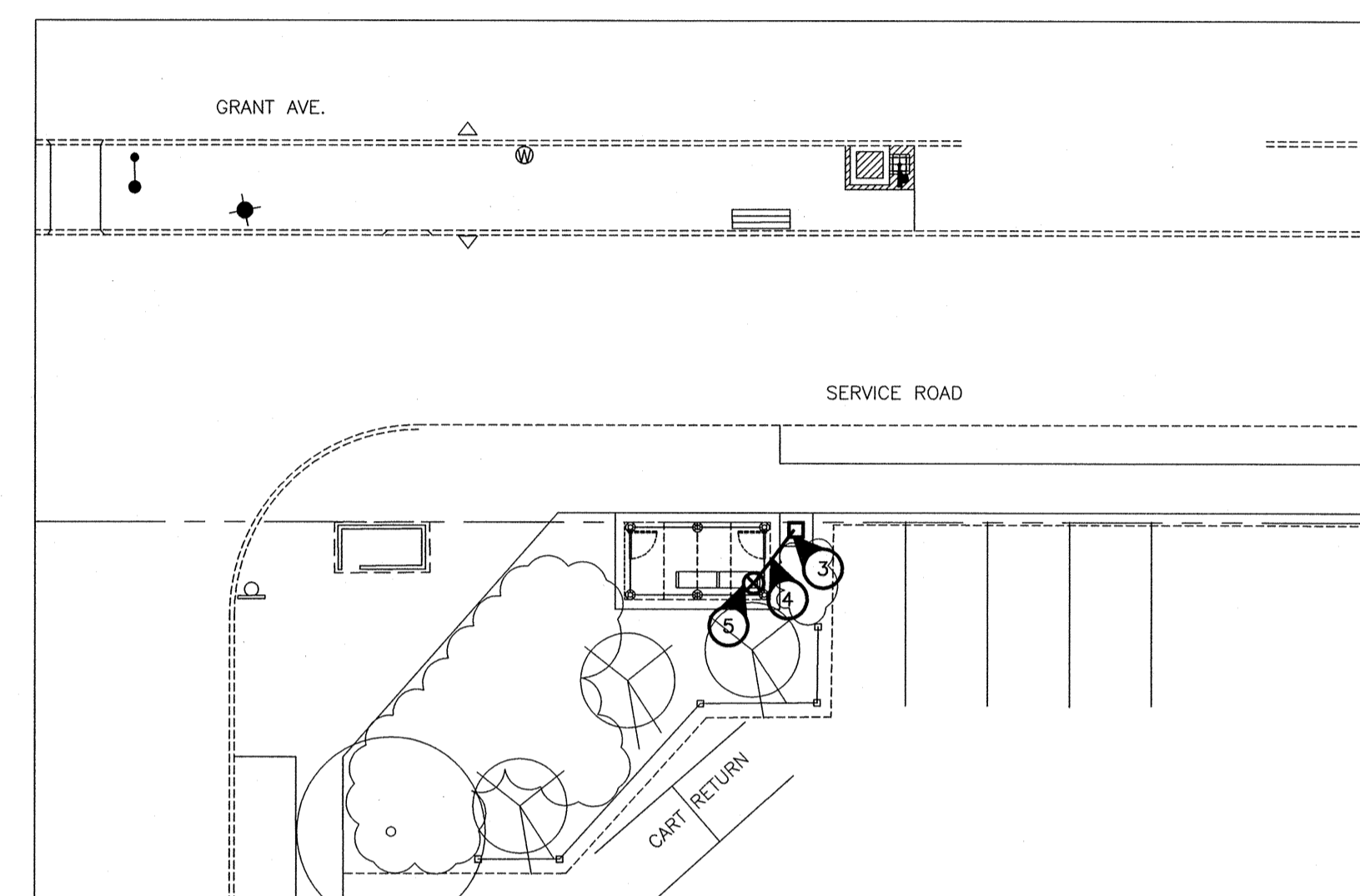
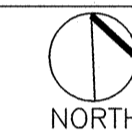

Eastbound Grant, F/S Opp Thurso
Stop 60292 Thurso

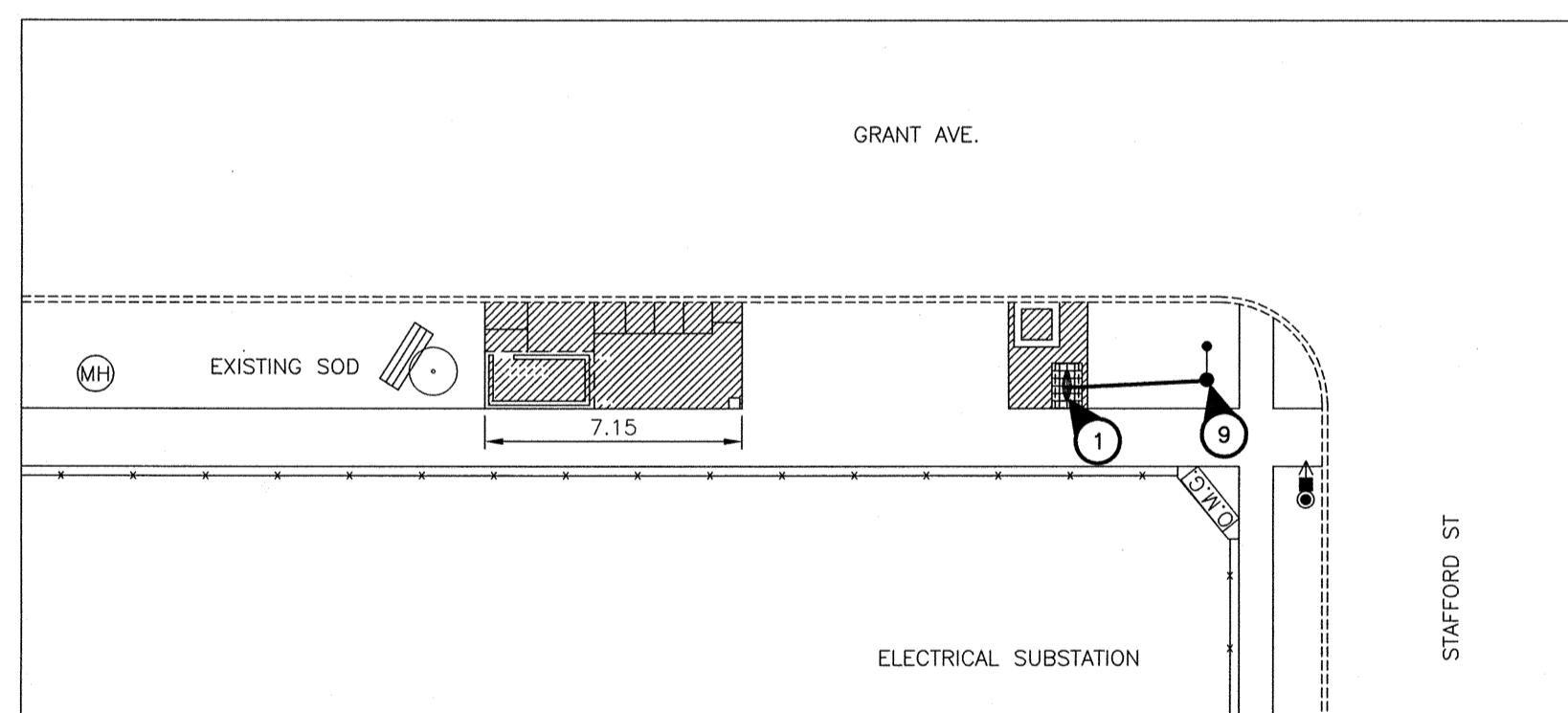

Eastbound Grant, N/S Stafford
Stop 10785 Stafford

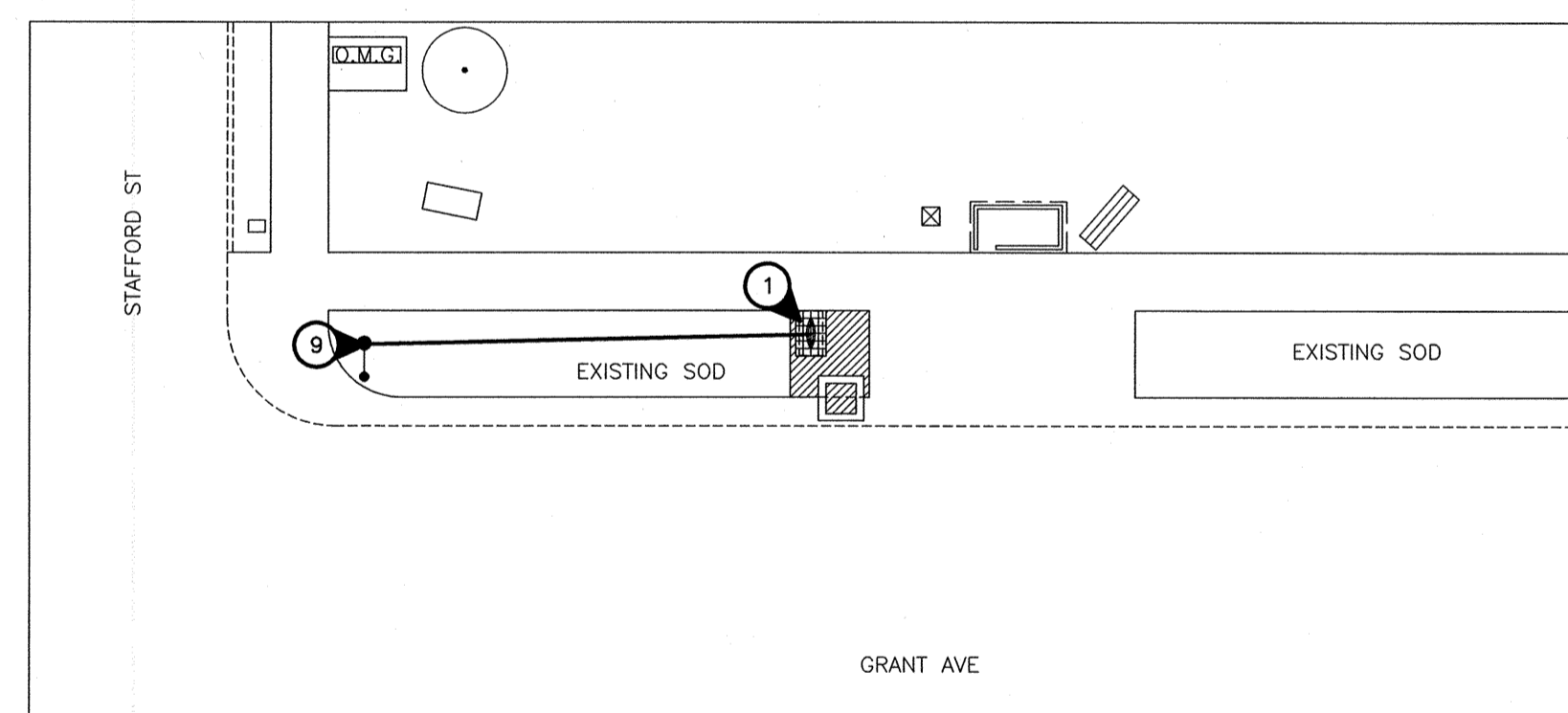

Westbound Grant, N/S Stafford
Stop 10782 Stafford

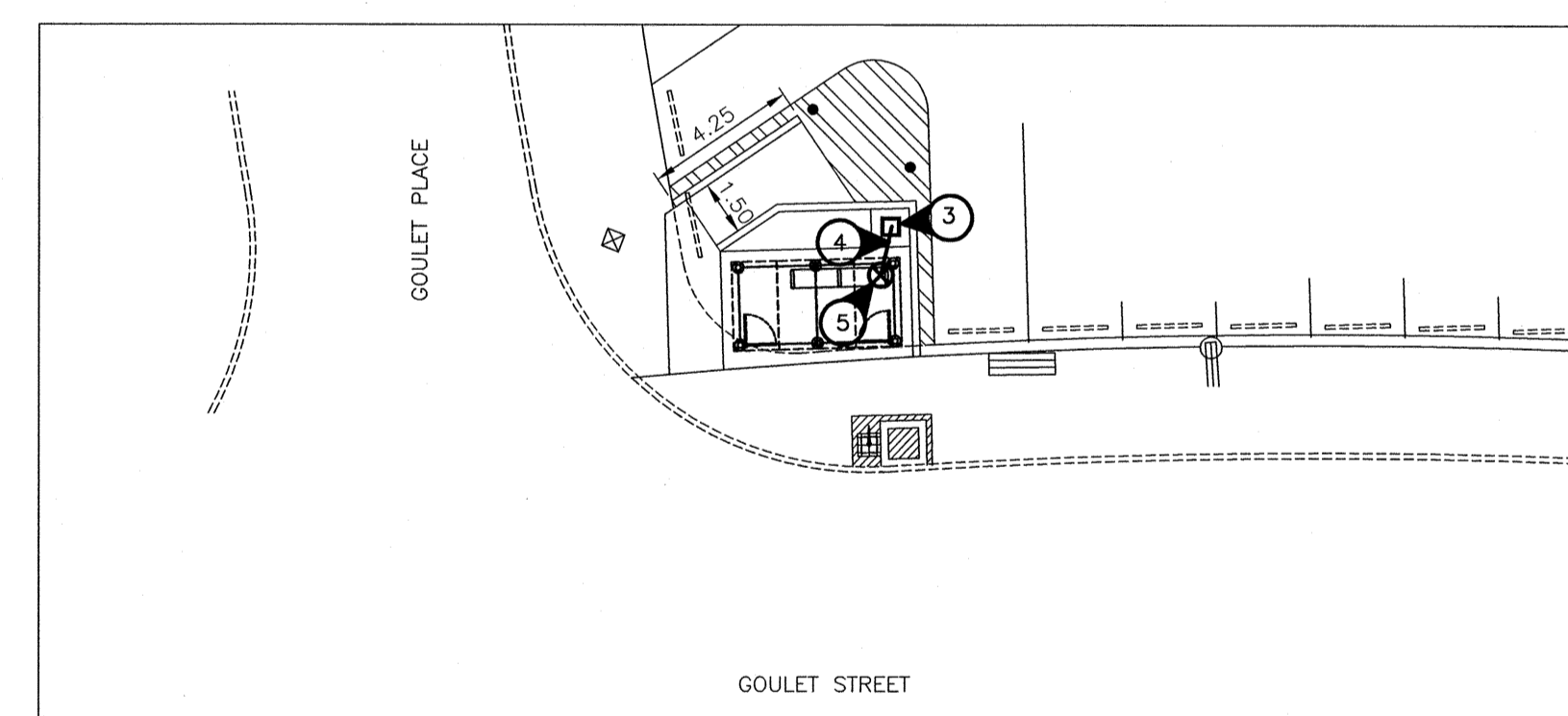

Westbound Goulet, N/S Goulet
Stop 50252 Tache

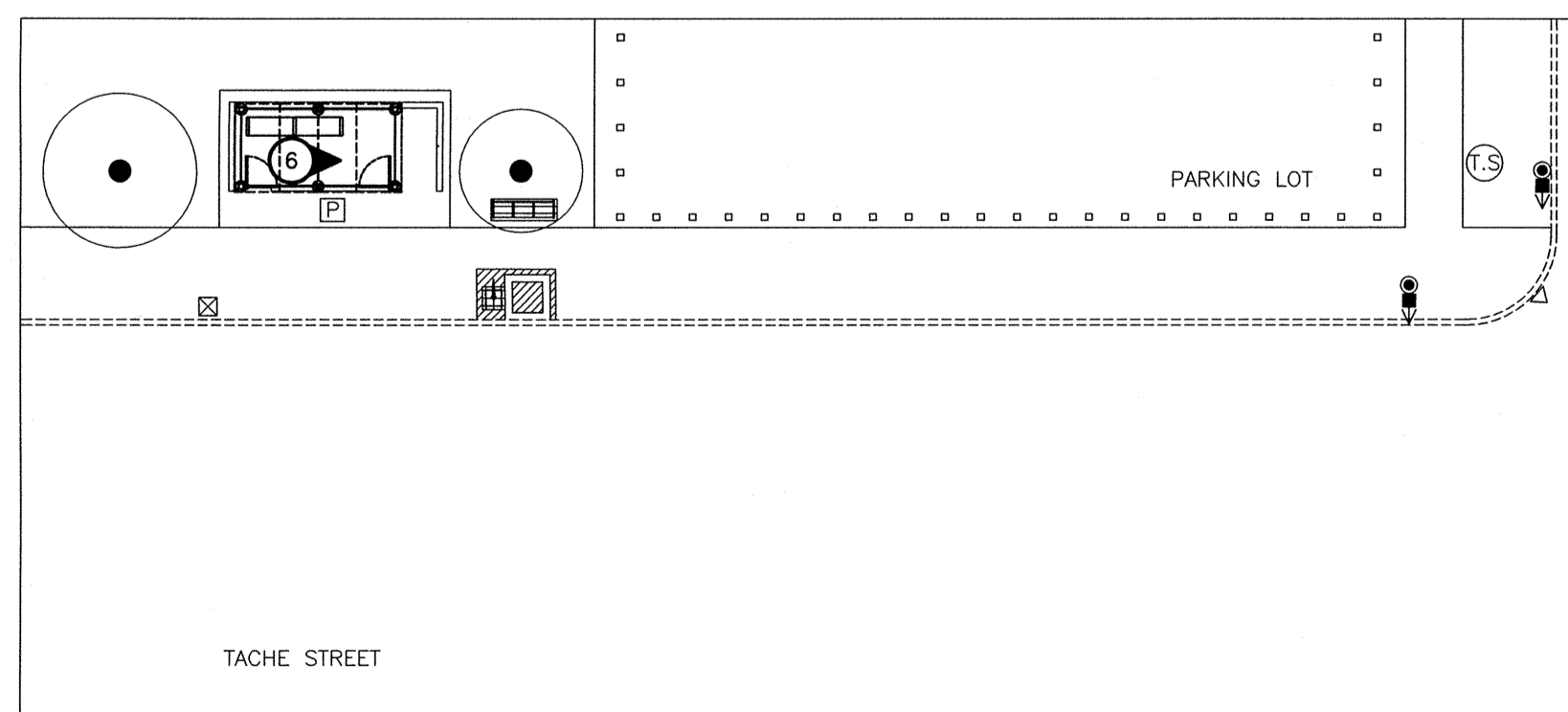
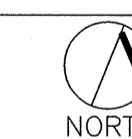

Northbound Tache, F/S Dollard
Stop 50199 Dollard

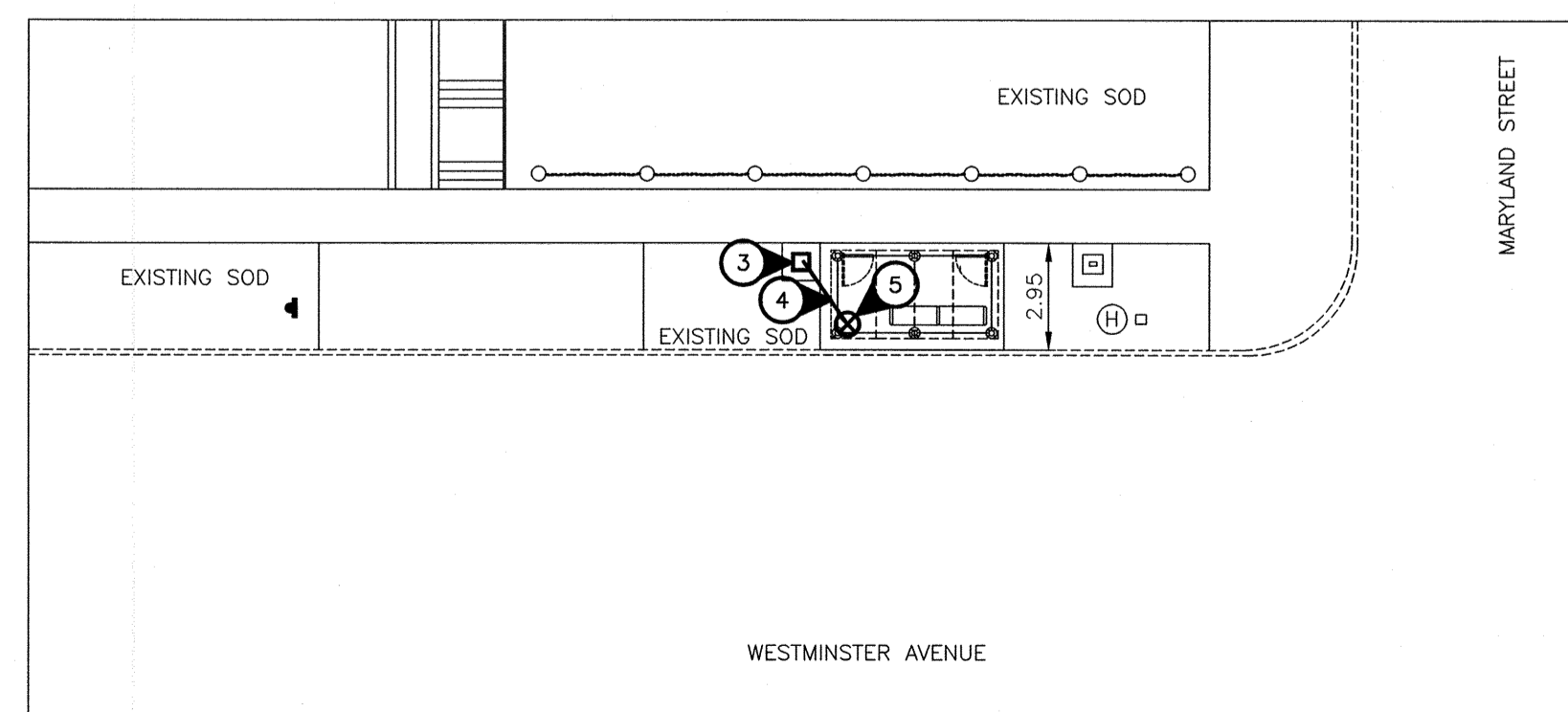

Westbound Westminster, F/S Maryland
Stop 10193 Maryland

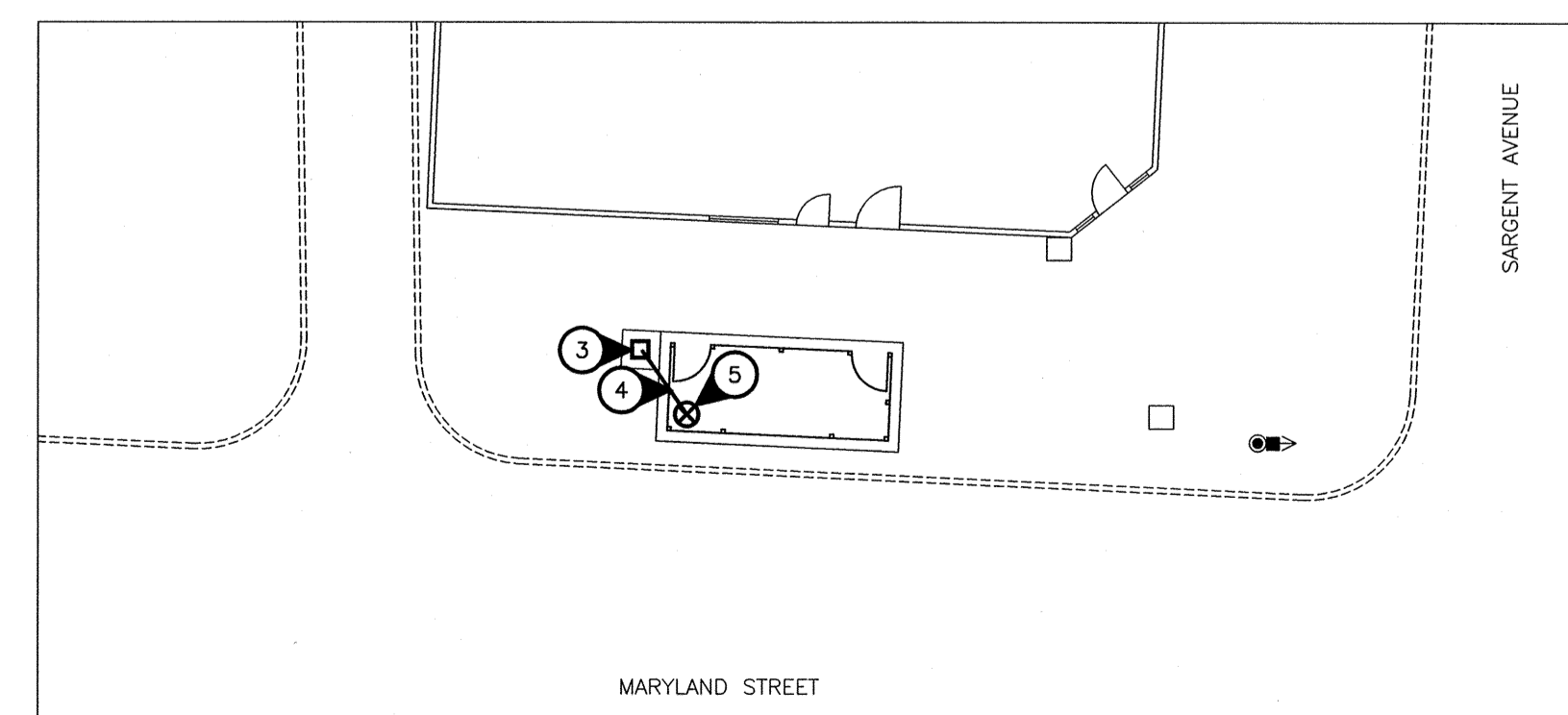
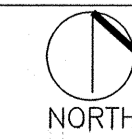

Southbound Maryland, F/S Sargent
Stop 10426 Sargent

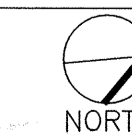

SPECIFIC ELECTRICAL NOTES

- 1 WIRE & CONNECT ILLUMINATED TRANSIT SIGN AS REQUIRED. COORDINATE EXACT LOCATION AND REQUIREMENTS WITH SIGNAGE SUPPLIER.
- 2 BURIED 2 #12 RWJ-90 CU AND GROUND IN A 25mm RIGID PVC CONDUIT. PROVIDE TRENCHING, BACKFILLING AND SURFACE REPAIR AS REQUIRED. PUSH BELOW SURFACE WHERE PRACTICAL.
- 3 NEW POWER PEDESTAL 'A'. SEE DETAIL ON DRAWING E4.
- 4 2#12 AND 4#10 RWJ90 CU AND GROUND IN A 32MM RIGID PVC CONDUIT.
- 5 CONNECT NEW TRANSIT SHELTER LIGHTING AND HEATING CIRCUITS TO POWER PEDESTAL AS REQUIRED. COORDINATE POWER ACCESS WITH SUPPLIER.
- 6 DISCONNECT EXISTING HEATED SHELTER AND PROTECT WIRES FOR REINSTALLATION. EXISTING WIRING AND C.B.'S MAY BE REUSED IF IN GOOD CONDITION AND SIZED CORRECTLY FOR NEW LOADS. CONNECT NEW SHELTER FOLLOWING INSTALLATION.
- 7 PROVIDE A MATCHING 15A-1P C.B. IN EXISTING POWER PEDESTAL FOR NEW SIGN. SIGN TO BE PHOTOCELL CONTROLLED.
- 8 DISCONNECT EXISTING HEATED SHELTER. REMOVE WIRING AS FAR AS PRACTICAL, CAP OFF IN AN APPROVED MANNER.
- 9 CONNECT NEW SIGN TO EXISTING STREET LIGHT/SERVICE POLE INDICATED. PROVIDE A 15A-2P WEATHER-PROOF SERVICE ENTRANCE RATED DISCONNECT AT SIGN (240V-1PH). FPE RH 102-2.
- 10 DISCONNECT EXISTING ILLUMINATED SIGN AND PROTECT WIRES FOR REINSTALLATION. CONNECT NEW SIGN FOLLOWING INSTALLATION.
- 11 DISCONNECT EXISTING ILLUMINATED SIGN. REMOVE WIRING AS FAR AS PRACTICAL, CAP OFF IN AN APPROVED MANNER.
- 12 PROVIDE A 15A-1P C.B. (SIGN), (1) 30A-2P & (1) 15A-2P C.B. (ELEC HEAT), AND (1) 15A-1P C.B. (SHELTER LIGHTING) IN PANELBOARD WITHIN BUILDING. NEW C.B.'S TO MATCH EXISTING. LIGHTING AND SIGN TO BE PHOTOCELL CONTROLLED.

NOVA 3 ENGINEERING LTD.
CONSULTING ENGINEERS

201-120 FORT STREET TEL: (204) 943-6142
WINNIPEG, MANITOBA FAX: (204) 942-1276
R3C 1C7 JN: 29-032

THIS DRAWING IS THE EXCLUSIVE PROPERTY OF NOVA 3 ENGINEERING LTD. AND MAY ONLY BE REPRODUCED WITH THE WRITTEN PERMISSION OF NOVA 3 ENGINEERING LTD.
THE CONCEPT AND DESIGN INCORPORATED INTO THIS DRAWING ARE BASED ON INFORMATION PROVIDED BY THE CLIENT AND OTHER RELATED SOURCES. PROFESSIONAL ENGINEER ACCEPTS NO RESPONSIBILITY FOR DRAWING AND DESIGN UNLESS DRAWING IS ACCOMPANIED BY ORIGINAL SEALED AND SIGNED LETTER OF INTENT AND CERTIFICATE OF INSPECTION. REFER TO WWW.NOVA3.CA FOR CAUTIONARY NOTES.

No.	Revisions	Date	By
02-27-09	1:200		
Designed By	DZ	Drawn By	DF
Checked By			VJT

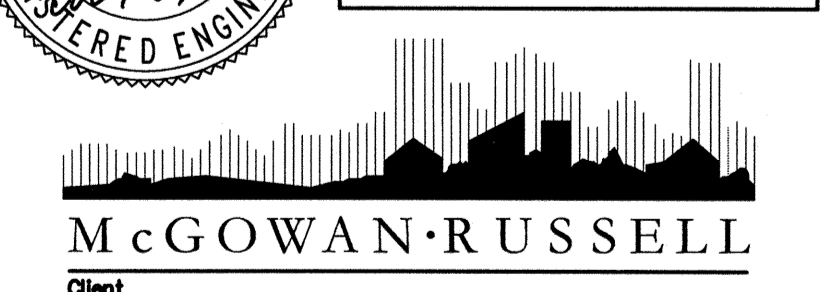
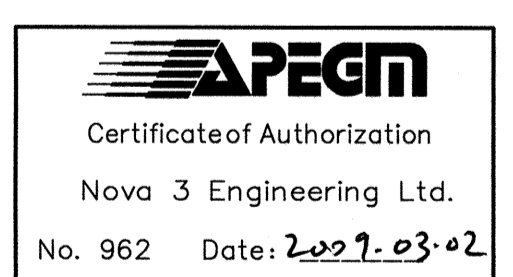
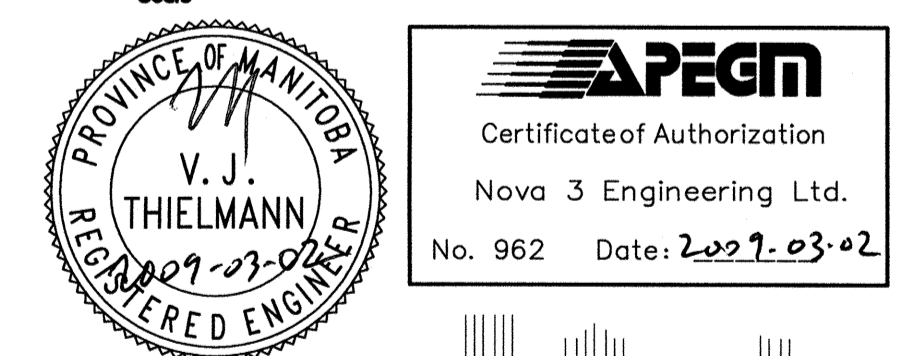

WINNIPEG TRANSIT
Project Title
BUS STOP UPGRADE PROGRAM PHASE 3 ELECTRICAL WORKS

Sheet Title
ALL STOPS - ELECTRICAL PLANS 1 OF 4

Project No. 06-029 / 29-032 Drawing No. E1