

Southbound Cavalier, N/S Morgan  
Stop 20349 Morgan

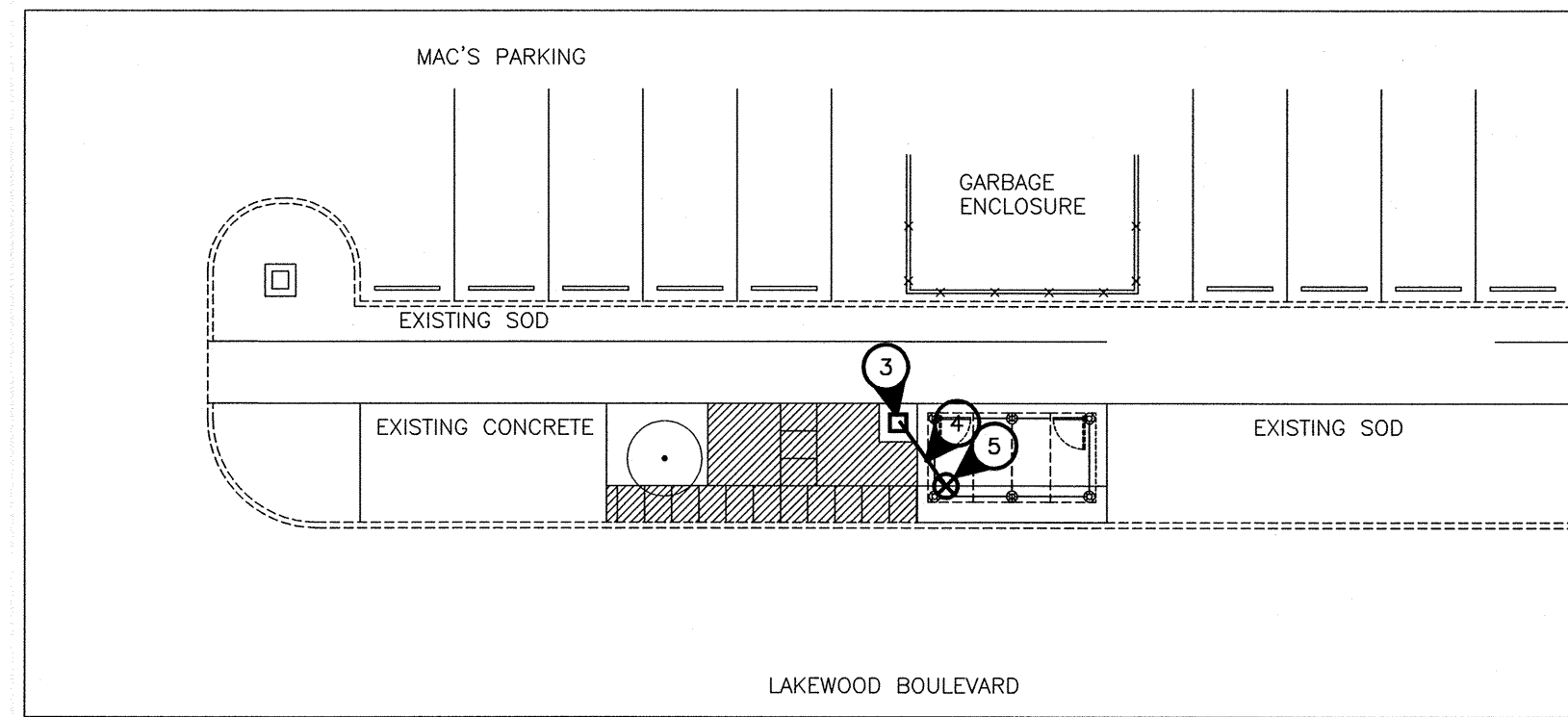

Southbound Lakewood, N/S Weatherstone  
Stop 50310 Southdale Centre

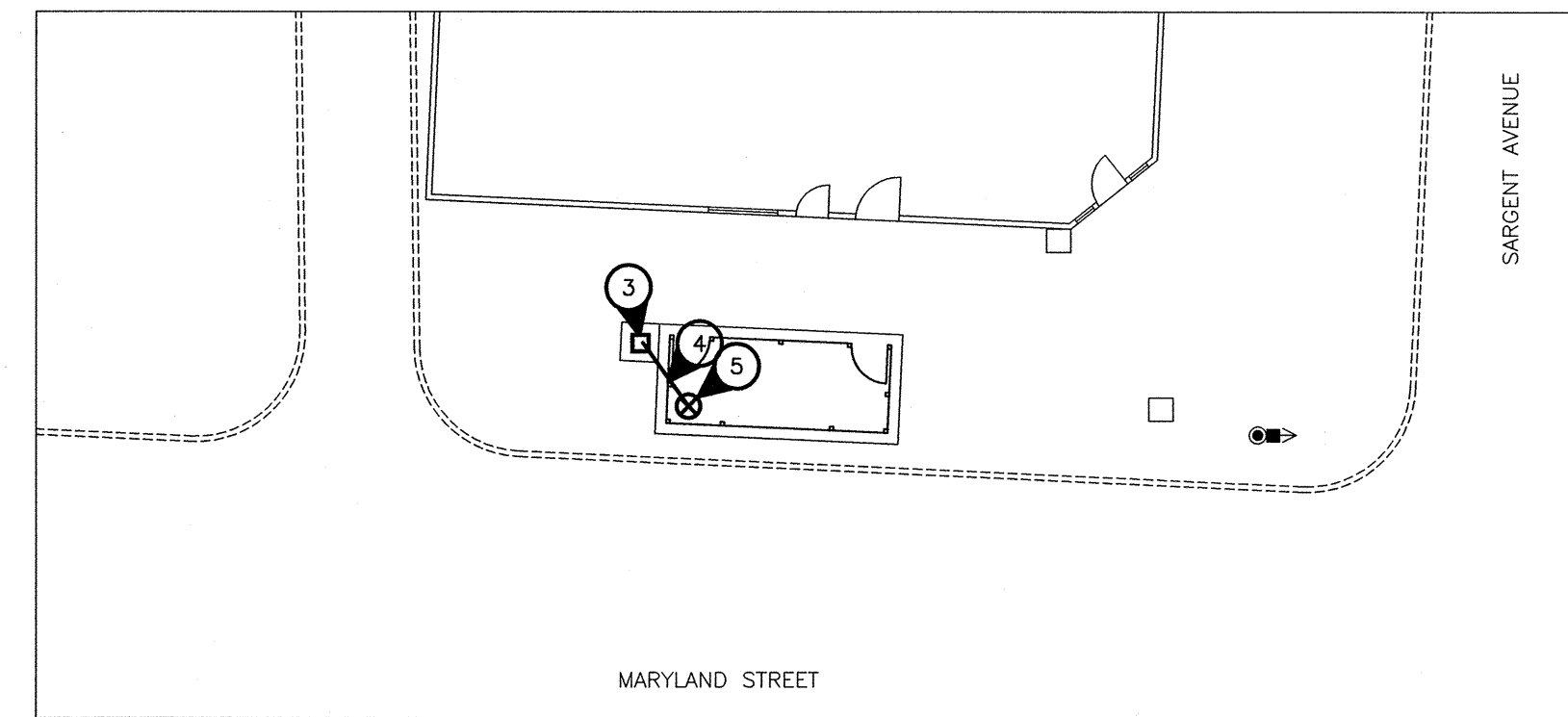

Southbound Maryland, F/S Sargent  
Stop 10426 Sargent

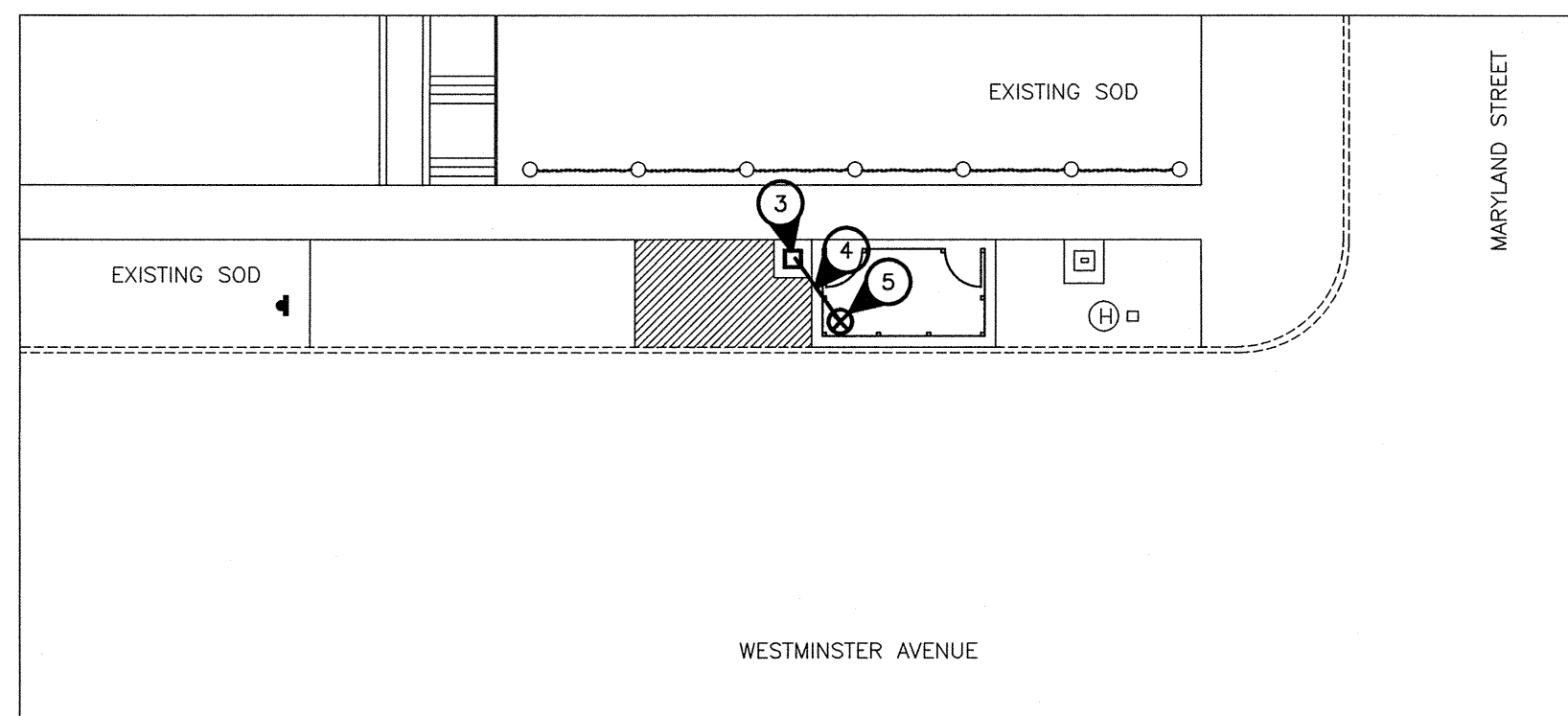

Westbound Westminster, F/S Maryland  
Stop 10193 Maryland

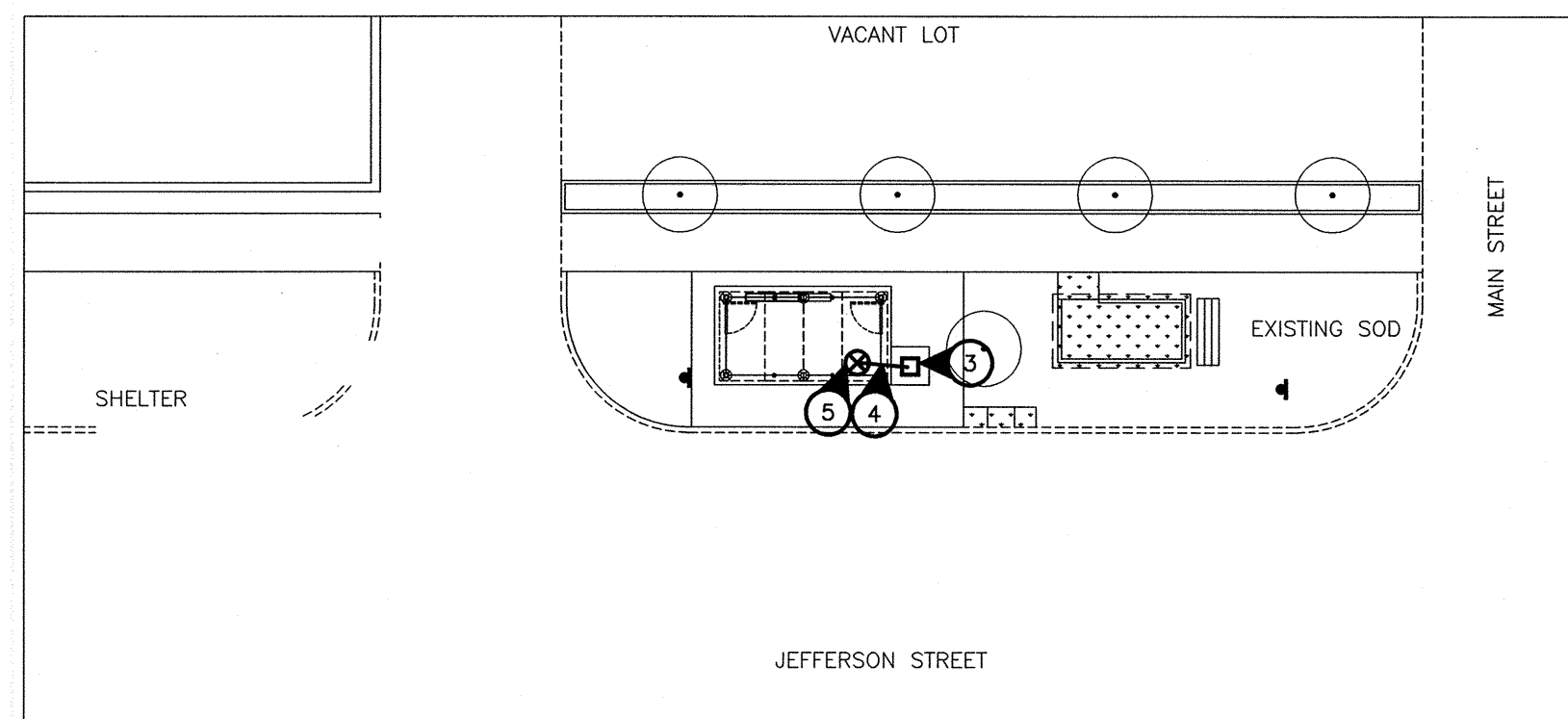

Westbound Jefferson, F/S Main  
Stop 30041 Main

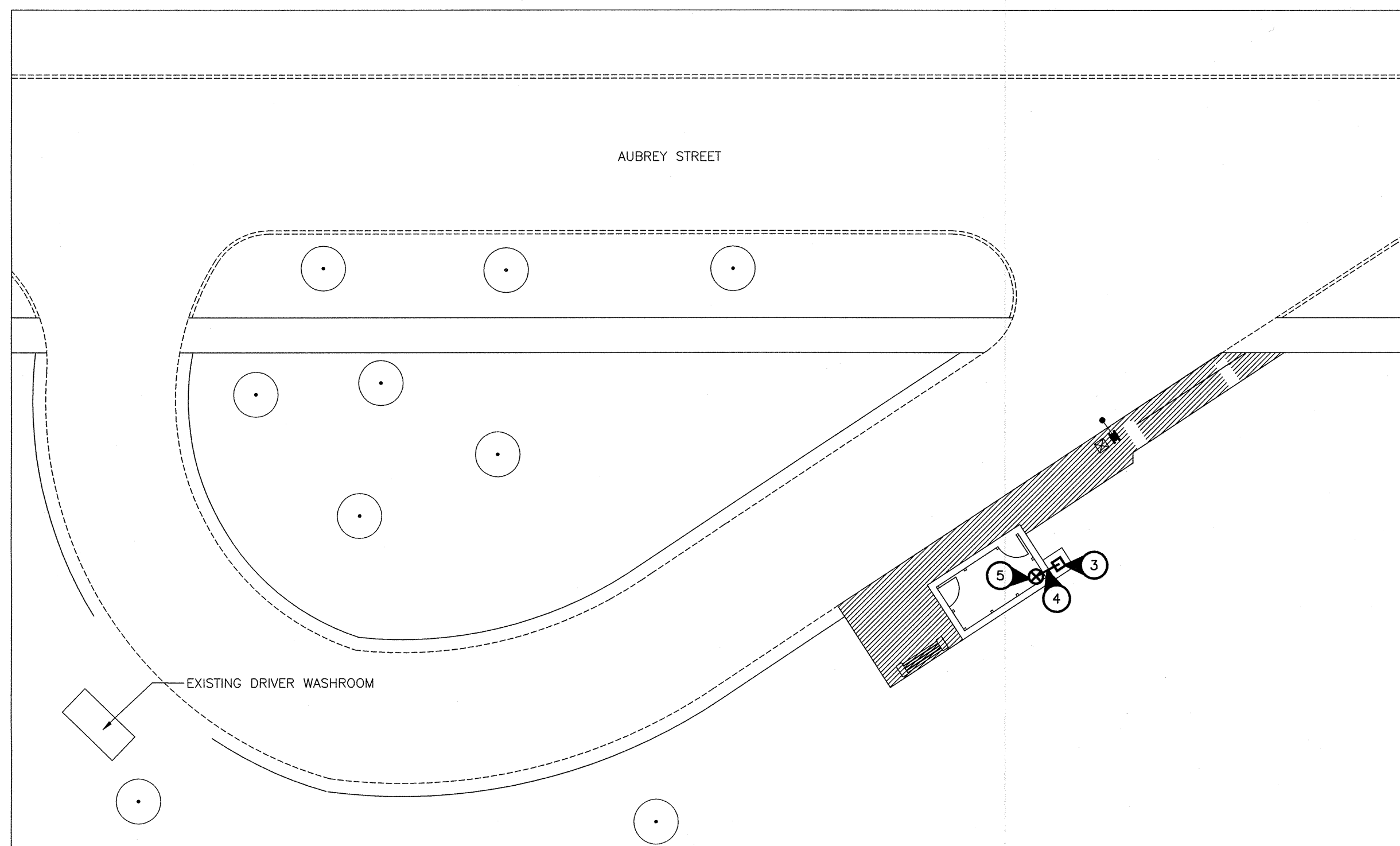

Northbound Aubrey, N/S Wolseley  
Stop 10232 Wolseley

**SPECIFIC ELECTRICAL NOTES**

- 1 WIRE & CONNECT ILLUMINATED TRANSIT SIGN AS REQUIRED. COORDINATE EXACT LOCATION AND REQUIREMENTS WITH SIGNAGE SUPPLIER.
- 2 BURIED 2 #12 RWU-90 CU AND GROUND IN A 25mm RIGID PVC CONDUIT. PROVIDE TRENCHING, BACKFILLING AND SURFACE REPAIR AS REQUIRED. PUSH BELOW SURFACE WHERE PRACTICAL.
- 3 NEW POWER PEDESTAL 'A'. SEE DETAIL ON DRAWING E4.
- 4 2#12 AND 4#10 RWU90 CU AND GROUND IN A 32MM RIGID PVC CONDUIT.
- 5 CONNECT NEW TRANSIT SHELTER LIGHTING AND HEATING CIRCUITS TO POWER PEDESTAL AS REQUIRED. COORDINATE POWER ACCESS WITH SUPPLIER.
- 6 DISCONNECT EXISTING HEATED SHELTER AND PROTECT WIRES FOR REINSTALLATION. EXISTING WIRING AND C.B.'S MAY BE REUSED IF IN GOOD CONDITION AND SIZED CORRECTLY FOR NEW LOADS. CONNECT NEW SHELTER FOLLOWING INSTALLATION.
- 7 PROVIDE A MATCHING 15A-1P C.B. IN EXISTING POWER PEDESTAL FOR NEW SIGN. SIGN TO BE PHOTOCELL CONTROLLED.
- 8 DISCONNECT EXISTING HEATED SHELTER. REMOVE WIRING AS FAR AS PRACTICAL. CAP OFF IN AN APPROVED MANNER.
- 9 CONNECT NEW SIGN TO EXISTING STREET LIGHT/SERVICE POLE INDICATED. PROVIDE A 15A-2P WEATHER-PROOF SERVICE ENTRANCE RATED DISCONNECT AT SIGN (240V-1PH). FPE RH 102-2.
- 10 DISCONNECT EXISTING ILLUMINATED SIGN AND PROTECT WIRES FOR REINSTALLATION. CONNECT NEW SIGN FOLLOWING INSTALLATION.
- 11 DISCONNECT EXISTING ILLUMINATED SIGN. REMOVE WIRING AS FAR AS PRACTICAL. CAP OFF IN AN APPROVED MANNER.
- 12 PROVIDE A 15A-1P C.B. (SIGN), (1) 30A-2P & (1) 15A-2P C.B. (ELEC HEAT), AND (1) 15A-1P C.B. (SHELTER LIGHTING) IN PANELBOARD WITHIN BUILDING. NEW C.B.'S TO MATCH EXISTING. LIGHTING AND SIGN TO BE PHOTOCELL CONTROLLED.

**NOVA 3 ENGINEERING LTD.**  
CONSULTING ENGINEERS

201-120 FORT STREET TEL: (204) 943-6142  
WINNIPEG, MANITOBA FAX: (204) 942-1276  
R3C 1C7 JN: 29-032

THIS DRAWING IS THE EXCLUSIVE PROPERTY OF NOVA 3 ENGINEERING LTD. AND MAY ONLY BE REPRODUCED WITH THE WRITTEN PERMISSION OF NOVA 3 ENGINEERING LTD.  
THE CONCEPT AND DESIGN INCORPORATED INTO THIS DRAWING ARE BASED ON INFORMATION PROVIDED BY THE CLIENT AND OTHER RELATED SOURCES. PROFESSIONAL ENGINEERS ACCEPTS NO RESPONSIBILITY FOR DRAWING AND DESIGN UNLESS DRAWING IS ACCOMPANIED BY ORIGINAL SEALED AND SIGNED LETTER OF INTENT AND CERTIFICATE OF INSPECTION.  
REFER TO WWW.NOVA3.CA FOR CAUTIONARY NOTES.

No.	Revisions	Date	By
02-27-09	1:200		
Designed By	Drawn By	Checked By	
DZ	DF	VJT	

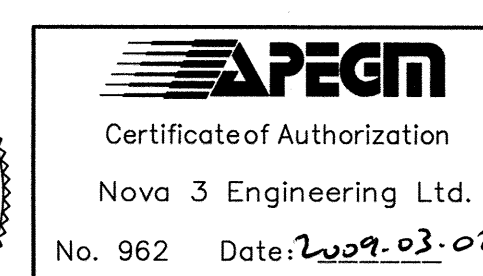
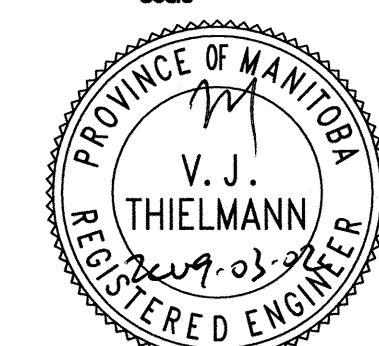

WINNIPEG TRANSIT  
Project Title  
**BUS STOP UPGRADE PROGRAM PHASE 3 ELECTRICAL WORKS**  
Sheet Title  
**ALL STOPS - ELECTRICAL PLANS 3 OF 4**

Project No. 06-029 / 29-032 Drawing No. E3