

MATCHLINE 5+70 - SEE DWG. 42072-C-003

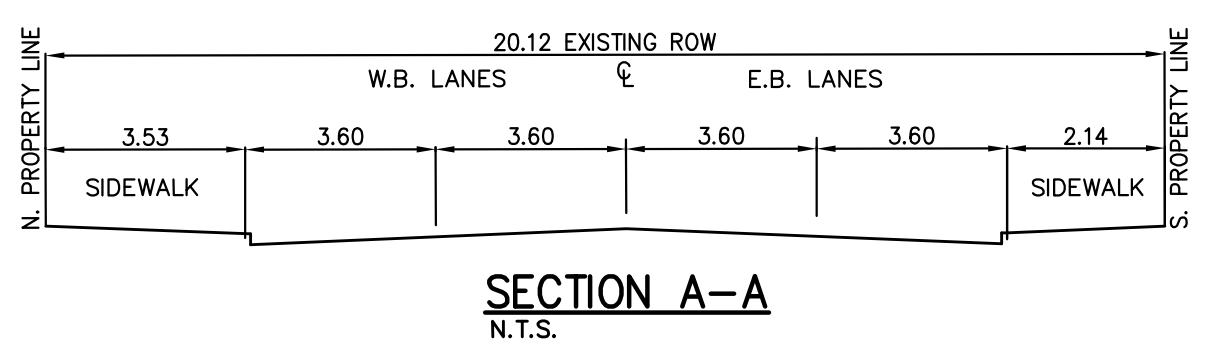

- NOTES:**
1. ALL ROADWAY DIMENSIONS SHOWN ARE TO BACK OF CURB.
  2. ADD 200.00 TO ALL ELEVATIONS TO OBTAIN GEODETIC ELEVATION.
  3. FINISHED CURB HEIGHT TO BE 125 mm UNLESS OTHERWISE NOTED.
  4. CONCRETE REPAIRS SHOWN ARE ESTIMATED. ACTUAL LOCATIONS ARE TO BE FIELD DETERMINED.

**METRIC**  
WHOLE NUMBERS INDICATE MILLIMETERS  
DECIMAL NUMBERS INDICATE METERS

NOTE: These design documents are prepared solely for the use by the party with whom the design professional has entered into a contract and there are no representations of any kind made by the design professional to any party with whom the design professional has not entered into a contract.

EXISTING	LEGEND-PLAN	PROPOSED	EXISTING	LEGEND-PLAN	PROPOSED	EXISTING	LEGEND-PROFILE	PROPOSED
⊕	WATERMAIN	⊕	⊕	TRAFFIC SIGNAL POLE	⊕	⊕	CENTRE LINE	⊕
⊕	HYDRANT/VALVE	⊕	⊕	HYDRO POLE	⊕	⊕	SOUTH GUTTER	⊕
⊕	ASPHALT MILLING	⊕	⊕	HYDRO POLE WITH LIGHT	⊕	⊕	NORTH GUTTER	⊕
⊕	LAND DRAINAGE SEWER	⊕	⊕	PROPERTY LINE	⊕	⊕	SOUTH PROP. LINE	⊕
⊕	WASTE WATER SEWER	⊕	⊕	BARRIER CURB	⊕	⊕	NORTH PROP. LINE	⊕
⊕	MANHOLE	⊕	⊕	EDGE OF ASPHALT ROADWAY	⊕	⊕		⊕
⊕	CATCH BASIN	⊕	⊕	SIDEWALK RAMP	⊕	⊕		⊕
⊕	C & G INLET	⊕	⊕	ROAD ELEVATION	⊕	⊕		⊕
⊕	SIGNAL PIT	⊕	⊕	CONC. SIDEWALK	⊕	⊕		⊕
⊕	UTILITIES ADJUSTED	⊕	⊕	ASPHALT PAVEMENT	⊕	⊕		⊕
⊕	GAS	⊕	⊕	CONCRETE REPAIRS	⊕	⊕		⊕
⊕	M.T.S.	⊕	⊕		⊕	⊕		⊕

**LOCATIONS APPROVED**

NO.	REVISIONS	DATE	BY
3	ISSUED FOR TENDER	05.12.09	RMB
2	REVISIONS FROM CITY REVIEW	04.16.09	RMB
1	UNDERGROUND REVIEW	03.26.09	RMB

**MMM GROUP**

DESIGNED BY	RA	CHECKED BY	RMB/dd
DRAWN BY	RA <td>APPROVED BY</td> <td>RMB </td>	APPROVED BY	RMB
HOR. SCALE	1:250	RELEASED FOR CONSTRUCTION	
VERTICAL	1:10	DATE	
DATE:	01.01.09		



**CITY OF WINNIPEG**  
PUBLIC WORKS DEPARTMENT  
TRANSPORTATION ENGINEERING DIVISION

**NOTRE DAME AVENUE**  
PRINCESS STREET TO ISABEL STREET

**PAVEMENT REHABILITATION**  
STA. 5+70.00 TO WEST LIMIT PRINCESS STREET

**P3307-04**  
SHEET 4 OF 4

May 12, 2009 - 2:59pm  
P:\42072 - 42072\42072 - 42072\Drawings\42072\_C01-04.dwg - tab C-04