

P:\PROJECTS\2008\08-0107-16\DWG\WUN_CORYDON-PLAN.dwg
PLOT 1:1 (A-1)

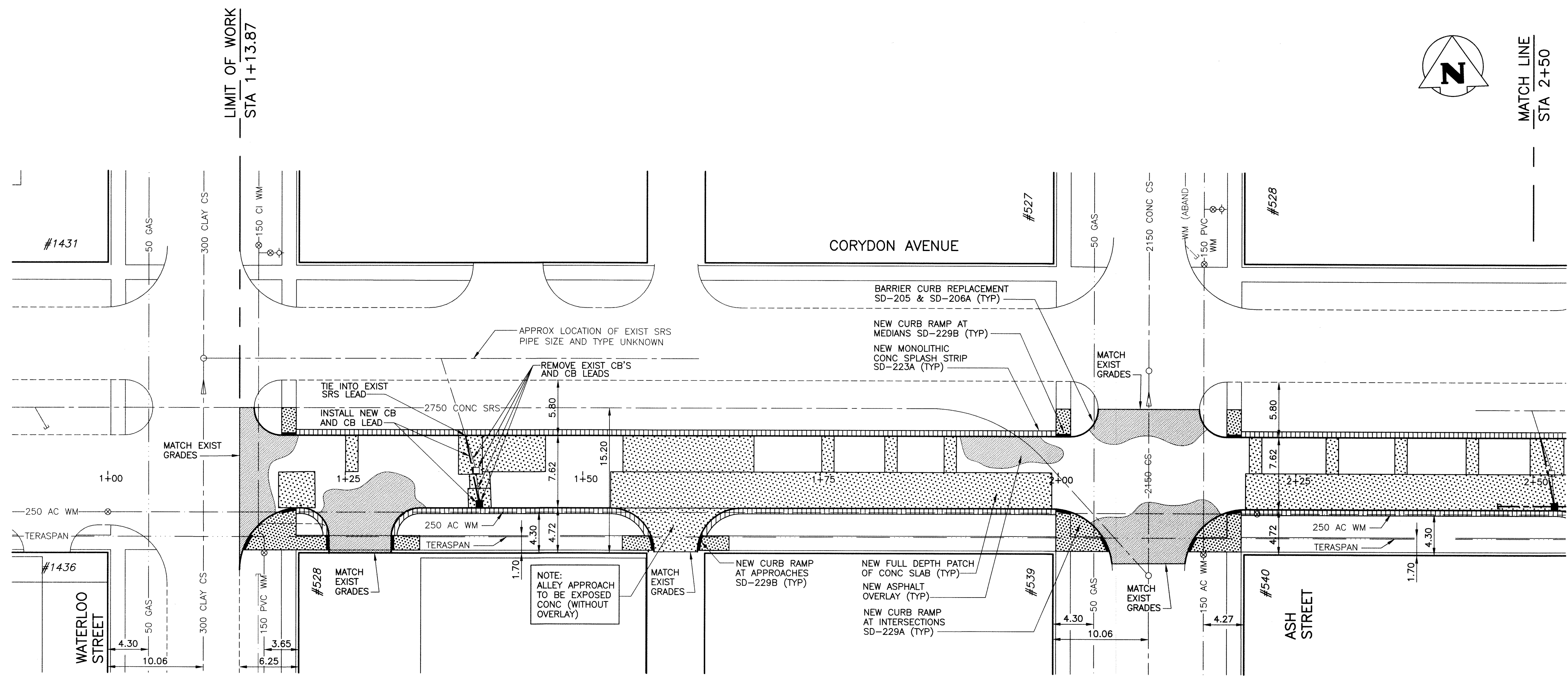

- NOTES:**
1. STATIONING IN CENTRE OF CORYDON EASTBOUND LANES UNLESS OTHERWISE NOTED
 2. WEST PROPERTY LINE OF WATERLOO STREET IS STA 1+00.0
 3. ALL MEASUREMENTS TO BACK OF CURB
 4. ADJUST MH AND CB RIMS TO NEW GRADES
 5. PLANE EXISTING ASPHALT PAVEMENT FROM STA 1+13.87 THROUGH STA 4+75.4
 6. DESIGN PROFILE TO BE COMPLETED AFTER PLANING OPERATIONS.

METRIC
WHOLE NUMBERS INDICATE MILLIMETRES
DECIMALIZED NUMBERS INDICATE METRES

PROPERTY LIMITS DELINEATION
DELINEATION OF PROPERTY LIMITS AS SHOWN ON THIS DWG DOES NOT REPRESENT A "LEGAL SURVEY". KGS GROUP MAKES NO REPRESENTATION OR WARRANTY AS TO THE ACCURACY OF PROPERTY LIMITS DELINEATED ON THIS DWG, NOR ON THE DIMENSIONAL ACCURACY OF DWG FEATURES RELATIVE TO THOSE PROPERTY LIMITS.

WARNING

1. NOTIFY THE GAS COMPANY OF THE PROPOSED LOCATION OF EXCAVATION.
2. TAKE PRECAUTION TO AVOID DAMAGE TO GAS COMPANY INSTALLATIONS.
3. SEE PROVINCIAL REGULATION 210/72 FOR DETAILS.

METRIC
WHOLE NUMBERS INDICATE MILLIMETRES
DECIMALIZED NUMBERS INDICATE METRES

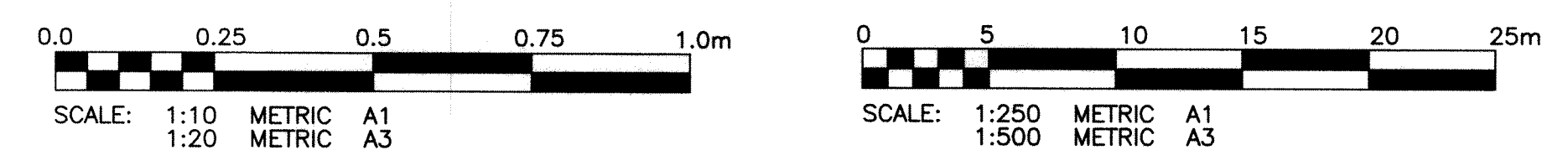

PRELIMINARY
NOT TO BE USED FOR CONSTRUCTION

EXISTING	LEGEND-PLAN	PROPOSED	EXISTING	LEGEND-PLAN	PROPOSED	EXISTING	LEGEND-PROFILE	PROPOSED
300 LBS	AND DRAINAGE SEWER	300 LBS	TEST HOLE					
250 WWS	WASTE WATER SEWER	250 WWS	GUY WIRE					
	GAS		LIGHT STANDARD					
	HYDRO		BACK OF CURB					
	M.T.S.		CONCRETE					
150 WM	WATERMAIN	150 WM	ASPHALT					
	HYDRANT		SIDEWALK					
	VALVE		PROPERTY LINE					
	MANHOLE		SURVEY BAR					
	CATCH BASIN		GEODETIC BENCHMARK					
	CURB INLET		ELEVATION	231.334	32.231			
	POLES							

LOCATION APPROVED UNDERGROUND STRUCTURES

SUPV. U/G STRUCTURES COMMITTEE DATE

NOTE:
LOCATION OF UNDERGROUND STRUCTURES AS SHOWN ARE BASED ON THE BEST INFORMATION AVAILABLE BUT NO GUARANTEE IS GIVEN THAT ALL EXISTING UTILITIES ARE SHOWN OR THAT THE GIVEN LOCATIONS ARE EXACT. CONFIRMATION OF EXISTENCE AND EXACT LOCATION OF ALL SERVICES MUST BE OBTAINED FROM THE INDIVIDUAL UTILITIES BEFORE PROCEEDING WITH CONSTRUCTION.

NO.	REVISIONS	DATE	BY
0	ISSUED FOR TENDER	30/03/09	RJH

KGS CONSULTING ENGINEERS & PROJECT MANAGERS GROUP

WINNIPEG (204) 886-1209
THUNDER BAY (807) 345-2233

DESIGNED BY: JDF
CHECKED BY: RJH
DRAWN BY: DMW
APPROVED BY:

HOR. SCALE: 1:250
VERTICAL: 1:50

RELEASED FOR CONSTRUCTION: 28/11/08

ENGINEER'S SEAL

R.J. HOUSTON
Member
Professional Engineer

CONSULTANT DRAWING NO. 08-0107-16_01

THE CITY OF WINNIPEG
PUBLIC WORKS DEPARTMENT
ENGINEERING SERVICES DIVISION

PROJECT TITLE: CORYDON AVENUE EASTBOUND PAVEMENT REHABILITATION

WATERLOO STREET TO MONTROSE STREET
STA 1+00 TO STA 2+50

SHEET 01 OF 03
COMPUTER FILE NAME: CORYDON PLOT.DWG
CITY DRAWING NUMBER: P-3303-01