

**PLAN**  
SCALE 1:750

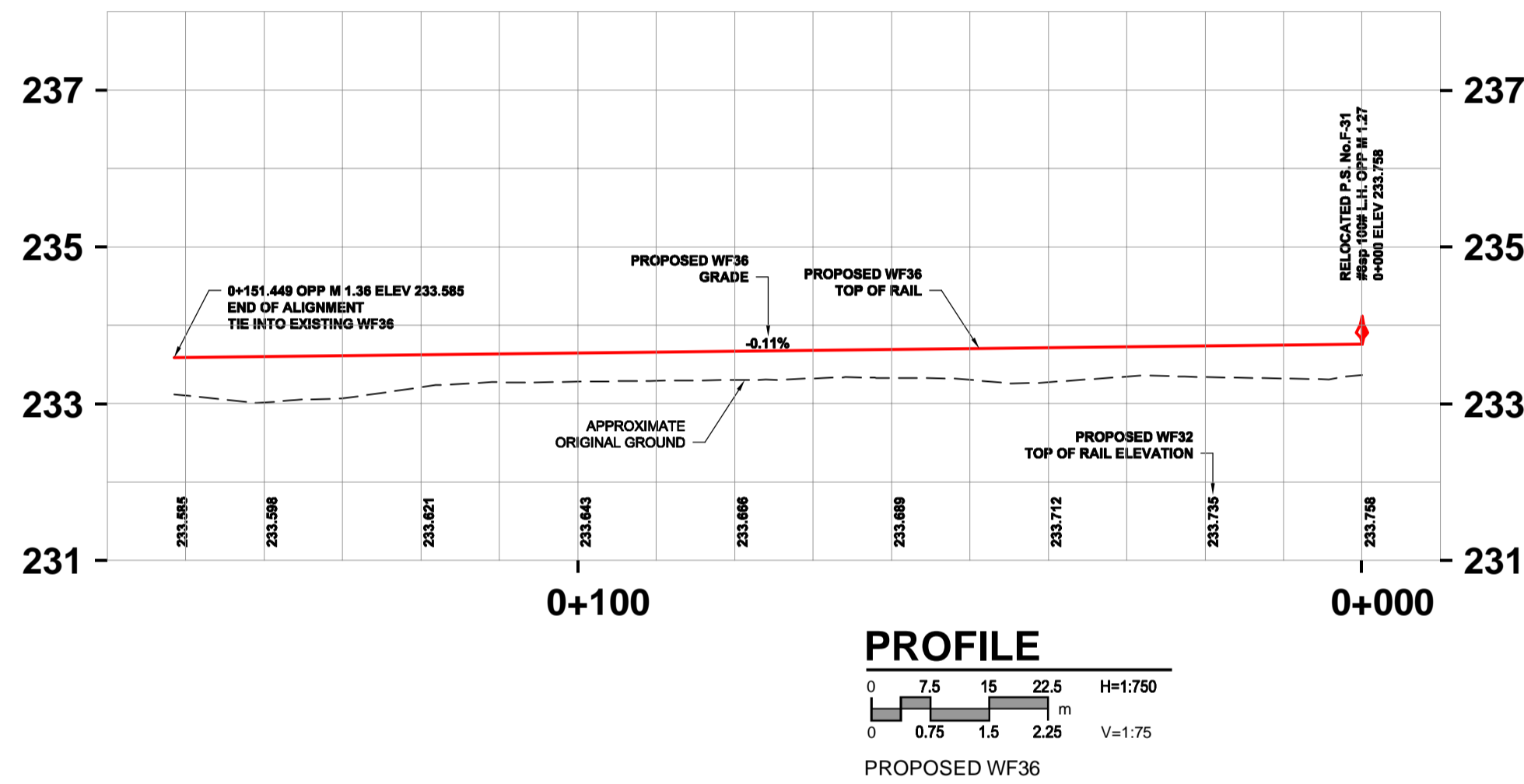

**PROFILE**  
H=1:750  
V=1:75  
PROPOSED WF36

ALIGNMENT GEOMETRIC CONTROL DATA - STAGE 'Eii'			
DESC	STATION	NORTHING	EASTING
<b>PROPOSED WF36 - OVERALL CONFIGURATION</b>			
P.S.	0+000	5528127.892	633578.840
EC	0+021.050	5528107.577	633571.388
P.S.	0+055.464	5528073.892	633564.321
EC	0+074.060	5528055.485	633561.733
BC	0+096.931	5528032.716	633559.577
EC	0+142.154	5525988.668	633549.853
TIE INTO WF36	0+151.449	5525979.905	633546.752

ALIGNMENT CURVE DATA - STAGE 'Eii'						
CURVE	DELTA	RADIUS	Dc	SUB TANGENT	LENGTH	LENGTH OF SPIRALS
<b>YARD RECONFIGURATION</b>						
CURVE 8	14°04'44"	184.040	9°30'00"	22.726	45.223	na

**CONSTRUCTION STAGING**

- E. COMPLETE WF32 AND WF32 RECONFIGURATION
- ii. REALIGN EAST LADDER FROM SW.No. F-31 #8sp-115# SGM TO END OF NEW ALIGNMENT

**GENERAL NOTES:**

- ALL DIMENSION ARE METRIC UNLESS NOTED OTHERWISE
- SURVEY CONTROL IS BASED ON GEODETIC BENCH-MARK
- ALL UTILITIES TO BE LOCATED IN THE FIELD AND MODIFIED AS NECESSARY TO TC-E-10 AND TC-E-11 STANDARDS.
- ALL EXISTING FENCES AFFECTED BY CONSTRUCTION ARE TO BE REBUILT BY THE CONTRACTOR AS DIRECTED BY THE CONTRACT ADMINISTRATOR.
- ALL PROPERTY LINES ARE PROVIDED FOR INFORMATION PURPOSES ONLY.
- SEE 01-CT6001 FOR GEOMETRIC CONTROL TABLES.

**WARNING - BURIED S&C CABLES**  
PRIOR TO CONSTRUCTION CN SIGNALS MUST BE NOTIFIED. AS WELL, USE EXTREME CAUTION WHEN WORKING NEAR CABLES, JUNCTION BOXES, CONDUITS, ETC.

LEGEND			
EXISTING	DESCRIPTION	PROPOSED	DESCRIPTION
	SWITCH STAND & POWER SWITCH		DERAILED
	CROSSING PLANKS		SURVEY CONTROL POINT
	CENTRELINE MAIN		CULVERT/CULVERT EXTENSION
	CENTRELINE - 85# RAIL		GRAVEL ROADWAY
	CENTRELINE - 115# RAIL		PAVED ROADWAY
	CENTRELINE - 132# RAIL		CHAINLINK FENCE

LOCATION APPROVED UNDERGROUND STRUCTURES	
EXISTING	DESCRIPTION
	OVERHEAD POWER WITH POLE
	UNDERGROUND POWER LINE
	UNDERGROUND FIBRE OPTIC LINE
	UNDERGROUND GAS LINE
	OVERHEAD CNT LINE WITH POLE
	UNDERGROUND S&C CABLE

LOCATION APPROVED UNDERGROUND STRUCTURES			
NO.	ISSUED FOR TENDER	DATE	BY
0	ISSUED FOR TENDER	09/05/27	RCP
	REVISIONS	YYMMDD	BY

DESIGNED BY		CHECKED BY	
RCP		KEG	
DRAWN BY		APPROVED BY	
BRP			
HOR. SCALE		RELEASED FOR CONSTRUCTION	
1:750			
VERT. SCALE		DATE	
1:75		09/05/27	

PROFESSIONAL'S SEAL	
DESIGNED BY	DATE
RCP	09/05/27

**THE CITY OF WINNIPEG  
TRANSIT DEPARTMENT**

**SOUTH WEST TRANSIT CORRIDOR  
CN FORT ROUGE YARD  
PLAN AND PROFILE  
PHASE 1 - STAGE 'Eii'**

CITY DRAWING NUMBER P-3309-09	SHEET 9 OF 14
DRAWING No. <b>01-CT1008</b>	REV <b>0</b>

© 2009 AECOM Canada Ltd. All Rights Reserved. This document is protected by copyright law and may not be used, reproduced or modified in any manner or for any purpose except with the written permission of AECOM Canada Ltd. ("AECOM") or a party to which its copyright has been assigned. AECOM accepts no responsibility, and denies any liability whatsoever, to any party that uses, reproduces, modifies, or relies on this document without AECOM's express written consent.

CONSULTANT DRAWING NO.  
F504-444-00\_01-CT1008\_0