

NOTES:

- CONTRACTOR TO EXPOSE EXISTING WATERMANS AT THE IN'S AND CONFIRM INVERTS OF PIPE.
- CONTRACTOR TO FOLLOW LATEST VERSION OF THE CITY OF WINNIPEG STANDARD CONSTRUCTION SPECIFICATION. WATERMANS TO BE INSTALLED BY TRENCHLESS METHODS.
- CLASS 3 BACKFILL TO BE USED WITHIN 1 METER OF PAVED SURFACES.
- CONTRACTOR TO NOTIFY RESIDENTS AT LEAST 24 HOURS PRIOR TO ANY DISRUPTION OF WATER SERVICE.

ADDRESS	SIZE (mm) & TYPE (STREET)	SHORT & LONG MEASUREMENT	COMP. LOCATION	REMARKS
#128 YALE AVE. E. RESIDENTIAL	19 COPPER	9.1 S OF N BLDG LINE	0.6 N OF S/C	-
#200 YALE AVE. E. RESIDENTIAL	NO INFO	3.1 N. S. HSE. LINE	-	-
#201 YALE AVE. E. RESIDENTIAL	NO INFO	3.1 E. W. LINE	1.8 E OF W/L	-
#501 KANATA ST. RESIDENTIAL	19 COPPER	1.1 SBL. OF HOUSE	6.3 FROM HSE. FRONT	-
#505 KANATA ST. RESIDENTIAL	19 COPPER	2.8 N/S HSE. LINE	6.1 FROM HSE. FRONT	3.7N/S HSE. LINE
#507 KANATA ST. RESIDENTIAL	19 COPPER	OPP. NORTH LINE	3.7 OUT	0.5 N OF S/C
#509 KANATA ST. RESIDENTIAL	19 COPPER	1.7 SBL. OF HOUSE	7.9 FROM HSE. FRONT	-
#511 KANATA ST. RESIDENTIAL	16 LEAD	7.6 ENL. HOUSE	3.4 FROM HSE. FRONT	-
#200 RAVELSTON AVE. E. RESIDENTIAL	19 COPPER	5.2 N.S. HSE. LINE	5.1 FROM HSE. FRONT	-

WARNING

IF POWER EQUIPMENT OR EXPLOSIVES ARE TO BE USED FOR EXCAVATION ON THIS PROJECT THE CONTRACTOR MUST:
 1) NOTIFY THE GAS COMPANY OF THE PROPOSED LOCATION OF EXCAVATION.
 2) TAKE PRECAUTION TO AVOID DAMAGE TO GAS COMPANY INSTALLATIONS.
 SEE PROVINCIAL REGULATION 140/92 FOR DETAILS.

METRIC

WHOLE NUMBERS INDICATE MILLIMETRES
 DECIMALIZED NUMBERS INDICATE METRES

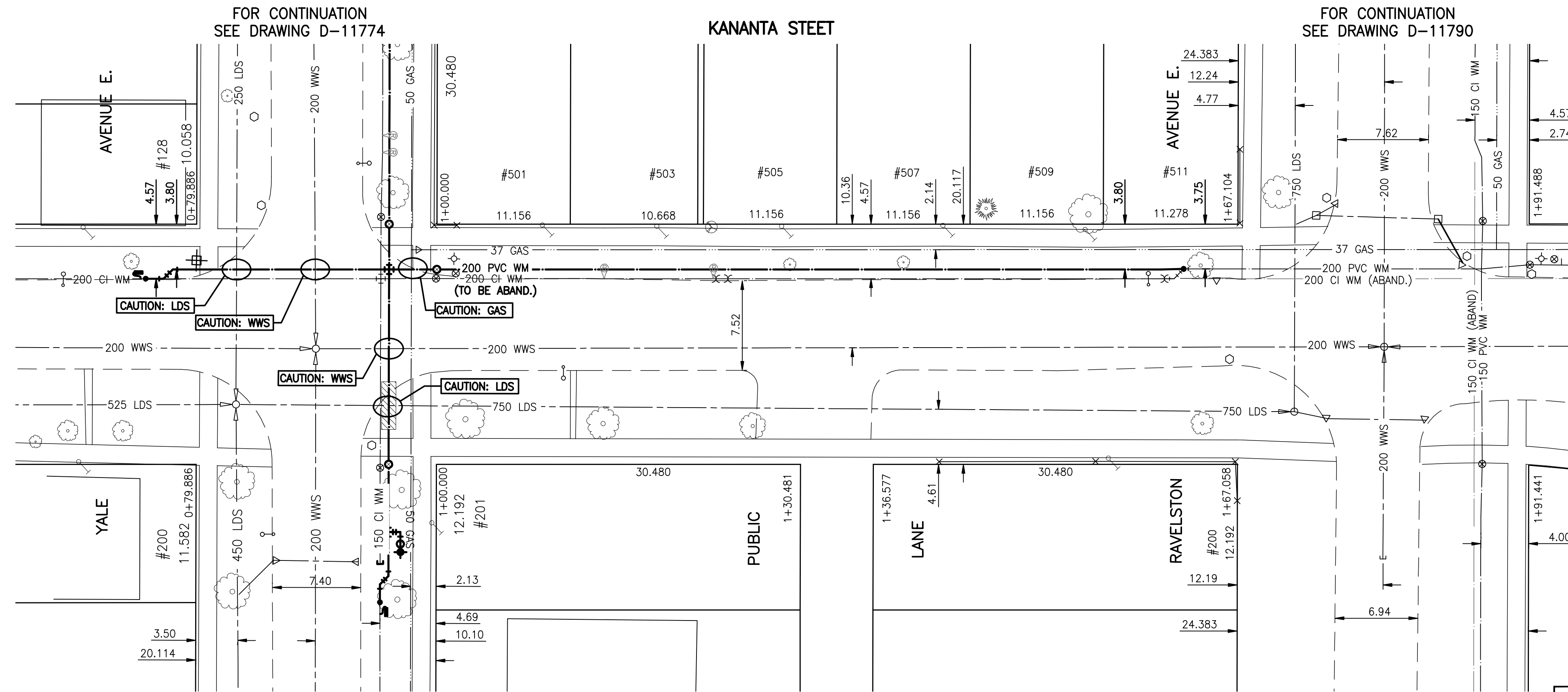

BENCH MARK: 87R494 - S.W. Cor. Ravelston Ave. W. & Day St., Tblt. on top of 0.05m dia. x 2.4m iron tube, 7.0 m N. of S.L. Ravelston Ave. W. & 10.1 m E. of W.L. Day St.

NOTE: STATIONS ALONG W P. OF KANATA ST.

BID OPPORTUNITY 311-2009



WATERMAIN		HYDRO		WATERMAIN	
EXISTING	PROPOSED	EXISTING	PROPOSED	EXISTING	PROPOSED
150 WM	150 WM	HYDRANT	M.T.S.	150 WM	HYDRANT, VALVE
300 LDS	300 LDS	CONCRETE	ASPHALT	300 LDS	LAND DRAINAGE SEWER
250 WWS	250 WWS	SIDEWALK	PROPERTY LINE	250 WWS	WASTE WATER SEWER
MANHOLE	MANHOLE	SURVEY BAR	DITCH	250 WWS	Q PROFILE
CATCH BASIN	CATCH BASIN	CURB STOP	TREE	250 WWS	NORTH OR WEST GUTTER
CURB INLET	CURB INLET	FENCE		250 WWS	SOUTH OR EAST GUTTER
JUNCTIONS	JUNCTIONS			250 WWS	NORTH OR WEST R.
STREET REHABILITATION LIMIT	STREET REHABILITATION LIMIT			250 WWS	SOUTH OR EAST R.
GAS	GAS			250 WWS	NORTH OR WEST DITCH
				250 WWS	SOUTH OR EAST DITCH

LOCATION APPROVED UNDERGROUND STRUCTURES

SUPV. U/G STRUCTURES COMMITTEE	DATE

NOTE: LOCATION OF UNDERGROUND STRUCTURES AS SHOWN ARE BASED ON THE BEST INFORMATION AVAILABLE BUT NO GUARANTEE IS GIVEN THAT ALL EXISTING UTILITIES ARE SHOWN OR THAT THE GIVEN LOCATIONS ARE EXACT. CONFIRMATION OF EXISTENCE AND EXACT LOCATION OF ALL SERVICES MUST BE OBTAINED FROM THE INDIVIDUAL UTILITIES BEFORE PROCEEDING WITH CONSTRUCTION.

NO.	REVISIONS	DATE	BY

Stantec Consulting Ltd.
 905 Waverley Street, Winnipeg, Manitoba
 Tel 204-489-5900 Fax 204-453-9012

ENGINEER'S SEAL

DESIGNED BY: J.K.H.	CHECKED BY: H.A.K.
DRAWN BY: J.K.H.	APPROVED BY: H.A.K.
HOR. SCALE: 1:250	RELEASED FOR CONSTRUCTION:
VERTICAL: 1:50	DATE:

THE CITY OF WINNIPEG
 WATER AND WASTE DEPARTMENT
 ENGINEERING DIVISION

2009 WATERMAIN RENEWALS - CONTRACT 5
KANATA STREET
 YALE AVE EAST TO
 4.50 SSL OF RAVELSTON AVENUE EAST

SHEET 13 OF 14
 CAD FILE DRAWING NUMBER: I1210c-213-711.dwg
 CITY DRAWING NUMBER: D-11775