

**ALLEY PAVEMENT PROFILE**

SCALE: 1:250 HOR  
1:10 VER

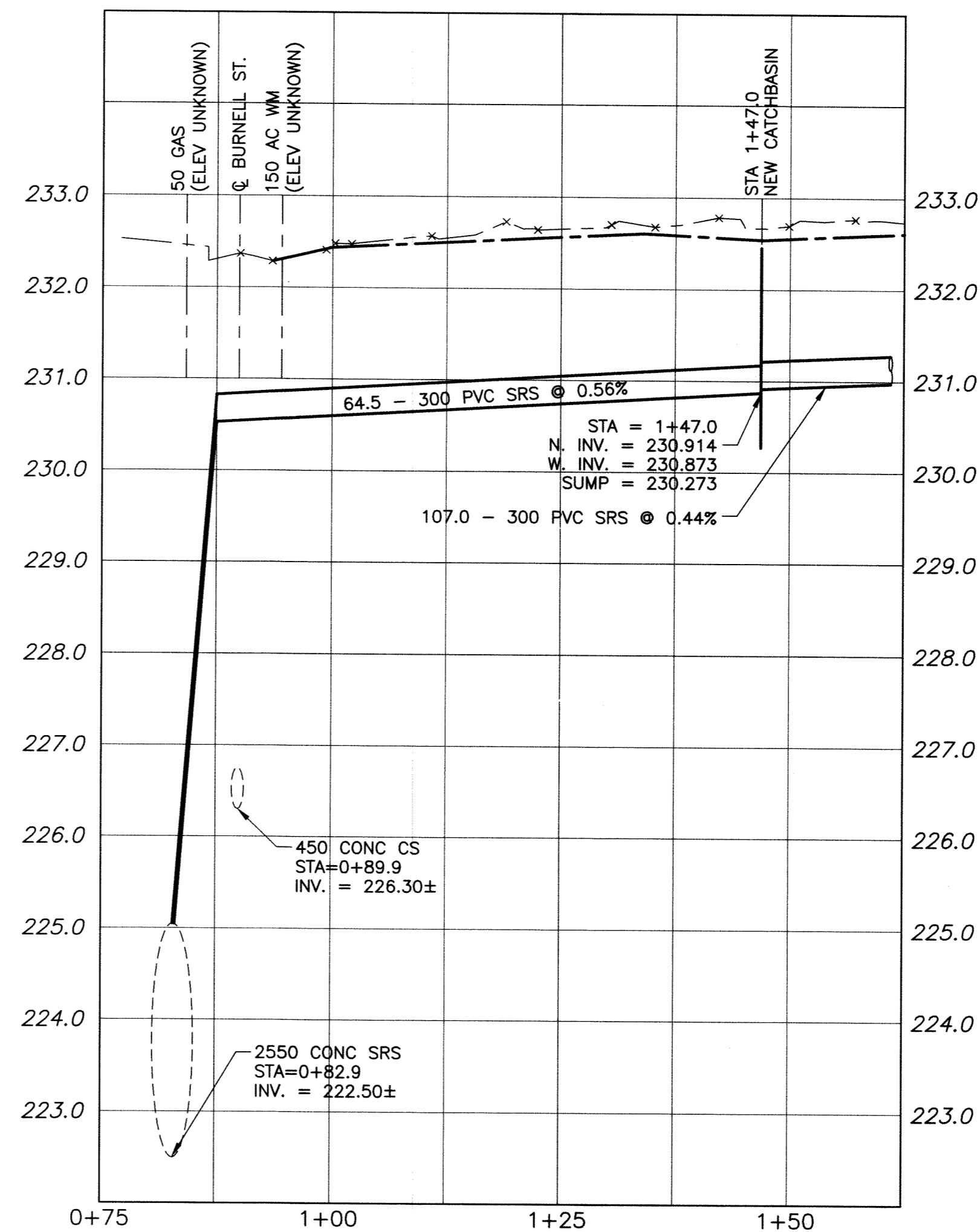

**CATCHBASIN & LEAD PROFILE**

SCALE: 1:500 HOR  
1:50 VER

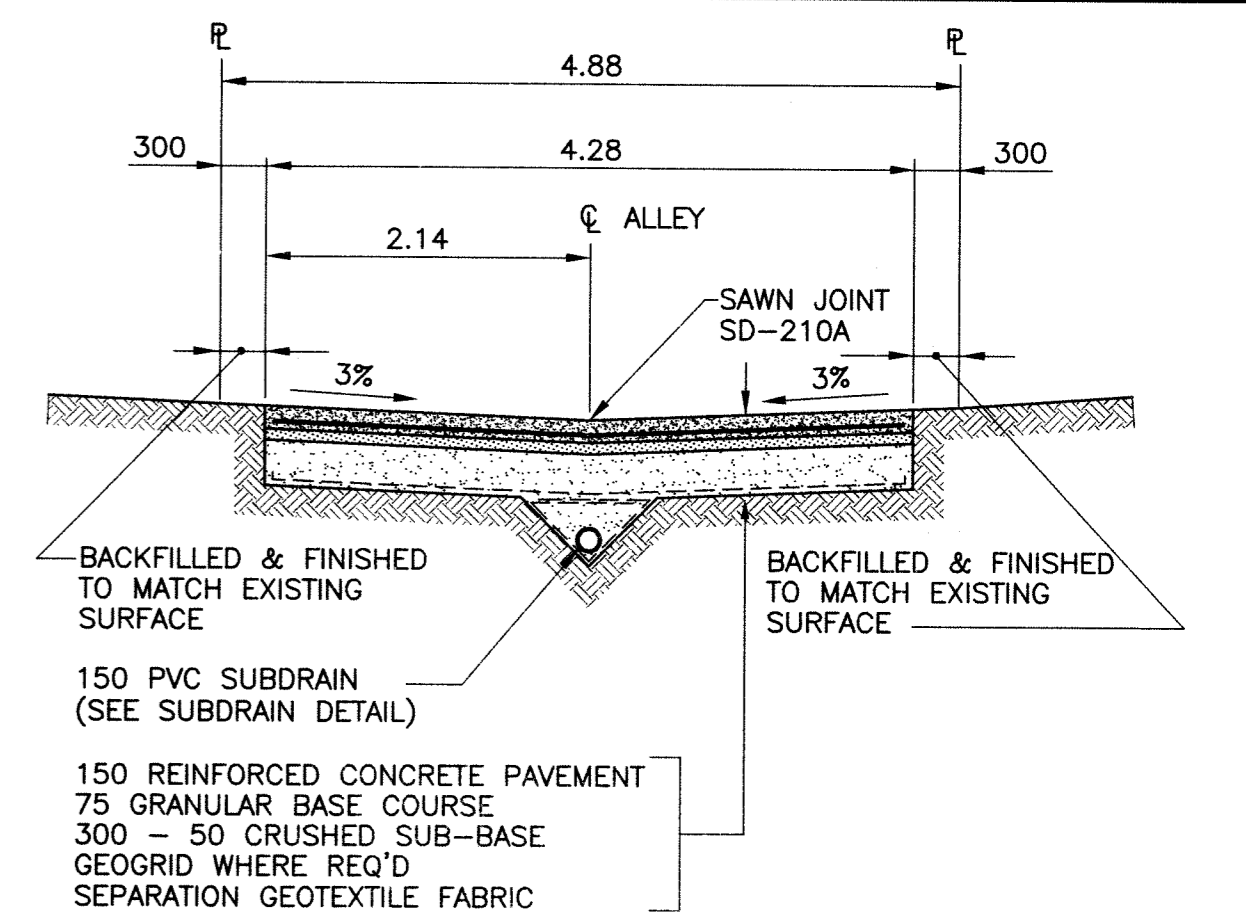

**TYPICAL CROSS SECTION**

SCALE: 1:50

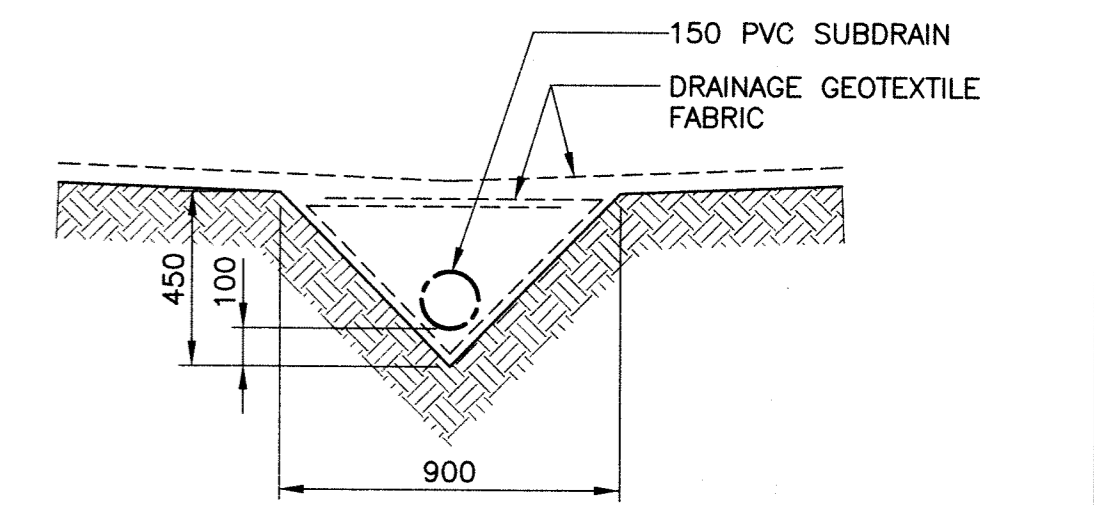

**SUBDRAIN DETAIL**

SCALE: 1:20

**NOTE:**

1. STATION CHAINAGE IS BASED ON CENTERLINE OF ALLEY RIGHT OF WAY.
2. ADJUST MH AND CB RIMS TO NEW GRADES.
3. PLUG SUBDRAINS AT TERMINAL ENDS.
4. REGRADE EXISTING PRIVATE SIDEWALKS AS REQUIRED.
5. INSTALLATION OF LIP CURBS AND THEIR EXTENTS TO BE DETERMINED BY THE CONTRACT ADMINISTRATOR.
6. LIGHT STANDARDS, HYDRO POLES AND ANCHORS MAY REQUIRE TEMPORARY SUPPORT/REMOVAL OR REPLACEMENT AT THE CONTRACTOR'S EXPENSE.
7. ISOLATE ALL POLES, BASES AND PILES WITHIN ALLEY RIGHT OF WAY (SD-228C).
8. AVOID DAMAGE TO EXISTING TREES WITHIN THE LIMITS OF CONSTRUCTION.
9. ELEVATION OF 50 GAS AND 150 AC WM ON BURNELL ST. IS UNKNOWN.
10. 300 PVC SRS TO BE INSTALLED USING TRENCHLESS METHODS FROM STA. 0.82.9 TO STA. 1+00.

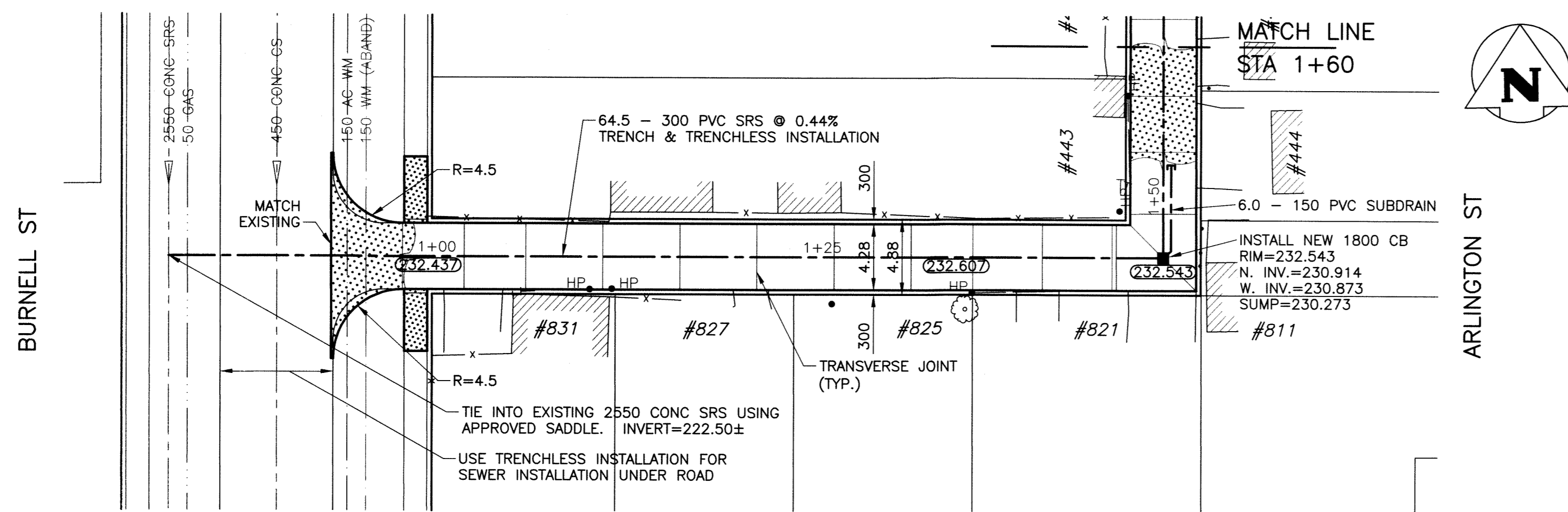

**ST. MATTHEWS AVE**

**ALLEY PAVEMENT PLAN**

SCALE: 1:250 HOR

**PROPERTY LIMITS DELINEATION**

DELINEATION OF PROPERTY LIMITS AS SHOWN ON THIS DWG DOES NOT REPRESENT A "LEGAL SURVEY". KGS GROUP MAKES NO REPRESENTATION OR WARRANTY AS TO THE ACCURACY OF PROPERTY LIMITS DELINEATED ON THIS DWG, NOR ON THE DIMENSIONAL ACCURACY OF DWG FEATURES RELATIVE TO THOSE PROPERTY LIMITS.

**WARNING**

1. NOTIFY THE GAS COMPANY OF THE PROPOSED LOCATION OF EXCAVATION.
2. TAKE PRECAUTION TO AVOID DAMAGE TO GAS COMPANY INSTALLATIONS.
3. SEE PROVINCIAL REGULATION 210/72 FOR DETAILS.

**METRIC**

WHOLE NUMBERS INDICATE MILLIMETRES  
DECIMALIZED NUMBERS INDICATE METRES

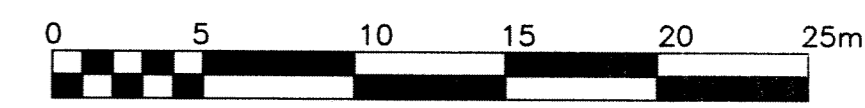
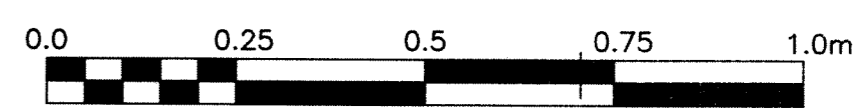
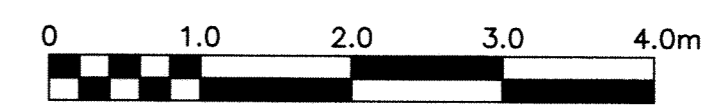

**APEGM**  
Certificate of Authorization  
KGS Group  
No. 245 Date: 06/05/09

300 LBS 250 WWS	LAND DRAINAGE SEWER WASTE WATER SEWER	300 LBS 250 WWS	CONCRETE JOINT TEST HOLE	EXISTING	PROPOSED	EXISTING	PROPOSED
---	GAS	---	GUY WIRE	---	---	---	---
---	HYDRO	---	LIGHT STANDARD	---	---	---	---
---	M.T.S.	---	BACK OF CURB	---	---	---	---
---	WATERMAIN	---	CONCRETE	---	---	---	---
---	HYDRANT	---	ASPHALT	---	---	---	---
---	VALVE	---	SIDEWALK	---	---	---	---
---	MANHOLE	---	PROPERTY LINE	---	---	---	---
---	CATCH BASIN	---	SURVEY BAR	---	---	---	---
---	CURB INLET	---	GEODETIC BENCHMARK	---	---	---	---
---	POLES	---	ELEVATION	---	---	---	---
---	LEGEND-PLAN	---	LEGEND-PLAN	---	---	---	---
---	PROPOSED	---	PROPOSED	---	---	---	---
---	EXISTING	---	EXISTING	---	---	---	---
---	LEGEND-PROFILE	---	LEGEND-PROFILE	---	---	---	---
---	PROPOSED	---	PROPOSED	---	---	---	---
---	EXISTING	---	EXISTING	---	---	---	---

LOCATION APPROVED  
UNDERGROUND STRUCTURES

SUPV. U/G STRUCTURES DATE COMMITTEE

NOTE:  
LOCATION OF UNDERGROUND STRUCTURES AS SHOWN ARE BASED ON THE BEST INFORMATION AVAILABLE BUT NO GUARANTEE IS GIVEN THAT ALL EXISTING UTILITIES ARE SHOWN OR CONFIRMATION OF EXISTENCE AND EXACT LOCATION OF ALL SERVICES MUST BE OBTAINED FROM THE INDIVIDUAL UTILITIES BEFORE PROCEEDING WITH CONSTRUCTION.

B.M. 37-027  
ELEV. 233.123

**KGS GROUP**  
CONSULTING ENGINEERS & PROJECT MANAGERS  
WINNIPEG (204) 896-1209  
THUNDER BAY (807) 345-2233

DESIGNED BY: JDF	CHECKED BY: RJH
DRAWN BY: GEL	APPROVED BY:
HOR. SCALE: 1:250	RELEASED FOR CONSTRUCTION:
VERTICAL: 1:50	DATE: 17/11/08
NO. REVISIONS	DATE BY

ENGINEER'S SEAL  
PROVINCE OF MANITOBA  
**R.J. HOUSTON**  
REGISTERED PROFESSIONAL ENGINEER  
CONSULTANT DRAWING NO. 09-0107-03

**THE CITY OF WINNIPEG**  
PUBLIC WORKS DEPARTMENT  
TRANSPORTATION ENGINEERING DIVISION  
PROJECT TITLE: 2009 ALLEY RENEWAL PROGRAM  
SHEET OF 04 15  
BURNELL ST./ARLINGTON ST. ALLEY  
ST. MATTHEWS AVE. TO ELLICE AVE  
STA. 1+00.0 TO STA. 1+60.0  
COMPUTER FILE NAME: BURNELL-ARLINGTON-PL0T  
CITY DRAWING NUMBER: 0004