

B SIZE 11" x 17" (279mm x 432mm)

PLOT: 7/22/2009 10:07:45 AM

FILE NAME: D265-244-01\_01-C-1009\_RX.dwg Saved By: berarok

**BOSTON AVENUE**

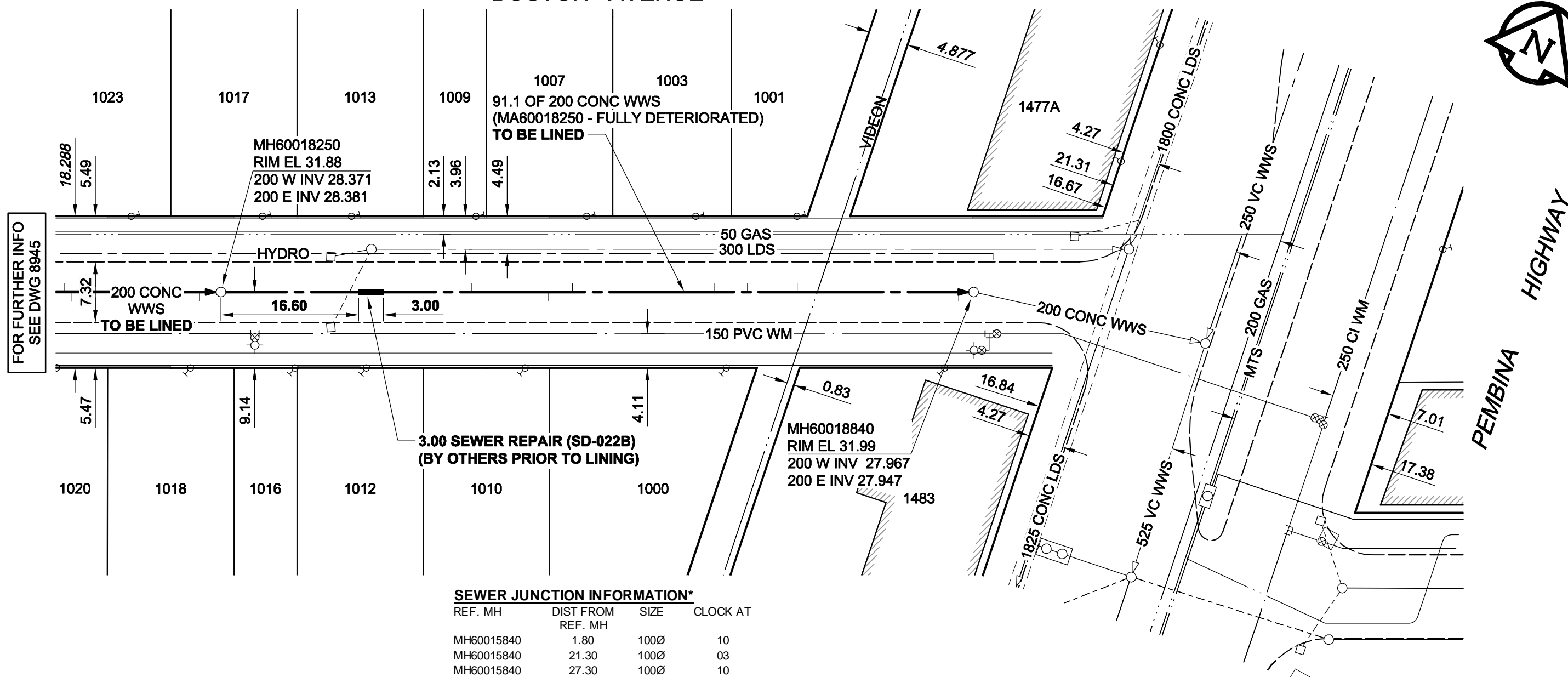
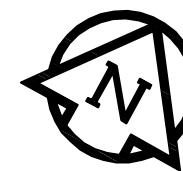

FOR FURTHER INFO  
SEE DWG 8945

**SEWER JUNCTION INFORMATION\***

REF. MH	DIST FROM REF. MH	SIZE	CLOCK AT
MH60015840	1.80	100Ø	10
MH60015840	21.30	100Ø	03
MH60015840	27.30	100Ø	10
MH60015840	31.30	100Ø	02
MH60015840	48.40	100Ø	02
MH60015840	51.30	100Ø	10
MH60015840	60.60	100Ø	03

\*JUNCTION INFORMATION FROM VIDEO INSPECTION

**AECOM**  
Certificate of Authorization  
AECOM Canada Ltd.  
No. 4671 Date: 09/07/21

**METRIC**  
WHOLE NUMBERS INDICATE MILLIMETRES  
DECIMALIZED NUMBERS INDICATE METRES

**WARNING**

IF POWER EQUIPMENT OR EXPLOSIVES ARE TO BE USED FOR EXCAVATION ON THIS PROJECT, THE CONTRACTOR MUST:  
1) NOTIFY THE GAS COMPANY OF THE PROPOSED LOCATION OF EXCAVATION.  
2) TAKE PRECAUTION TO AVOID DAMAGE TO GAS COMPANY INSTALLATIONS.  
SEE PROVINCIAL REGULATION 140/92 FOR DETAILS

BID OPPORTUNITY NO. 372-2009

**LOCATION APPROVED UNDERGROUND STRUCTURES**

SUPR. U/G STRUCTURES DATE COMMITTEE

**NOTE:**  
LOCATION OF UNDERGROUND STRUCTURES AS SHOWN ARE BASED ON THE BEST INFORMATION AVAILABLE. BUT NO GUARANTEE IS GIVEN THAT ALL EXISTING UTILITIES ARE SHOWN OR THAT THE GIVEN LOCATIONS ARE EXACT. CONFIRMATION OF EXISTENCE AND EXACT LOCATION OF ALL SERVICES MUST BE OBTAINED FROM THE INDIVIDUAL UTILITIES BEFORE PROCEEDING WITH CONSTRUCTION.

NO.	REVISIONS	YY/MM/DD	BY
0	ISSUED FOR CONSTRUCTION	09/07/21	KMB

**AECOM**

DESIGNED BY ALD  
DRAWN BY GDL  
HOR. SCALE 1:500  
VERT. SCALE N/A  
DATE 09/07/21

CHECKED BY PL  
APPROVED BY BRYAN WEBER  
RELEASED FOR CONSTRUCTION KZ  
DATE JULY 21/09

PROFESSIONAL'S SEAL

ISSUED FOR CONSTRUCTION WAS SEALED BY C. C. MACEY AND DATED 09/07/21

CONSULTANT DRAWING NO. D265-244-01\_01-C-1009\_RX.dwg

**THE CITY OF WINNIPEG WATER AND WASTE DEPARTMENT**

**2009 WASTE WATER SEWER RENEWALS BY CIPP LINING CONTRACT 16**

**BOSTON AVENUE**  
161m E OF HUDSON STREET TO PEMBINA HIGHWAY

SHEET 9 OF 52  
CITY DRAWING NUMBER 8946  
REV 0