

B SIZE 11" x 17" (279mm x 432mm)

PLOT: 7/30/2009 3:57:56 PM

FILE NAME: D265-244-02_01-C-1021_RX.dwg Saved By: berarok

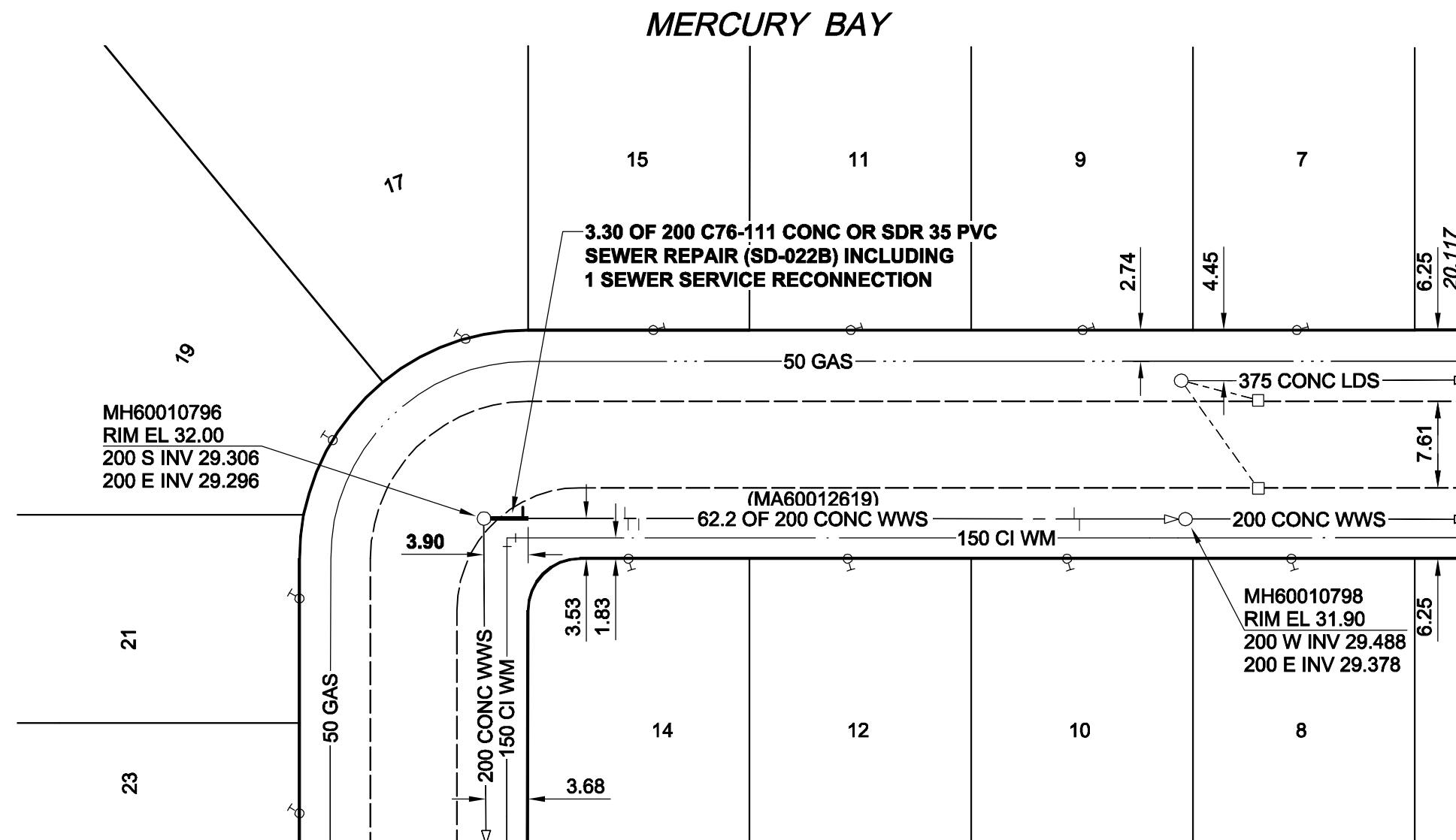
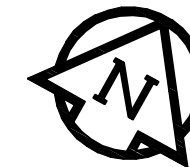

SEWER JUNCTION INFORMATION*

REF. MH	DIST FROM REF. MH	SIZE	CLOCK AT
MH60010796	3.4	150Ø	09
MH60010796	12.4	150Ø	10
MH60010796	12.7	150Ø	02
MH60010796	13.6	100Ø	03
MH60010796	32.2	100Ø	03
MH60010796	32.6	150Ø	10
MH60010796	51.9	150Ø	10
MH60010796	52.4	100Ø	02

*JUNCTION INFORMATION FROM VIDEO INSPECTION

CONSTRUCTION NOTES:

1. CONTRACTOR TO VERIFY LIMITS OF SEWER REPAIRS PRIOR TO EXCAVATION BY MEANS OF VIDEO INSPECTION.
2. CONTRACTOR TO PROVIDE VIDEO INSPECTION OF SEWER SERVICES WITHIN LIMITS OF REPAIR IN PRESENCE OF CONTRACT ADMINISTRATOR TO DETERMINE IF SERVICE RENEWAL IS REQUIRED.
3. ALL BACKFILL TO BE CLASS 5 BACKFILL UNDER BOULEVARDS AND CLASS 3 UNDER OR WITHIN 1.0m OF PAVEMENTS AND SIDEWALKS.

WARNING

IF POWER EQUIPMENT OR EXPLOSIVES ARE TO BE USED FOR EXCAVATION ON THIS PROJECT, THE CONTRACTOR MUST:
 1) NOTIFY THE GAS COMPANY OF THE PROPOSED LOCATION OF EXCAVATION.
 2) TAKE PRECAUTION TO AVOID DAMAGE TO GAS COMPANY INSTALLATIONS.
 SEE PROVINCIAL REGULATION 140/92 FOR DETAILS



Certificate of Authorization

AECOM Canada Ltd.

No. 4671 Date: 09/07/29

METRIC
 WHOLE NUMBERS INDICATE MILLIMETRES
 DECIMALIZED NUMBERS INDICATE METRES

BID OPPORTUNITY NO. 374-2009

LOCATION APPROVED UNDERGROUND STRUCTURES

SUPR. U/G STRUCTURES DATE COMMITTEE

NOTE:
 LOCATION OF UNDERGROUND STRUCTURES AS SHOWN ARE BASED ON THE BEST INFORMATION AVAILABLE. BUT NO GUARANTEE IS GIVEN THAT ALL EXISTING UTILITIES ARE SHOWN OR THAT THE GIVEN LOCATIONS ARE EXACT. CONFIRMATION OF EXISTENCE AND EXACT LOCATION OF ALL SERVICES MUST BE OBTAINED FROM THE INDIVIDUAL UTILITIES BEFORE PROCEEDING WITH CONSTRUCTION.

BM 65-015 N. side Somerville Ave., E. of Planet St., ELEV 232.691m Tbt. in E. Conc. foundation of No. 1431 Somerville Ave., 1.0m N. & 0.3m below stucco of S.E. Cor. of house.			
NO.	ISSUED FOR CONSTRUCTION	09/07/24	KMB
NO.	REVISIONS	YY/MM/DD	BY

AECOM © 2009 AECOM Canada Ltd. All Rights Reserved. This document is protected by copyright law and may not be used, reproduced or modified in any manner or for any purpose except with the written permission of AECOM Canada Ltd. ("AECOM") or a party to which its copyright has been assigned. AECOM accepts no responsibility, and denies any liability whatsoever, to any party that uses, reproduces, modifies, or relies on this document without AECOM's express written consent.			
DESIGNED BY	PL	CHECKED BY	ALD
DRAWN BY	GDL	APPROVED BY	KWF
HOR. SCALE	1:500	RELEASED FOR CONSTRUCTION	KZ
VERT. SCALE	N/A	DATE	July 30/09
DATE	09/07/29	DATE	July 30/09

PROFESSIONAL'S SEAL
 ISSUED FOR CONSTRUCTION
 WAS SEALED BY
 K. W. FITCHETT
 AND DATED
 JULY 29/09
 CONSULTANT DRAWING NO.
 D265-244-02_01-C-1021_RX.dwg

THE CITY OF WINNIPEG WATER AND WASTE DEPARTMENT

2009 WASTE WATER SEWER RENEWALS BY REPAIRS AND REPLACEMENTS CONTRACT 18

MERCURY BAY (N LEG)
 MERCURY BAY (W LEG)
 TO 53m W OF PLANET STREET

SHEET 21 OF 35
 CITY DRAWING NUMBER
8891 REV 0