

WATERFORD AVENUE

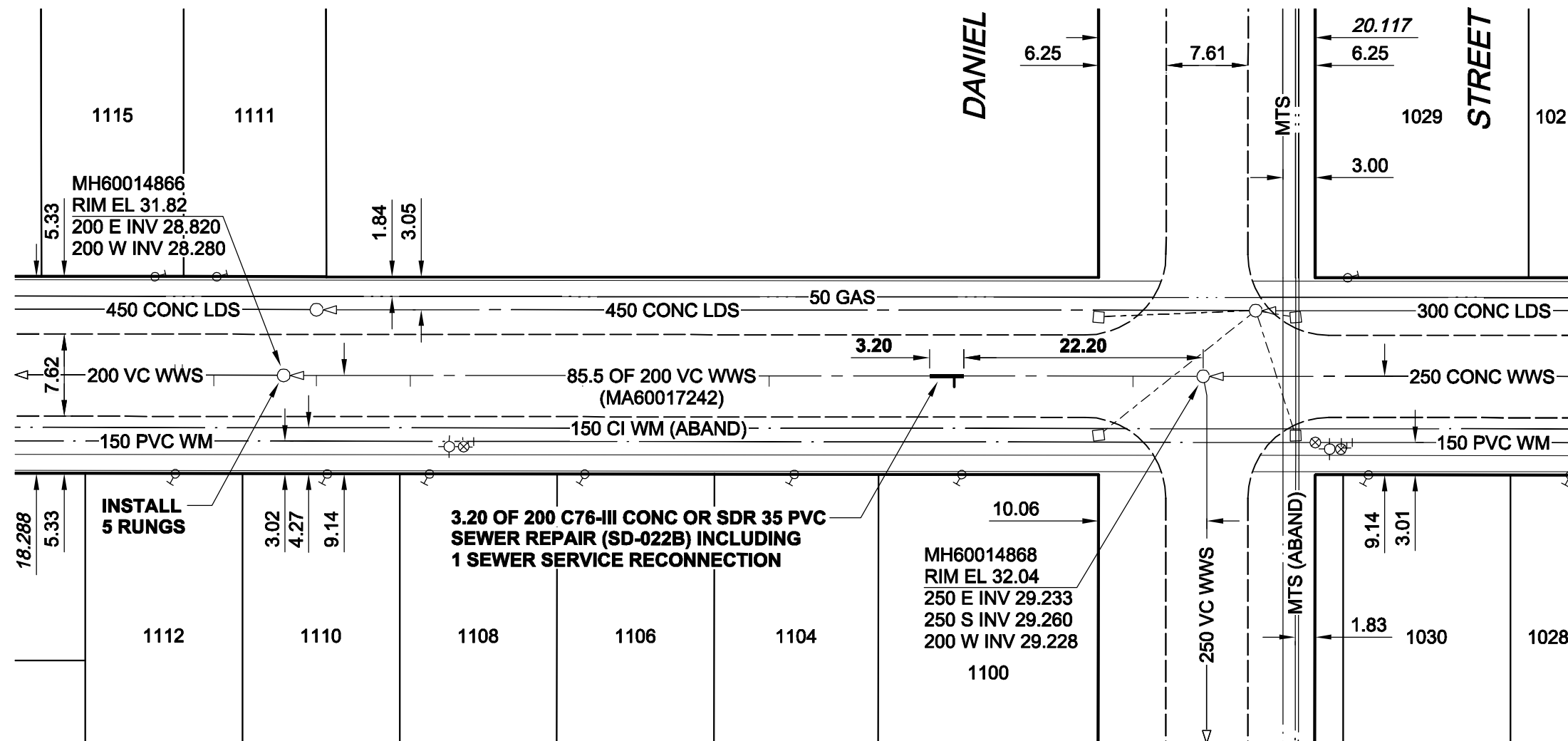

SEWER JUNCTION INFORMATION*

REF. MH	DIST FROM REF. MH	SIZE	CLOCK AT
MH60014868	6.50	150Ø	11
MH60014868	23.10	150Ø	09
MH60014868	40.30	150Ø	09
MH60014868	57.60	150Ø	10
MH60014868	73.60	150Ø	10
MH60014868	82.30	150Ø	09

*JUNCTION INFORMATION FROM VIDEO INSPECTION

CONSTRUCTION NOTES:

1. CONTRACTOR TO VERIFY LIMITS OF SEWER REPAIRS PRIOR TO EXCAVATION BY MEANS OF VIDEO INSPECTION.
2. CONTRACTOR TO PROVIDE VIDEO INSPECTION OF SEWER SERVICES WITHIN LIMITS OF REPAIR IN PRESENCE OF CONTRACT ADMINISTRATOR TO DETERMINE IF SERVICE RENEWAL IS REQUIRED.
3. ALL BACKFILL TO BE CLASS 5 BACKFILL UNDER BOULEVARDS AND CLASS 3 UNDER OR WITHIN 1.0m OF PAVEMENTS AND SIDEWALKS.

WARNING

IF POWER EQUIPMENT OR EXPLOSIVES ARE TO BE USED FOR EXCAVATION ON THIS PROJECT, THE CONTRACTOR MUST:
 1) NOTIFY THE GAS COMPANY OF THE PROPOSED LOCATION OF EXCAVATION.
 2) TAKE PRECAUTION TO AVOID DAMAGE TO GAS COMPANY INSTALLATIONS.
 SEE PROVINCIAL REGULATION 140/92 FOR DETAILS



Certificate of Authorization

AECOM Canada Ltd.

No. 4671 Date: 09/07/29

METRIC

WHOLE NUMBERS INDICATE MILLIMETRES
 DECIMALIZED NUMBERS INDICATE METRES

BID OPPORTUNITY NO. 374-2009

LOCATION APPROVED UNDERGROUND STRUCTURES

SUPR. U/G STRUCTURES DATE COMMITTEE

NOTE:
 LOCATION OF UNDERGROUND STRUCTURES AS SHOWN ARE BASED ON THE BEST INFORMATION AVAILABLE. BUT NO GUARANTEE IS GIVEN THAT ALL EXISTING UTILITIES ARE SHOWN OR THAT THE GIVEN LOCATIONS ARE EXACT. CONFIRMATION OF EXISTENCE AND EXACT LOCATION OF ALL SERVICES MUST BE OBTAINED FROM THE INDIVIDUAL UTILITIES BEFORE PROCEEDING WITH CONSTRUCTION.

NO.	REVISIONS	YY/MM/DD	BY
0	ISSUED FOR CONSTRUCTION	09/07/24	KMB



© 2009 AECOM Canada Ltd. All Rights Reserved. This document is protected by copyright law and may not be used, reproduced or modified in any manner or for any purpose except with the written permission of AECOM Canada Ltd. ("AECOM") or a party to which its copyright has been assigned. AECOM accepts no responsibility, and denies any liability whatsoever, to any party that uses, reproduces, modifies, or relies on this document without AECOM's express written consent.

DESIGNED BY	PL	CHECKED BY	ALD
DRAWN BY	KMB	APPROVED BY	KWF
HOR. SCALE	1:500	RELEASED FOR CONSTRUCTION	KZ
VERT. SCALE	N/A	DATE	July 30/09
DATE	09/07/29	DATE	July 30/09

PROFESSIONAL'S SEAL

ISSUED FOR CONSTRUCTION
 WAS SEALED BY
 K. W. FITCHETT
 AND DATED
 JULY 29/09

CONSULTANT DRAWING NO.
 D265-244-02_01-C-1033_RX.dwg



THE CITY OF WINNIPEG WATER AND WASTE DEPARTMENT

2009 WASTE WATER SEWER RENEWALS BY REPAIRS AND REPLACEMENTS CONTRACT 18

WATERFORD AVENUE
 52m E OF BEAUMONT STREET
 TO DANIEL STREET

SHEET 33 OF 35

CITY DRAWING NUMBER

8903

REV
 0