

HOUSE WATER SERVICES INFORMATION					
ADDRESS & NATURE	SIZE (mm) & TYPE	SHORT & LONG MEASUREMENT	CORP LOCATION	REMARKS	
178 Clonard Avenue Residential	13 Copper	2.1 L OF R 709.9 E/E/L OF ST ANNES		LEAD SERVICE	
181 Clonard Avenue Residential	13 Lead	8.5 L OF R 714.8 E/E/L OF ST ANNES			
182 Clonard Avenue Residential		1.2 L OF R SDIWK 724.2 E/E/L OF ST ANNES			
185 Clonard Avenue Residential	13 Copper	9.4 L OF R 727.3 E/E/L OF ST ANNES			
186 Clonard Avenue Residential	13 Copper	1.2 L OF R 737.6 E/E/L OF ST ANNES			
190 Clonard Avenue Residential	19 Copper	0.9 R OF R 748.9 E/E/L OF ST ANNES			

CHAINAGE ALONG SOUTH PROPERTY LINE OF CLONARD AVENUE

CLONARD AVENUE

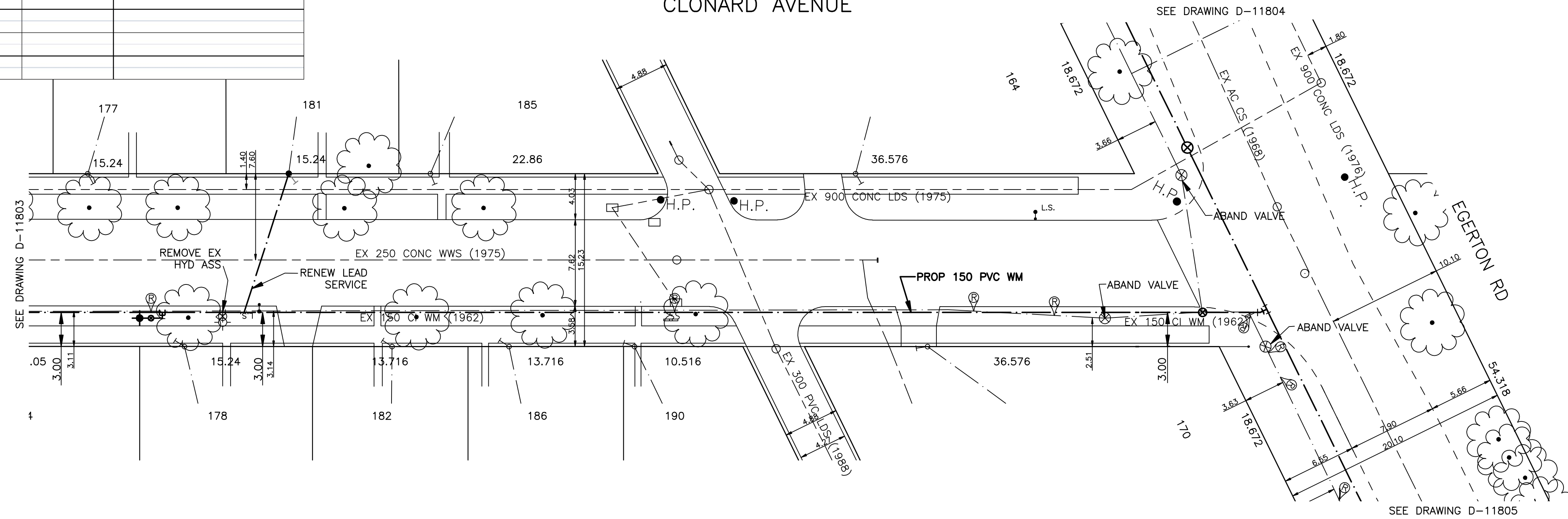

- NOTES:**
- ALL GATE VALVES ARE COUNTER-CLOCKWISE TO OPEN WITH A BLACK OPERATING NUT.
 - WATERMAIN TO BE INSTALLED BY TRENCHLESS METHODS.
 - BACKFILL IS CLASS 5 WITHIN BOULEVARD AND CLASS 3 WHEN WITHIN PAVEMENT/SIDEWALK OR WHEN WITHIN 1.0m OF PAVEMENT OR SIDEWALK.
 - WATER SERVICES ARE 19mm UNLESS OTHERWISE NOTED.
 - MINIMUM COVER TO TOP OF WATERMAIN SHALL BE 2.4m.
 - LOCATION OF ALL SERVICES TO BE CONFIRMED IN FIELD.
 - EXPOSE EXISTING WATERMAIN TO CONFIRM DEPTH PRIOR TO CONSTRUCTION.
 - ALL LEAD SERVICES TO BE RENEWED TO PROPERTY LINE.
 - SERVICES TO BE RENEWED SHALL BE REPLACED FROM WATERMAIN TO PROPERTY LINE. ALL OTHERS TO BE RECONNECTED.

EXISTING	LEGEND - PLAN	PROPOSED	EXISTING	LEGEND - PLAN	PROPOSED	EXISTING	LEGEND - PROFILE	PROPOSED
—	WATERMAIN	—	—	REDUCER	—	—	150mm W.W.	—
—	HYDRANT VALVE	—	—	PLUG	—	—	WATERMAIN VALVE	—
—	LAND DRAINAGE SEWER	—	—	TRAFFIC SIGNAL	—	—	LAND DRAINAGE SEWER	—
—	WASTE WATER SEWER	—	—	GAS	—	—	WASTE WATER SEWER	—
○	MANHOLE	●	—	HYDRO	—	—	JUNCTIONS	—
□	CATCH BASIN	■	—	M.T.S.	—	—	CULVERT	—
△	CURB INLET	▲	—	SURVEY BAR	—	—		
—	TEE	—	—	CURB STOP	—	—		
—	BEND	—	—	C.B. LEAD	—	—		
—	ANODE	—	—	TREE	—	—		
—		—	—	LAMP STANDARD	—	—		

LOCATION APPROVED

SUPPLY, U/G STRUCTURES COMMITTEE

NOTE: LOCATION OF UNDERGROUND STRUCTURES AS SHOWN ARE BASED ON THE BEST INFORMATION AVAILABLE BUT NO GUARANTEE IS GIVEN THAT ALL EXISTING UTILITIES ARE SHOWN OR THAT THE GIVEN LOCATIONS ARE EXACT. CONFIRMATION OF EXISTENCE AND EXACT LOCATION OF ALL SERVICES MUST BE OBTAINED FROM THE INDIVIDUAL UTILITIES BEFORE PROCEEDING WITH CONSTRUCTION.

B.N. ELEV. 54-002 231.653

GENIVAR

10 PRAIRIE WAY WINNIPEG, MANITOBA R2J 3J6
PH: (204)-477-8650 FAX: (204)-474-2884

DESIGNED BY: DJ
CHECKED BY: AB
DRAWN BY: AB
APPROVED BY: SM

HOR. SCALE: 1:250
VERT. SCALE: 1:50

RELEASED FOR CONSTRUCTION
SIGNED BY: K. ZUREK P. ENG
DATE: MAY 25, 2009

ENGINEERS SEAL

PROVINCE OF MANITOBA
REGISTERED PROFESSIONAL ENGINEER

I. G. MCKINNON

CONSULTANT DRAWING NO. 09-049-06

THE CITY OF WINNIPEG
WATER AND WASTE DEPARTMENT

2009 CAPITAL WORKS
WATERMAIN RENEWALS
CLONARD AVENUE
EGERTON ROAD TO
90M WEST OF EGERTON ROAD

SHEET 1 OF 4
CITY DRAWING NO. D-11802

APR 2004

APECN
Certificate of Authorization
GENIVAR Consultants
No. 4318 Expiry: April 30, 2010

METRIC
WHOLE NUMBERS INDICATE MILLIMETRES
DECIMALIZED NUMBERS INDICATE METRES