

HOUSE WATER SERVICE INFORMATION					
ADDRESS & NATURE OF SERVICE	SIZE (mm) & TYPE	SHORT & LONG MEASUREMENT	CORP LOCATION	REMARKS	
79 Parkville Drive Residential	19 Copper	0.9 WEHL			
80 Parkville Drive Residential	19 Copper	1.2 WWHL		DR/WY 72	
81 Parkville Drive Residential	19 Copper	2.3 EEHL			
82 Parkville Drive Residential	19 Copper	5.9 E OF W 10.4 FROM BLDG		DR/WY/82 SEWER/81 RECORD ONLY-RENEWED BROKEN S/C BOX	
83 Parkville Drive Residential	19 Copper	5.2 EWHL		DR/WY/82 SEWER/82	
85 Parkville Drive Residential	19 Copper	4.9 WEHL		DR/WY/82 SEWER/82	
86 Parkville Drive Residential	19 Copper	8.8 EWHL		DR/WY 0199 SEWER/82	
87 Parkville Drive Residential	19 Copper	ON WHL		DR/WY/81 SEWER/81	
89 Parkville Drive Residential	19 Copper	1.2 WWHL GAR LINE ATT TO HSE			
90 Parkville Drive Residential	19 Copper	4.3 WEHL		DR/WY 80	
92 Parkville Drive Residential	19 Copper	5.8 EWHL			

CHAINAGE ALONG SOUTH PROPERTY LINE OF PARKVILLE DRIVE
PARKVILLE DRIVE

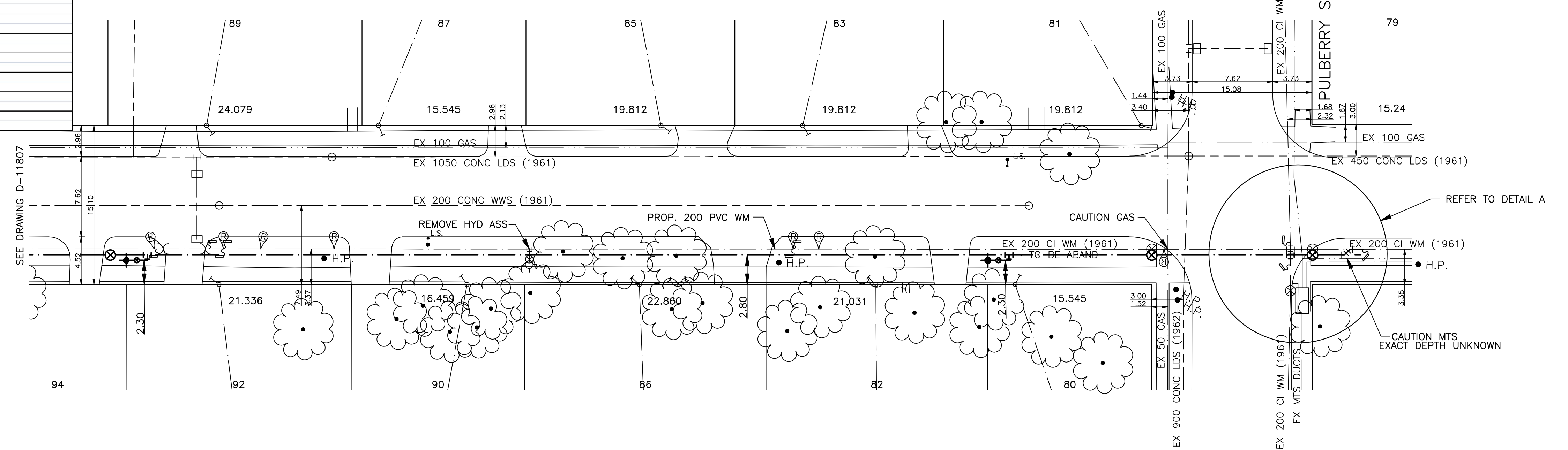

- NOTES:**
- ALL GATE VALVES ARE COUNTER-CLOCKWISE TO OPEN WITH A BLACK OPERATING NUT.
 - WATERMAIN TO BE INSTALLED BY TRENCHLESS METHODS.
 - BACKFILL IS CLASS 5 WITHIN BOULEVARD AND CLASS 3 WHEN WITHIN PAVEMENT/SIDEWALK OR WHEN WITHIN 1.0m OF PAVEMENT OR SIDEWALK.
 - WATER SERVICES ARE 19mm UNLESS OTHERWISE NOTED.
 - MINIMUM COVER TO TOP OF WATERMAIN SHALL BE 2.4m.
 - LOCATION OF ALL SERVICES TO BE CONFIRMED IN FIELD.
 - EXPOSE EXISTING WATERMAIN TO CONFIRM DEPTH PRIOR TO CONSTRUCTION.
 - ALL LEAD SERVICES TO BE RENEWED TO PROPERTY LINE.
 - SERVICES TO BE RENEWED SHALL BE REPLACED FROM WATERMAIN TO PROPERTY LINE. ALL OTHERS TO BE RECONNECTED.

EXISTING	LEGEND - PLAN	PROPOSED	EXISTING	LEGEND - PLAN	PROPOSED	EXISTING	LEGEND - PROFILE	PROPOSED
—	WATERMAIN	—	—	REDUCER	—	—	150mm W.W.	—
—	HYDRANT VALVE	—	—	PLUG	—	—	WATERMAIN VALVE	—
—	LAND DRAINAGE SEWER	—	—	TRAFFIC SIGNAL	—	—	LAND DRAINAGE SEWER	—
—	WASTE WATER SEWER	—	—	GAS	—	—	WASTE WATER SEWER	—
—	MANHOLE	—	—	HYDRO	—	—	JUNCTIONS	—
—	CATCH BASIN	—	—	M.T.S.	—	—	CULVERT	—
—	CURB INLET	—	—	SURVEY BAR	—	—		—
—	TEE	—	—	CURB STOP	—	—		—
—	BEND	—	—	C.B. LEAD	—	—		—
—	ANODE	—	—	TREE	—	—		—
—		—	—	LAMP STANDARD	—	—		—

LOCATION APPROVED

SUPV. U/G STRUCTURES COMMITTEE

NOTE: LOCATION OF UNDERGROUND STRUCTURES AS SHOWN ARE BASED ON THE BEST INFORMATION AVAILABLE BUT NO GUARANTEE IS GIVEN THAT ALL EXISTING UTILITIES ARE SHOWN OR THAT THE GIVEN LOCATIONS ARE EXACT. CONFIRMATION OF EXISTENCE AND EXACT LOCATION OF ALL SERVICES MUST BE OBTAINED FROM THE INDIVIDUAL UTILITIES BEFORE PROCEEDING WITH CONSTRUCTION.

B.N. ELEV. 63-036 231.843

DESIGNED BY AB CHECKED BY DJ
DRAWN BY AB APPROVED BY SM

HOR. SCALE: 1:250
VERT. SCALE: 1:50

RELEASED FOR ORIGINAL CONSTRUCTION
SIGNED BY K. ZUREK P. ENG
DATE MAY 25, 2009

CONSULTANT DRAWING NO. 09-049-12

GENIVAR
10 PRAIRIE WAY WINNIPEG, MANITOBA R2J 3J8
PH: (204)-477-6850 FAX: (204)-474-2864

ENGINEERS SEAL
I. G. MCKINNON
REGISTERED PROFESSIONAL ENGINEER

THE CITY OF WINNIPEG
WATER AND WASTE DEPARTMENT

2009 CAPITAL WORKS
WATERMAIN RENEWALS
PARKVILLE DRIVE
166M EAST OF WEAVER BAY TO
PULBERRY STREET

SHEET 3 OF 3
CITY DRAWING NO. D-11808

GENIVAR Consultants
No. 4318 Expiry: April 30, 2009