

HOUSE WATER RENEWAL INFORMATION					
ADDRESS & NATURE OF SERVICE	SIZE (mm) & TYPE	SHORT & LONG MEASUREMENT	CORP LOCATION	REMARKS	
36 Falconer Bay Residential	19 Copper	6.1 LRHL		DR/WY A5221 C4867 AERIAL INSTALLED 79	
39 Falconer Bay Residential	19 Copper	5.2 RLHL		DR/WY A4679 C4380 SWR 150mm CONC. SWIMMING POOL-5	
40 Falconer Bay Residential	19 Copper	5.6 R OF L		DR/WY A4453 C4381 SWR 74 E3978	
43 Falconer Bay Residential	19 Copper	7.8 R OF L		DR/WY A4458 C4382 SWR 150mm CONC	
44 Falconer Bay Residential	19 Copper	6.1 LRHL		DR/WY A5283 C4392	

CHAINAGE ALONG NORTH PROPERTY LINE OF FALCONER BAY (SOUTH LEG)
FALCONER BAY

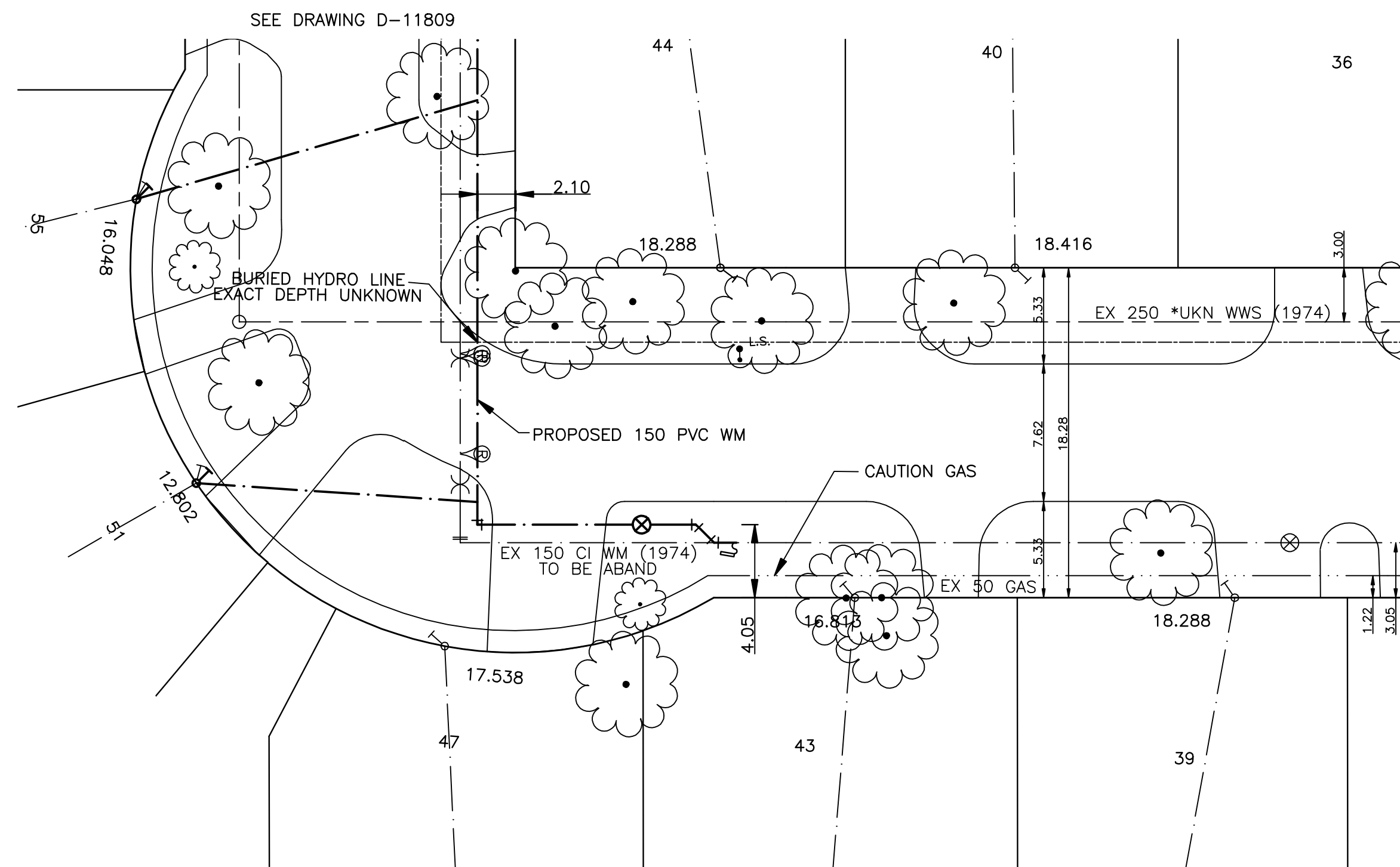

NOTES:

- ALL GATE VALVES ARE COUNTER-CLOCKWISE TO OPEN WITH A BLACK OPERATING NUT. WATERMAIN TO BE INSTALLED BY TRENCHLESS METHODS.
- BACKFILL IS CLASS 5 WITHIN BOULEVARD AND CLASS 3 WHEN WITHIN PAVEMENT/SIDEWALK OR WHEN WITHIN 1.0m OF PAVEMENT OR SIDEWALK.
- WATER SERVICES ARE 19mm UNLESS OTHERWISE NOTED.
- MINIMUM COVER TO TOP OF WATERMAIN SHALL BE 2.4m.
- LOCATION OF ALL SERVICES TO BE CONFIRMED IN FIELD.
- EXPOSE EXISTING WATERMAIN TO CONFIRM DEPTH PRIOR TO CONSTRUCTION.
- ALL LEAD SERVICES TO BE RENEWED TO PROPERTY LINE.
- SERVICES TO BE RENEWED SHALL BE REPLACED FROM WATERMAIN TO PROPERTY LINE. ALL OTHERS TO BE RECONNECTED.



METRIC
WHOLE NUMBERS INDICATE MILLIMETRES
DECIMALIZED NUMBERS INDICATE METRES

EXISTING	LEGEND - PLAN	PROPOSED	EXISTING	LEGEND - PLAN	PROPOSED	EXISTING	LEGEND - PROFILE	PROPOSED
---	WATERMAIN	---	---	REDUCER	---	---	150mm W.W.	---
⊕	HYDRANT VALVE	⊕	⊕	PLUG	⊕	---	150mm W.W.	---
⊕	LAND DRAINAGE SEWER	⊕	⊕	TRAFFIC SIGNAL	⊕	---	300mm L.D.S.	---
⊕	WASTE WATER SEWER	⊕	⊕	GAS	⊕	---	250mm W.W.S.	---
○	MANHOLE	●	---	HYDRO	---	---	---	---
□	CATCH BASIN	■	---	M.T.S.	---	---	---	---
△	CURB INLET	▲	---	SURVEY BAR	---	---	---	---
▭	TEE	▭	---	CURB STOP	---	---	---	---
∩	BEND	∩	---	C.B. LEAD	---	---	---	---
⊕	ANODE	⊕	---	TREE	---	---	---	---
---	---	---	---	LAMP STANDARD	---	---	---	---

LOCATION APPROVED

SUPPLY, U/G STRUCTURES COMMITTEE	DATE

NOTE:
LOCATION OF UNDERGROUND STRUCTURES AS SHOWN ARE BASED ON THE BEST INFORMATION AVAILABLE BUT NO GUARANTEE IS GIVEN THAT ALL EXISTING UTILITIES ARE SHOWN OR THAT THE GIVEN LOCATIONS ARE EXACT. CONFIRMATION OF EXISTENCE AND EXACT LOCATION OF ALL SERVICES MUST BE OBTAINED FROM THE INDIVIDUAL UTILITIES BEFORE PROCEEDING WITH CONSTRUCTION.

NO.	REVISIONS	DATE	BY
1	BID OPPORTUNITY 399-2009	MAY 09	AB

GENIVAR
10 PRAIRIE WAY WINNIPEG, MANITOBA R2J 3J8
Ph: (204)-477-8650 FAX: (204)-474-2864

DESIGNED BY AB	CHECKED BY DJ
DRAWN BY AB	APPROVED BY SM
HOR. SCALE: 1:250	RELEASED FOR CONSTRUCTION
VERT. SCALE: 1:50	SIGNED BY K. ZUREK P. ENG
DATE MAY 09	DATE MAY 25, 2009

ENGINEERS SEAL
I. G. MCKINNON
REGISTERED PROFESSIONAL ENGINEER
PROVINCE OF MANITOBA

THE CITY OF WINNIPEG
WATER AND WASTE DEPARTMENT

2009 CAPITAL WORKS
WATERMAIN RENEWALS
FALCONER BAY (SOUTH LEG)
FALCONER BAY (WEST LEG) TO
10M EAST OF FALCONER BAY (WEST LEG)