

TLS-075

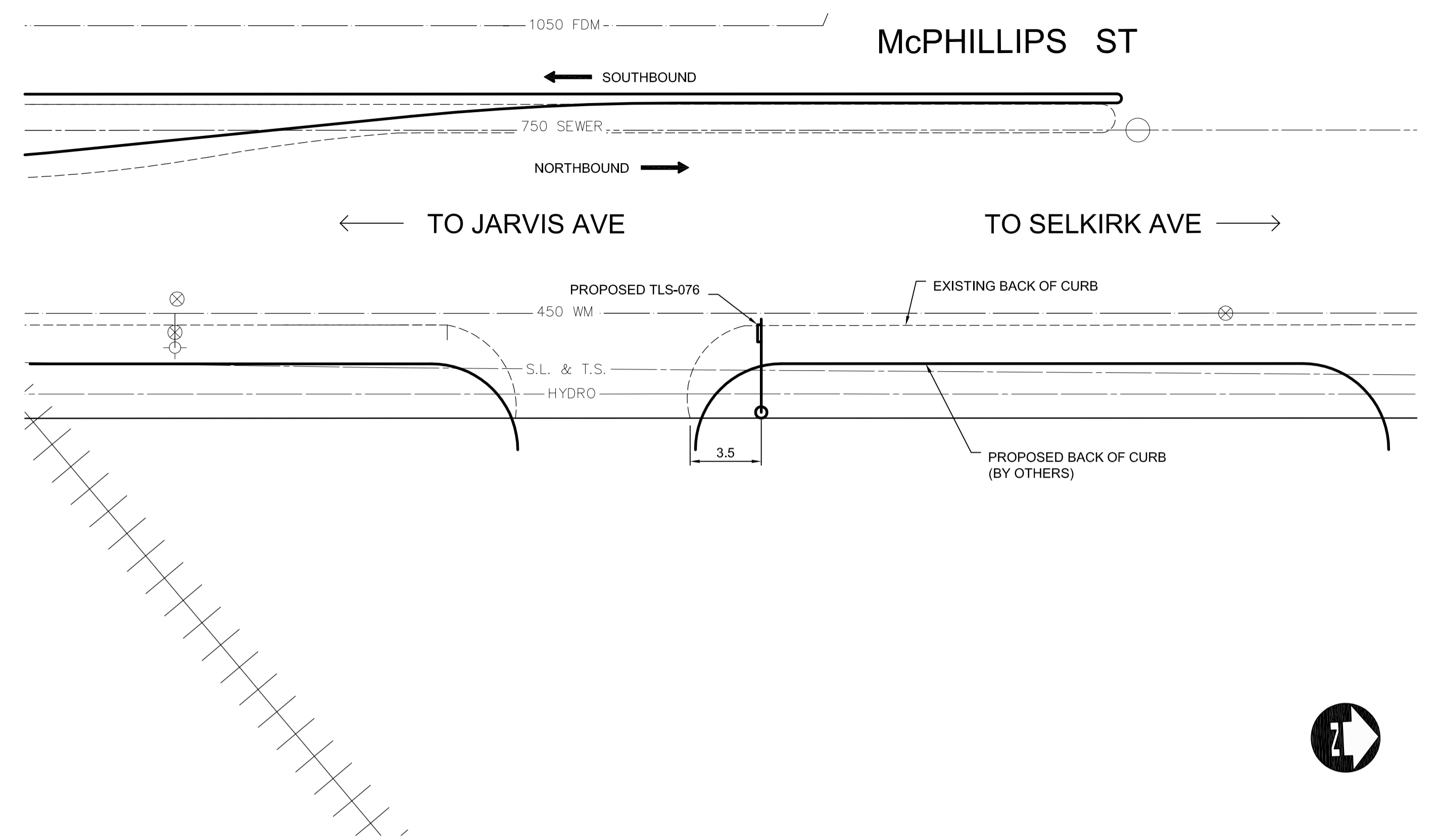

TLS-076

NOTE: DIMENSIONS SHOWN ARE APPROXIMATE ONLY

G:\CAD\09-1545\Contract\CHSS\CHSS-PLAN.dwg

EXISTING	LEGEND-PLAN	PROPOSED	EXISTING	LEGEND-PLAN	PROPOSED	EXISTING	LEGEND-PROFILE	PROPOSED
150 WM	WATERMAIN	150 WM	HYDRO	HYDRO	HYDRO	150 mm W.M.	WATERMAIN	150 mm W.M.
⊕	HYDRANT	⊕	MTS	M.T.S.	MTS	+	HYDRANT	+
⊗	VALVE	⊗		CONCRETE		⊗	VALVE	⊗
300 LDS	LAND DRAINAGE SEWER	300 LDS		ASPHALT		300 mm L.D.S.	LAND DRAINAGE SEWER	300 mm L.D.S.
250 WWS	WASTE WATER SEWER	250 WWS		PLANING		250 mm W.W.S.	WASTE WATER SEWER	250 mm W.W.S.
○	MANHOLE	●		SIDEWALK		- - - - -	PROFILE	- - - - -
□	CATCH BASIN	■		PAVING STONES		▣	NORTH/WEST GUTTER	▣
▽	CURB INLET	▽		PARTIAL DEPTH REPAIR		▣	SOUTH/EAST GUTTER	▣
+	JUNCTIONS	+		PROPERTY LINE		▣	NORTH/WEST T/LANE	▣
—	CULVERT	—		SURVEY BAR		▣	SOUTH/EAST T/LANE	▣
100 GAS	GAS	100 GAS		PARAPLEGIC RAMP		▣		▣

UNDERGROUND STRUCTURES

SUPV. U/G STRUCTURES COMMITTEE DATE

NOTE:
LOCATION OF UNDERGROUND STRUCTURES AS SHOWN ARE BASED ON THE BEST INFORMATION AVAILABLE, BUT NO GUARANTEE IS GIVEN THAT ALL EXISTING UTILITIES ARE SHOWN OR THAT THE GIVEN LOCATIONS ARE EXACT. CONFIRMATION OF EXISTENCE AND EXACT LOCATION OF ALL SERVICES MUST BE OBTAINED FROM THE INDIVIDUAL UTILITIES BEFORE PROCEEDING WITH CONSTRUCTION.

NO.	REVISIONS	DATE	BY
2	ISSUED FOR TENDER	06/19/09	TJH
1	ISSUED FOR REVIEW	06/04/09	TJH

DESIGNED BY: RJT

DRAWN BY: TJH

CHECKED BY: DBW

APPROVED BY:

HOR. SCALE: 1:200

VERTICAL:



ENGINEER'S SEAL

PROVINCE OF MANITOBA

REGISTERED PROFESSIONAL ENGINEER

D.B. WIEBE

06/19/09

Member 22480

CONSULTANT PROJECT NUMBER: 09-1545

THE CITY OF WINNIPEG
TRANSIT DEPARTMENT

ON STREET TRANSIT PRIORITY IMPROVEMENTS - PHASE 3

MCPHILLIPS STREET (2 OF 2)

CITY DRAWING NUMBER: TLS-09-17

SHEET 17 OF 23

CONSULTANT DRAWING NUMBER