

Station	3+650	3+675	3+700	3+725	3+750	3+775	3+800	3+825	3+850	3+875	3+900	3+925	3+950	3+975
EXISTING GRADE	233.606	233.513	233.567	233.638	233.684	233.751	234.279	233.971	234.061	234.145	234.180	234.296	234.572	
FINISH GRADE	234.42	234.45	234.48	234.50	234.52	234.55	234.58	234.58	234.53	234.45	234.38	234.32	234.59	
WEST DITCH	233.230	233.209	233.188	233.167	233.147	233.126	233.105	233.084	233.063	233.042	233.021	233.000	233.377	
EAST DITCH	233.550	233.538	233.525	233.512	233.500	233.488	233.475	233.462	233.442	233.421	233.400	233.377	233.652	

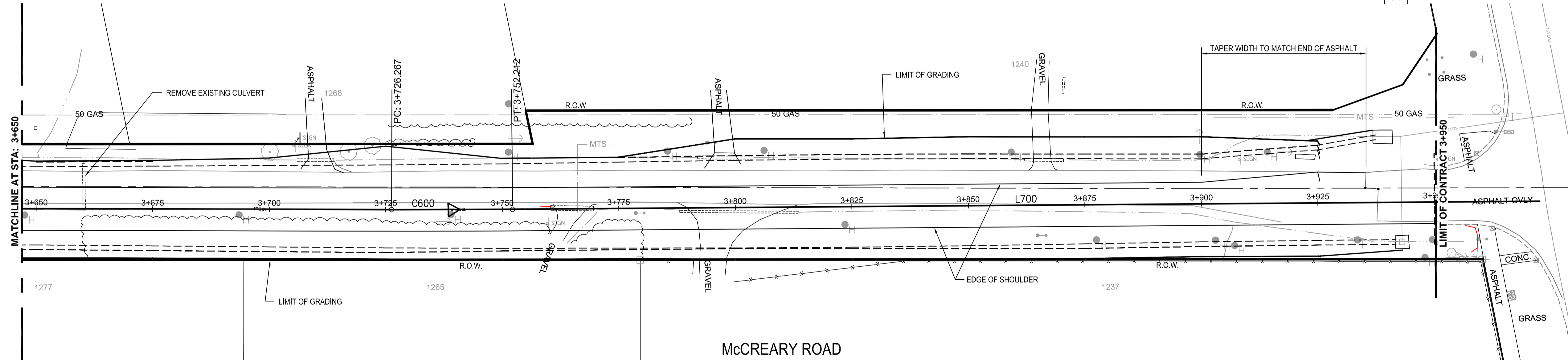
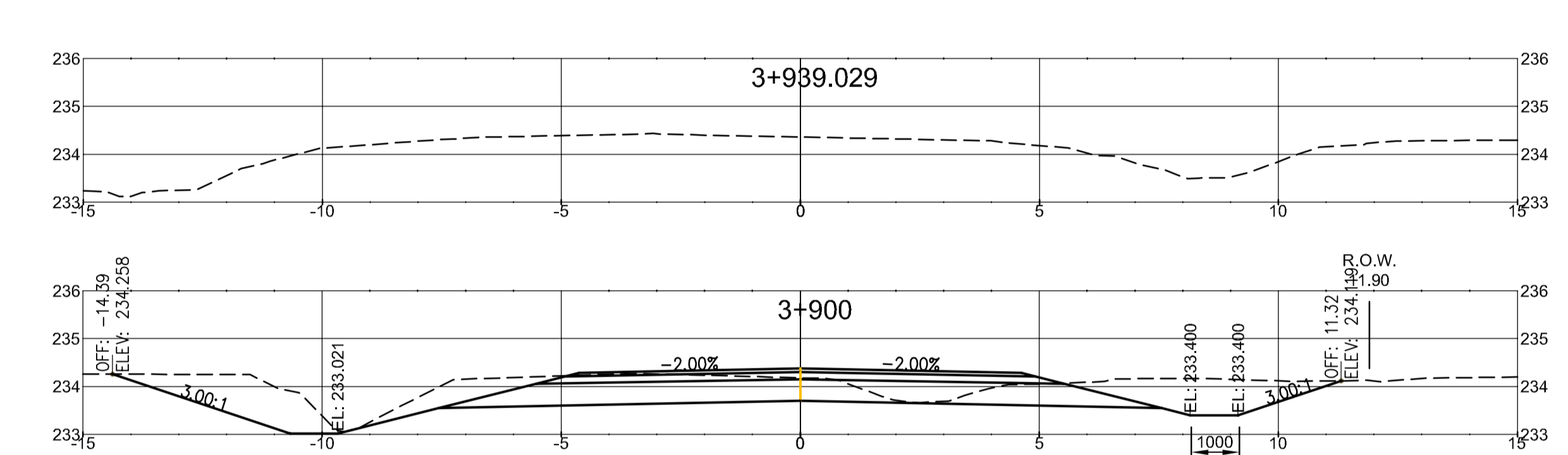
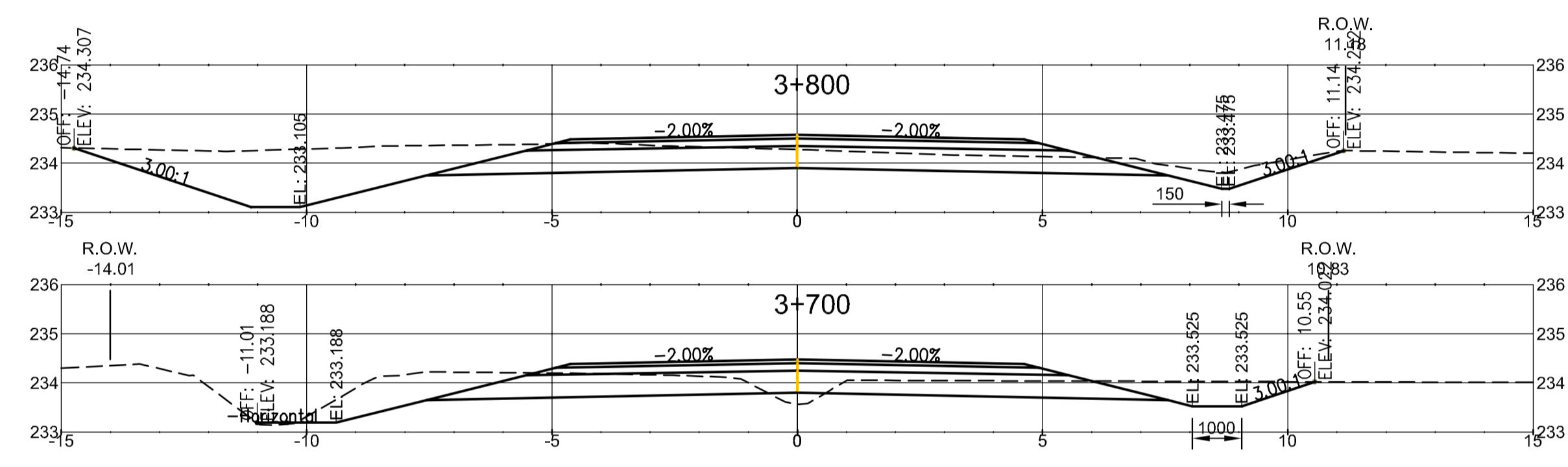

McCREARY ROAD

CONSTRUCTION NOTES

1. REGRADE EXISTING DITCHES AS DIRECTED BY CONTRACT ADMINISTRATOR.
2. RENEW EXISTING APPROACHES AS DIRECTED BY CONTRACT ADMINISTRATOR.
3. NEW CULVERTS TO BE INSTALLED ON ALL DRIVEWAYS AS DIRECTED BY CONTRACT ADMINISTRATOR.
4. CHAINAGE ALONG CENTRELINE OF NEW ROAD

WARNING

- IF POWER EQUIPMENT OR EXPLOSIVES ARE TO BE USED FOR EXCAVATION ON THIS PROJECT THE CONTRACTOR MUST:
1. NOTIFY THE GAS COMPANY OF THE PROPOSED LOCATION OF EXCAVATION.
 2. TAKE PRECAUTION TO AVOID DAMAGE TO GAS COMPANY INSTALLATIONS. SEE PROVINCIAL REGULATION 210/92 FOR DETAILS.

METRIC

WHOLE NUMBERS INDICATE MILLIMETRES
DECIMALIZED NUMBERS INDICATE METRES.

150 mm W.M.	WATER MAIN	150 mm W.M.	HYDRO	150 mm W.M.	WATERMAIN	150 mm W.M.
○	HYDRANT	○	M.T.S.	○	HYDRANT	○
⊗	VALVE	⊗	CONCRETE	⊗	VALVE	⊗
300 mm L.D.S.	LAND DRAINAGE SEWER	300 mm L.D.S.	ASPHALT	300 mm L.D.S.	LAND DRAINAGE SEWER	300 mm L.D.S.
250 mm W.W.S.	WASTE WATER SEWER	250 mm W.W.S.	PLANNING	250 mm W.W.S.	WASTE WATER SEWER	250 mm W.W.S.
○	MANHOLE	○	SIDEWALK	○	Q PROFILE	○
□	CATCH BASIN	□	PAVING STONES	□	NORTH/WEST GUTTER	□
▽	CURB INLET	▽	PARTIAL DEPTH REPAIR	▽	SOUTH/EAST GUTTER	▽
—	JUNCTIONS	—	PROPERTY LINE	—	NORTH/WEST T/LANE	—
—	CULVERT	—	SURVEY BAR	—	SOUTH/EAST T/LANE	—
—	GAS	—	PARAPLEGIC RAMP	—		—
EXISTING	LEGEND—PLAN	PROPOSED	EXISTING	LEGEND—PLAN	PROPOSED	EXISTING

UNDERGROUND STRUCTURES	B.M. ELEV.
SUPPLY, U/G STRUCTURES COMMITTEE	DATE
NOTE: LOCATION OF UNDERGROUND STRUCTURES AS SHOWN ARE BASED ON THE BEST INFORMATION AVAILABLE, BUT NO GUARANTEE IS GIVEN THAT ALL EXISTING UTILITIES ARE SHOWN OR THAT THE GIVEN LOCATIONS ARE EXACT. CONFIRMATION OF EXISTENCE AND EXACT LOCATION OF ALL SERVICES MUST BE OBTAINED FROM THE INDIVIDUAL UTILITIES BEFORE PROCEEDING WITH CONSTRUCTION.	

DESIGNED BY	DTM
DRAWN BY	DTM
CHECKED BY	ORIGINAL SIGNED BY TARAN J. PETERS
APPROVED BY	ORIGINAL SIGNED BY DAVID P. KRAHN
HOR. SCALE	1 : 500
VERTICAL	1 : 25
1. RELEASED FOR TENDER	MAY 27/09 TJP
NO. REVISIONS	DATE BY

DILLON CONSULTING

RELEASED FOR CONSTRUCTION ORIGINAL SIGNED BY KEN TURKO, 05/27/2009

ENGINEER'S SEAL

PROVINCE OF MANITOBA
REGISTERED PROFESSIONAL ENGINEER
T.J. PETERS
08/27/09
Member 22309

CONSULTANT PROJECT NO.
08-9587

THE CITY OF WINNIPEG
PUBLIC WORKS DEPARTMENT

2009 GRANULAR ROADWAY IMPROVEMENTS
McCREARY ROAD
GRADING AND PAVING
3+650 TO 3+950

CITY DRAWING NUMBER
SHEET 10 OF 11

APCGM
Certificate of Authorization
Dillon Consulting Limited (MB)
No. 1789 Date: MAY 27/09