

**MATERIAL LIST**

ITEM	MANUFACTURER	MATERIAL SPECIFICATION	SPECIAL FEATURES
<b>2. SEWER PIPE</b>			
375 OVERFLOW PIPE	SDEPTER	ASTM D3034	PVC SR 35
375 OVERFLOW PIPE	NORTHERN PIPE PRODUCTS	ASTM D3034	PVC SR 35
MANHOLES	GENSTAR MATERIALS	ASTM C-478	PRECAST CONCRETE
MANHOLE FRAMES & COVERS	HORWOOD FOUNDRY	ASTM A-48 CLASS 20	
<b>4. ROADS</b>			
ITEM	MANUFACTURER/SUPPLIER		
CONCRETE	SUPERCRETE		
REINFORCING STEEL	COMIN STEEL		
CONTRACTOR: B-A CONSTRUCTION LTD.			
CONSTRUCTION PERIOD: NOVEMBER/DECEMBER, 1987			
FIELD BOOK NO. 87116			

**PLAN VIEW**  
1:250

REF. or DRAWING No. 41-02-0066-196-01  
DETAILS OVERFLOW CONTROL STRUCTURE -  
DWG. 03

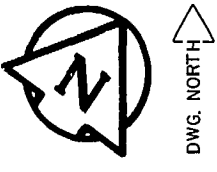
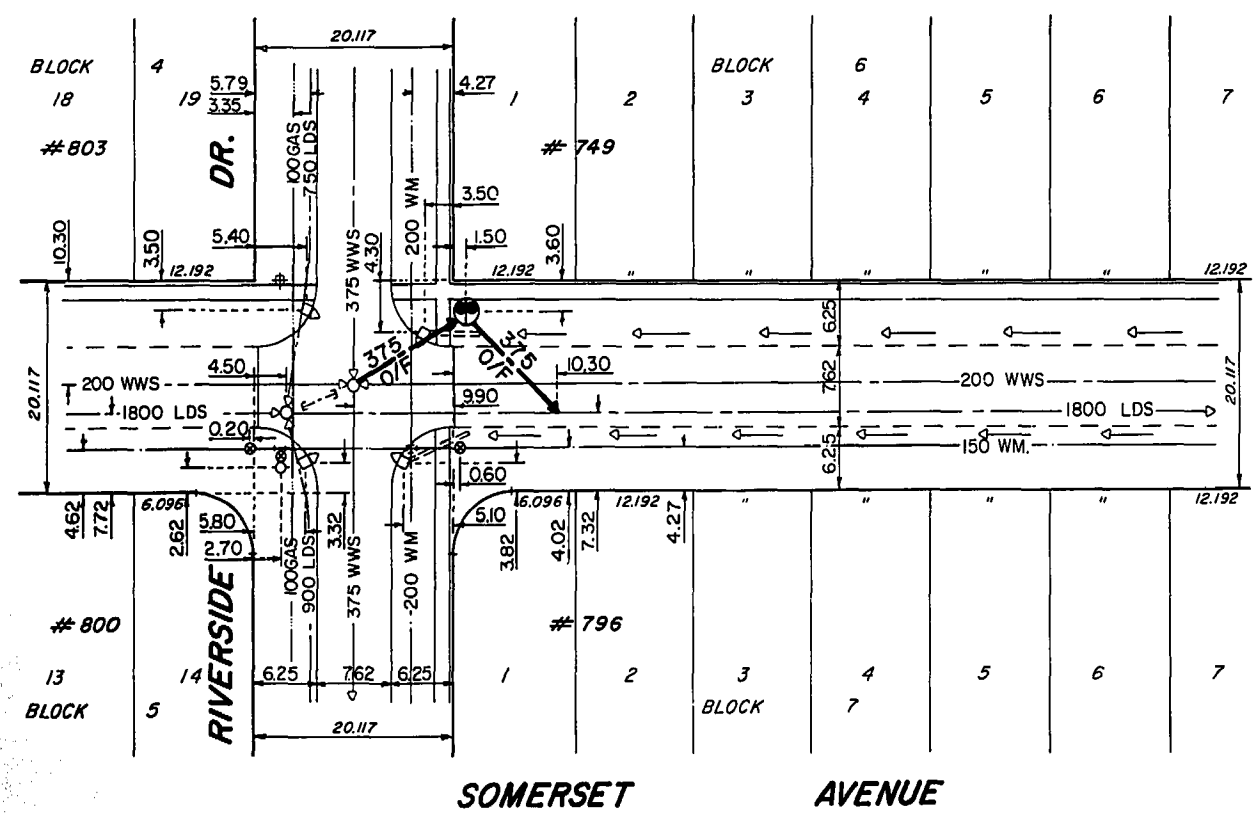

DWG. NORTH

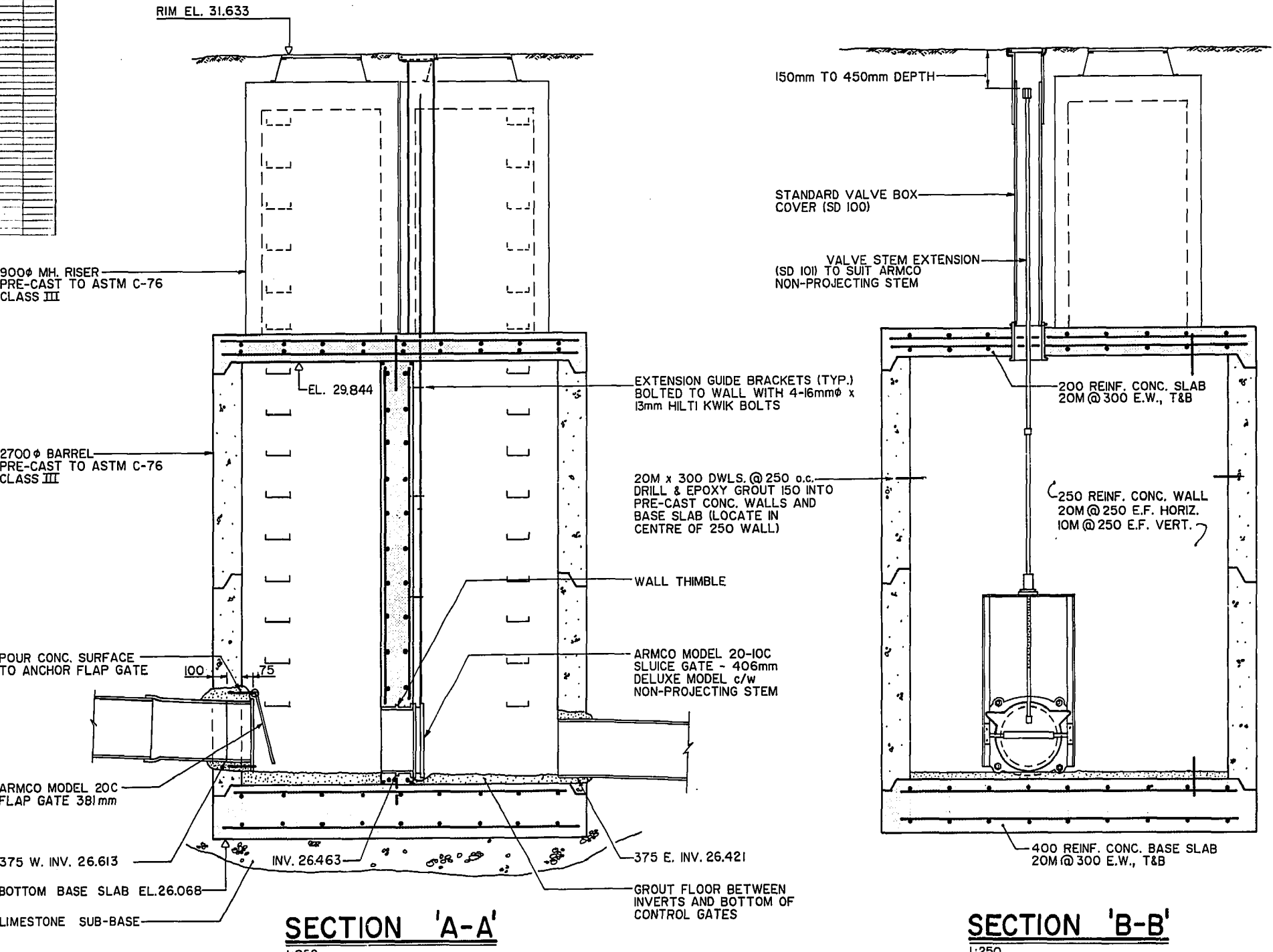

**SECTION 'A-A'**  
1:250

**SECTION 'B-B'**  
1:250

**METRIC**

WHOLE NUMBERS INDICATE MILLIMETRES  
DECIMALIZED NUMBERS INDICATE METRES

18 Jan 88  
CCM **RECORD DRAWING**

150 mm W.M.	WATERMAIN	150 mm W.M.	HYDRO	150 mm W.M.	WATERMAIN
	HYDRANT		M.T.S.		HYDRANT
	VALVE		CONCRETE		VALVE
	LAND DRAINAGE SEWER		ASPHALT		LAND DRAINAGE SEWER
	WASTE WATER SEWER		PROPERTY LINE		WASTE WATER SEWER
	MANHOLE		SURVEY BAR		Q. PROFILE
	CATCH BASIN				N. P. PROFILE
	CURB INLET				
	JUNCTIONS				
	CULVERT				
	GAS				
	EXISTING		EXISTING		EXISTING
	LEGEND-PLAN		LEGEND-PLAN		LEGEND-PROFILE
	PROPOSED		PROPOSED		PROPOSED

**LOCATION APPROVED**  
UNDERGROUND STRUCTURES

DATE: \_\_\_\_\_

NOTE:  
LOCATION OF UNDERGROUND STRUCTURES AS SHOWN ARE BASED ON THE BEST INFORMATION AVAILABLE BUT NO GUARANTEE IS GIVEN THAT ALL EXISTING UTILITIES ARE SHOWN OR THAT THE GIVEN LOCATIONS ARE EXACT. CONFIRMATION OF EXISTENCE AND EXACT LOCATION OF ALL SERVICES MUST BE OBTAINED FROM THE INDIVIDUAL UTILITIES BEFORE PROCEEDING WITH CONSTRUCTION.

NO.	REVISIONS	DATE	BY
B	REVISED TO RECORD DWG.	12-01-88	L.S.
A	Added Glass Lids on W/Side Boxes	4/20/87	legl

UMA Engineering Ltd.  
Engineers & Planners  
1475 Buffalo Place - Winnipeg, Manitoba, Canada R3T 1T7

DESIGNED BY: C.C.M.  
CHECKED BY: DR  
DRAWN BY: D.M.L.  
APPROVED BY: [Signature]

HOR SCALE: 1:500  
VERTICAL: 1:50

DATE: April 16/87  
DATE: 1987 04 16

ENGINEER'S SEAL  
PROVINCE OF MANITOBA  
16 April 87  
C.C. MACEY  
REGISTERED ENGINEER  
CONSULTANT DRAWING NO.  
02-0066-196-01

**THE CITY OF WINNIPEG**  
WORKS AND OPERATIONS DIVISION  
OPERATIONS DEPARTMENT - DISTRICT 6

OVERFLOW CONTROL STRUCTURE  
SOMERSET AVENUE @ RIVERSIDE DRIVE

CITY DRAWING NUMBER  
SHEET 3 OF 3  
**03 B**