

**SEWER JUNCTION INFORMATION  
FOR SEWER ID MA60017460**

REFERENCE—METERS SOUTH OF MANHOLE MH60015093

DIST. FROM REF. MANHOLE	JUNCTION DIA.	CLOCK REF.	SERVICE TYPE	DESCRIPTION
4.0	150	02	CNI	LIVE
8.4	150	10	CNI	
19.4	150	02	CN	CAPPED
19.5	150	02	CN	LIVE
20.9	150	10	CN	
37.8	150	03	CX	LIVE
39.4	100	10	CNI	
50.1	150	02	CN	
52.2	150	10	CX	
67.6	150	09	CN	

ALL JUNCTION INFORMATION  
BASED ON CCTV INSPECTION

**SEWER SERVICE INFORMATION**

ADDRESS	SIZE	PROPERTY LINE LOCATION
#1 KENNETH ST RESIDENTIAL	NO INFORMATION	NO INFORMATION
#2 KENNETH ST RESIDENTIAL	NO INFORMATION	NO INFORMATION
#5 KENNETH ST RESIDENTIAL	NO INFORMATION	NO INFORMATION
#6 KENNETH ST RESIDENTIAL	NO INFORMATION	NO INFORMATION
#9 KENNETH ST RESIDENTIAL	NO INFORMATION	NO INFORMATION
#10 KENNETH ST RESIDENTIAL	NO INFORMATION	NO INFORMATION
#13 KENNETH ST RESIDENTIAL	NO INFORMATION	NO INFORMATION
#14 KENNETH ST RESIDENTIAL	NO INFORMATION	NO INFORMATION
#17 KENNETH ST RESIDENTIAL	NO INFORMATION	NO INFORMATION
#18 KENNETH ST RESIDENTIAL	NO INFORMATION	NO INFORMATION
#21 KENNETH ST RESIDENTIAL	NO INFORMATION	NO INFORMATION
#22 KENNETH ST RESIDENTIAL	NO INFORMATION	NO INFORMATION
#25 KENNETH ST RESIDENTIAL	NO INFORMATION	NO INFORMATION
#26 KENNETH ST RESIDENTIAL	NO INFORMATION	NO INFORMATION

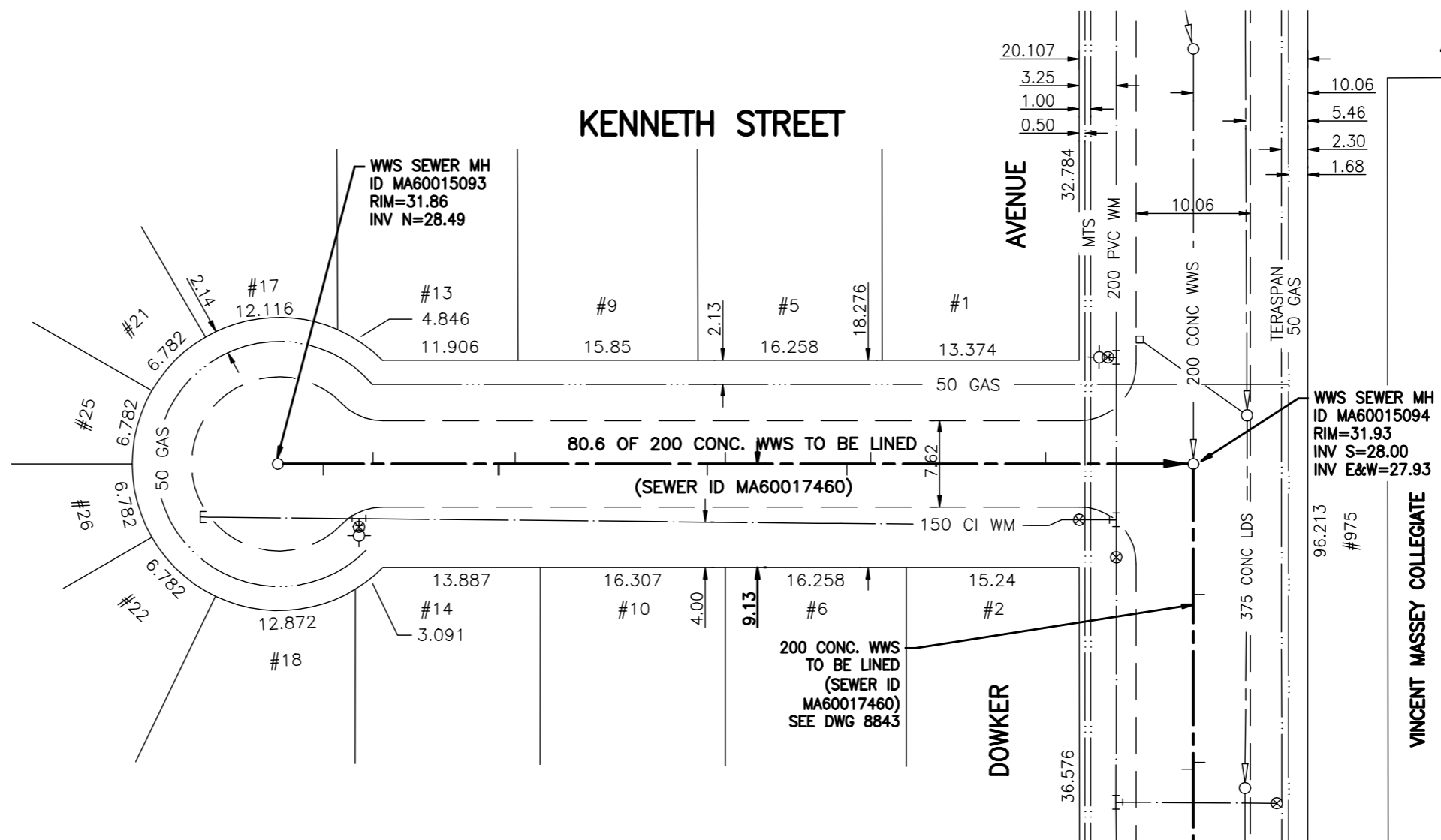

FOR CONTINUATION  
SEE DRAWING 8843

**WARNING**

IF POWER EQUIPMENT OR EXPLOSIVES ARE TO BE USED FOR EXCAVATION ON THIS PROJECT THE CONTRACTOR MUST:

- 1) NOTIFY THE GAS COMPANY OF THE PROPOSED LOCATION OF EXCAVATION.
  - 2) TAKE PRECAUTION TO AVOID DAMAGE TO GAS COMPANY INSTALLATIONS.
- SEE PROVINCIAL REGULATION 140/92 FOR DETAILS

**METRIC**

WHOLE NUMBERS INDICATE MILLIMETRES  
DECIMALIZED NUMBERS INDICATE METRES

BENCH MARK: 268 (654268) - Tblt. in 7.6 m  
Conc. pile in median of Pembina Hwy., 3.8 m  
N. of line of N.L. of Kelsey Ave., & 0.5 m E.  
of W. edge of median.

BID OPPORTUNITY 478-2009

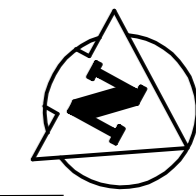

**APEGM**  
Certificate of Authorization  
Stantec Consulting Ltd.  
No. 1301 Expiry: April 30, 2010

**LOCATION APPROVED UNDERGROUND STRUCTURES**

SUPV. U/G STRUCTURES COMMITTEE	DATE

NOTE:  
LOCATION OF UNDERGROUND STRUCTURES AS SHOWN ARE BASED ON THE BEST INFORMATION AVAILABLE BUT NO GUARANTEE IS GIVEN THAT ALL EXISTING UTILITIES ARE SHOWN OR THAT THE GIVEN LOCATIONS ARE EXACT. CONFIRMATION OF EXISTENCE AND EXACT LOCATION OF ALL SERVICES MUST BE OBTAINED FROM THE INDIVIDUAL UTILITIES BEFORE PROCEEDING WITH CONSTRUCTION.

B.M. 64-003  
ELEV. 232.442m

NO.	REVISIONS	DATE	BY

**Stantec Consulting Ltd.**  
905 Waverley Street, Winnipeg, Manitoba  
Tel 204-489-5900 Fax 204-453-9012

DESIGNED BY	J.K.H.	CHECKED BY	W.A.B.
DRAWN BY	J.K.H.	APPROVED BY	H.A.K.
HOR. SCALE:	1:500	RELEASED FOR CONSTRUCTION:	ORIGINAL SIGNED BY K. ZUREK
VERTICAL:	N/A	DATE	09.07.21
DATE	09.04.21	DATE	09.07.21

ENGINEER'S SEAL

**ORIGINAL SEALED BY**  
H.A. KATZ  
P. ENG.  
09.07.21

CONSULTANT DRAWING NO.  
**C-110**

**THE CITY OF WINNIPEG**  
WATER AND WASTE DEPARTMENT

**2009 SEWER RENEWALS**  
BY CIPP LINING - CONTRACT I7  
**KENNETH STREET**  
1ST MH S OF DOWKER AVE TO  
MH AT DOWKER AVE

SHEET OF	10 22
CAD FILE DRAWING NUMBER	11490c-110-711.dwg
CITY DRAWING NUMBER	<b>8845</b>

V:\1118\Drawings\11181100\Drawings\11181100-110-711.dwg  
2009-07-21 09:59:04 By: jkms