

FOR CONTINUATION
SEE DRAWING 8850

OAKENWALD AVENUE

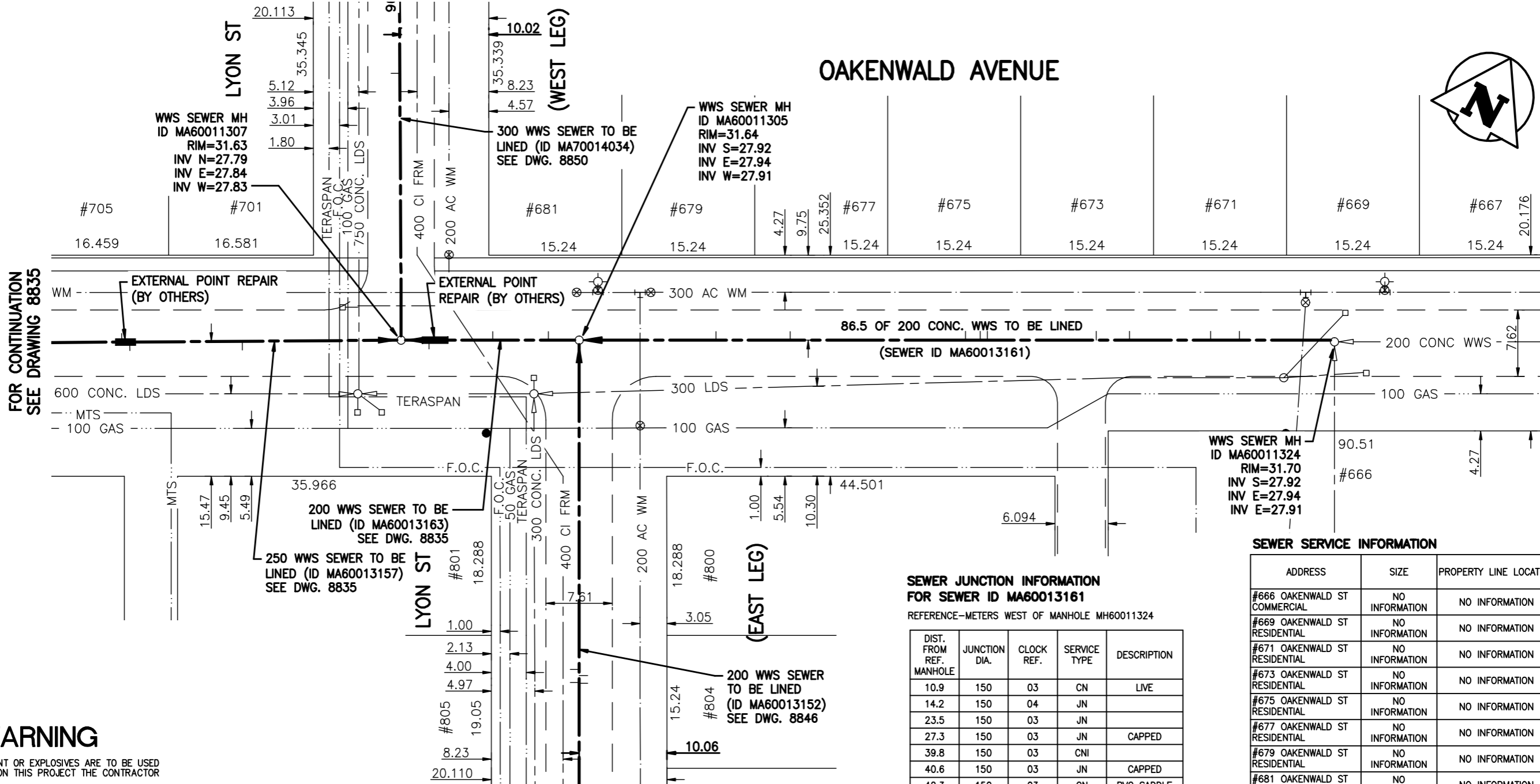
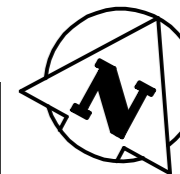

SEWER SERVICE INFORMATION

ADDRESS	SIZE	PROPERTY LINE LOCATION
#666 OAKENWALD ST COMMERCIAL	NO INFORMATION	NO INFORMATION
#669 OAKENWALD ST RESIDENTIAL	NO INFORMATION	NO INFORMATION
#671 OAKENWALD ST RESIDENTIAL	NO INFORMATION	NO INFORMATION
#673 OAKENWALD ST RESIDENTIAL	NO INFORMATION	NO INFORMATION
#675 OAKENWALD ST RESIDENTIAL	NO INFORMATION	NO INFORMATION
#677 OAKENWALD ST RESIDENTIAL	NO INFORMATION	NO INFORMATION
#679 OAKENWALD ST RESIDENTIAL	NO INFORMATION	NO INFORMATION
#681 OAKENWALD ST RESIDENTIAL	NO INFORMATION	NO INFORMATION

SEWER JUNCTION INFORMATION FOR SEWER ID MA60013161

REFERENCE—METERS WEST OF MANHOLE MH60011324

DIST. FROM REF. MANHOLE	JUNCTION DIA.	CLOCK REF.	SERVICE TYPE	DESCRIPTION
10.9	150	03	CN	LIVE
14.2	150	04	JN	
23.5	150	03	JN	
27.3	150	03	JN	CAPPED
39.8	150	03	CNI	
40.6	150	03	JN	CAPPED
42.3	150	03	CN	PVC SADDLE
62.4	150	02	JN	
70.9	150	02	JN	

ALL JUNCTION INFORMATION BASED ON CCTV INSPECTION

WARNING

IF POWER EQUIPMENT OR EXPLOSIVES ARE TO BE USED FOR EXCAVATION ON THIS PROJECT THE CONTRACTOR MUST:
 1) NOTIFY THE GAS COMPANY OF THE PROPOSED LOCATION OF EXCAVATION.
 2) TAKE PRECAUTION TO AVOID DAMAGE TO GAS COMPANY INSTALLATIONS.
 SEE PROVINCIAL REGULATION 140/92 FOR DETAILS

METRIC

WHOLE NUMBERS INDICATE MILLIMETRES
 DECIMALIZED NUMBERS INDICATE METRES

BENCH MARK: S. side Oakenwald Ave., W. of Point Rd., Tblt. in E. Conc. foundation of Oakenwald School, No. 666 Oakenwald Ave., 1.0 m S. & 0.1 m below brick of N.E. Cor. of school.

BID OPPORTUNITY 478-2009

APEGM
 Certificate of Authorization
 Stantec Consulting Ltd.
 No. 1301 Expiry: April 30, 2010

LOCATION APPROVED UNDERGROUND STRUCTURES SUPV. U/G STRUCTURES COMMITTEE DATE NOTE: LOCATION OF UNDERGROUND STRUCTURES AS SHOWN ARE BASED ON THE BEST INFORMATION AVAILABLE BUT NO GUARANTEE IS GIVEN THAT ALL EXISTING UTILITIES ARE SHOWN OR THAT THE GIVEN LOCATIONS ARE EXACT. CONFIRMATION OF EXISTENCE AND EXACT LOCATION OF ALL SERVICES MUST BE OBTAINED FROM THE INDIVIDUAL UTILITIES BEFORE PROCEEDING WITH CONSTRUCTION.	B.M. 64-014 ELEV. 232.479m	<p>Stantec Consulting Ltd. 905 Waverley Street, Winnipeg, Manitoba Tel 204-489-5900 Fax 204-453-9012</p>	ENGINEER'S SEAL ORIGINAL SEALED BY H.A. KATZ P. ENG. 09.07.21	<p>THE CITY OF WINNIPEG WATER AND WASTE DEPARTMENT</p>	SHEET OF 16 22
	NO. REVISIONS DATE BY				DESIGNED BY J.K.H. CHECKED BY W.A.B. DRAWN BY J.K.H. APPROVED BY H.A.K. HOR. SCALE: 1:500 VERTICAL: N/A DATE 09.04.21

V:\1173\winnipeg\11731140\drawing\11731140-116-711.dwg
 2009-07-21 02:11 PM Bp Jhwa