

- CONSTRUCTION NOTES:**
1. FOR DETAILED TEST HOLE INFORMATION, SEE SPECIFICATION.
 2. THE LOCATION OF ALL SERVICES IS TO BE CONFIRMED IN THE FIELD.
 3. INSTALL NEW SEWERS AND CATCHBASIN LEADS BY TRENCHLESS METHODS WHEREVER POSSIBLE.
 4. RENEW/REHABILITATE CATCHBASINS & RENEW CATCHBASIN LEADS WHERE NOTED.

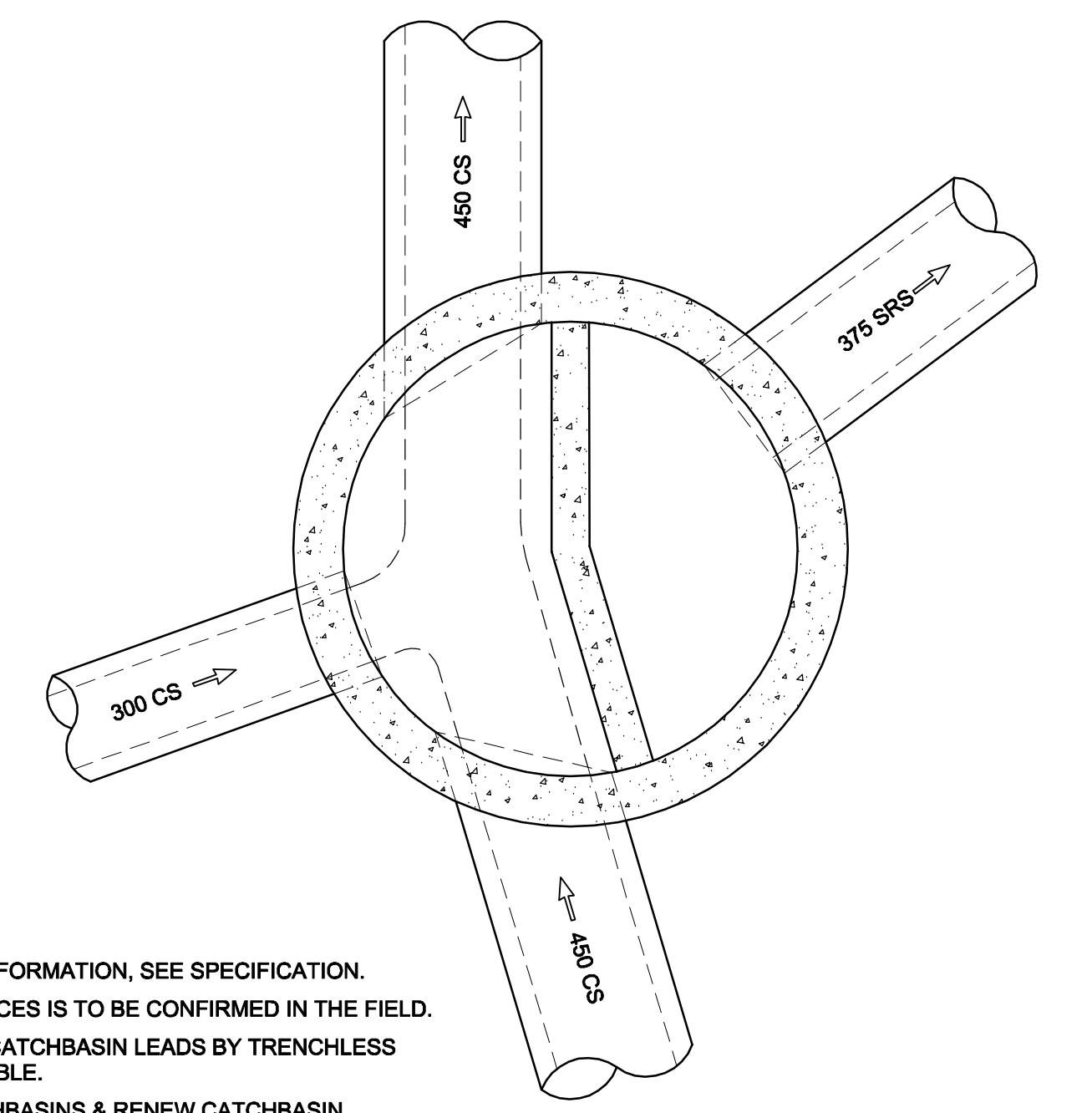

SECTION A
SCALE 1:25

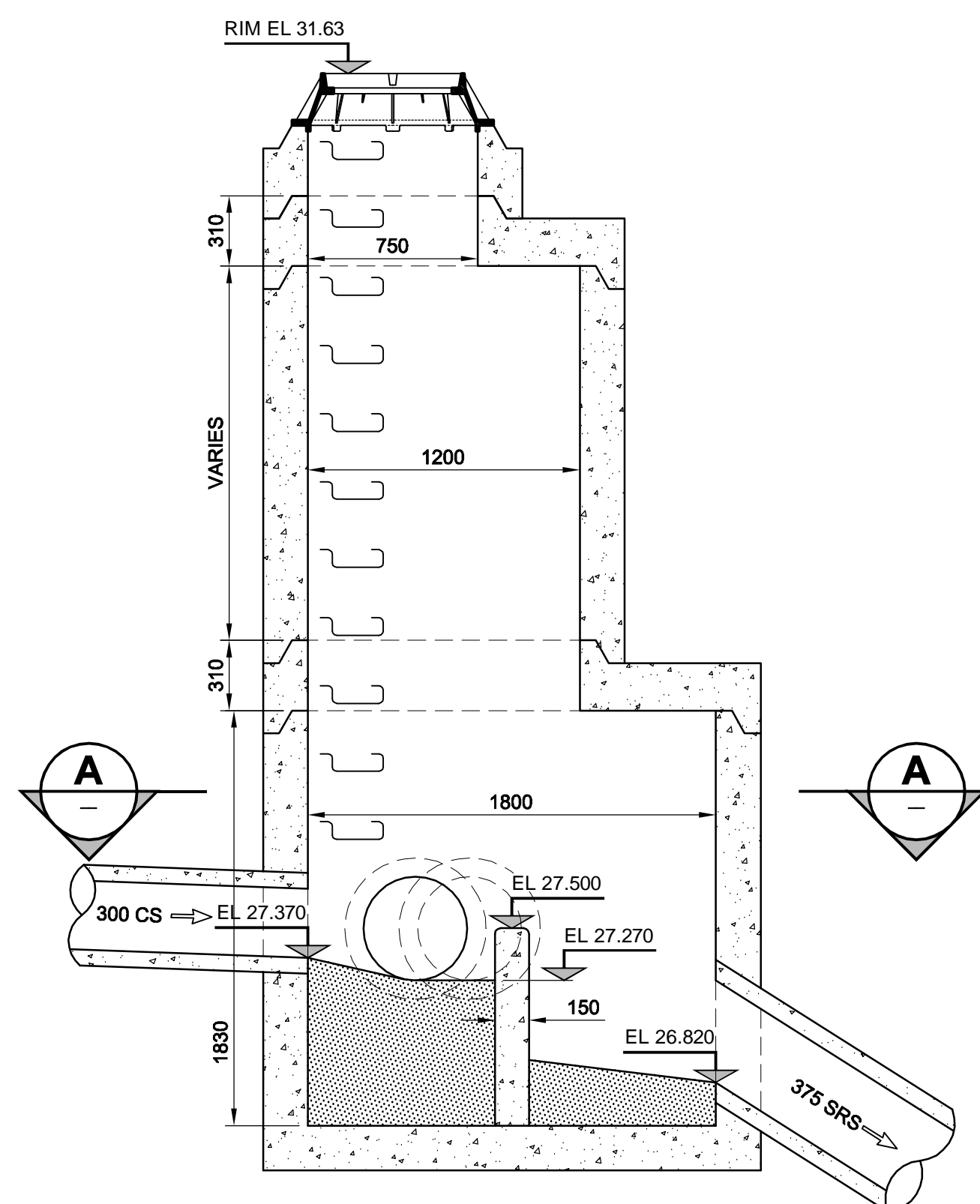
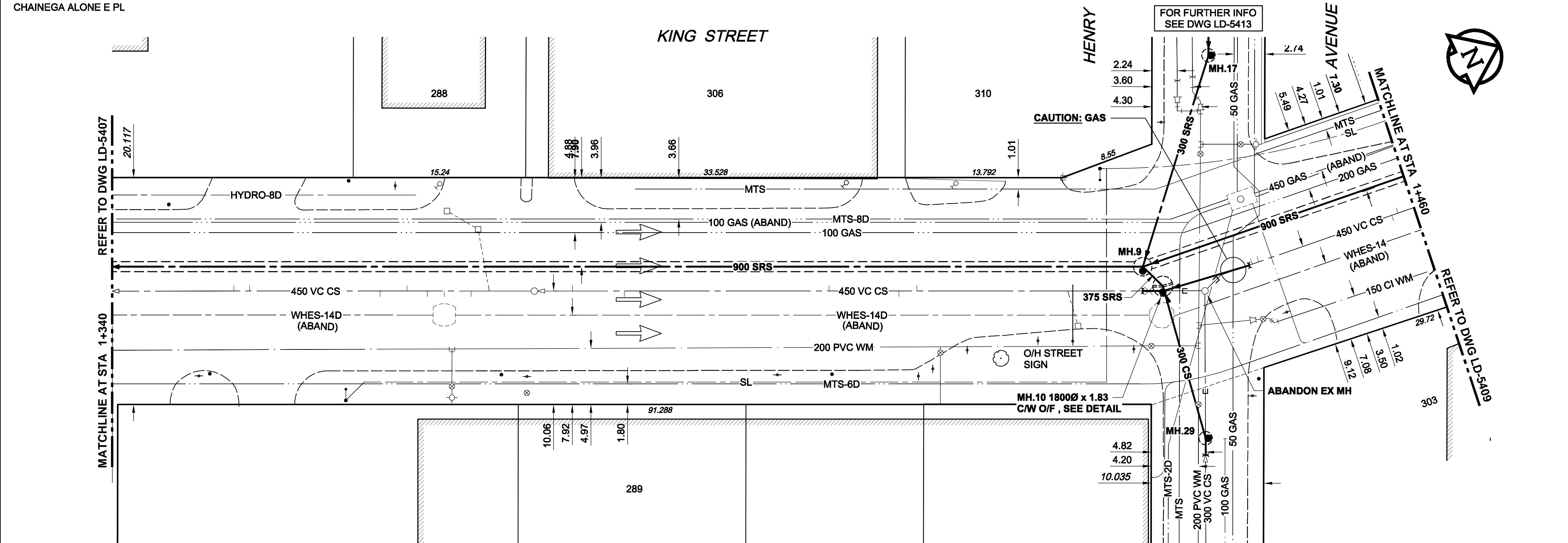

MANHOLE 10 OVERFLOW DETAIL
SCALE 1:25
TYPICAL MANHOLE REQUIREMENTS AS PER SD-010

WARNING
IF POWER EQUIPMENT OR EXPLOSIVES ARE TO BE USED FOR EXCAVATION ON THIS PROJECT, THE CONTRACTOR MUST:
1) NOTIFY THE GAS COMPANY OF THE PROPOSED LOCATION OF EXCAVATION.
2) TAKE PRECAUTION TO AVOID DAMAGE TO GAS COMPANY INSTALLATIONS.
SEE PROVINCIAL REGULATION 140/92 FOR DETAILS

150 WM	WATERMAIN	150 WM	CURB STOP	150 WM	WATERMAIN	150 WM	WATERMAIN
○	HYDRANT	○	REDUCER	○	HYDRANT	○	HYDRANT
⊕	VALVE	⊕	COUPLING	⊕	VALVE	⊕	VALVE
⊗	LAND DRAINAGE SEWER	⊗	ANODE	⊗	LAND DRAINAGE SEWER	⊗	LAND DRAINAGE SEWER
⊙	WASTE WATER SEWER	⊙	HYDRO	⊙	WASTE WATER SEWER	⊙	WASTE WATER SEWER
○	MANHOLE	○	MTS	○	PAVEMENT CROWN	○	PAVEMENT CROWN
□	CATCH BASIN	□	GAS	□	N/W PROPERTY LINE	□	N/W PROPERTY LINE
△	CURB INLET	△	TESTHOLE	△	S/E PROPERTY LINE	△	S/E PROPERTY LINE
▭	CULVERT	▭	LAMP STANDARD	▭	N/W GUTTER	▭	N/W GUTTER
—	PIPE ABANDONMENTS	—	TREE	—	S/E GUTTER	—	S/E GUTTER
+	SURVEY BAR						
○	EXISTING	○	LEGEND - PLAN	○	EXISTING	○	LEGEND - PROFILE
○	NEW	○	LEGEND - PLAN	○	NEW	○	LEGEND - PROFILE

LOCATION APPROVED
UNDERGROUND STRUCTURES
SUPR. U/G STRUCTURES DATE COMMITTEE
NOTE:
LOCATION OF UNDERGROUND STRUCTURES AS SHOWN ARE BASED ON THE BEST INFORMATION AVAILABLE. BUT NO GUARANTEE IS GIVEN THAT ALL EXISTING UTILITIES ARE SHOWN OR THAT THE GIVEN LOCATIONS ARE EXACT. CONFIRMATION OF EXISTENCE AND EXACT LOCATION OF ALL SERVICES MUST BE OBTAINED FROM THE INDIVIDUAL UTILITIES BEFORE PROCEEDING WITH CONSTRUCTION.

NO.	ISSUED FOR CONSTRUCTION	REVISIONS	DATE	BY
0	ISSUED FOR CONSTRUCTION		09/07/06	KMB

AECOM		DESIGNED BY: GEB		CHECKED BY: FMI	
DRAWN BY: KMB		APPROVED BY: BTW		RELEASED FOR CONSTRUCTION: C. Boulet	
HOR. SCALE: 1:250		DATE: July 7, 2009		DATE: July 7, 2009	
VERT. SCALE: 1:50					

APEGM
Certificate of Authorization
AECOM Canada Ltd.
No. 4671 Date: July 7, 2009

THE CITY OF WINNIPEG
WATER AND WASTE DEPARTMENT

ALEXANDER/BANNATYNE
COMBINED SEWER RELIEF
CONTRACT 5
KING STREET
MATCHLINE 1+340
TO MATCHLINE 1+460

SHEET 6 OF 20
CITY DRAWING NUMBER LD-5408
REV 0

PROFESSIONAL'S SEAL
ISSUE / REVISION 0
ISSUED FOR CONSTRUCTION
WAS SEALED BY A. NAGY
AND DATED July 7, 2009
CONSULTANT DRAWING NO. D265-177-05_01-C-1006_RX.dwg