

KEY PLAN

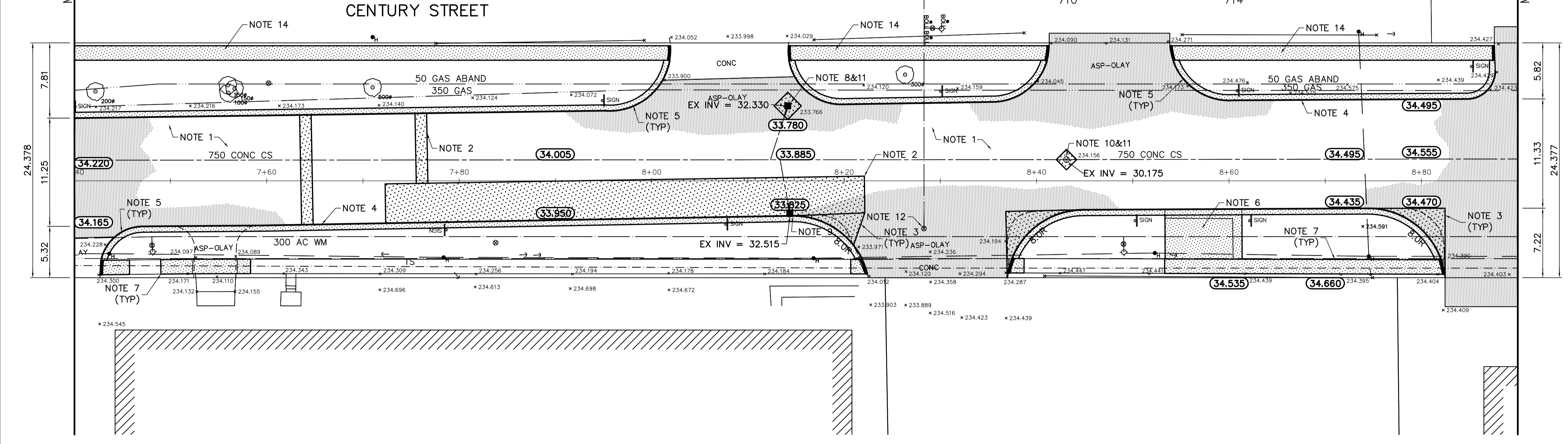

- REFERENCE NOTES:**
- BASELINE IS CENTERED BETWEEN WEST AND EAST PROPERTY LINES OF CENTURY STREET FROM ELLICE AVENUE TO SARGENT AVENUE
  - LEGAL PLAN - L.B.I.S.
  - AECOM FIELD BOOK No. 4607
  - PAVEMENT DIMENSIONS ARE TO BACK OF CURB
  - ALL WORK TO CONFORM TO CITY OF WINNIPEG STANDARD CONSTRUCTION SPECIFICATIONS

- CONSTRUCTION NOTES:**
- PLANE EXISTING ASPHALT AND CONSTRUCT NEW 80mm ASPHALTIC CONCRETE OVERLAY
  - CONSTRUCT NEW 200mm PLAIN DOWELLED CONCRETE PAVEMENT
  - CONSTRUCT NEW 200mm REINFORCED CONCRETE PAVEMENT
  - CONSTRUCT NEW MONOLITHIC CONCRETE SPLASH STRIP (150mm HT)
  - CONSTRUCT NEW MONOLITHIC CONCRETE MODIFIED SPLASH STRIP
  - REMOVE EXISTING PATIO BLOCKS AND CONSTRUCT NEW CONCRETE SIDEWALK
  - RENEW EXISTING CONCRETE SIDEWALK
  - REMOVE EXISTING CATCH BASIN AND INSTALL NEW CATCH BASIN (SD-025) C/W GRATED COVER AND CONNECT NEW 250mm LEAD TO EXISTING LEAD
  - REMOVE EXISTING CATCH BASIN AND INSTALL NEW CURB AND GUTTER INLET C/W CATCH BASIN (SD-024) AND CONNECT NEW 250mm LEAD TO EXISTING LEAD
  - ADJUST EXISTING CATCH BASIN/MANHOLE TO GRADE
  - INSTALL NEW CAST IRON RISER RING
  - ADJUST EXISTING WATER VALVE TO GRADE
  - REMOVE EXISTING PAVEMENT
  - CONSTRUCT NEW CONCRETE SIDEWALK

**AECOM**

© 2008 EARTH TECH (CANADA) INC. ALL RIGHTS RESERVED. THIS DOCUMENT IS PROTECTED BY COPYRIGHT LAW AND MAY NOT BE USED, REPRODUCED OR MODIFIED IN ANY MANNER OR FOR ANY PURPOSE EXCEPT WITH THE WRITTEN PERMISSION OF EARTH TECH (CANADA) INC. DOING BUSINESS AS AECOM ("AECOM") OR A PARTY TO WHICH ITS COPYRIGHT HAS BEEN ASSIGNED. AECOM ACCEPTS NO RESPONSIBILITY, AND DENIES ANY LIABILITY WHATSOEVER, TO ANY PARTY THAT USES, REPRODUCES, MODIFIES, OR RELIES ON THIS DOCUMENT WITHOUT AECOM'S EXPRESS WRITTEN CONSENT.

**APECA**  
 Certificate of Authorization  
 Earth Tech Canada Inc.  
 No. 730 Expiry: April 30, 2009

**METRIC**  
 WHOLE NUMBERS INDICATE MILLIMETRES  
 DECIMALIZED NUMBERS INDICATE METRES

EXISTING	LEGEND - PLAN	PROPOSED	EXISTING	LEGEND - PLAN	PROPOSED	EXISTING	LEGEND - PROFILE	PROPOSED
150 mm W.M.	WATERMAIN	150 mm W.M.	HYDRO	HYDRO	HYDRO	---	Q PROFILE	---
300mm L.D.S.	LAND DRAINAGE SEWER	300mm L.D.S.	M.T.S.	M.T.S.	M.T.S.	---	WEST GUTTER	---
250mm W.W.S.	WASTEWATER SEWER	250mm W.W.S.	CONCRETE	CONCRETE	CONCRETE	---	EAST GUTTER	---
	MANHOLE		ASPHALT	ASPHALT	ASPHALT	---		
	CATCH BASIN		PROPERTY LINE	PROPERTY LINE	PROPERTY LINE	---		
	CURB INLET		SURVEY BAR	SURVEY BAR	SURVEY BAR	---		
	JUNCTIONS		ELEVATION	ELEVATION	ELEVATION	(32.750)		
	CULVERT		TREE	TREE	TREE	---		
	GAS		SIDEWALK RAMP	SIDEWALK RAMP	SIDEWALK RAMP	---		
			CONCRETE SIDEWALK	CONCRETE SIDEWALK	CONCRETE SIDEWALK	---		
			FENCE	FENCE	FENCE	---		

**LOCATION APPROVED UNDERGROUND STRUCTURES**

SUPV. U/G STRUCTURES DATE COMMITTEE

**NOTE:**  
 LOCATION OF UNDERGROUND STRUCTURES AS SHOWN ARE BASED ON THE BEST INFORMATION AVAILABLE BUT NO GUARANTEE IS GIVEN THAT ALL EXISTING UTILITIES ARE SHOWN OR THAT THE GIVEN LOCATIONS ARE EXACT. CONFIRMATION OF EXISTENCE AND EXACT LOCATION OF ALL SERVICES MUST BE OBTAINED FROM THE INDIVIDUAL UTILITIES BEFORE PROCEEDING WITH CONSTRUCTION.

B.M. 38-072 N.E. Cor. Ellice Ave. & Century St. Tab. on top of 0.05 m dia. x 2.4 m iron pipe, 4.8 m S. of N.L. of Ellice Ave. & on E.L. of Century St.

NO.	REVISIONS	DATE	BY
0	ISSUED FOR TENDER	02/26/09	KWR
A	ISSUED FOR REVIEW	02/11/09	KWR

**AECOM**

DESIGNED BY RC CHECKED BY KWR

DRAWN BY SS APPROVED BY

HOR. SCALE: 1:250  
 VERTICAL: 1:10

RELEASED FOR CONSTRUCTION BY:

DATE 2008/11/17 DATE

ENGINEER'S SEAL

PROVINCE OF MANITOBA  
 ORIGINAL SIGNED BY  
**K.W. RAE**  
 2006/02/26  
 REGISTERED PROFESSIONAL ENGINEER

CONSULTANT DRAWING NO. CT05

**THE CITY OF WINNIPEG**  
 PUBLIC WORKS DEPARTMENT  
 ENGINEERING DIVISION

**Winnipeg**

**CENTURY STREET - 130m SOUTH OF ELLICE AVENUE TO 300m NORTH OF WELLINGTON AVENUE**  
 CONCRETE REPAIRS AND ASPHALT RESURFACING

CITY DRAWING NUMBER P-3298-06  
 SHEET 5 OF 9

PLAN PROFILE  
 STA 7+40 TO STA 8+90