

RIDLEY PL  
(S LEG)

18.0 PARTIALLY DETERIORATED  
OVALITY = 3.0%

61.6 FULLY DETERIORATED  
OVALITY = 5.0%

29.0 PARTIALLY DETERIORATED  
OVALITY = 3.0%

MH ID S-MH20000976  
MH OPENING - 521Ø  
MH RISERS - 750Ø  
MH BASE - 1200Ø

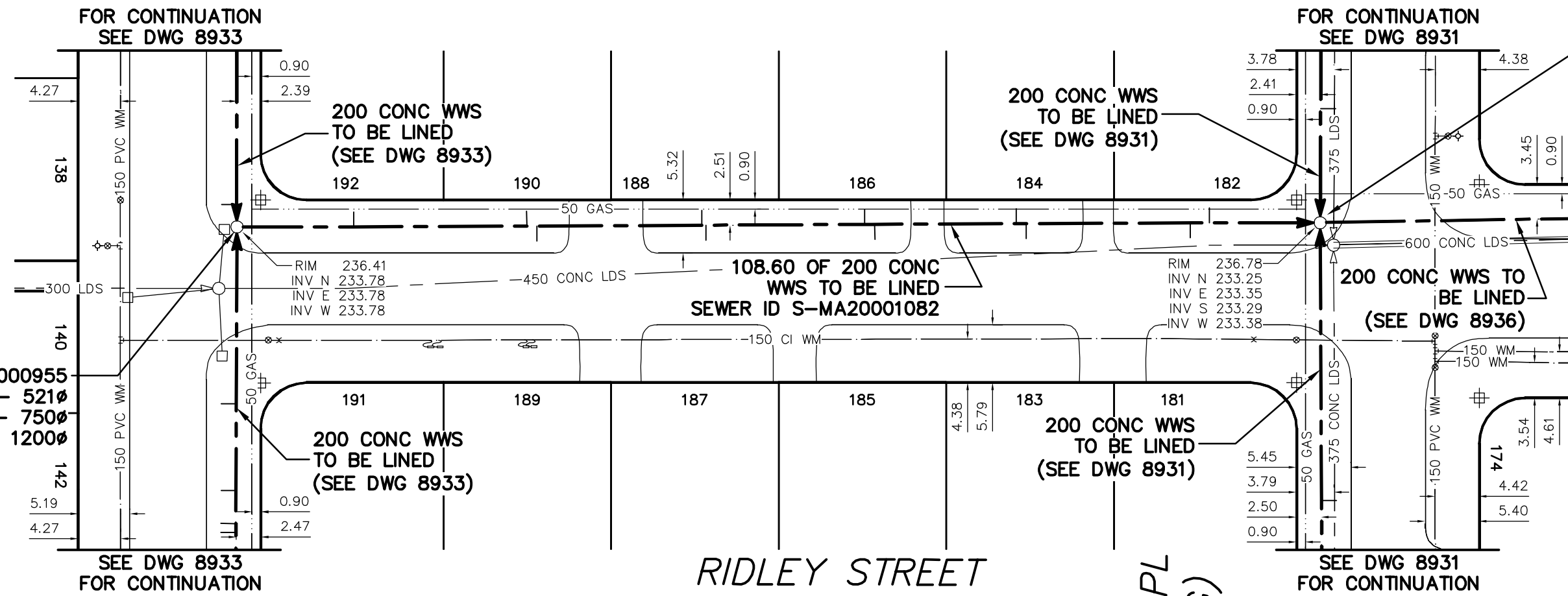

MH ID S-MH20000955  
MH OPENING - 521Ø  
MH RISERS - 750Ø  
MH BASE - 1200Ø

SEE DWG 8936  
FOR CONTINUATION

SEE DWG 8933  
FOR CONTINUATION

SEE DWG 8931  
FOR CONTINUATION

RIDLEY STREET

RIDLEY PL  
(N LEG)

ENGINEER'S SEAL

**ORIGINAL  
SIGNED BY  
S.R.J.  
COURNOYER  
09/07/15**

BID OPPORTUNITY: 526-2009  
FILENAME : 8935.dwg  
PLOT DATE : 2009 07 16

SEWER JUNCTION INFORMATION FROM SEWER VIDEO INSPECTION SEWER ID S-MA20001082				
DISTANCE FROM MH ID S-MH20000955				
11.7	N	150Ø	WEST	JN
29.0	N	150Ø	WEST	JN
30.0	N	150Ø	EAST	JN
46.5	N	150Ø	WEST	JN
46.9	N	150Ø	EAST	JN
62.8	N	150Ø	WEST	JN
63.8	N	150Ø	EAST	CNI
* REVERSAL REQUIRED *				

SEWER JUNCTION INFORMATION FROM SEWER VIDEO INSPECTION SEWER ID S-MA20001082				
DISTANCE FROM MH ID S-MH20000976				
11.1	S	100Ø	WEST	CX
13.0	S	100Ø	EAST	JN
29.4	S	100Ø	EAST	JN
30.4	S	100Ø	WEST	JN
* REVERSAL REQUIRED *				

LEGEND:

52.0 | MEASUREMENT TO REPAIR FROM REFERENCE MH SHOWN THUS...

0.0 |

**METRIC**  
WHOLE NUMBERS INDICATE MILLIMETRES  
DECIMALIZED NUMBERS INDICATE METRES

B.M. ELEV.	FIELD BOOK #:
POSTED TO LBIS	
DESIGNED BY: SC	CHECKED BY: SC
DRAWN BY: CJH	APPROVED BY: KZ
HOR. SCALE: 1:500	RELEASED FOR CONSTRUCTION
VERTICAL	
NO. REVISIONS	DATE BY
	DATE: 2009 07 14

*CITY OF WINNIPEG  
WATER AND WASTE  
ENGINEERING DIVISION*

**THE CITY OF WINNIPEG  
WATER AND WASTE DEPARTMENT**

Winnipeg

**2009 SEWER RENEWALS  
BY CIPP LININGS, CONTRACT 14  
RIDLEY STREET  
MH AT RIDLEY PLACE (S LEG) TO  
MH AT RIDLEY PLACE (N LEG)**

SHEET **30** OF **32**  
CITY DRAWING NUMBER  
**8935**