

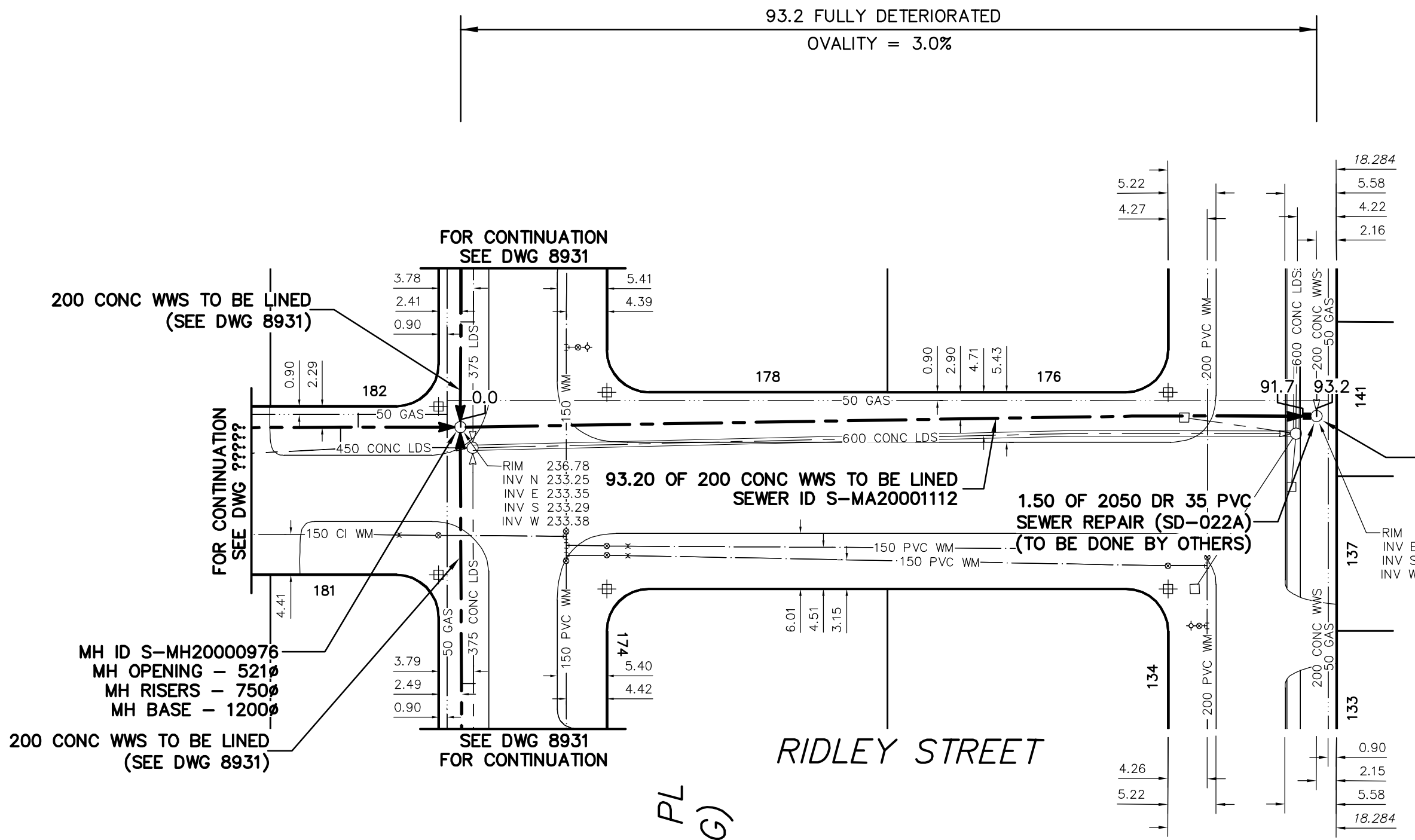

FAIRLANE AVE

93.2 FULLY DETERIORATED  
OVALITY = 3.0%



200 CONC WWS TO BE LINED  
(SEE DWG 8931)

FOR CONTINUATION  
SEE DWG ????

FOR CONTINUATION  
SEE DWG 8931

93.20 OF 200 CONC WWS TO BE LINED  
SEWER ID S-MA2000112

1.50 OF 2050 DR 35 PVC  
SEWER REPAIR (SD-022A)  
(TO BE DONE BY OTHERS)

MH ID S-MH20001008  
MH OPENING - 521Ø  
MH RISERS - 750Ø  
MH BASE - 1200Ø

MH ID S-MH20000976  
MH OPENING - 521Ø  
MH RISERS - 750Ø  
MH BASE - 1200Ø

200 CONC WWS TO BE LINED  
(SEE DWG 8931)

SEE DWG 8931  
FOR CONTINUATION

RIDLEY PL  
(N LEG)

RIDLEY STREET

ENGINEER'S SEAL	
<p>ORIGINAL SIGNED BY S.R.J. COURNOYER 09/07/15</p>	
BID OPPORTUNITY: 526-2009	
FILENAME : 8936.dwg	
PLOT DATE : 2009 07 16	

SEWER JUNCTION INFORMATION FROM SEWER VIDEO INSPECTION SEWER ID S-MA2000112
DISTANCE FROM MH ID S-MH20000976
NO JUNCTIONS

**LEGEND:**  
52.0 | MEASUREMENT TO REPAIR FROM REFERENCE MH SHOWN THUS...

**METRIC**  
WHOLE NUMBERS INDICATE MILLIMETRES  
DECIMALIZED NUMBERS INDICATE METRES

B.M. ELEV.	FIELD BOOK #:	<i>CITY OF WINNIPEG</i> WATER AND WASTE ENGINEERING DIVISION		<b>THE CITY OF WINNIPEG</b> WATER AND WASTE DEPARTMENT	
POSTED TO LBIS		DESIGNED BY: SC	CHECKED BY: SC	<b>2009 SEWER RENEWALS</b> BY CIPP LININGS, CONTRACT 14 <b>RIDLEY STREET</b> MH AT RIDLEY PLACE (N LEG) TO MH AT FAIRLANE AVENUE	
		DRAWN BY: C.J.H.	APPROVED BY: K.Z.	SHEET <b>31</b> OF <b>32</b> CITY DRAWING NUMBER <b>8936</b>	
		HOR. SCALE 1:500 VERTICAL	RELEASED FOR CONSTRUCTION		
NO.	REVISIONS	DATE	BY	DATE	2009 07 14