

NOTE: ALL EXISTING TREES AS SHOWN AND THEIR LOCATIONS ARE APPROXIMATE. CARE MUST BE TAKEN TO AVOID OR PROTECT THEM DURING THE CONSTRUCTION PERIOD AS PER D.16.

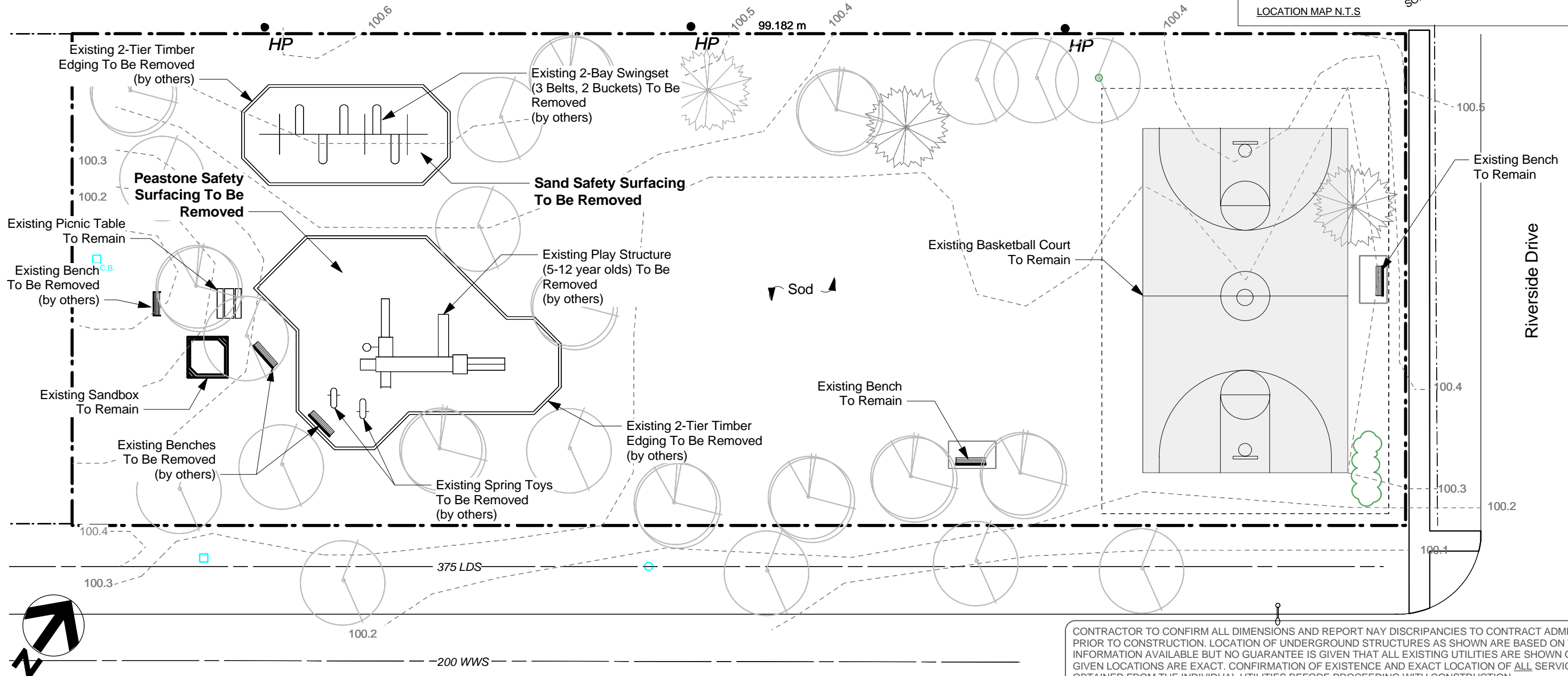
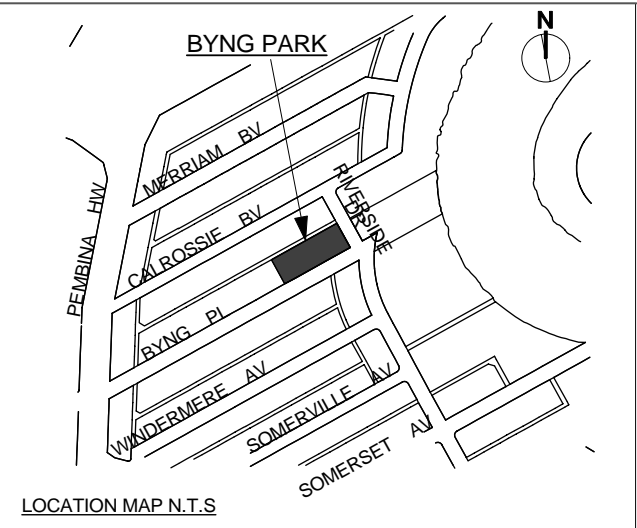

CONTRACTOR TO CONFIRM ALL DIMENSIONS AND REPORT ANY DISCREPANCIES TO CONTRACT ADMINISTRATOR PRIOR TO CONSTRUCTION. LOCATION OF UNDERGROUND STRUCTURES AS SHOWN ARE BASED ON THE BEST INFORMATION AVAILABLE BUT NO GUARANTEE IS GIVEN THAT ALL EXISTING UTILITIES ARE SHOWN OR THAT THE GIVEN LOCATIONS ARE EXACT. CONFIRMATION OF EXISTENCE AND EXACT LOCATION OF ALL SERVICES MUST BE OBTAINED FROM THE INDIVIDUAL UTILITIES BEFORE PROCEEDING WITH CONSTRUCTION.

THE CITY OF WINNIPEG
 Planning, Property and Development Department
 Planning and Land Use Division
 Unit 15 - 30 Fort Street, Winnipeg, MB, (R3C 4X5)

DESIGNED BY	CHECKED BY	MANAGER, PARK AND OPEN SPACES	DATE
DRAWN BY CH/HF	APPROVED BY		
HORIZ. SCALE VERT. SCALE	1:300	MANAGER, PLANNING AND LAND USE DIVISION	DATE
DATE	May/09		

DRAWING TITLE	DRAWING NO.
BYNG PARK EXISTING SITE CONDITIONS & REMOVALS	T.14-E
SITE ADDRESS	BID OPPORTUNITY NO.
913 BYNG PLACE	