

WATER SERVICE INFORMATION

ADDRESS	SIZE (mm) & TYPE (STREET)	SHORT & LONG MEASUREMENT	CORP MEASUREMENT	REMARKS
675 RIVERWOOD AVE RESIDENTIAL	19 COPPER	1.5 m W E H/L	2.8 m W E H/L	
674 RIVERWOOD AVE RESIDENTIAL	NO INFO AVAILABLE	3.7 m S N H/L	NO INFO AVAILABLE	
671 RIVERWOOD AVE RESIDENTIAL	NO INFO AVAILABLE	2.7 m W E H/L	2.4 m E OF S/C	92/09/11-#21751 SEWER REPAIR INTERNAL
670 RIVERWOOD AVE RESIDENTIAL	NO INFO AVAILABLE	1.7 m W E H/L	3.9 m W E P/L	TAX-FTG-1-901830-03 USED TAPPING CLAMP-COUPLING 3" CORP
669 RIVERWOOD AVE RESIDENTIAL	19 COPPER	3.0 m W E H/L	3.0 m W E H/L	
667 RIVERWOOD AVE RESIDENTIAL	NO INFO AVAILABLE	1.5 m W E H/L	0.5 m W E H/L	
666 RIVERWOOD AVE RESIDENTIAL	NO INFO AVAILABLE	3.7 m W E H/L	2.4 m W E H/L	
664 RIVERWOOD AVE RESIDENTIAL	NO INFO AVAILABLE	1.2 m W E H/L	NO INFO AVAILABLE	DEC 31/02 S/BOX DUG OUT (NO CONNECTOR SHEET)
663 RIVERWOOD AVE RESIDENTIAL	NO INFO AVAILABLE	1.5 m W E H/L	NO INFO AVAILABLE	
662 RIVERWOOD AVE RESIDENTIAL	NO INFO AVAILABLE	1.5 m W E H/L	ON E H/L	
661 RIVERWOOD AVE RESIDENTIAL	19 COPPER	3.4 m W E H/L	0.6 m E OF S/C	CRIG 1" FROM S/C PRO P. SIDE.
658 RIVERWOOD AVE RESIDENTIAL	NO INFO AVAILABLE	7.2 m W E H/L	NO INFO AVAILABLE	

SEWER SERVICE INFORMATION

ADDRESS	SIZE	PROPERTY LINE LOCATION	JUNCTION LOCATION
675 RIVERWOOD AVE RESIDENTIAL	NO INFO AVAILABLE	NO INFO AVAILABLE	NO INFO AVAILABLE
674 RIVERWOOD AVE RESIDENTIAL	NO INFO AVAILABLE	NO INFO AVAILABLE	NO INFO AVAILABLE
671 RIVERWOOD AVE RESIDENTIAL	NO INFO AVAILABLE	NO INFO AVAILABLE	NO INFO AVAILABLE
670 RIVERWOOD AVE RESIDENTIAL	NO INFO AVAILABLE	NO INFO AVAILABLE	NO INFO AVAILABLE
669 RIVERWOOD AVE RESIDENTIAL	NO INFO AVAILABLE	NO INFO AVAILABLE	NO INFO AVAILABLE
667 RIVERWOOD AVE RESIDENTIAL	NO INFO AVAILABLE	NO INFO AVAILABLE	NO INFO AVAILABLE
666 RIVERWOOD AVE RESIDENTIAL	NO INFO AVAILABLE	NO INFO AVAILABLE	NO INFO AVAILABLE
664 RIVERWOOD AVE RESIDENTIAL	NO INFO AVAILABLE	NO INFO AVAILABLE	NO INFO AVAILABLE
663 RIVERWOOD AVE RESIDENTIAL	NO INFO AVAILABLE	NO INFO AVAILABLE	NO INFO AVAILABLE
662 RIVERWOOD AVE RESIDENTIAL	NO INFO AVAILABLE	NO INFO AVAILABLE	NO INFO AVAILABLE
661 RIVERWOOD AVE RESIDENTIAL	NO INFO AVAILABLE	NO INFO AVAILABLE	NO INFO AVAILABLE
658 RIVERWOOD AVE RESIDENTIAL	NO INFO AVAILABLE	NO INFO AVAILABLE	NO INFO AVAILABLE

WARNING

IF POWER EQUIPMENT OR EXPLOSIVES ARE TO BE USED FOR EXCAVATION ON THIS PROJECT THE CONTRACTOR MUST:

- NOTIFY THE GAS COMPANY OF THE PROPOSED LOCATION OF EXCAVATION.
- TAKE PRECAUTION TO AVOID DAMAGE TO GAS COMPANY INSTALLATIONS.

SEE PROVINCIAL REGULATION 140/92 FOR DETAILS

METRIC

WHOLE NUMBERS INDICATE MILLIMETRES
DECIMALIZED NUMBERS INDICATE METRES

NOTE: STATIONING IS ALONG S. P/L OF RIVERWOOD AVE.

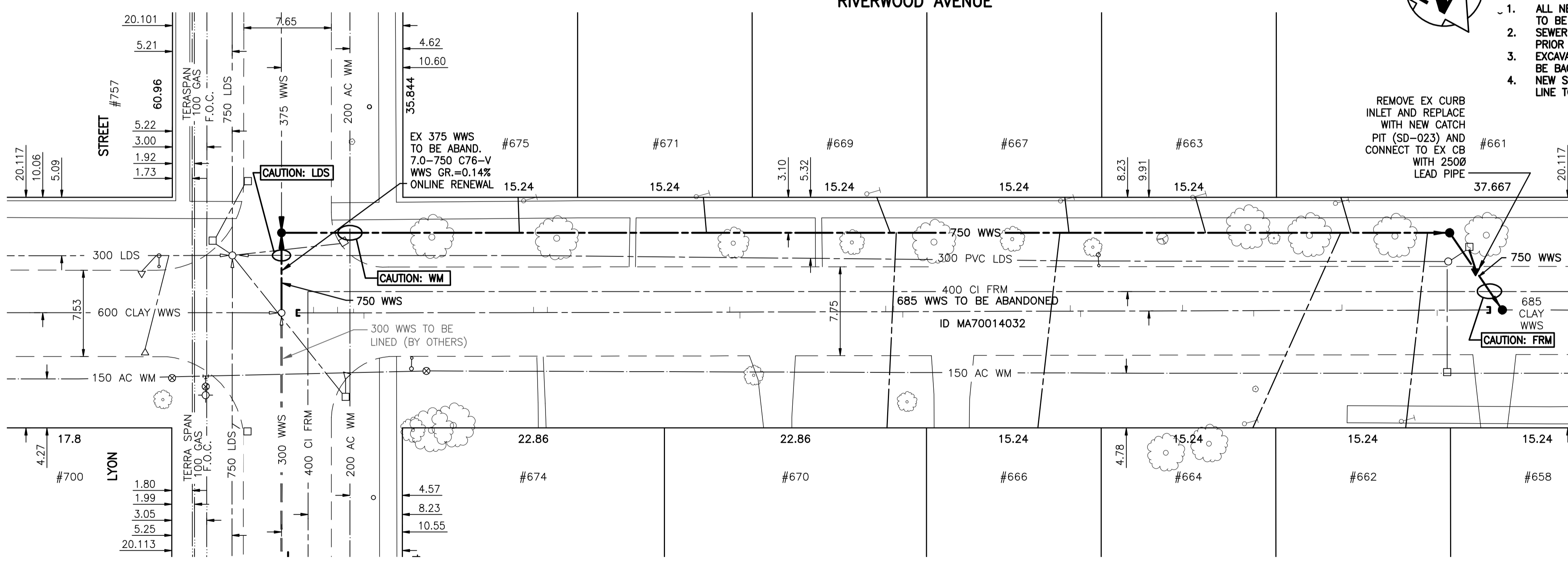

CONSTRUCTION NOTES:

- ALL NEW SEWERS AND SEWER SERVICES TO BE INSTALLED BY TRENCHLESS METHODS. SEWER SERVICE LOCATIONS TO BE CONFIRMED PRIOR TO CONSTRUCTION.
- EXCAVATIONS WITHIN 1.0m OF PAVEMENT TO BE BACKFILLED WITH CLASS 3 MATERIAL.
- NEW SEWER SERVICES RENEWED TO PROPERTY LINE TO HAVE A MINIMUM SLOPE OF 1.0%.

SEWER SERVICE INFORMATION

REFERENCE MANHOLE 60011329

DIST. FROM REF. MANHOLE	JUNCTION DIA.	CLOCK REF.	SERVICE TYPE	REMARKS
3.1	150	12	JN	CAPPED
5.2	150	11	JN	CAPPED
6.6	150	11	JN	CAPPED
7.5	150	01	JN	CAPPED
22.3	150	11	JN	CAPPED
23.5	150	11	JN	CAPPED
39.4	150	11	JN	CAPPED
40.3	150	01	JN	CAPPED
53.0	150	11	JN	CAPPED
53.7	150	11	JN	CAPPED
54.5	150	01	JN	CAPPED
69.1	150	01	JN	LIVE
70.0	150	01	JN	LIVE
78.9	150	11	JN	LIVE
85.1	150	01	JN	LIVE
92.8	150	11	CX	
101.1	150	01	JN	

ALL JUNCTION INFORMATION BASED ON CCTV INSPECTION

APEGM
Certificate of Authorization
Stantec Consulting Ltd.
No. 1301 Expiry: April 30, 2010

BENCH MARK: 84R591 - N. side Dowker Ave.
@ South Dr., Tblt. on top of 0.05 m dia. x 2.4 m iron pipe, 1.5 m S. of N. L. of Dowker Ave. & 8.2 m E. of W.L. of South Dr.

BID OPPORTUNITY 536-2009

150 WM	WATERMAIN	150 WM	HYDRO	150 WM	WATERMAIN	150 WM
+	HYDRANT	+	M.T.S.	+	HYDRANT, VALVE	+
⊗	VALVE	⊗	CONCRETE	⊗	LAND DRAINAGE SEWER	⊗
300 LDS	LAND DRAINAGE SEWER	300 LDS	ASPHALT	250 WWS	WASTE WATER SEWER	250 WWS
250 WWS	WASTE WATER SEWER	250 WWS	SIDEWALK	X	PROFILE	X
○	MANHOLE	○	PROPERTY LINE	□	NORTH OR WEST GUTTER	□
▽	CATCH BASIN	▽	SURVEY BAR	⊕	SOUTH OR EAST GUTTER	⊕
□	CURB INLET	□	DITCH	◇	NORTH OR WEST P	◇
+	JUNCTIONS	+	ELEVATION	⊙	SOUTH OR EAST P	⊙
⊚	CULVERT	⊚		△	NORTH OR WEST DITCH	△
⊚	GAS	⊚		▽	SOUTH OR EAST DITCH	▽
EXISTING	LEGEND-PLAN	PROPOSED	EXISTING	LEGEND-PLAN	PROPOSED	EXISTING
---	LEGEND-PROFILE	---	---	---	LEGEND-PROFILE	---

LOCATION APPROVED UNDERGROUND STRUCTURES

DESIGNED BY: J.D.C. CHECKED BY: J.K.H.
DRAWN BY: W.R.A. APPROVED BY: H.A.K.

HOR. SCALE: 1:250
VERTICAL: 1:50

1. REVISED MANHOLE TIE IN 09.08.28 J.K.H.

NO. REVISIONS DATE BY

Stantec Consulting Ltd.
905 Waverley Street, Winnipeg, Manitoba
Tel 204-489-5900 Fax 204-453-9012

THE CITY OF WINNIPEG
WATER AND WASTE DEPARTMENT
ENGINEERING DIVISION

RIVERWOOD AVENUE (CL)
MH AT LYON ST TO IST MH E OF LYON ST

STA. 0+80 TO STA. 2+00
2009 SEWER RENEWAL

SHEET 4 OF 14
CAD FILE DRAWING NUMBER: I480c-201-712.dwg
CITY DRAWING NUMBER: 8860

ORIGINAL SEALED BY: H.A. KATZ P. ENG. 09.08.13

CONSULTANT DRAWING NO. C-203

RELEASED FOR CONSTRUCTION: SIGNED BY K. ZUREK DATE AUG. 13, 2009