

**SEWER JUNCTION INFORMATION
FOR SEWER ID MA60013317**

REFERENCE—METERS SOUTH OF MANHOLE MH60011455

DIST. FROM REF. MANHOLE	JUNCTION DIA.	CLOCK REF.	SERVICE TYPE	DESCRIPTION
2.8	150	09	JN	
6.6	150	09	JN	LIVE—ROOTS
19.7	150	09	JN	
53.8	150	09	JN	LIVE
64.7	150	09	JN	

ALL JUNCTION INFORMATION
BASED ON CCTV INSPECTION

SEWER SERVICE INFORMATION

ADDRESS	SIZE	PROPERTY LINE LOCATION
#14 WILDWOOD F PK AVE RESIDENTIAL	NO INFORMATION	NO INFORMATION
#23 WILDWOOD F PK AVE RESIDENTIAL	NO INFORMATION	NO INFORMATION
#34 WILDWOOD F PK AVE RESIDENTIAL	NO INFORMATION	NO INFORMATION
#47 WILDWOOD F PK AVE RESIDENTIAL	NO INFORMATION	NO INFORMATION

WILDWOOD F PK (S LEG)

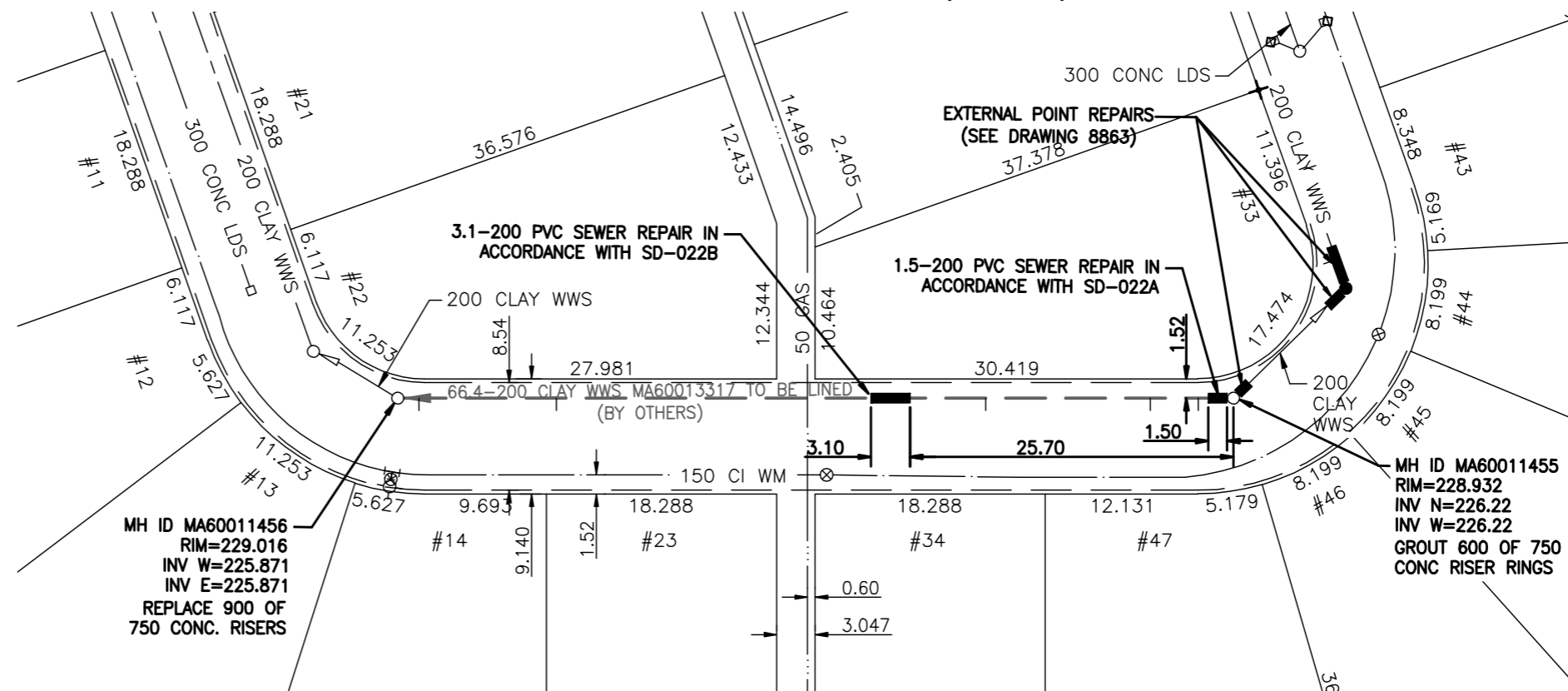

WARNING

IF POWER EQUIPMENT OR EXPLOSIVES ARE TO BE USED FOR EXCAVATION ON THIS PROJECT THE CONTRACTOR MUST:
1) NOTIFY THE GAS COMPANY OF THE PROPOSED LOCATION OF EXCAVATION.
2) TAKE PRECAUTION TO AVOID DAMAGE TO GAS COMPANY INSTALLATIONS.
SEE PROVINCIAL REGULATION 140/92 FOR DETAILS

METRIC

WHOLE NUMBERS INDICATE MILLIMETRES
DECIMALIZED NUMBERS INDICATE METRES

BENCH MARK: S.E. Cor. Oakenwald Ave. & Wildwood St., 19 mm dia. x 6.1 m I.B. in Valve Box, 2.0 m W. of E.L. Wildwood St. & 1.0 m S. of S.L. Oakenwald Ave.

BID OPPORTUNITY 536-2009

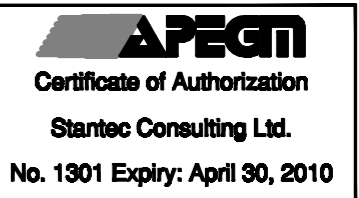

LOCATION APPROVED
UNDERGROUND STRUCTURES

B.M. 64-015 ELEV. 229.000m			
NO.	REVISIONS	DATE	BY

Stantec Consulting Ltd.
905 Waverley Street, Winnipeg, Manitoba
Tel 204-489-5900 Fax 204-453-9012

DESIGNED BY	J.K.H.	CHECKED BY	W.A.B.
DRAWN BY	J.K.H.	APPROVED BY	H.A.K.
HOR. SCALE:	1:500	RELEASED FOR CONSTRUCTION:	SIGNED BY K. ZUREK
VERTICAL:	N/A	DATE	AUG. 13, 2009

ENGINEER'S SEAL

ORIGINAL SEALED BY
H.A. KATZ
P. ENG.
09.08.13

CONSULTANT DRAWING NO.
C-102

THE CITY OF WINNIPEG
WATER AND WASTE DEPARTMENT

2009 SEWER RENEWALS AND EXTERNAL POINT REPAIRS
CONTRACT No. 23
WILDWOOD F PK (S LEG)
1ST MH W OF WILDWOOD F PK (E LEG) TO 2ND MH W OF WILDWOOD F PK (E LEG)
200 WWS POINT REPAIRS

SHEET	OF
6	14
CAD FILE DRAWING NUMBER 11480c-102-712.dwg	
CITY DRAWING NUMBER 8862	

V:\112\winnipeg\11211480\drawing\02_esign\winnipeg\11480c-102-712.dwg
2009-08-13 04:28PM By: jkhan