

- (12) 5 GAL. CARAGANA SHRUB PLANTS
- 11" DEEP BEDDING SOIL
- 10 MIL. POLY-ALL SEAMS & EDGES TAPED
- 1" STYROFOAM SM RIGID INSULATION BASE & PROTECTION BOARDS @ SIDES
- BITUTHENE 3000 WATERPROOFING MEMBRANE APPLIED TO SLAB FACE & SIDES OF WALLS ABOVE SLAB
- 5" THICK REINFORCED CONCRETE RECESSED COVER SLAB C/W 10M @ 12" O.C. EACH WAY & 15M x 18" LG. DOWELS @ 12" O.C. DRILL & EPOXY GROUT MIN. 6" INTO EXISTING CONCRETE STAIRWELL WALLS AROUND ENTIRE PERIMETER OF NEW SLAB & NEW MASONRY BLOCK WALL
- VICWEST H8938 Z 275 0.030" GALVANIZED METAL DECK C/W SIDE & END CLOSURE FITMENTS AS REQUIRED
- NEW CONTIN. STEEL 'L' 3" x 3" x 3/8" ANGLE LEDGE BELOW SLAB BOLTED TO NORTH & SOUTH WALLS W/ HILTI HUS-H 1/2" x 3" SCREW ANCHORS @ 24" O.C.

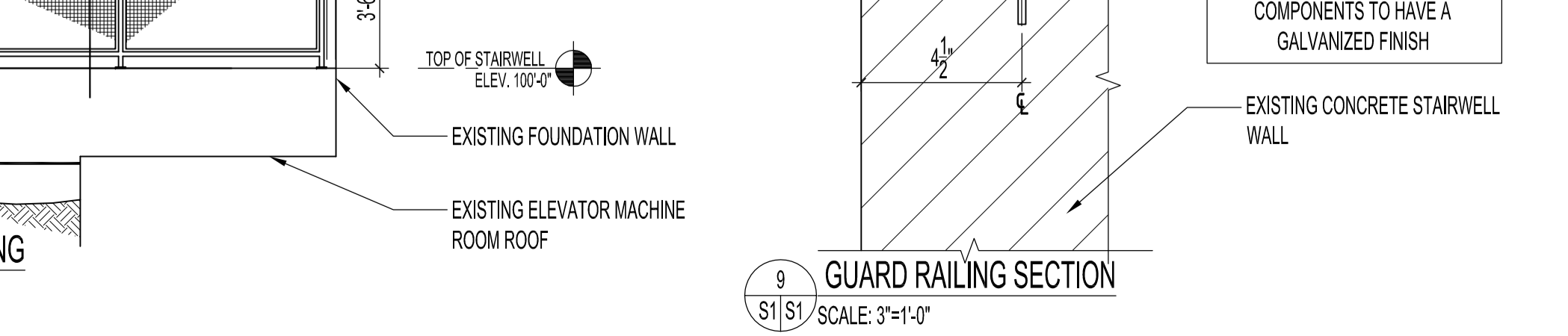
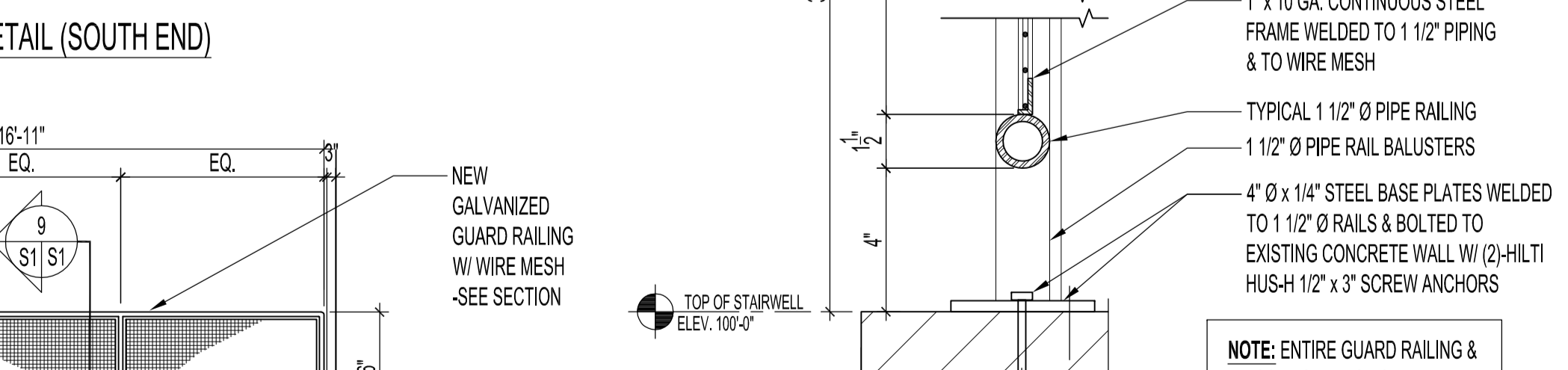
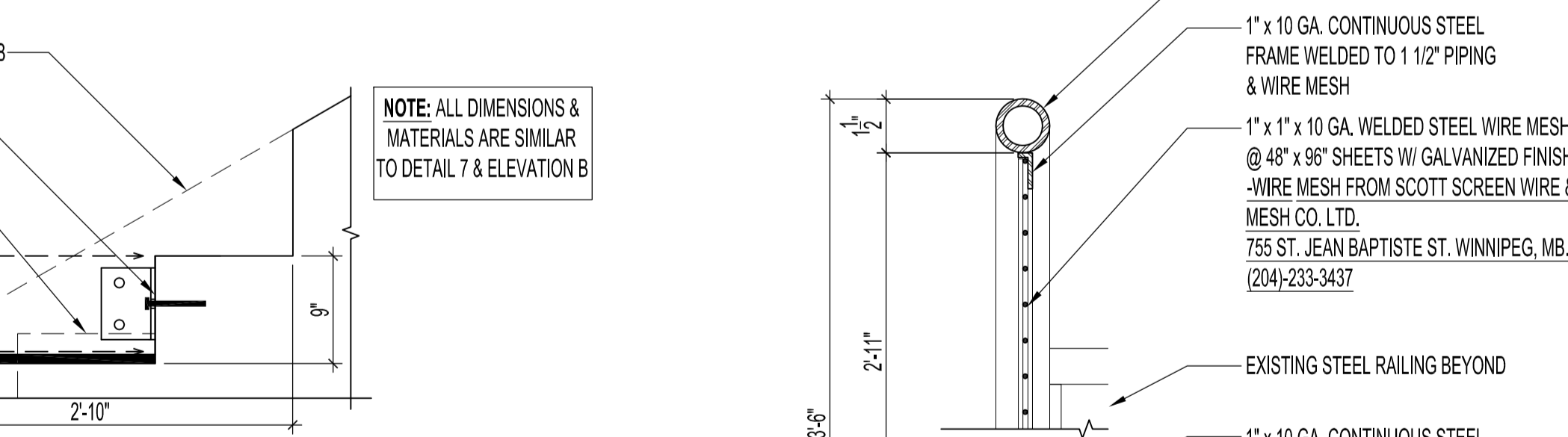
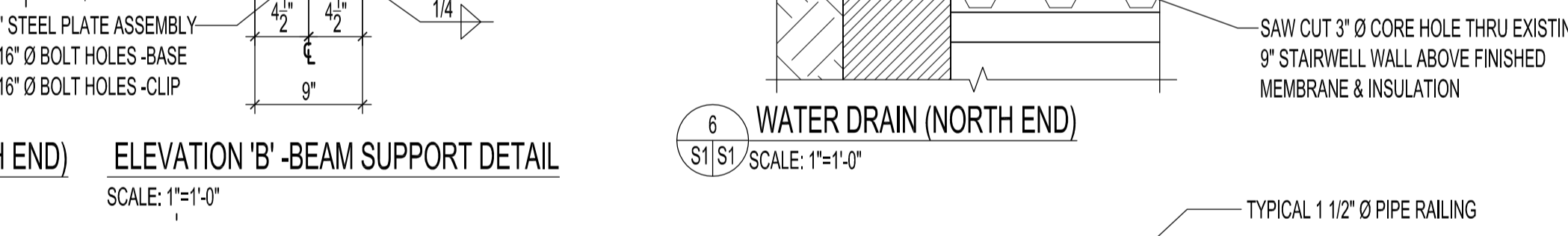
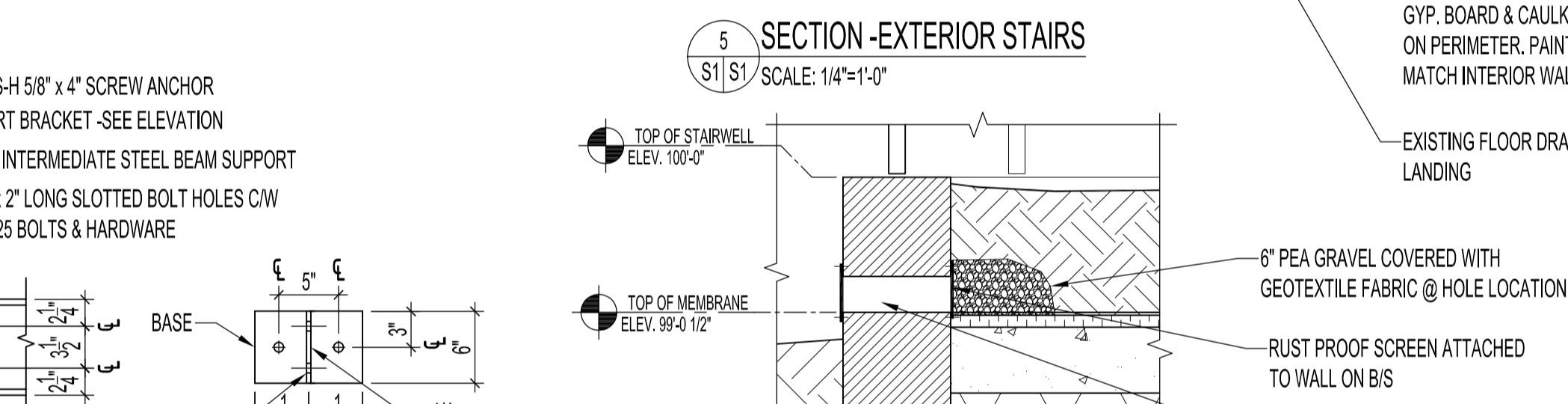
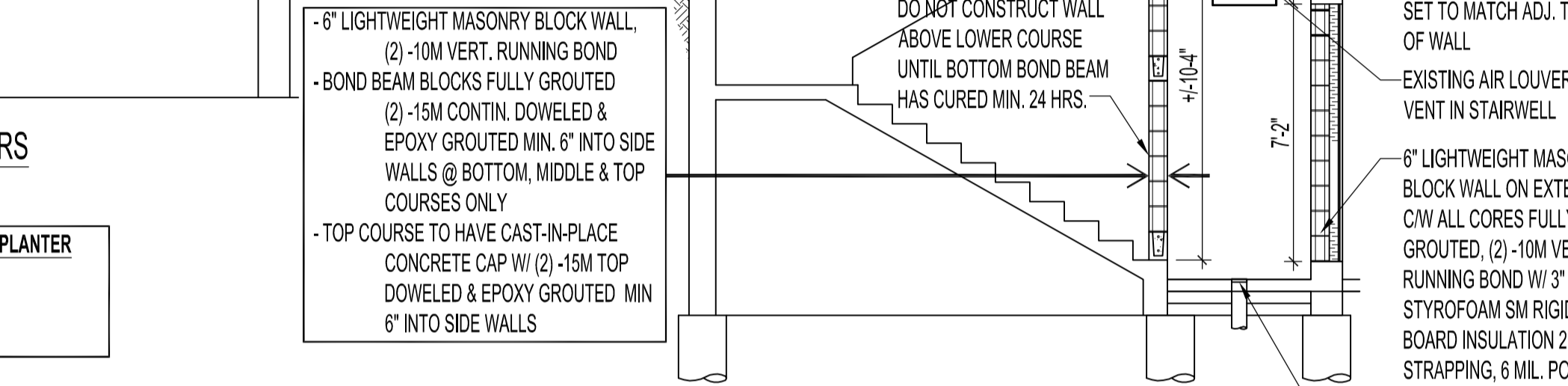
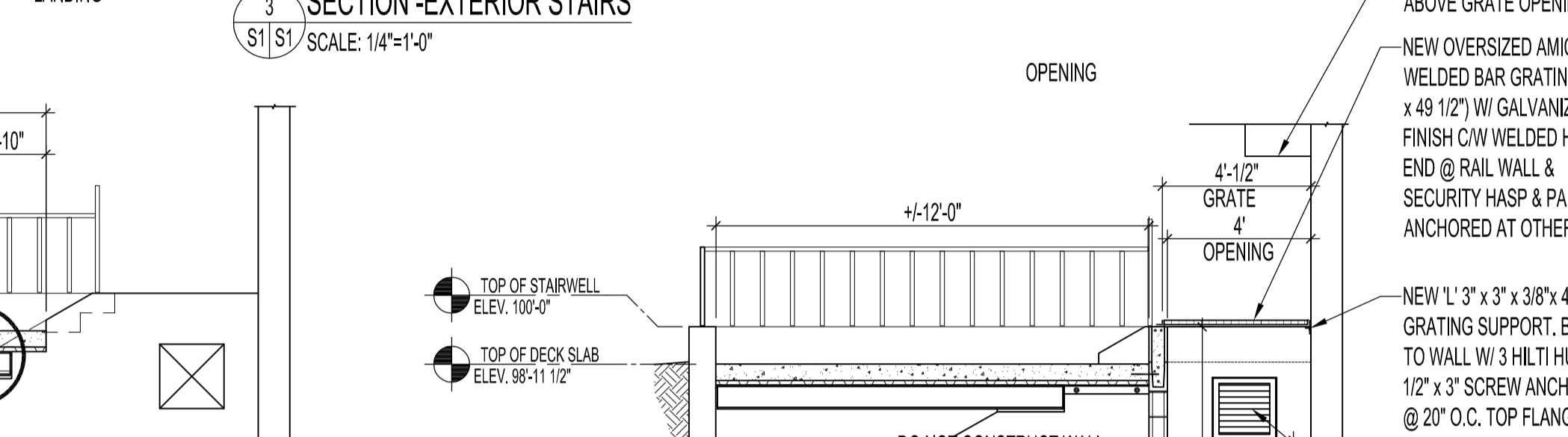
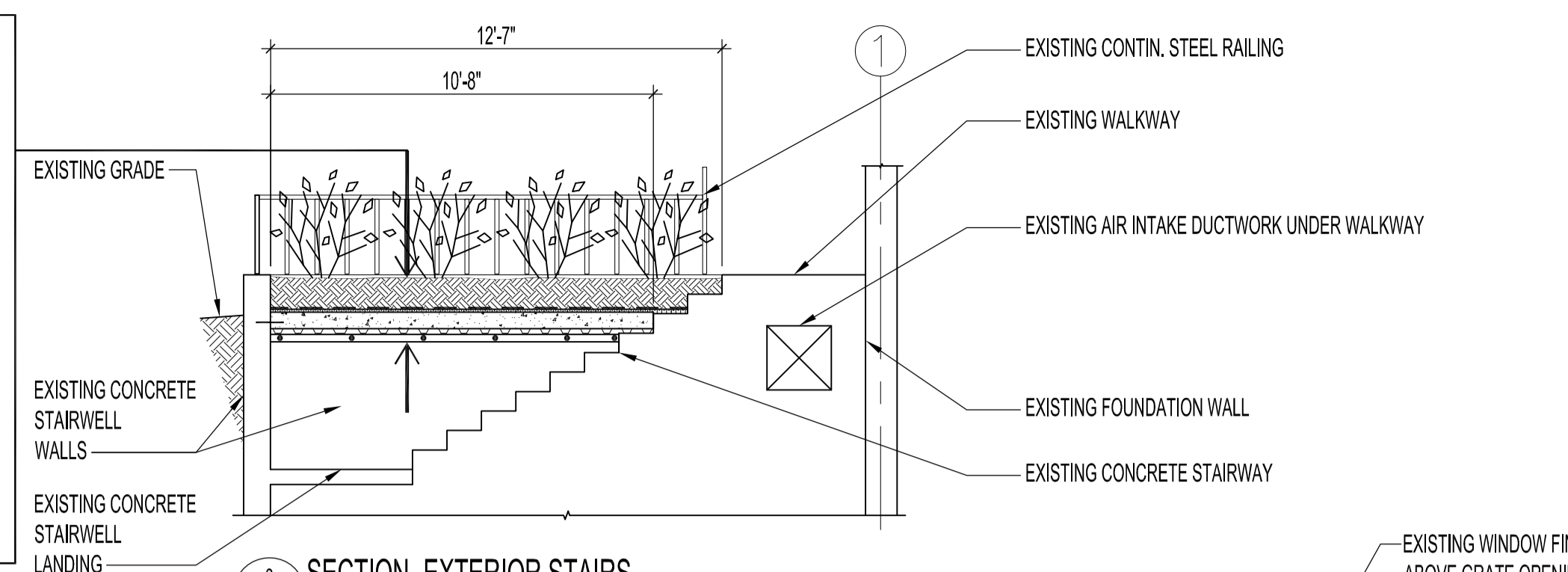

NOTES :

ALL DIMENSIONS MUST BE FIELD VERIFIED & CONFIRMED ON-SITE BY THE CONTRACTOR.

REPORT DEVIATIONS IN FIELD CONDITIONS OR DESIGN DRAWINGS TO THE CONTRACT ADMINISTRATOR.

PROTECT EXISTING SITE STRUCTURES AND UTILITIES DURING THE WORK.

PROVIDE SITE CLEAN-UP AT THE END OF THE WORK, TO THE SATISFACTION OF THE CONTRACT ADMINISTRATOR.

FABRICATION/INSTALLATION SPECIFICATIONS AND NOTES

SUPPLY AND FABRICATION OF STEEL COMPONENTS SHALL MEET THE REQUIREMENTS OF: STRUCTURAL SHAPES - CAN/CSA G40.20/C40.21 OR ASTM A992/A992M; BARS - CAN/CSA G31.1/G31.2; BOLTS - A325; WELDING - CAN/CSA-S16 AND CSA W59.

REINFORCING STEEL SHALL CONFORM TO CAN/CSA - G-30.18 GRADE 400W.

CONCRETE MATERIALS AND PLACEMENT SHALL CONFORM TO CAN/CSA - A23.1-04.

EXPOSURE CLASS C-2

32 MPa TYPE 10

MAXIMUM WATER/CEMENT RATIO 0.45

5-8% AIR ENTRAINMENT

MASONRY CONSTRUCTION & MATERIALS SHALL CONFORM TO CAN/CSA - A371-04 & CAN/CSA - A179-04.

WHERE NEW CONCRETE IS TO BE JOINED TO EXISTING CONCRETE, THOSE SURFACES SHALL BE ADEQUATELY PREPARED TO ENSURE FULL STRENGTH BOND. REMOVE SURFACE PARGING AND SCALE DOWN TO SOUND BASE.

NEW ASSEMBLIES SHALL BE SHOP FABRICATED TO THE FULLEST EXTENT POSSIBLE. FIELD WORK SHALL BE LIMITED TO INSTALLATIONS, REPAIRS, AND TOUCH UPS, UNLESS NOTED OTHERWISE.

THE CONTRACTOR IS RESPONSIBLE FOR SURVEYING AND ESTABLISHING ALL WORK ELEVATIONS, LINES AND POINTS, AND ANCHOR BOLT LOCATIONS.

STRUCTURAL STEEL SHALL BE SHOP FINISHED WITH PROTECTIVE COATING.

PREPARATION AND APPLICATION OF ALL THIRD PARTY PRODUCTS SHALL BE IN FULL ACCORDANCE WITH THE RESPECTIVE MANUFACTURER'S SPECIFICATIONS.

NO PRODUCT SUBSTITUTIONS WITHOUT THE PRIOR APPROVAL OF THE CONTRACT ADMINISTRATOR.

ORIGINAL STAMPED BY: B. C. PINIUTA, P. ENG.
DATE: 2008.07.22

NO.	REVISION/DESCRIPTION	BY	DATE
SEALS			

DRAWN BY MMK **CHECKED BY** USER **APPROVED** USER
DATE 2007.07.22

CITY OF WINNIPEG
PLANNING, PROPERTY & DEVELOPMENT DEPARTMENT
CIVIC ACCOMMODATIONS DIVISION
300 - 65 GARRY ST. R3C 4K4

PROJECT
WEST KILDONAN LIBRARY
FACILITY EXIT UPGRADE

365 JEFFERSON AVENUE
SHEET TITLE
PARTIAL MAIN FLOOR PLAN
EXTERIOR STAIR DEMOLITION,
RENOVATION, SECTION & DETAILS

SCALE	PROJECT NO.	SHEET NO.
AS SHOWN	2005055	S1