

NOTE: CHAINAGES SHOWN ARE ALONG N R OF TALBOT AVE

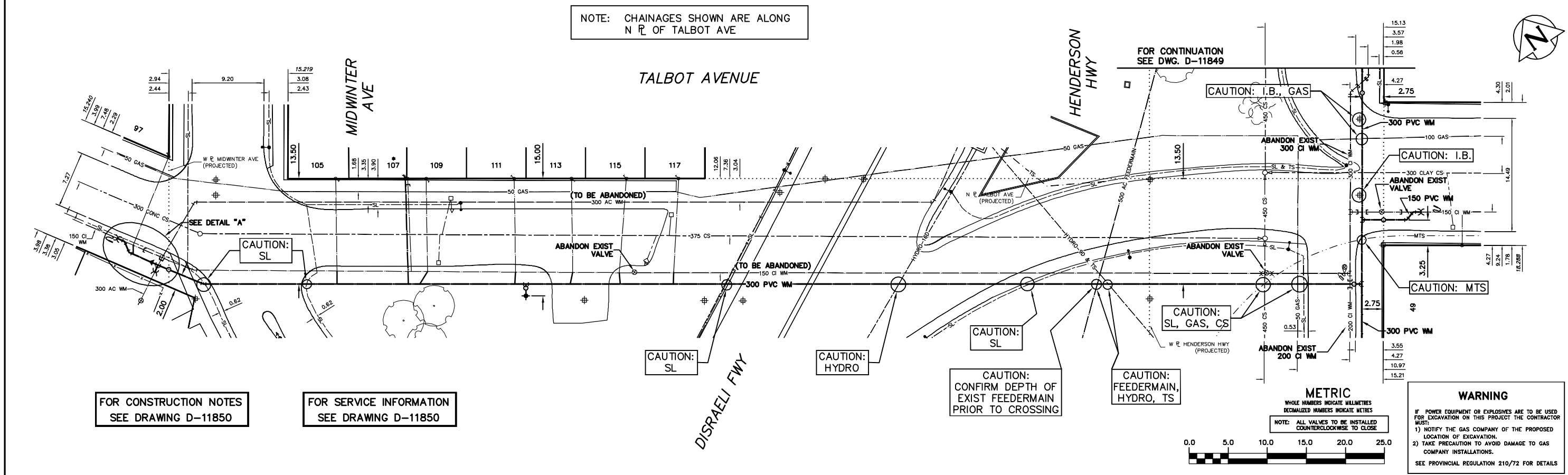

EXISTING	LEGEND-PLAN	PROPOSED	EXISTING	LEGEND-PLAN	PROPOSED	EXISTING	LEGEND-PROFILE	PROPOSED
200 WM	WATERMAIN	200 WM	SL, HYDRO	SL, HYDRO	150 WM	WATERMAIN	150 WM	
525 LDS	LAND DRAINAGE SEWER	525 LDS	MTS	TRAFFIC SIGNALS	50 GAS	HYDRANT	50 GAS	
375 WWS	WASTEWATER SEWER	375 WWS	GAS	SURVEY BAR	300 LDS	VALVE	300 LDS	
○	MANHOLE	●	* * * *	FENCE	250 WWS	⊕	250 WWS	
□	CATCH BASIN	■	* H * T	POLE - HYDRO, MTS	⊕	⊕	⊕	
▽	CURB INLET	▽	⊕	CURB STOP	⊕	⊕	⊕	
∇	REDUCER	∇	⊕	GUY ANCHOR	⊕	⊕	⊕	
X	COUPLER	X	⊕	LIGHT STANDARD	⊕	⊕	⊕	
⊕	ANODE	⊕	⊕	TREE	⊕	⊕	⊕	

LOCATION APPROVED	FIELD BOOK #:
UNDERGROUND STRUCTURES	
SUPV. U/G STRUCTURES COMMITTEE	
DATE	
NOTE:	
LOCATION OF UNDERGROUND STRUCTURES AS SHOWN ARE BASED ON THE BEST INFORMATION AVAILABLE BUT NO GUARANTEE IS GIVEN THAT ALL EXISTING UTILITIES ARE SHOWN OR THAT THE GIVEN LOCATIONS ARE EXACT. CONFIRMATION OF EXISTENCE AND EXACT LOCATION OF ALL SERVICES MUST BE OBTAINED FROM THE INDIVIDUAL UTILITIES BEFORE PROCEEDING WITH CONSTRUCTION.	

DESIGNED BY	CHECKED BY
AS	SC/KZ
DRAWN BY	APPROVED BY
CJH	KZ
HOR. SCALE	RELEASED FOR CONSTRUCTION
1:250	K.R. ZUREK
VERTICAL	DATE
1:50	2009 08 07

ENGINEER'S SEAL
ORIGINAL SIGNED BY A. SINGBEIL
09/08/07
BID OPPORTUNITY 596-2009
FILENAME: D-11847.dwg
PLOT DATE: 2009 08 07

THE CITY OF WINNIPEG
WATER AND WASTE DEPARTMENT

2009 WATERMAIN RENEWALS
CONTRACT 42
TALBOT AVENUE
MIDWINTER AVENUE TO
HENDERSON HIGHWAY

SHEET 1 OF 6
CITY DRAWING NUMBER
D-11847