

TYPICAL SIDEWALK DETAIL  
1:10

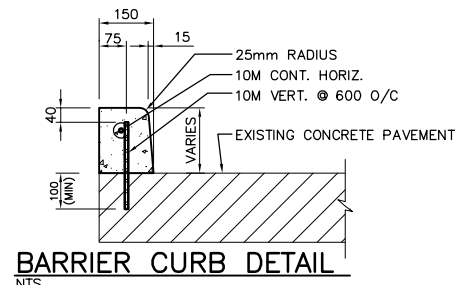

BARRIER CURB DETAIL  
NTS

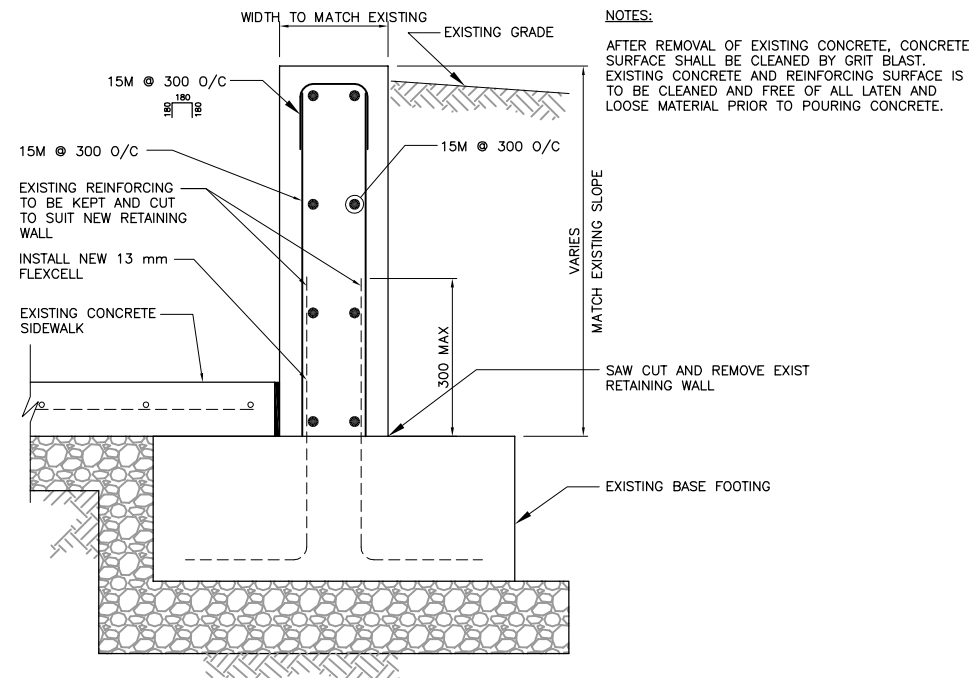

RETAINING WALL REPAIR DETAIL  
1:10

NOTES:  
AFTER REMOVAL OF EXISTING CONCRETE, CONCRETE SURFACE SHALL BE CLEANED BY GRIT BLAST. EXISTING CONCRETE AND REINFORCING SURFACE IS TO BE CLEANED AND FREE OF ALL LATEN AND LOOSE MATERIAL PRIOR TO POURING CONCRETE.

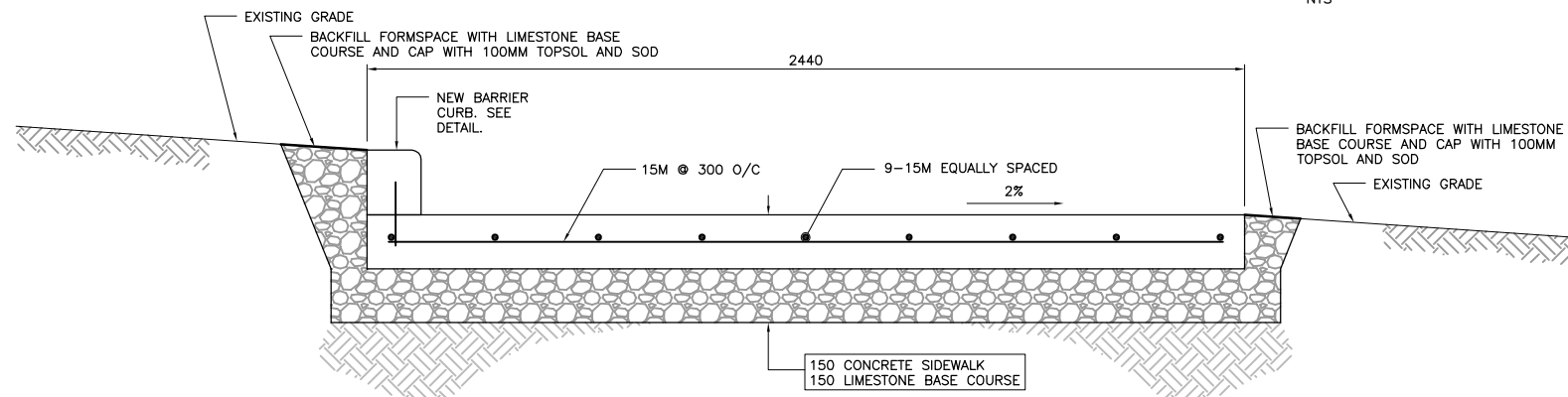

SECTION A  
1:10

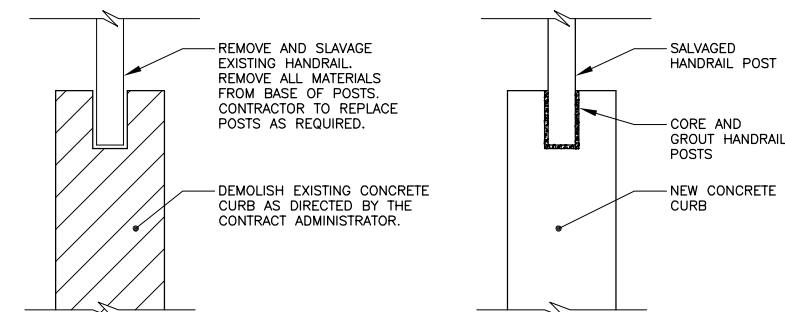

HANDRAIL POST REMOVAL DETAIL  
1:10

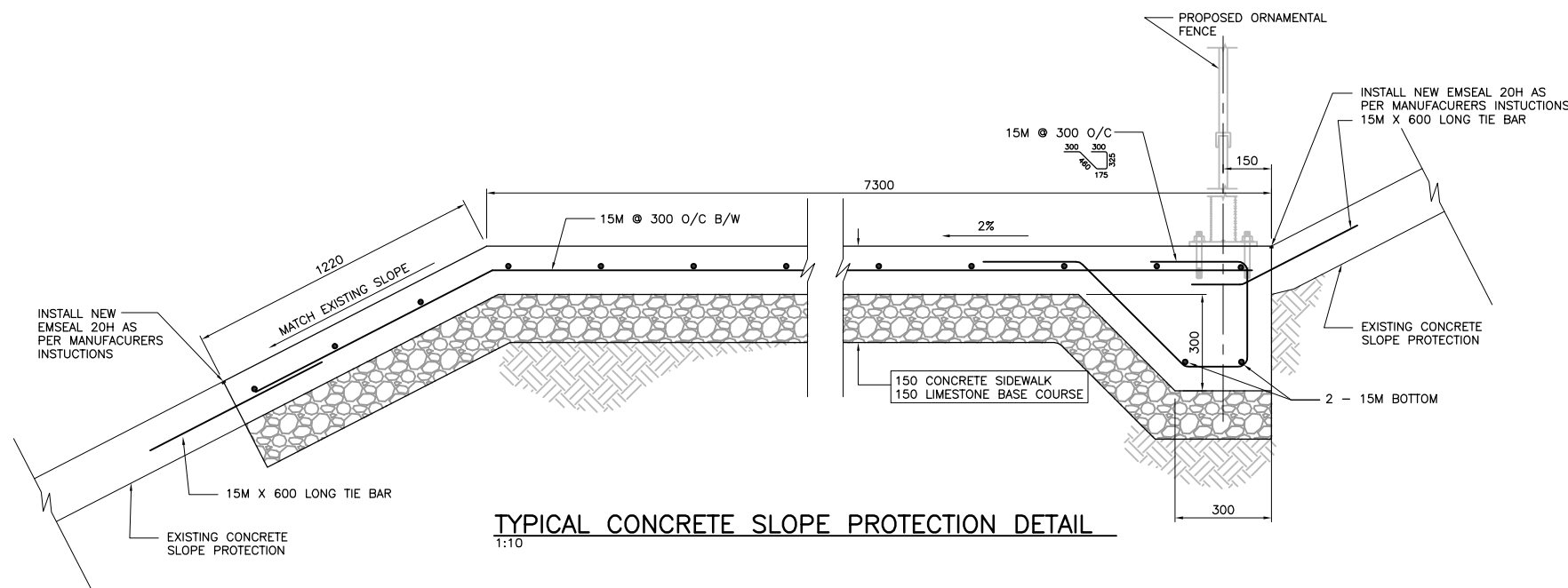

TYPICAL CONCRETE SLOPE PROTECTION DETAIL  
1:10

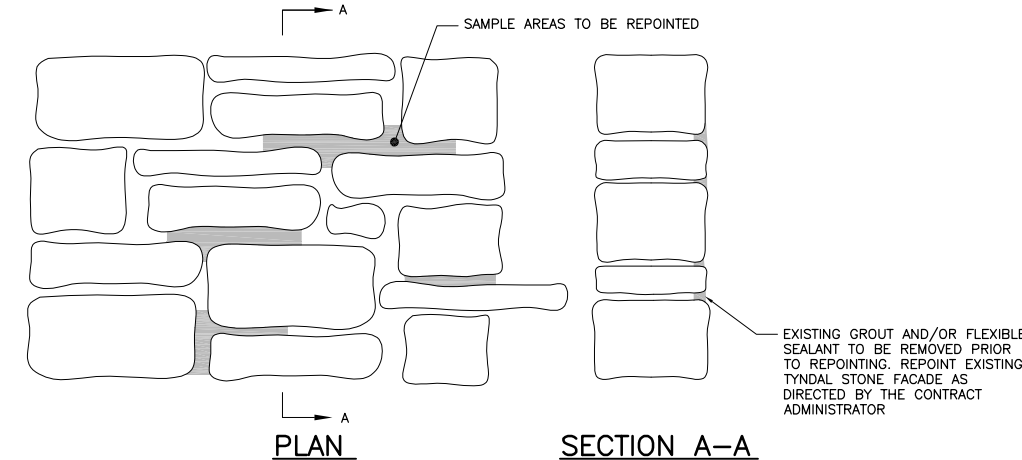

TYPICAL TYNDALL STONE FACADE REPOINTING DETAIL  
NTS

B.M. ELEV.	DESIGNED BY DDW		ENGINEER'S SEAL	ENGINEER'S SEAL
	DRAWN BY DDW			
	CHECKED BY JSB			
	REVIEWED BY JSB			
	HOR. SCALE			
	VERTICAL	RELEASED FOR CONSTRUCTION		
NO. REVISIONS	DATE	BY	DATE	AUGUST 2009

CONSULTANT PROJECT NO. 05-5069-4000	
--	--

<b>THE CITY OF WINNIPEG</b> PUBLIC WORKS DEPARTMENT	
MARYLAND TWIN BRIDGES REHABILITATION PROJECT MAJOR REPAIRS TO NORTH END PEDESTRIAN RAMPS AND STAIRS	CITY DRAWING NUMBER B108-09-07 SHEET 08 OF 09
CONCRETE SIDEWALK AND RETAINING WALL DETAILS	BID OPPORTUNITY 630-2009