

- CONSTRUCTION NOTES:**
- CONTRACTOR SHALL TAKE PRECAUTIONARY STEPS TO AVOID DAMAGE FROM CONSTRUCTION ACTIVITIES TO EXISTING BOULEVARDS AND TREES WITHIN THE LIMITS OF CONSTRUCTION.
 - SEWER AND SEWER SERVICES TO BE INSTALLED BY TRENCHLESS METHODS UNLESS OTHERWISE SPECIFIED.
 - LOCATION OF EXISTING UTILITIES TO BE CONFIRMED IN THE FIELD BY THE CONTRACTOR.
 - LIMITS OF SIDEWALK RENEWALS TO BE FINALIZED IN THE FIELD BY THE CONTRACT ADMINISTRATOR.
 - BOULEVARD REPLACEMENT TO BE FINALIZED IN THE FIELD BY THE CONTRACT ADMINISTRATOR.
 - CONTRACTOR TO PLUG ANY ABANDONED PIPES THAT ARE BROKEN DURING CONSTRUCTION.
 - TRENCHES & EXCAVATIONS WITHIN 1 METRE OF A PAVED AREA INCLUDING SIDEWALKS SHALL BE CLASS 3 BACKFILL.
 - BACKFILL IN BOULEVARD TO BE CLASS 5.
 - CB LEADS TO BE INSTALLED AT MIN. 1.0% SLOPE OR AS DIRECTED BY CONTRACT ADMINISTRATOR.
 - CONTRACTOR TO CONFIRM THE NUMBER AND LOCATION OF SEWER SERVICES TO BE RECONNECTED.

NOTE: CHAINAGES SHOWN ARE ALONG S PL OF NORTH DR.

EXISTING SEWER SERVICE LOCATION RECORDS		
ADDRESS	SIZE/TYPE	SERVICE LOCATION AT PL
NORTH DR	INFO NOT AVAILABLE	INFO NOT AVAILABLE

SEWER SERVICE INFORMATION (S-MA60013427) *
 DISTANCE FROM MH @ WILDWOOD B PK N LEG (S-MH60017726)
 NO SERVICES ON ENTITY
 * - INFORMATION FROM SEWER VIDEO INSPECTION

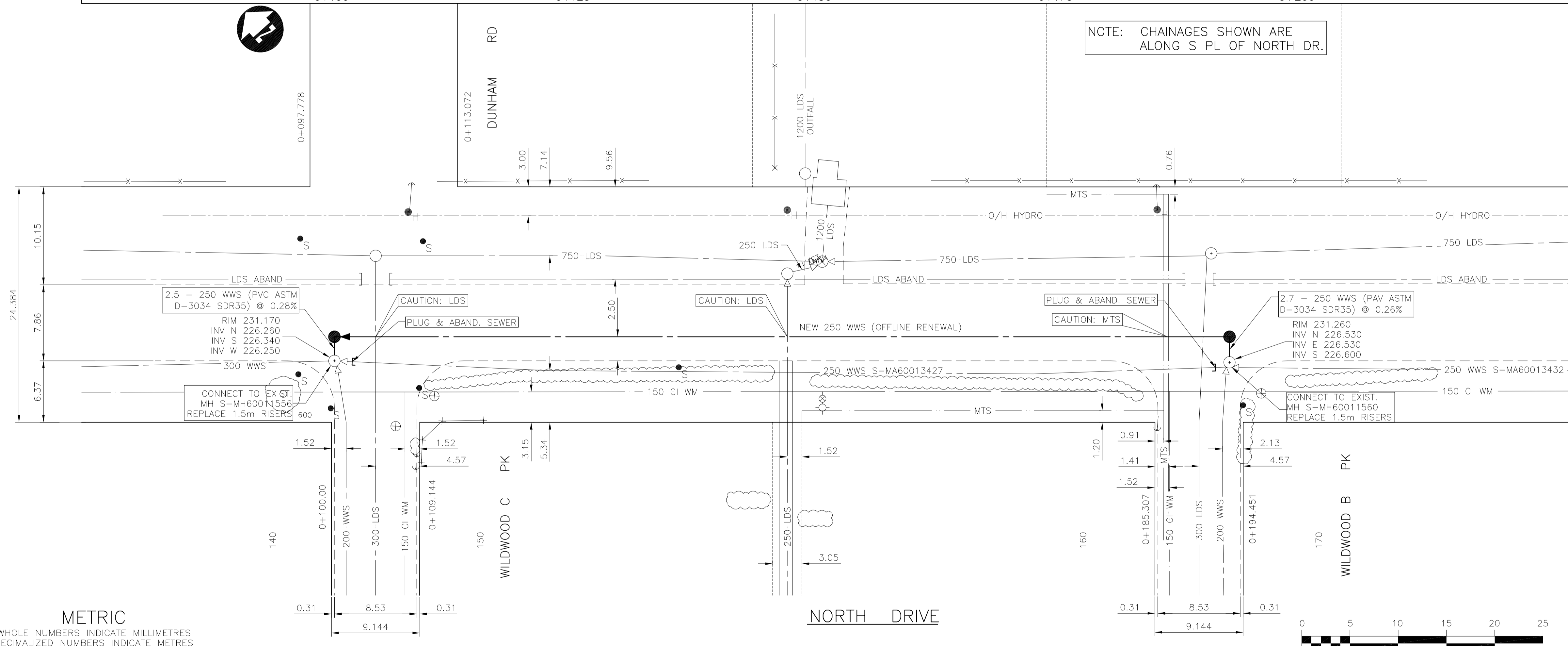

METRIC
 WHOLE NUMBERS INDICATE MILLIMETRES
 DECIMALIZED NUMBERS INDICATE METRES



150 mm W.M.	WATERMAIN	150 mm W.M.	HYDRO	150 mm W.M.	WATERMAIN	150 mm W.M.	UNDERGROUND STRUCTURES	B.M. ELEV. 64-016 230.655	DESIGNED BY C.L.P.			
300 mm L.D.S.	LAND DRAINAGE SEWER	300 mm L.D.S.	M.T.S. CONCRETE	300 mm L.D.S.	LAND DRAINAGE SEWER	300 mm L.D.S.	DATE	DRAWN BY A.J.P./S.K.B.	PROVINCE OF MANITOBA D.P. KRAHN 10/07/09 Member 4226 REGISTERED PROFESSIONAL ENGINEER			
250 mm W.W.S.	WASTE WATER SEWER	250 mm W.W.S.	PROPERTY LINE	250 mm W.W.S.	WASTE WATER SEWER	250 mm W.W.S.	SUPPLY U/S STRUCTURES COMMITTEE	CHECKED BY S.C.C.	APPROVED BY D.P.K.	RELEASSED FOR CONSTRUCTION	CONSULTANT PROJECT NO. 09-1893-2000	CITY DRAWING NUMBER 9087
○	MANHOLE	⊕	SURVEY BAR	⊕	⊕ PROFILE	⊕	NOTE: LOCATION OF UNDERGROUND STRUCTURES AS SHOWN ARE BASED ON THE BEST INFORMATION AVAILABLE BUT NO GUARANTEE IS GIVEN THAT ALL EXISTING UTILITIES ARE SHOWN OR THAT THE GIVEN LOCATIONS ARE EXACT. CONFIRMATION OF EXISTENCE AND EXACT LOCATION OF ALL SERVICES MUST BE OBTAINED FROM THE INDIVIDUAL UTILITIES BEFORE PROCEEDING WITH CONSTRUCTION.	HOR. SCALE 1 : 250	DATE AUG. 26, 2009	DATE	2009 SEWER RENEWALS AND REPAIRS, CONTRACT 19	SHEET 2 OF 25
▽	CATCH BASIN	⊕	SERVICE VALVE	⊕	⊕ NORTH/WEST GUTTER	⊕		VERTICAL 1 : 50			MH AT WILDWOOD C PK. (S LEG) TO MH AT WILDWOOD B PK. (N LEG)	BID OPPORTUNITY 658-2009
□	CURB INLET	⊕	TREE	⊕	⊕ SOUTH/EAST GUTTER	⊕						
+	JUNCTIONS	⊕	LIGHT STANDARD	⊕		⊕						
—	CULVERT	⊕	FENCE	⊕		⊕						
—	GAS	⊕	GUY ANCHOR	⊕		⊕						
—	EXISTING	⊕	LEGEND-PLAN	⊕	LEGEND-PROFILE	⊕						