

NOTES:

1. BACKFILL UNDER PAVEMENT, IN SIDEWALKS, & WITHIN 1.0 m OF PAVEMENT TO BE CLASS 3.
2. CONFIRM LIMITS OF REPAIR IN PRESENCE OF THE CONTRACT ADMINISTRATOR BY CCTV.

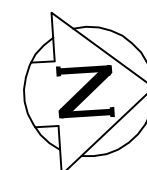

KINKORA DRIVE

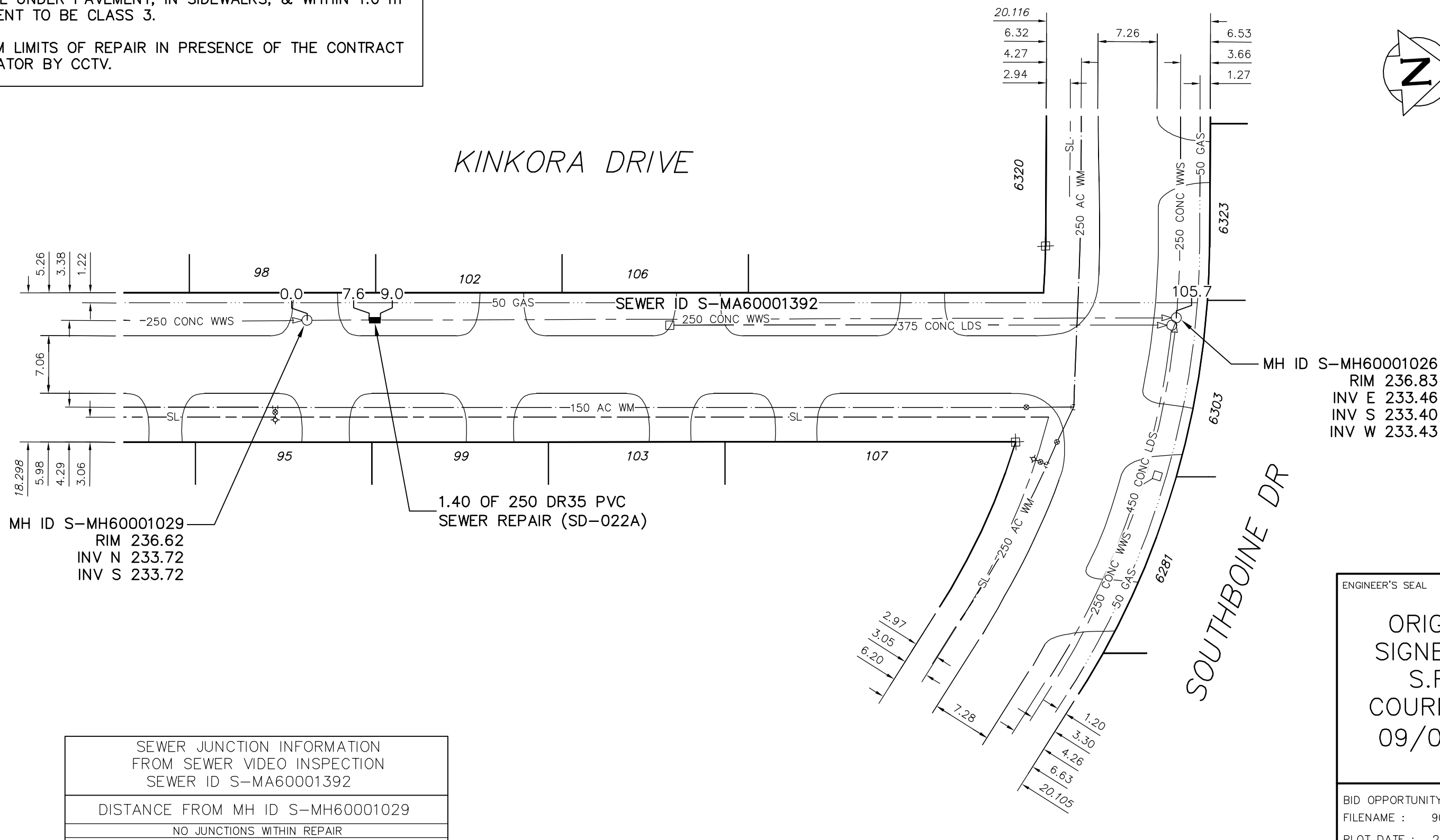

MH ID S-MH60001026
 RIM 236.83
 INV E 233.46
 INV S 233.40
 INV W 233.43

MH ID S-MH60001029
 RIM 236.62
 INV N 233.72
 INV S 233.72

1.40 OF 250 DR35 PVC
 SEWER REPAIR (SD-022A)

SEWER JUNCTION INFORMATION FROM SEWER VIDEO INSPECTION SEWER ID S-MA60001392
DISTANCE FROM MH ID S-MH60001029
NO JUNCTIONS WITHIN REPAIR

ENGINEER'S SEAL

ORIGINAL
 SIGNED BY
 S.R.J.
 COURNOYER
 09/09/16

BID OPPORTUNITY: 669-2009
 FILENAME : 9009.dwg
 PLOT DATE : 2009 09 17

LEGEND:

52.0 | MEASUREMENT TO REPAIR FROM REFERENCE MH SHOWN THUS...

METRIC
 WHOLE NUMBERS INDICATE MILLIMETRES
 DECIMALIZED NUMBERS INDICATE METRES

B.M. ELEV.	FIELD BOOK #:	CITY OF WINNIPEG WATER AND WASTE ENGINEERING DIVISION	THE CITY OF WINNIPEG WATER AND WASTE DEPARTMENT	2009 SEWER REPAIRS CONTRACT 45 KINKORA DRIVE 1ST MH S OF SOUTHBOINE DRIVE TO MH AT SOUTHBOINE DRIVE	SHEET 12 OF 23 CITY DRAWING NUMBER 9009
POSTED TO LBIS					
DESIGNED BY	AMC	CHECKED BY	SC		
DRAWN BY	CJH	APPROVED BY	KZ		
HOR. SCALE	1:500	RELEASED FOR CONSTRUCTION			
VERTICAL					
NO.	REVISIONS	DATE	BY	DATE	2009 09 17