

NOTES:

1. BACKFILL UNDER PAVEMENT, IN SIDEWALKS, & WITHIN 1.0 m OF PAVEMENT TO BE CLASS 3.
2. CONFIRM LIMITS OF REPAIR IN PRESENCE OF THE CONTRACT ADMINISTRATOR BY CCTV.

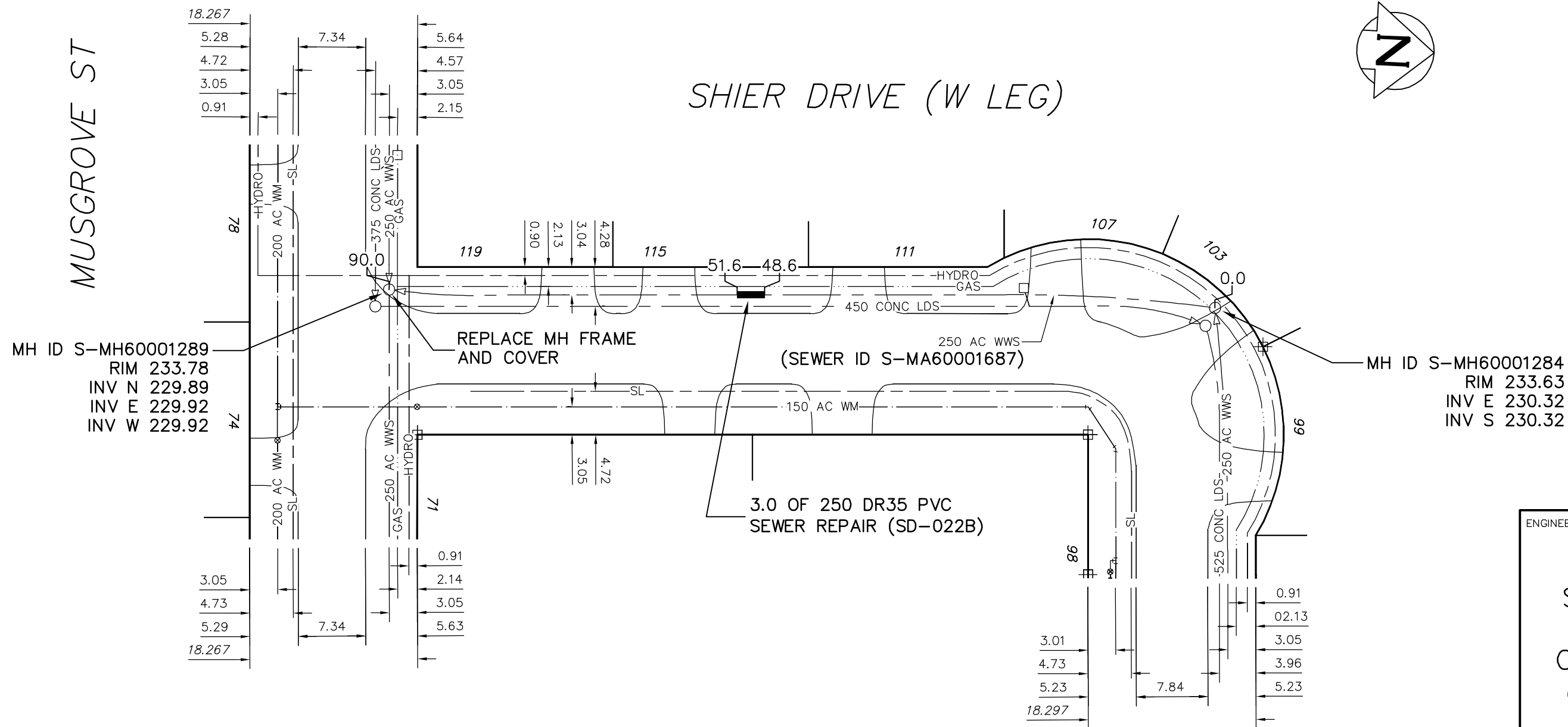

MH ID S-MH60001289
RIM 233.78
INV N 229.89
INV E 229.92
INV W 229.92

MH ID S-MH60001284
RIM 233.63
INV E 230.32
INV S 230.32

SEWER JUNCTION INFORMATION FROM SEWER VIDEO INSPECTION SEWER ID S-MA60001687
DISTANCE FROM MH ID S-MH600012866
NO JUNCTIONS WITHIN REPAIR

ENGINEER'S SEAL

ORIGINAL
SIGNED BY
S.R.J.
COURNOYER
09/09/16

BID OPPORTUNITY: 669-2009
FILENAME : 9012.dwg
PLOT DATE : 2009 09 17

LEGEND:

52.0 | MEASUREMENT TO REPAIR FROM REFERENCE MH SHOWN THUS...

METRIC
WHOLE NUMBERS INDICATE MILLIMETRES
DECIMALIZED NUMBERS INDICATE METRES

B.M. ELEV. POSTED TO LBIS	FIELD BOOK #	CITY OF WINNIPEG WATER AND WASTE ENGINEERING DIVISION		THE CITY OF WINNIPEG WATER AND WASTE DEPARTMENT	
DESIGNED BY AMC	CHECKED BY SC	2009 SEWER REPAIRS CONTRACT 45		SHEET 15 OF 23	
DRAWN BY C.J.H.	APPROVED BY K.Z.	SHIER DRIVE (W LEG) MH AT SHIER DRIVE (N LEG) TO MH AT MUSGROVE STREET		CITY DRAWING NUMBER 9012	
HOR. SCALE VERTICAL 1:500	RELEASED FOR CONSTRUCTION	DATE 2009 09 17		DATE	
NO. REVISIONS	DATE	BY	DATE		