

CUNNINGTON AVENUE

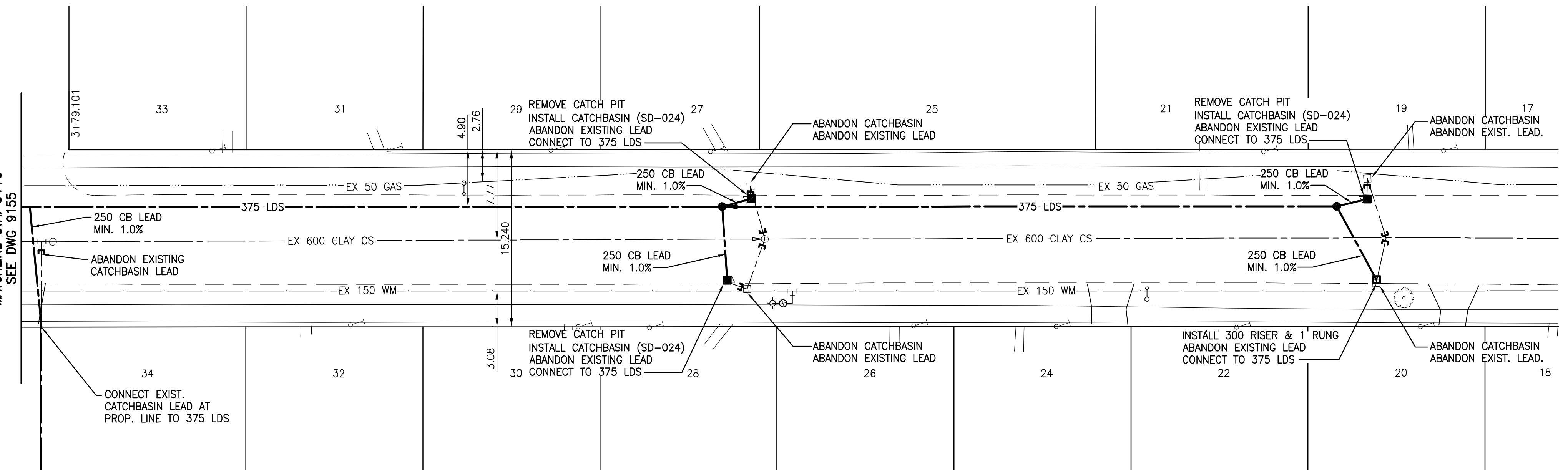
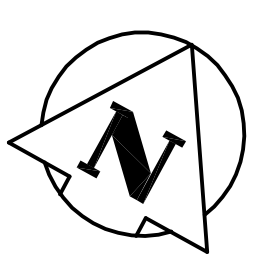

WATER SERVICE INFORMATION					
ADDRESS	SIZE (mm) & TYPE (STREET)	DIST TO PROP	SHORT & LONG MEASUREMENT	CORP MEASUREMENT	REMARKS
17 CUNNINGTON AVE. RESIDENTIAL	-	-	-	-	-
19 CUNNINGTON AVE. RESIDENTIAL	19 COPPER	-	0.91 E/VEH	-	-
21 CUNNINGTON AVE. RESIDENTIAL	19 COPPER	-	1.07 W/VEH	-	-
25 CUNNINGTON AVE. RESIDENTIAL	19 COPPER	-	5.49 E/WHL	-	-
27 CUNNINGTON AVE. RESIDENTIAL	19 COPPER	-	2.14 W/VEH	-	-
29 CUNNINGTON AVE. RESIDENTIAL	19 COPPER	-	0.91 W/VEH	-	-
31 CUNNINGTON AVE. RESIDENTIAL	19 COPPER	-	1.07 W/VEH	-	-
33 CUNNINGTON AVE. RESIDENTIAL	19 COPPER	-	0.61 W/VEH	-	-

SEWER SERVICE INFORMATION			
ADDRESS	SIZE & TYPE	PROPERTY LINE LOCATION	JUNCTION LOCATION
17 CUNNINGTON AVE.	-	-	-
19 CUNNINGTON AVE.	-	-	-
21 CUNNINGTON AVE.	-	-	-
25 CUNNINGTON AVE.	-	-	-
27 CUNNINGTON AVE.	-	-	-
29 CUNNINGTON AVE.	-	-	-
31 CUNNINGTON AVE.	-	-	-
33 CUNNINGTON AVE.	-	-	-

BID OPPORTUNITY NO. 921-2009

WARNING
 IF POWER EQUIPMENT OR EXPLOSIVES ARE TO BE USED FOR EXCAVATION ON THIS PROJECT THE CONTRACTOR MUST:
 1) NOTIFY THE GAS COMPANY OF THE PROPOSED LOCATION OF EXCAVATION.
 2) TAKE PRECAUTION TO AVOID DAMAGE TO GAS COMPANY INSTALLATIONS.
 SEE PROVINCIAL REGULATION 140/92 FOR DETAILS

METRIC
 WHOLE NUMBERS INDICATE MILLIMETRES
 DECIMALIZED NUMBERS INDICATE METRES

- CONSTRUCTION NOTES:**
- ALL NEW SEWERS AND SEWER SERVICES TO BE INSTALLED BY TRENCHLESS METHODS.
 - SEWER SERVICE LOCATIONS TO BE CONFIRMED PRIOR TO CONSTRUCTION.
 - EXCAVATIONS WITHIN 1.0m OF PAVEMENT TO BE BACKFILLED WITH CLASS 3 MATERIAL.
 - NEW SEWER SERVICES RENEWED TO PROPERTY LINE TO HAVE A MINIMUM SLOPE OF 1.0%.



NOTE:
 STATIONING IS ALONG C OF ROAD

BENCH MARK: S.W. Cor. Kingston Row & Killarney St., Tibit, on top of 0.05m dia. x 2.4m iron pipe, 1.4m N. of S.L. Kingston Row & 11.6m W. of E.L. Killarney St.

EXISTING	LEGEND-PLAN	PROPOSED	EXISTING	LEGEND-PLAN	PROPOSED	EXISTING	LEGEND-PROFILE	PROPOSED
150 WM	WATERMAIN	150 WM	HYDRANT	M.T.S.	150 WM	WATERMAIN	HYDRANT, VALVE	150 WM
300 LDS	LAND DRAINAGE SEWER	300 LDS	VALVE	CONCRETE	300 LDS	LAND DRAINAGE SEWER	300 LDS	300 LDS
250 WWS	WASTE WATER SEWER	250 WWS	MANHOLE	ASPHALT	250 WWS	WASTE WATER SEWER	250 WWS	250 WWS
			CATCH BASIN	PROPERTY LINE				
			CURB INLET	SURVEY BAR				
			JUNCTIONS					
			GAS					

LOCATION APPROVED UNDERGROUND STRUCTURES

SUPV. U/G STRUCTURES COMMITTEE DATE

NOTE:
 LOCATION OF UNDERGROUND STRUCTURES AS SHOWN ARE BASED ON THE BEST INFORMATION AVAILABLE BUT NO GUARANTEE IS GIVEN THAT ALL EXISTING UTILITIES ARE SHOWN OR THAT THE GIVEN LOCATIONS ARE EXACT. CONFIRMATION OF EXISTENCE AND EXACT LOCATION OF ALL SERVICES MUST BE OBTAINED FROM THE INDIVIDUAL UTILITIES BEFORE PROCEEDING WITH CONSTRUCTION.

NO.	REVISIONS	DATE	BY

Stantec Consulting Ltd.
 905 Waverley Street, Winnipeg, Manitoba
 Tel 204-489-5900 Fax 204-453-9012

DESIGNED BY: J.C. CHECKED BY: H.K.
 DRAWN BY: W.A. APPROVED BY: H.K.

HOR. SCALE: 1:250
 VERTICAL: 1:50

RELEASED FOR CONSTRUCTION: _____

ENGINEER'S SEAL

CONSULTANT DRAWING NO. C-210

THE CITY OF WINNIPEG
 WATER AND WASTE DEPARTMENT
 ENGINEERING DIVISION

CUNNINGTON AVE.
 60.0m E OF 5TH MH E OF KILLARNEY ST. TO
 6TH MH E OF KILLARNEY ST.
 MAGER COMBINED SEWER DISTRICT SEWER SEPARATION

SHEET 10 OF 18
 CAD FILE DRAWING NUMBER 11890c-208-712.dwg
 CITY DRAWING NUMBER 9156