

PLAN
1:150

SHOWING REINFORCING STEEL IN BOT. OF BOT. SLAB & TOP OF TOP SLAB
NOTE: TRANSVERSE REINFORCING STEEL NOT SHOWN FOR CLARITY

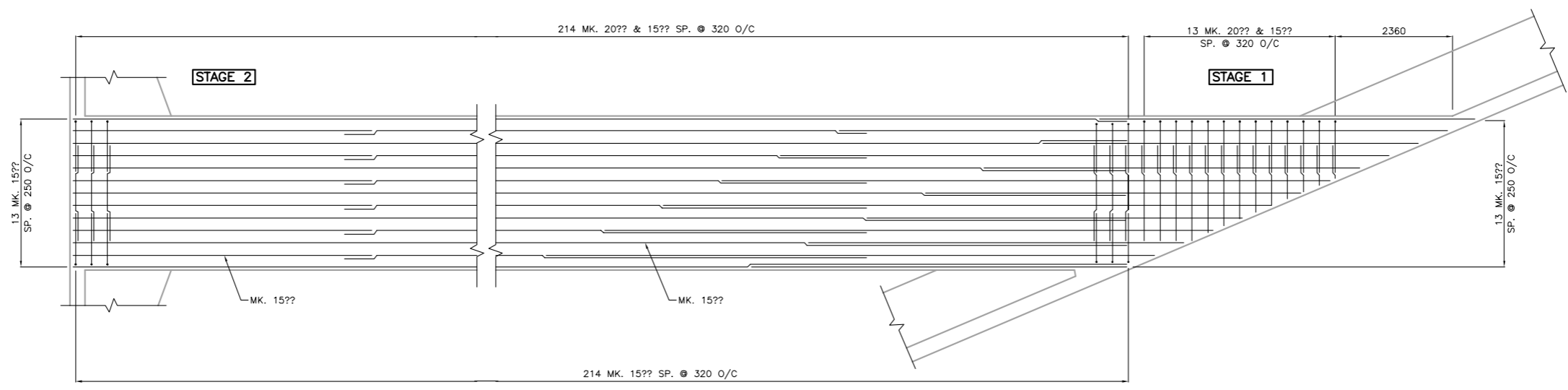

1 DETAIL
1:50

SHOWING REINFORCING STEEL IN BOT. OF BOT. SLAB & TOP OF TOP SLAB

2 DETAIL
1:50

SHOWING REINFORCING STEEL IN BOT. OF BOT. SLAB & TOP OF TOP SLAB

APEGN
Certificate of Authorization
Stantec Consulting Ltd.
No. 1301 Date: _____

LOCATION APPROVED UNDERGROUND STRUCTURES			
SUPV. U/G STRUCTURES COMMITTEE	DATE		
NOTE: LOCATION OF UNDERGROUND STRUCTURES AS SHOWN ARE BASED ON THE BEST INFORMATION AVAILABLE BUT NO GUARANTEE IS GIVEN THAT ALL EXISTING UTILITIES ARE SHOWN OR THAT THE GIVEN LOCATIONS ARE EXACT. CONFIRMATION OF EXISTENCE AND EXACT LOCATION OF ALL SERVICES MUST BE OBTAINED FROM THE INDIVIDUAL UTILITIES BEFORE PROCEEDING WITH CONSTRUCTION.			

B.M. ELEV.			
2 ISSUED FOR TENDER	10.01.06	J.M.B.	
1 SUBMITTED FOR 90% REVIEW	09.12.11	M.L.T.	
NO. REVISIONS	DATE	BY	

Stantec Consulting Ltd.
905 Waverley Street, Winnipeg, Manitoba
Tel 204-489-5900 Fax 204-453-9012

DESIGNED BY: M.L.T.	CHECKED BY: K.S.A.
DRAWN BY: J.M.M.	APPROVED BY: M.L.T.
HOR. SCALE: AS SHOWN	RELEASED FOR CONSTRUCTION: _____
VERTICAL: AS SHOWN	DATE: 09.12.11

ENGINEER'S SEAL	
CONSULTANT DRAWING NO.	S-104

THE CITY OF WINNIPEG
PUBLIC WORKS DEPARTMENT
ENGINEERING DIVISION

GUNN ROAD RECONSTRUCTION
CORDITE DITCH CULVERT REPLACEMENT
AT DAY STREET AND GUNN ROAD
REINFORCING DETAILS - SHEET 2 OF 6

SHEET 10 OF 15
CAD FILE DRAWING NUMBER 051705-101-726.dwg
CITY DRAWING NUMBER C365-10-10

V:\137\pct\1\13700170\Drawings\A02_Design\Rebar\Rebar\1051705-102-726.dwg
 2010-01-07 10:02AM By: jpearns