

**A SECTION**  
9 | 12  
1:75  
SHOWING REINFORCING STEEL IN OUTSIDE FACE OF SOUTH WALL

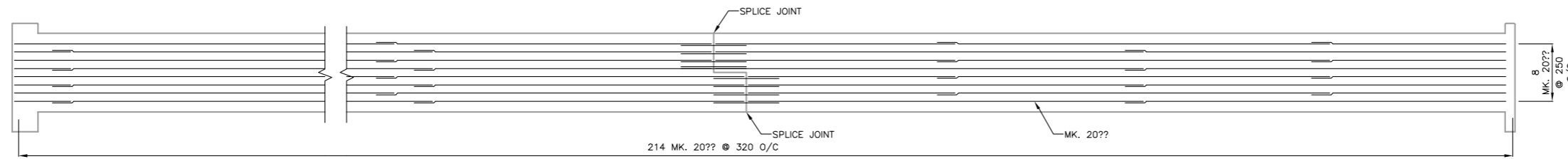

**A SECTION**  
10 | 12  
1:75  
SHOWING REINFORCING STEEL IN INSIDE FACE OF SOUTH WALL

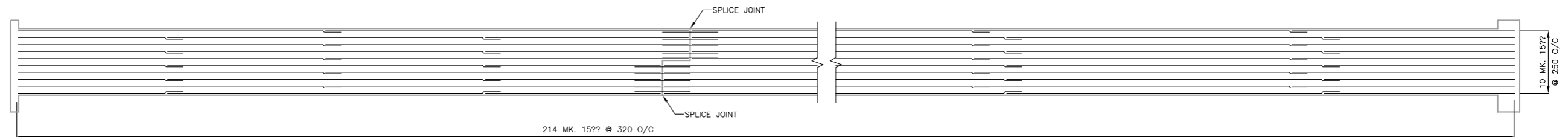

**B SECTION**  
9 | 12  
1:75  
SHOWING REINFORCING STEEL IN OUTSIDE FACE OF NORTH WALL

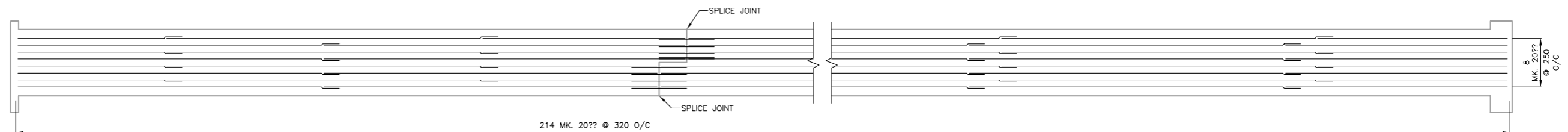

**B SECTION**  
10 | 12  
1:75  
SHOWING REINFORCING STEEL IN INSIDE FACE OF NORTH WALL

V:\137\p\13700170\Drawings\A02\_Design\Reinf\Reinf\1051705-102-726.dwg  
 2010-01-07 10:02AM By: jbaron

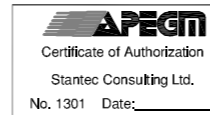

**LOCATION APPROVED UNDERGROUND STRUCTURES**

SUPV. U/G STRUCTURES COMMITTEE DATE  
 NOTE:  
 LOCATION OF UNDERGROUND STRUCTURES AS SHOWN ARE BASED ON THE BEST INFORMATION AVAILABLE BUT NO GUARANTEE IS GIVEN THAT ALL EXISTING UTILITIES ARE SHOWN OR THAT THE GIVEN LOCATIONS ARE EXACT. CONFIRMATION OF EXISTENCE AND EXACT LOCATION OF ALL SERVICES MUST BE OBTAINED FROM THE INDIVIDUAL UTILITIES BEFORE PROCEEDING WITH CONSTRUCTION.

B.M. ELEV.	NO.	REVISIONS	DATE	BY
	2	ISSUED FOR TENDER	10.01.06	J.M.B.
	1	SUBMITTED FOR 90% REVIEW	09.12.11	M.L.T.

**Stantec Consulting Ltd.**  
 905 Waverley Street, Winnipeg, Manitoba  
 Tel 204-489-5900 Fax 204-453-9012

DESIGNED BY: M.L.T. CHECKED BY: K.S.A.  
 DRAWN BY: J.M.M. APPROVED BY: M.L.T.

HOR. SCALE: AS SHOWN  
 VERTICAL: AS SHOWN

RELEASED FOR CONSTRUCTION: \_\_\_\_\_  
 DATE: 09.12.11

ENGINEER'S SEAL  
 CONSULTANT DRAWING NO. S-106

**THE CITY OF WINNIPEG**  
 PUBLIC WORKS DEPARTMENT  
 ENGINEERING DIVISION

**GUNN ROAD RECONSTRUCTION**  
 CORDITE DITCH CULVERT REPLACEMENT  
 AT DAY STREET AND GUNN ROAD  
 REINFORCING DETAILS - SHEET 4 OF 6

SHEET 12 OF 15  
 CAD FILE DRAWING NUMBER 051705-101-726.dwg  
 CITY DRAWING NUMBER C365-10-12