

- CONSTRUCTION NOTES**
1. EXPOSE EXISTING WATERMAIN & CONFIRM INVERTS PRIOR TO CONSTRUCTION.
 2. CONFIRM LOCATION OF ALL SERVICES IN THE FIELD.
 3. INSTALL WATERMAIN BY TRENCHLESS METHODS.
 4. TRENCHES AND EXCAVATIONS WITHIN 1 METRE OF A PAVED AREA INCLUDING SIDEWALKS SHALL BE CLASS 3 BACKFILL.
 5. ALL MATERIALS SHALL CONFORM TO THE CITY OF WINNIPEG STANDARD CONSTRUCTION SPECIFICATIONS.
 6. MINIMUM COVER TO TOP OF WATERMAIN SHALL BE 2.4 m.
 7. REPLACE ALL EXISTING LEAD SERVICES FROM PROPOSED WATERMAIN TO &
 8. NOTIFY ALL AFFECTED RESIDENTS AND BUSINESSES 24 HOURS IN ADVANCE OF ANY WATER SHUTDOWNS OR DISRUPTION OF SERVICE.

NOTE: CHAINAGES SHOWN ARE ALONG E R OF TECUMSEH ST

WATER SERVICE INFORMATION

ADDRESS	SIZE(mm) & TYPE (STREET)	SIZE(mm) & TYPE (PROP)	SHORT & LONG MEASUREMENT	CORP. LOCATION	REMARKS
814 ALEXANDER AVE	20 COPPER	20 COPPER	1.29 EWL HSE	0.7 E OF S/C	RECONNECT SERVICE
RESIDENTIAL	12 LEAD	12 LEAD	3.66 EEL TECUMSEH	OPP S/C	SERV. OFF SHERMAN
815 ALEXANDER AVE	12 LEAD	12 LEAD	9.17 NSL HSE		
RESIDENTIAL	12 LEAD	12 LEAD	10.67>NNL ALEXANDER		
817 ALEXANDER AVE	20 COPPER	20 COPPER	2.20 WEL HSE	1.5 W OF S/C	RECONNECT SERVICE
RESIDENTIAL	16 COPPER	16 COPPER	5.29 WEL TECUMSEH		
819 ALEXANDER AVE	16 COPPER	16 COPPER	0.30 WWL HSE	0.6 E OF S/C	RENEW TO R WITH 20 COPPER
RESIDENTIAL	16 COPPER	16 COPPER	0.85 EWL TECUMSEH		
823 ALEXANDER AVE	16 LEAD	16 LEAD	0.50 EEL HSE	0.5 E OF S/C	RENEW TO R WITH 20 COPPER
RESIDENTIAL	20 LEAD	20 LEAD	0.44 EWL TECUMSEH		
811 PACIFIC AVE	20 COPPER	20 COPPER	1.88 EWL HSE	OPP S/C	RECONNECT SERVICE
RESIDENTIAL	20 COPPER	20 COPPER	5.59 EEL TECUMSEH		

* SERVICES TO BE RENEWED TO R UPON CONFIRMATION BY THE CONTRACTOR OF EXISTING 1/2" COPPER OR LEAD SERVICE. OBTAIN APPROVAL FROM CONTRACT ADMINISTRATOR PRIOR TO RENEWAL.

CAUTION: AQUEDUCT

DO NOT OPERATE HEAVY OR VIBRATORY EQUIPMENT OVER OR WITHIN 3 METERS OF CENTRE LINE OF AQUEDUCT

A MINIMUM CLEARANCE OF 1 METRE SHALL BE PROVIDED BETWEEN THE UNDERSIDE OF THE EXISTING AQUEDUCT PIPE AND THE TOP OF THE PROPOSED WORKS.

A MINIMUM CLEARANCE OF 0.5 METRES SHALL BE PROVIDED BETWEEN THE UNDERSIDE OF THE PROPOSED WORKS AND THE TOP OF THE EXISTING AQUEDUCT PIPE.

INSTALLATION TO BE DONE BY TRENCHLESS METHODS ONLY FOR PROPOSED WORKS CROSSING UNDER THE EXISTING AQUEDUCT PIPE.

EXPOSE AQUEDUCT BY HYDRO VACUUM OR OTHER SOFT DIG METHODS TO CONFIRM DEPTH AND ALIGNMENT OF PIPE.

* IMPORTANT CONTACT THE WATER AND WASTE DEPT. CONSTRUCTION SERVICES COORDINATOR AT 986-3823 A MINIMUM OF SEVEN DAYS PRIOR TO CROSSING OR WORKING ADJACENT TO FEEDERMANS TO ARRANGE FOR INSPECTION.

METRIC

WHOLE NUMBERS INDICATE MILLIMETRES
DECIMALIZED NUMBERS INDICATE METRES

NOTE: ALL VALVES TO BE INSTALLED COUNTERCLOCKWISE TO CLOSE

WARNING

IF POWER EQUIPMENT OR EXPLOSIVES ARE TO BE USED FOR EXCAVATION ON THIS PROJECT THE CONTRACTOR MUST:

- 1) NOTIFY THE GAS COMPANY OF THE PROPOSED LOCATION OF EXCAVATION.
- 2) TAKE PRECAUTION TO AVOID DAMAGE TO GAS COMPANY INSTALLATIONS.

SEE PROVINCIAL REGULATION 210/72 FOR DETAILS

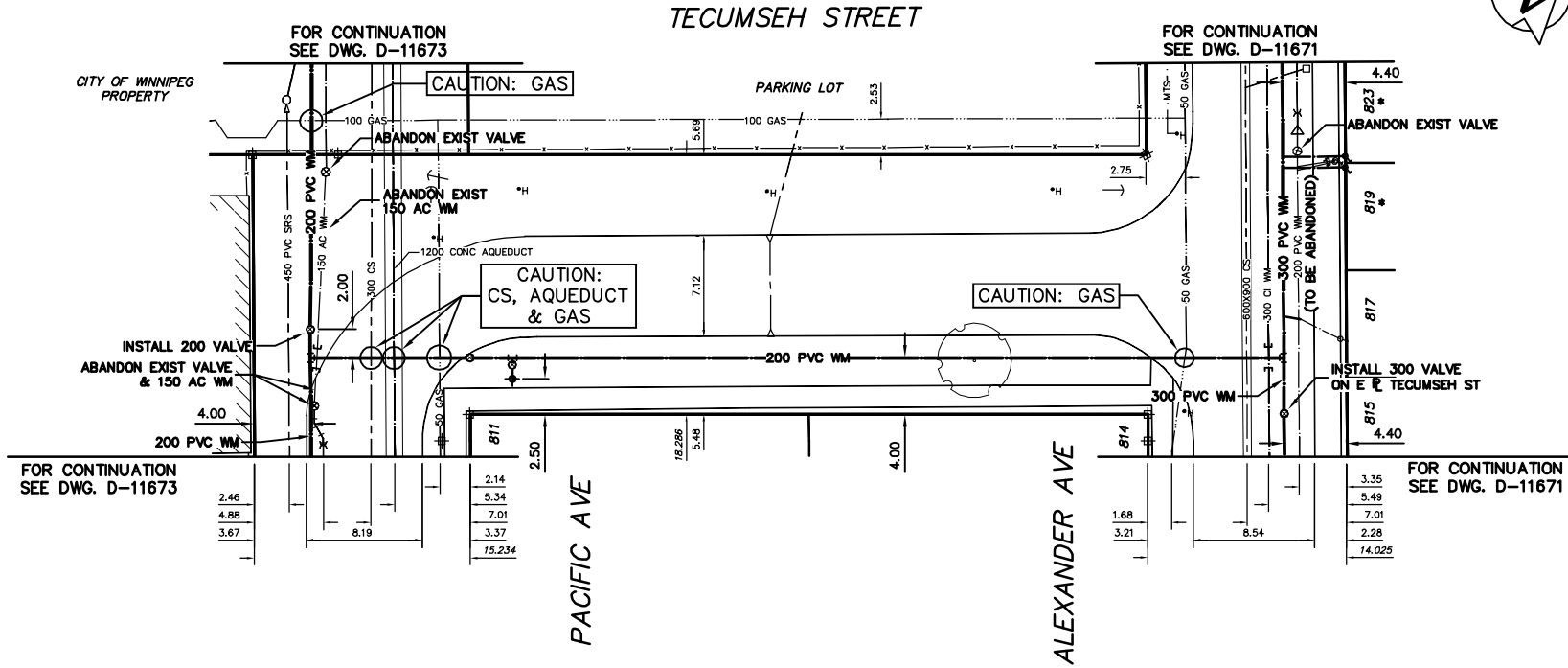
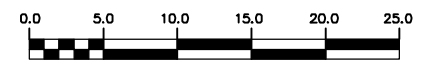

200 WM	WATERMAIN	200 WM	SL - HYDRO	150 WM	WATERMAIN	150 WM
⊕	HYDRANT	⊕	MTS	⊕	HYDRANT	⊕
⊙	VALVE	⊙	TRAFFIC SIGNALS	⊙	VALVE	⊙
525 LDS	LAND DRAINAGE SEWER	525 LDS	GAS	50 GAS	300 LDS	LAND DRAINAGE SEWER
375 WWS	WASTEWATER SEWER	375 WWS	SURVEY BAR	250 WWS	250 WWS	WASTEWATER SEWER
○	MANHOLE	●	FENCE	⊕	⊕	PROFILE
□	CATCH BASIN	■	POLE - HYDRO, MTS	⊕	⊕	GROUND ABOVE PIPE
▽	CURB INLET	▽	CURB STOP	⊕	⊕	⊕ DITCH (NORTH & WEST)
◁	REDUCER	◁	GUY ANCHOR	⊕	⊕	⊕ DITCH (SOUTH & EAST)
X	COUPLER	X	LIGHT STANDARD	⊕	⊕	⊕ GUTTER (NORTH & WEST)
⊕	ANODE	⊕	TREE	⊕	⊕	⊕ GUTTER (SOUTH & EAST)
EXISTING	LEGEND-PLAN	PROPOSED	EXISTING	LEGEND-PLAN	PROPOSED	EXISTING
				LEGEND-PROFILE	PROPOSED	

LOCATION APPROVED UNDERGROUND STRUCTURES

SUPV. U/G STRUCTURES COMMITTEE DATE

NOTE: LOCATION OF UNDERGROUND STRUCTURES AS SHOWN ARE BASED ON THE BEST INFORMATION AVAILABLE BUT NO GUARANTEE IS GIVEN THAT ALL EXISTING UTILITIES ARE SHOWN OR THAT THE GIVEN LOCATIONS ARE EXACT. CONFIRMATION OF EXISTENCE AND EXACT LOCATION OF ALL SERVICES MUST BE OBTAINED FROM THE INDIVIDUAL UTILITIES BEFORE PROCEEDING WITH CONSTRUCTION.

B.M. ELEV. FIELD BOOK #:

POSTED TO LISB

NO. REVISIONS DATE BY

CITY OF WINNIPEG WATER AND WASTE ENGINEERING DIVISION

DESIGNED BY SC CHECKED BY SC

DRAWN BY C.J.H. APPROVED BY K.Z.

HOR. SCALE 1:250
VERTICAL 1:50

RELEASED FOR CONSTRUCTION

DATE 2009 02 12

ENGINEER'S SEAL

ORIGINAL SIGNED BY S.R.J. COUNROYER 09/02/12

BID OPPORTUNITY 94-2009
FILENAME: D-11672.dwg
PLOT DATE: 2009 02 12

THE CITY OF WINNIPEG WATER AND WASTE DEPARTMENT

2009 WATERMAIN RENEWALS CONTRACT 2
TECUMSEH STREET
PACIFIC AVENUE TO ALEXANDER AVENUE

SHEET 8 OF 10
CITY DRAWING NUMBER D-11672