

SOUTHBOUND

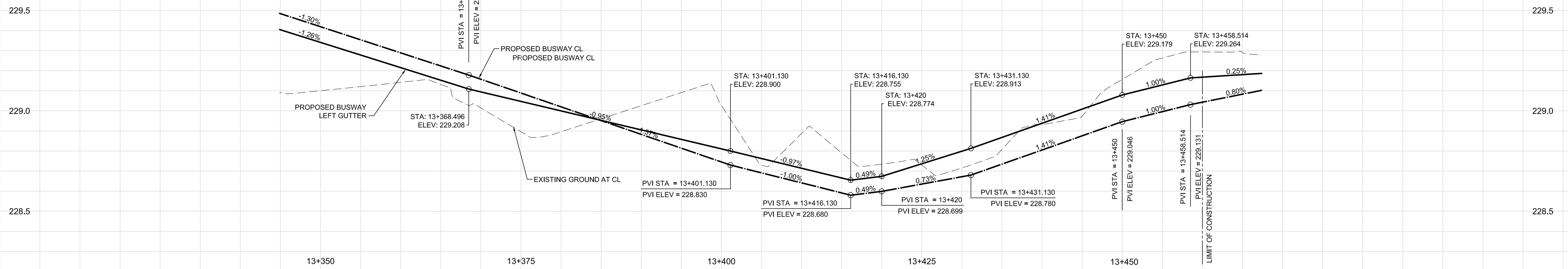

NORTHBOUND

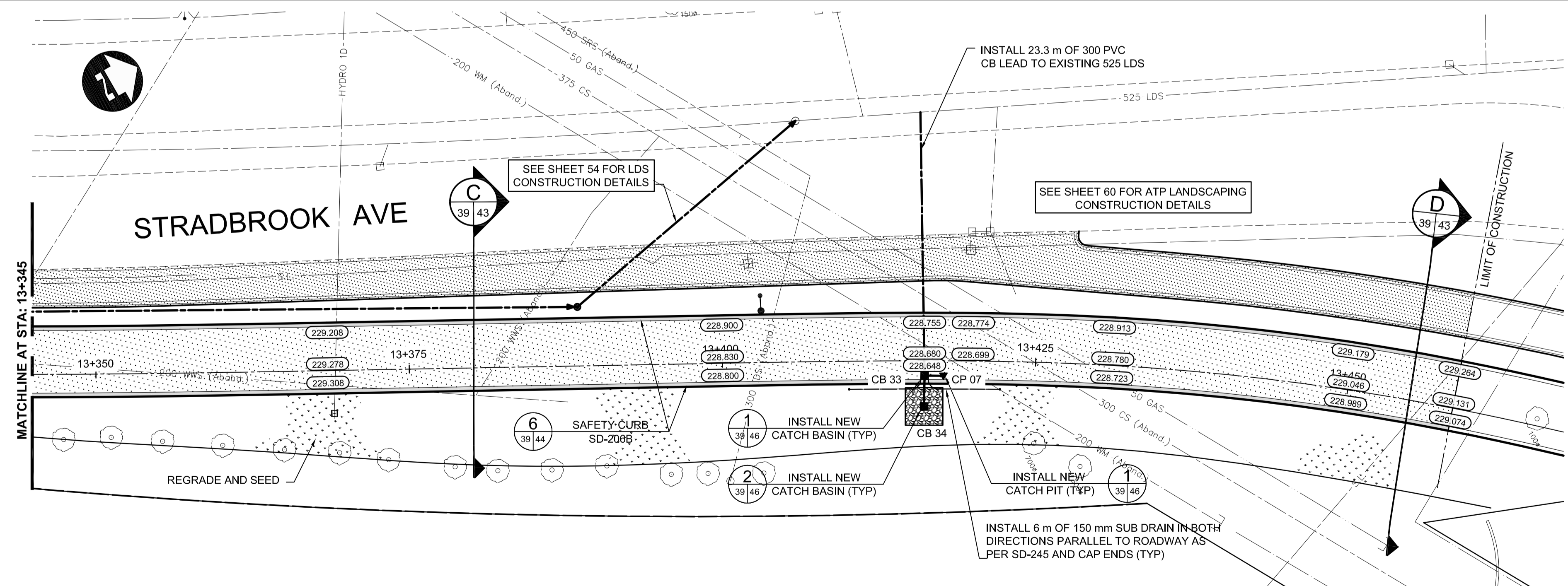
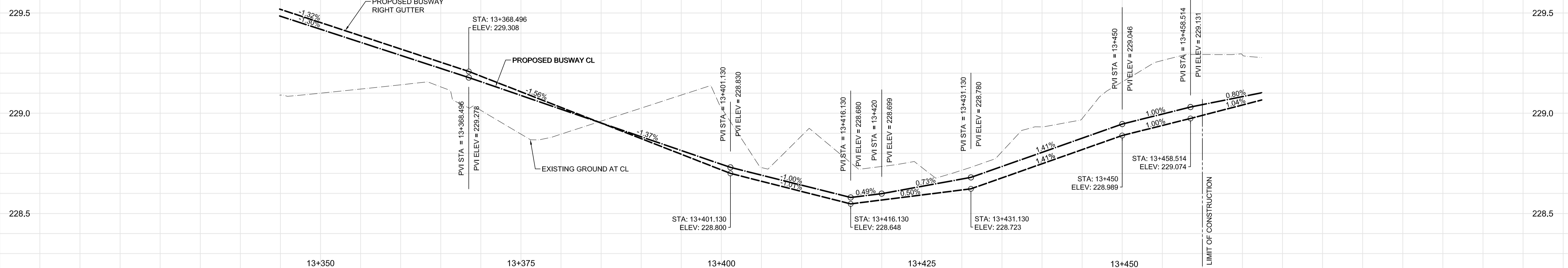

- CONSTRUCTION NOTES:**
- CONTRACTOR SHALL TAKE PRECAUTIONARY STEPS TO AVOID DAMAGE FROM CONSTRUCTION ACTIVITIES TO EXISTING BOULEVARDS AND TREES WITHIN THE LIMITS OF CONSTRUCTION.
 - LOCATION OF EXISTING SERVICES ARE TO BE CONFIRMED IN THE FIELD BY THE CONTRACTOR.
 - TIE-INS TO BE VERIFIED IN THE FIELD BY THE CONTRACT ADMINISTRATOR.
 - LIMITS OF SIDEWALK RENEWALS TO BE FINALIZED IN THE FIELD BY THE CONTRACT ADMINISTRATOR.
 - BOULEVARD REPLACEMENT TO BE FINALIZED IN THE FIELD BY THE CONTRACT ADMINISTRATOR.
 - BASE LINE ALONG CENTER OF TRANSITWAY.
 - FOR ADJUSTMENTS AND REMOVALS SEE PAGES 5 TO 10 OF 64.
 - CB LEADS TO BE INSTALLED AT MIN. 1.0% SLOPE OR AS DIRECTED BY CONTRACT ADMINISTRATOR.
 - REMOVE EXISTING FENCE AND PLACE AS TEMPORARY FENCE TO PREVENT ACCESS TO CN RAIL.

WARNING

IF POWER EQUIPMENT OR EXPLOSIVES ARE TO BE USED FOR EXCAVATION ON THIS PROJECT THE CONTRACTOR MUST:

- NOTIFY THE GAS COMPANY OF THE PROPOSED LOCATION OF EXCAVATION.
- TAKE PRECAUTION TO AVOID DAMAGE TO GAS COMPANY INSTALLATIONS. SEE PROVINCIAL REGULATION 210/72 FOR DETAILS.

#	COORDINATES		RIM ELEV.	SUMP ELEV.	STATION	PIPE LEAD	LEAD INV.	INV. AT MAIN
	NORTHING	EASTING						
CB33	5527294.460	634159.077	228.648	226.608	13+416.13	23.3m - 300mm	227.208	226.700
CB34	5527293.344	634160.918	???	226.750	13+416.13	2.0m - 250mm	227.350	227.308
CP07	5527295.753	634159.830	228.648		13+417.60	1.5m - 250mm	227.350	227.308

NOTE: ALL COORDINATES SHOWN ON DRAWINGS ARE NAD 83 UTM. COMBINED SCALE FACTOR TO OBTAIN GROUND DISTANCES IS 0.9997688

METRIC

WHOLE NUMBERS INDICATE MILLIMETRES
DECIMALIZED NUMBERS INDICATE METRES.

Certificate of Authorization
Dillon Consulting Limited (MB)
No. 1789 Date: _____

LOCATION UNDERGROUND	APPROVED STRUCTURES	B.M. 654265 (633392.694, 5525026.192) ELEV. 232.518
SUPPLY, U/G STRUCTURES COMMITTEE	DATE	
NOTE: LOCATION OF UNDERGROUND STRUCTURES AS SHOWN ARE BASED ON THE BEST INFORMATION AVAILABLE, BUT NO GUARANTEE IS GIVEN THAT ALL EXISTING UTILITIES ARE SHOWN OR THAT THE GIVEN LOCATIONS ARE EXACT. CONFIRMATION OF EXISTENCE AND EXACT LOCATION OF ALL SERVICES MUST BE OBTAINED FROM THE INDIVIDUAL UTILITIES BEFORE PROCEEDING WITH CONSTRUCTION.		

NO.	REVISIONS	DATE	BY
2	ISSUED FOR TENDER	04/29/09	TJP
1	SUBMITTED FOR 95% REVIEW	02/13/09	TJP

DESIGNED BY	DRAWN BY	CHECKED BY	APPROVED BY
RTP	TJH	ORIGINAL SIGNED BY TARAN J. PETERS	ORIGINAL SIGNED BY DAVE P. KRAHN

RELEASSED FOR CONSTRUCTION
ORIGINAL SIGNED BY RANDY FINGAS
DATE 04/29/09

CONSULTANT PROJECT NO. 088813

THE CITY OF WINNIPEG TRANSIT DEPARTMENT

Winnipeg

SOUTHWEST RAPID TRANSIT CORRIDOR - STAGE 1
TRANSITWAY CONSTRUCTION, DONALD/HARKNESS RECONSTRUCTION & ASSOCIATED WORKS

CITY DRAWING NUMBER P-3299-39
SHEET 39 OF 64
CONSULTANT DRAWING NUMBER C3-C3021-T

PAVING & GRADING - TRANSITWAY - STA. 13+345 TO 13+445

G:\CAD\088813\Contract\Contract_3-Donald Street\Roadway\CI-403-Paving-Grading-Busway.dwg