

A1 SIZE 23.1" x 33.1" (594mm x 841mm)

NOTE: ALL CATCHBASIN LEADS TO BE 250mmØ UNLESS NOTED OTHERWISE (U.N.O.).

LAND DRAINAGE SYSTEM	CO-ORDINATE		RIM ELEV.	INVERT			
	STATION	OFFSET		N	S	E	W
CB 1 (SD024)	1+15.986	3.000 L	232.170	230.420	*	*	*
CB 2 (SD024)	1+80.000	3.000 R	233.050	231.300	*	*	*
CB 3 (SD024)	2+79.975	3.375 R	232.860	*	231.110	*	*
CP 1 (SD023)	2+38.082	3.375 R	232.110	231.010	*	*	*

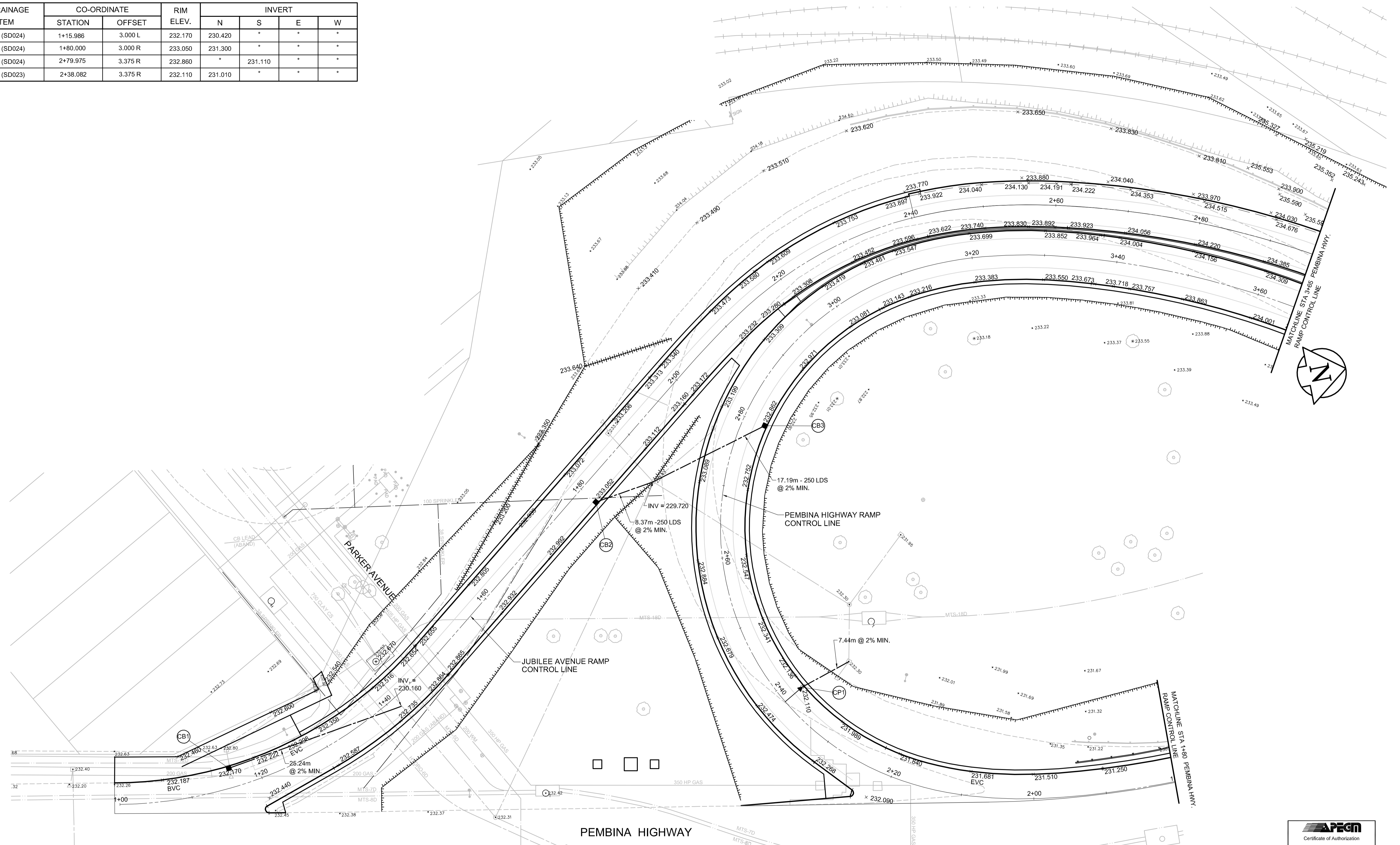

PEMBINA HIGHWAY

METRIC
WHOLE NUMBERS INDICATE MILLIMETRES
DECIMALIZED NUMBERS INDICATE METRES

AECOM
Certificate of Authorization
AECOM Canada Ltd.
Original dated on:
No. 4671 Date: 2010/03/24

BID OPPORTUNITY NO. 133-2010

EXISTING	LEGEND - PLAN	NEW	EXISTING	LEGEND - PLAN	NEW	EXISTING	LEGEND - PLAN	NEW
---	GAS	---	○	MANHOLE	●	---	CONCRETE PAVEMENT	---
---	MTS	---	□	CATCH BASIN / CATCH PIT	■	---	ASPHALT PAVEMENT	---
---	HYDRO	---	△	CURB INLET WITH BOX	▼	---	CONC. SIDEWALK/MEDIAN	---
---	CATV/FO	---	TH	TREE	---	---	PAVING STONE	---
---	TRAFFIC SIGNALS/PIT	---	TH	TEST HOLE	---	---	GRAVEL	---
---	LAND DRAINAGE SEWER	---	---	PROPERTY LINE	---	---	RAMP CURB	---
---	SANITARY/COMBINED SEWER	---	---	SURVEY BAR	---	---	PLANING/REMOVAL	---
---	SSP/DCP	---	---	FENCE	---	---		
---	WATERMAIN	---	---	BOC/EOPAVT	---	---		
---	SUBDRAIN	---	233.000	ELEVATION	232.750	---		
---	DITCH	---	---	TRAFFIC SIGN	---	---		

LOCATION APPROVED UNDERGROUND STRUCTURES

Supr. U/G Structures DATE COMMITTEE

NOTE: LOCATION OF UNDERGROUND STRUCTURES AS SHOWN ARE BASED ON THE BEST INFORMATION AVAILABLE. BUT NO GUARANTEE IS GIVEN THAT ALL EXISTING UTILITIES ARE SHOWN OR THAT THE GIVEN LOCATIONS ARE EXACT. CONFIRMATION OF EXISTENCE AND EXACT LOCATION OF ALL SERVICES MUST BE OBTAINED FROM THE INDIVIDUAL UTILITIES BEFORE PROCEEDING WITH CONSTRUCTION.

NO.	REVISIONS	DATE	BY
0	ISSUED FOR CONSTRUCTION	10/03/24	BC
B	ISSUED FOR 100% REVIEW	10/03/08	BC
A	ISSUED FOR 30% REVIEW	10/01/28	BC

AECOM

DESIGNED BY: KWR
DRAWN BY: BC
HOR. SCALE: 1:250
VERT. SCALE: N/A

CHECKED BY: WRJ
APPROVED BY: [Signature]
RELEASED FOR CONSTRUCTION

DATE: []

PROFESSIONAL'S SEAL

PROVINCE OF MANITOBA
ORIGINAL SIGNED
K.W. RAE
MARCH 24/2010
REGISTERED PROFESSIONAL ENGINEER

CONSULTANT DRAWING NO. CT-36.dwg

THE CITY OF WINNIPEG
PUBLIC WORKS DEPARTMENT
ENGINEERING DIVISION

JUBILEE AVENUE OVERPASS ASSOCIATED ROADWORKS
PAVEMENT ELEVATIONS
SHEET 1 OF 3

CITY DRAWING NUMBER: B124-10-36
SHEET 36 OF 51
DRAWING No. 36
REV 0