

KEY PLAN
SCALE: NT8

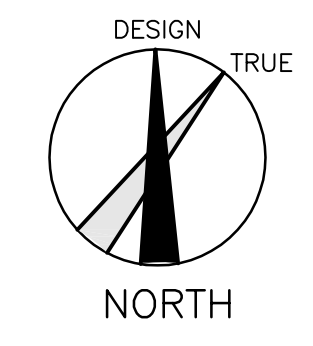

- NOTES:
- HOARDING WALL TO BE WOOD STUDS @ 16" OC "TENTEST" SHEATHING ON ONE SIDE UP TO CEILING HEIGHT COMPLETE WITH SEALED DOORS.
 - NORTH LOCKERS TO BE FOAMED FROM BEHIND BY REMOVING LOCKERS & REINSTALL AFTER FOAMING.

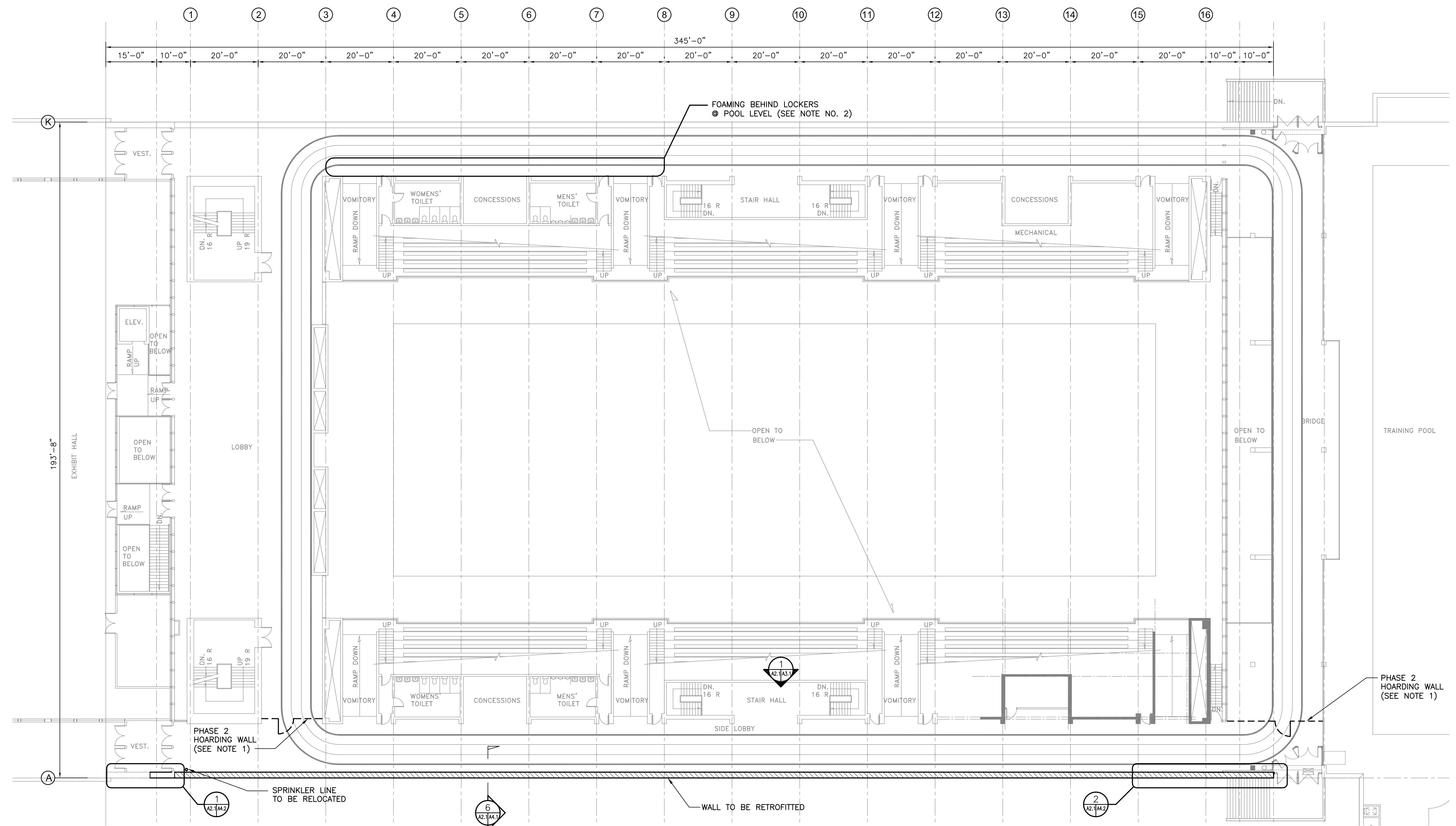

1 PARTIAL SECOND FLOOR PLAN
SCALE: 1/16" = 1'-0"

NO	ISSUED FOR TENDER	DATE	BY
00	ISSUED FOR TENDER	MAR 02, 2010	AL
REV	DESCRIPTION	DATE	BY

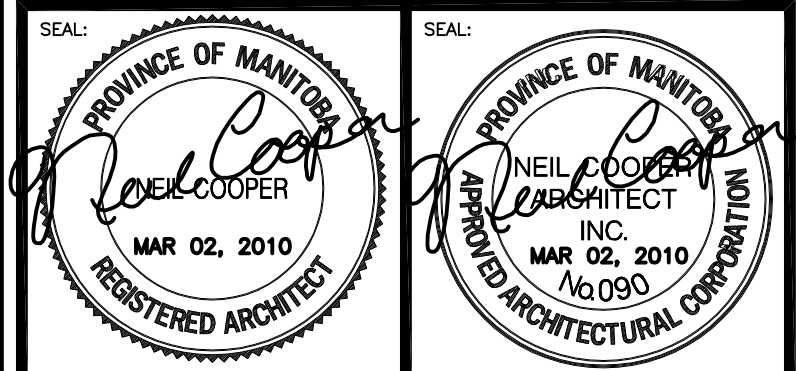

THIS DRAWING MUST NOT BE SCALED.
THE GENERAL CONTRACTOR SHALL VERIFY ALL DIMENSIONS, DATUMS AND LEVELS PRIOR TO COMMENCEMENT OF WORK AND IS HELD RESPONSIBLE FOR REPORTING ANY DISCREPANCY OR OMISSION TO NEIL COOPER ARCHITECT INC. IMMEDIATELY.

THIS DRAWING IS THE EXCLUSIVE PROPERTY OF NEIL COOPER ARCHITECT INC. AND CAN BE REPRODUCED ONLY WITH THE PERMISSION OF NEIL COOPER ARCHITECT INC. IN WHICH CASE THE REPRODUCTION MUST BEAR THEIR NAME AS THE ARCHITECTURAL FIRM.

DRAWING:

PARTIAL 2nd FLOOR PLAN

PROJECT:

**PAN AM POOL
BLDG ENVELOPE RETROFIT
PHASE 2**

25 Poseidon Bay, Winnipeg, Manitoba

Neil Cooper Architect Inc.
10-395 Berry Street, Winnipeg, Manitoba R3J 1N6

Tuplin Group Inc.
Unit L 301 Weston Street, Winnipeg, Manitoba R3E 3H4

DRAWN BY: AG/AL	CHECKED BY:	SHEET NO: A2.1R-0	REV NO:
DATE: JUNE 22, 2009			
SCALE: As Noted			

FILE: 08062\PAN AM POOL\ CONT DOC.\ CONT. DWGS.\PHASE 2\A2.1