

NOTE: CHAINAGES SHOWN ARE ALONG S R OF HENRY AVE

WATER SERVICE INFORMATION

ADDRESS	SIZE(mm) & TYPE (STREET)	SIZE(mm) & TYPE (PROP)	SHORT & LONG MEASUREMENT	CORP. LOCATION	REMARKS
72 HENRY AVE COMMERCIAL	50 COPPER	50 COPPER	2.24 EWL BLDG 4.50 WWL BACK LANE	OPP S/C	RENEW TO R W/ 50 COPPER
72 HENRY AVE	150 CI	150 CI	2.90 EWL BLDG 44.24 WWL ARGYLE	OPP VALVE	RENEW TO R W/ 150 PVC (SEE DETAIL 'B')
7 ARGYLE ST COMMERCIAL	25 COPPER	25 COPPER	-	-	SERVICE CUT-OFF
15 ARGYLE ST RESIDENTIAL	20 COPPER	20 COPPER	1.42 SSL HSE 28.45 SSL HEATON	0.5 N OF S/C	-
30 ARGYLE ST COMMERCIAL	100 CI	100 CI	18.78 SNL BLDG 0.31>NNL HEATON	OPP VALVE	SERVICED OFF ARGYLE

* SERVICES TO BE RENEWED TO R UPON CONFIRMATION BY THE CONTRACTOR OF EXISTING LEAD SERVICE. OBTAIN APPROVAL FROM CONTRACT ADMINISTRATOR PRIOR TO RENEWAL.

CONSTRUCTION NOTES

1. EXPOSE EXISTING WATERMAIN & CONFIRM INVERTS PRIOR TO CONSTRUCTION.
2. CONFIRM LOCATION OF ALL SERVICES IN THE FIELD.
3. INSTALL WATERMAIN BY TRENCHLESS METHODS.
4. TRENCHES AND EXCAVATIONS WITHIN 1 METRE OF A PAVED AREA INCLUDING SIDEWALKS SHALL BE CLASS 3 BACKFILL.
5. ALL MATERIALS SHALL CONFORM TO THE CITY OF WINNIPEG STANDARD CONSTRUCTION SPECIFICATIONS.
6. MINIMUM COVER TO TOP OF WATERMAIN SHALL BE 2.4 m.
7. REPLACE ALL EXISTING LEAD SERVICES FROM PROPOSED WATERMAIN TO R.
8. NOTIFY ALL AFFECTED RESIDENTS AND BUSINESSES 24 HOURS IN ADVANCE OF ANY WATER SHUTDOWNS OR DISRUPTION OF SERVICE.

METRIC

WHOLE NUMBERS INDICATE MILLIMETRES
DECIMALIZED NUMBERS INDICATE METRES

NOTE: ALL VALVES TO BE INSTALLED COUNTERCLOCKWISE TO CLOSE

WARNING

IF POWER EQUIPMENT OR EXPLOSIVES ARE TO BE USED FOR EXCAVATION ON THIS PROJECT THE CONTRACTOR MUST:
1) NOTIFY THE GAS COMPANY OF THE PROPOSED LOCATION OF EXCAVATION.
2) TAKE PRECAUTION TO AVOID DAMAGE TO GAS COMPANY INSTALLATIONS.
SEE PROVINCIAL REGULATION 210/72 FOR DETAILS

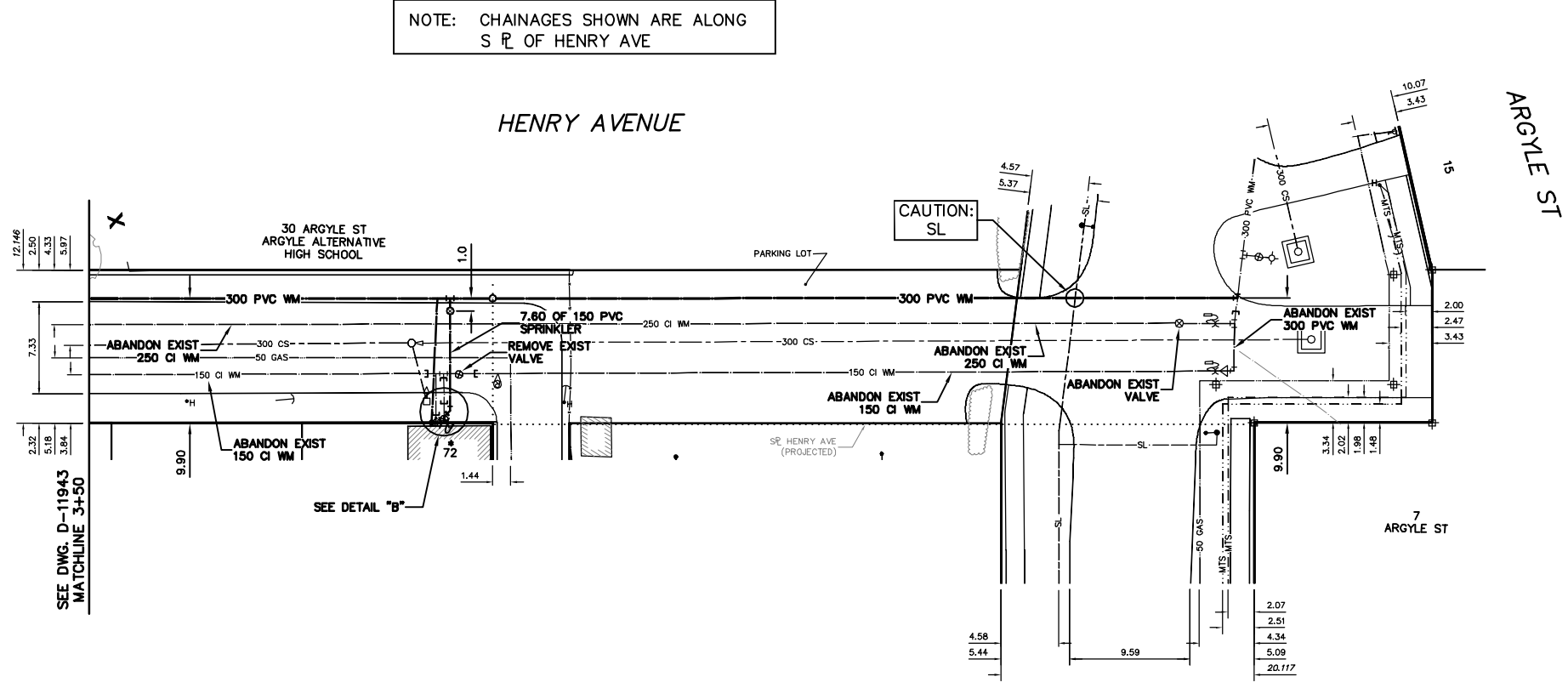
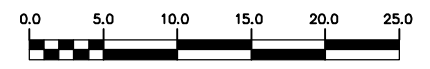

200 WM	WATERMAIN	200 WM	SL, HYDRO	150 WM	WATERMAIN	150 WM
+	HYDRANT	+	MTS	+	HYDRANT	+
o	VALVE	o	TRAFFIC SIGNALS	+	VALVE	+
525 LDS	LAND DRAINAGE SEWER	525 LDS	GAS	50 GAS	300 LDS	LAND DRAINAGE SEWER
375 WWS	WASTEWATER SEWER	375 WWS	SURVEY BAR	250 WWS	WASTEWATER SEWER	250 WWS
o	MANHOLE	o	FENCE	x	o	PROFILE
□	CATCH BASIN	□	POLE - HYDRO, MTS	///	□	GROUND ABOVE PIPE
▽	CURB INLET	▽	CURB STOP	♂	⊕	DITCH (NORTH & WEST)
∇	REDUCER	∇	GUY ANCHOR	⊕	⊕	DITCH (SOUTH & EAST)
X	COUPLER	X	LIGHT STANDARD	⊕	⊕	GUTTER (NORTH & WEST)
⊕	ANODE	⊕	TREE	⊕	⊕	GUTTER (SOUTH & EAST)
EXISTING	LEGEND-PLAN	PROPOSED	EXISTING	LEGEND-PLAN	PROPOSED	EXISTING
				LEGEND-PROFILE		PROPOSED

LOCATION APPROVED UNDERGROUND STRUCTURES

NOTE: LOCATION OF UNDERGROUND STRUCTURES AS SHOWN ARE BASED ON THE BEST INFORMATION AVAILABLE BUT NO GUARANTEE IS GIVEN THAT ALL EXISTING UTILITIES ARE SHOWN OR THAT THE GIVEN LOCATIONS ARE EXACT. CONFIRMATION OF EXISTENCE AND EXACT LOCATION OF ALL SERVICES MUST BE OBTAINED FROM THE INDIVIDUAL UTILITIES BEFORE PROCEEDING WITH CONSTRUCTION.

NO.	REVISIONS	DATE	BY

CITY OF WINNIPEG WATER AND WASTE ENGINEERING DIVISION

DESIGNED BY: AS
CHECKED BY: SC/KZ

DRAWN BY: CJH
APPROVED BY: KZ

HOR. SCALE: 1:250
VERTICAL: 1:50

DATE: 2010 03 08

ENGINEER'S SEAL
ORIGINAL MYLAR SIGNED BY
A.J. SINGBEIL
10/03/08

THE CITY OF WINNIPEG WATER AND WASTE DEPARTMENT

2010 WATERMAIN RENEWALS
CONTRACT NO 1
HENRY AVENUE
DISRAELI FREEWAY TO ARGYLE STREET

SHEET 4 OF 14
CITY DRAWING NUMBER
D-11944