

NOTE: CHAINAGES SHOWN ARE ALONG E.P. OF LILY ST

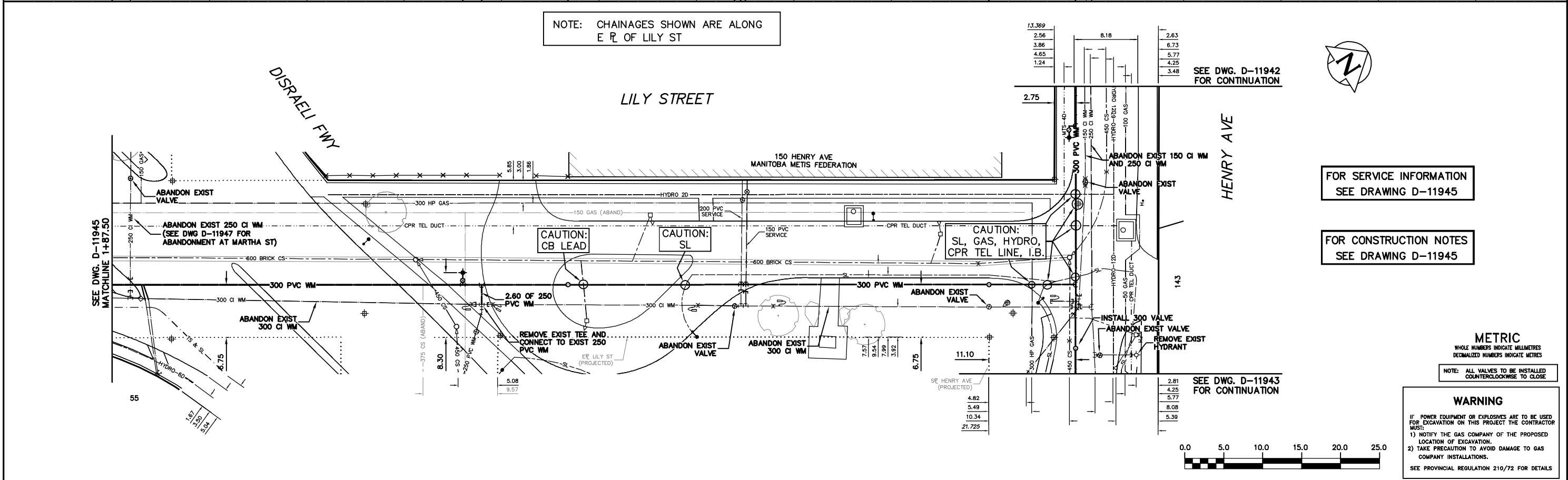

200 WM	WATERMAIN	200 WM	SL, HYDRO	150 WM	WATERMAIN	150 WM
+	HYDRANT	+	MTS	+	HYDRANT	+
o	VALVE	o	TRAFFIC SIGNALS	+	VALVE	+
525 LDS	LAND DRAINAGE SEWER	525 LDS	GAS	50 GAS	300 LDS	LAND DRAINAGE SEWER
375 WWS	WASTEWATER SEWER	375 WWS	SURVEY BAR	250 WWS	WASTEWATER SEWER	250 WWS
o	MANHOLE	o	FENCE	o	PROFILE	
□	CATCH BASIN	□	POLE - HYDRO, MTS	□	GROUND ABOVE PIPE	
▽	CURB INLET	▽	CURB STOP	▽	☉ DITCH (NORTH & WEST)	
▽	REDUCER	▽	GUY ANCHOR	▽	☉ DITCH (SOUTH & EAST)	
X	COUPLER	X	LIGHT STANDARD	X	☉ GUTTER (NORTH & WEST)	
⊕	ANODE	⊕	TREE	⊕	☉ GUTTER (SOUTH & EAST)	
EXISTING	LEGEND-PLAN	PROPOSED	EXISTING	LEGEND-PLAN	PROPOSED	EXISTING
				LEGEND-PROFILE	PROPOSED	

LOCATION APPROVED	B.M. ELEV.	FIELD BOOK #
UNDERGROUND STRUCTURES		
SUPV. U/G STRUCTURES COMMITTEE		
DATE		
NOTE:		
LOCATION OF UNDERGROUND STRUCTURES AS SHOWN ARE BASED ON THE BEST INFORMATION AVAILABLE BUT NO GUARANTEE IS GIVEN THAT ALL EXISTING UTILITIES ARE SHOWN OR THAT THE GIVEN LOCATIONS ARE EXACT. CONFIRMATION OF EXISTENCE AND EXACT LOCATION OF ALL SERVICES MUST BE OBTAINED FROM THE INDIVIDUAL UTILITIES BEFORE PROCEEDING WITH CONSTRUCTION.		
NO. REVISIONS	DATE	BY

DESIGNED BY		CHECKED BY	
AS		SC/KZ	
DRAWN BY		APPROVED BY	
CJH		KZ	
HOR. SCALE		RELEASED FOR CONSTRUCTION	
1:250			
VERTICAL		DATE	
1:50		2010 03 08	

**ENGINEER'S SEAL**

ORIGINAL MYLAR SIGNED BY  
A.J. SINGBEIL  
10/03/08

**THE CITY OF WINNIPEG**  
WATER AND WASTE DEPARTMENT

2010 WATERMAIN RENEWALS  
CONTRACT NO 1  
LILY STREET  
DISRAELI FREEWAY TO HENRY AVENUE

SHEET 6 OF 14  
CITY DRAWING NUMBER  
D-11946

BID OPPORTUNITY 192-2010  
FILENAME : D-11946.dwg  
PLOT DATE : 2010 03 09

**WARNING**

IF POWER EQUIPMENT OR EXPLOSIVES ARE TO BE USED FOR EXCAVATION ON THIS PROJECT THE CONTRACTOR MUST:

- 1) NOTIFY THE GAS COMPANY OF THE PROPOSED LOCATION OF EXCAVATION.
- 2) TAKE PRECAUTION TO AVOID DAMAGE TO GAS COMPANY INSTALLATIONS.

SEE PROVINCIAL REGULATION 210/72 FOR DETAILS