

A1 SIZE 23.4" x 33.1" (594mm x 841mm)

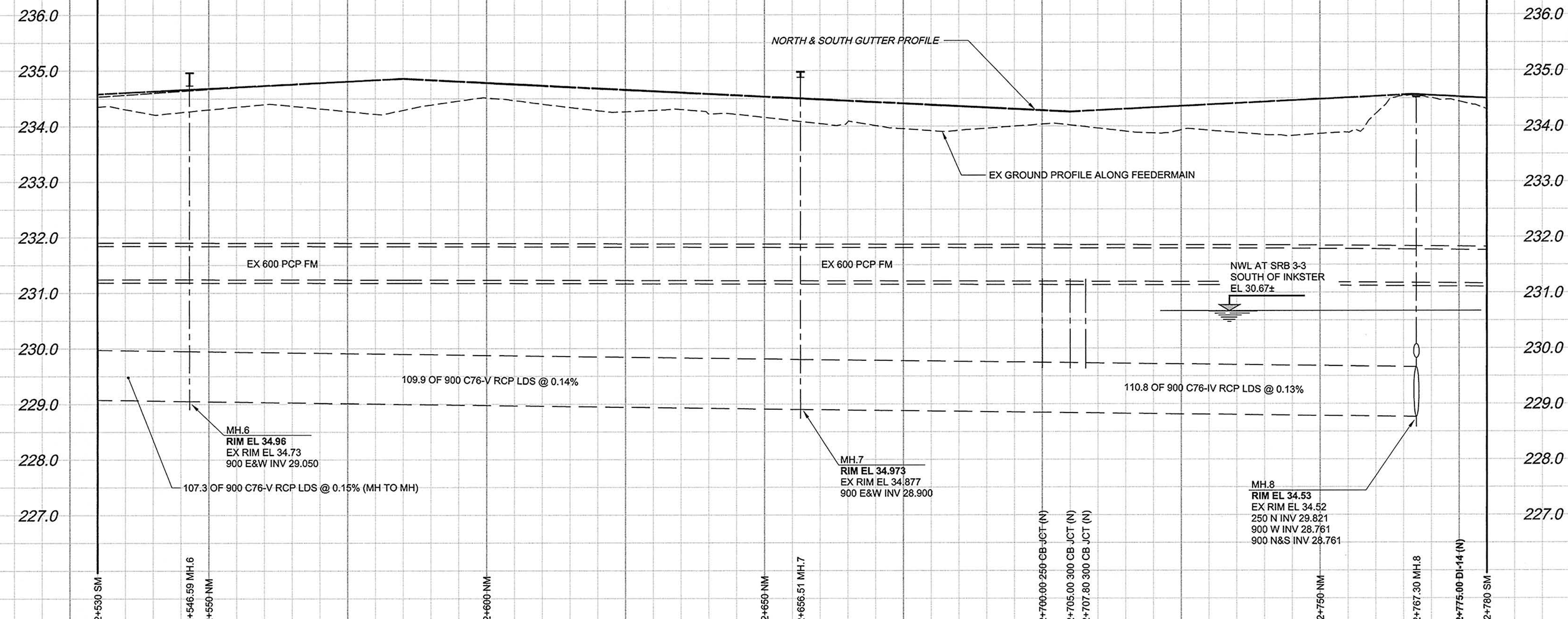

PLOT: 4/18/2010 4:25:28 PM

CHAINAGE ALONG SOUTH MEDIAN CONTROL LINE

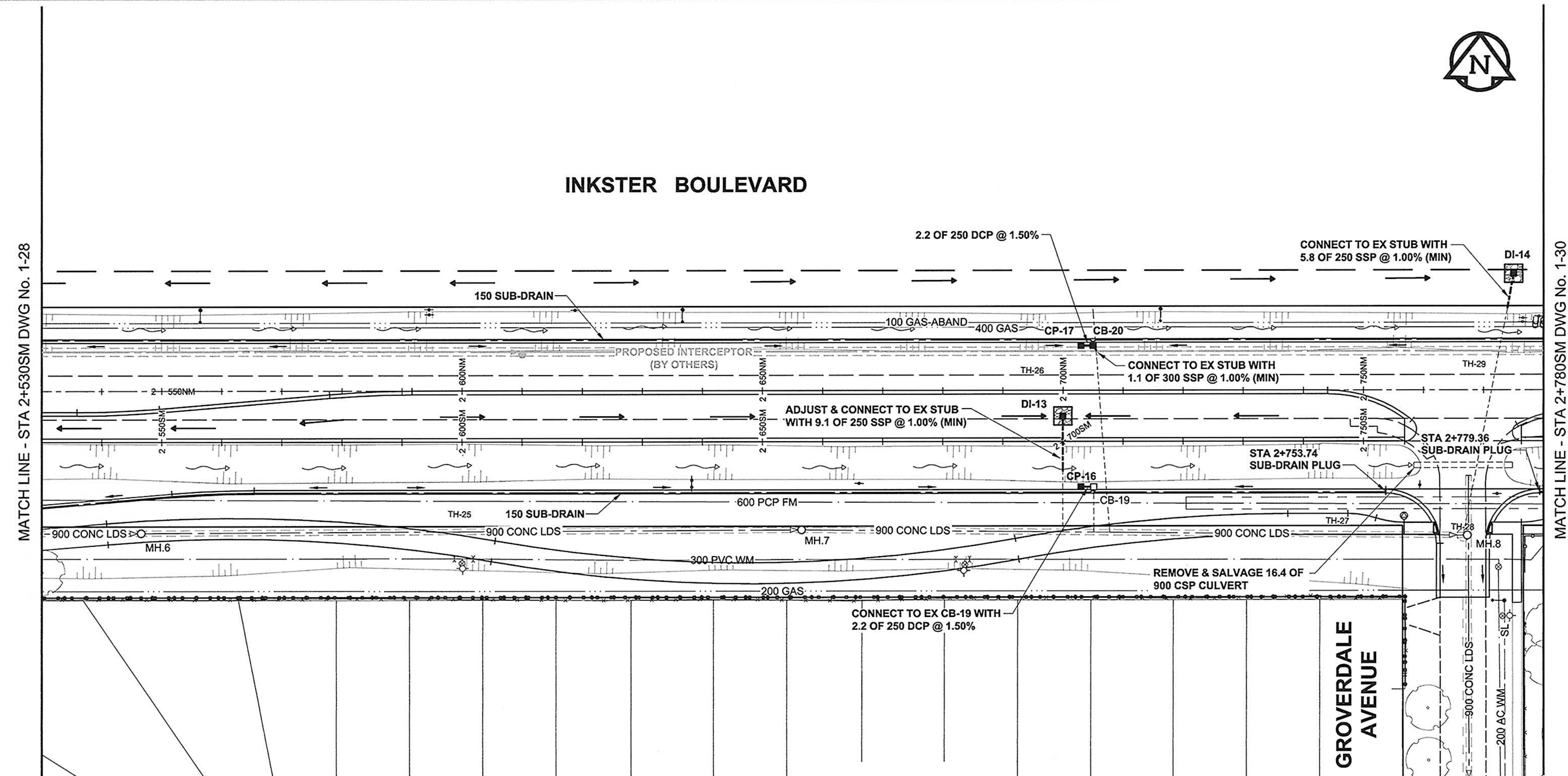

- GENERAL CONSTRUCTION NOTES:**
1. BACKFILL TO BE CLASS 2 UNLESS NOTED OTHERWISE.
 2. INSTALLATION OF ALL LDS TO BE IN A TRENCH UNLESS OTHERWISE NOTED.
 3. SEE SPECIFICATION FOR DETAILS & RESTRICTIONS WHEN WORKING AROUND EXISTING 600 FEEDERMAIN.
 4. REFER TO STRUCTURE & LOCATION SCHEDULE ON DRAWING 37 FOR FURTHER CATCHBASIN, CATCH PIT, DITCH INLET & MANHOLE DETAILS.
 5. TEMPORARILY PLUG SSP STUBS & BACKFILL AS PER THE DIRECTION OF THE CONTRACT ADMINISTRATOR.



AECOM REVIEW DIRECT CHK

AECOM FILE NAME: 0265-411-00_02-C-1005_RX.dwg Saved By: berardk

150 WM	WATERMAIN	150 WM	150 WM	CURB STOP	150 WM	WATERMAIN	150 WM	LOCATION APPROVED
HYDRANT	HYDRANT	REDUCER	HYDRANT	REDUCER	HYDRANT	HYDRANT	HYDRANT	UNDERGROUND STRUCTURES
VALVE	VALVE	COUPLING	VALVE	COUPLING	VALVE	VALVE	VALVE	
300 LDS	LAND DRAINAGE SEWER	ANODE	300 LDS	ANODE	300 LDS	LAND DRAINAGE SEWER	300 LDS	NOTE:
250 WWS	WASTE WATER SEWER	HYDRO	250 WWS	HYDRO	250 WWS	WASTE WATER SEWER	250 WWS	LOCATION OF UNDERGROUND STRUCTURES AS SHOWN ARE BASED ON THE BEST INFORMATION AVAILABLE BUT NO GUARANTEE IS GIVEN THAT ALL EXISTING UTILITIES ARE SHOWN OR THAT THE GIVEN LOCATIONS ARE EXACT. CONFIRMATION OF EXISTENCE AND EXACT LOCATION OF ALL SERVICES MUST BE OBTAINED FROM THE INDIVIDUAL UTILITIES BEFORE PROCEEDING WITH CONSTRUCTION.
MANHOLE	MANHOLE	MTS	MANHOLE	MTS	MANHOLE	MANHOLE	MANHOLE	
CATCH BASIN	CATCH BASIN	GAS	CATCH BASIN	GAS	CATCH BASIN	CATCH BASIN	CATCH BASIN	
CURB INLET	CURB INLET	TESTHOLE	CURB INLET	TESTHOLE	CURB INLET	CURB INLET	CURB INLET	
CULVERT	CULVERT	LAMP STANDARD	CULVERT	LAMP STANDARD	CULVERT	CULVERT	CULVERT	
PIPE ABANDONMENTS	PIPE ABANDONMENTS	TREE	PIPE ABANDONMENTS	TREE	PIPE ABANDONMENTS	PIPE ABANDONMENTS	PIPE ABANDONMENTS	
SURVEY BAR	SURVEY BAR		SURVEY BAR		SURVEY BAR	SURVEY BAR	SURVEY BAR	
EXISTING	LEGEND - PLAN	NEW	EXISTING	LEGEND - PLAN	NEW	EXISTING	LEGEND - PROFILE	

BM ELEV			
NO.	REVISIONS	YYMMDD	BY
0	ISSUED FOR CONSTRUCTION	10/04/21	KMB

This drawing has been prepared for the use of AECOM's client and may not be used, reproduced or relied upon by third parties, except as agreed by AECOM and its client, as required by law or for use by governmental reviewing agencies. AECOM accepts no responsibility, and denies any liability whatsoever, to any party that modifies this drawing without AECOM's express written consent. Do not scale this document. All measurements must be obtained from stated dimensions.

AECOM

DESIGNED BY: DME
 CHECKED BY: [Signature]
 DRAWN BY: KMB
 APPROVED BY: [Signature]
 HOR. SCALE: 1:500
 VERT. SCALE: 1:50
 DATE: 10/24/19
 DATE: April 19, 2010

PROFESSIONAL'S SEAL

PROVINCE OF MANITOBA
 REGISTERED PROFESSIONAL ENGINEER
 A. NAGY
 April 19, 2010
 CONSULTANT DRAWING NO.
 0265-411-00_02-C-1005_RX.dwg

THE CITY OF WINNIPEG
 PUBLIC WORKS DEPARTMENT
 ENGINEERING DIVISION

INKSTER BOULEVARD WIDENING PROJECT
 BROOKSIDE BOULEVARD TO KEEWATIN STREET
 LAND DRAINAGE SYSTEM
 STA 2+530 TO STA 2+780

CITY DRAWING NUMBER: P-3301-61
 SHEET 29 OF 82
 DRAWING No. 1-29
 REV 0

BID OPPORTUNITY NO. 232-2010