

A1 SIZE 23.4" x 33.1" (594mm x 841mm)

PLOT: 4/18/2010 4:26:54 PM

AECOM REVIEW DRAFT CHK 4/18/2010 4:26:54 PM

236.0
235.0
234.0
233.0
232.0
231.0
230.0
229.0
228.0
227.0

236.0
235.0
234.0
233.0
232.0
231.0
230.0
229.0
228.0
227.0

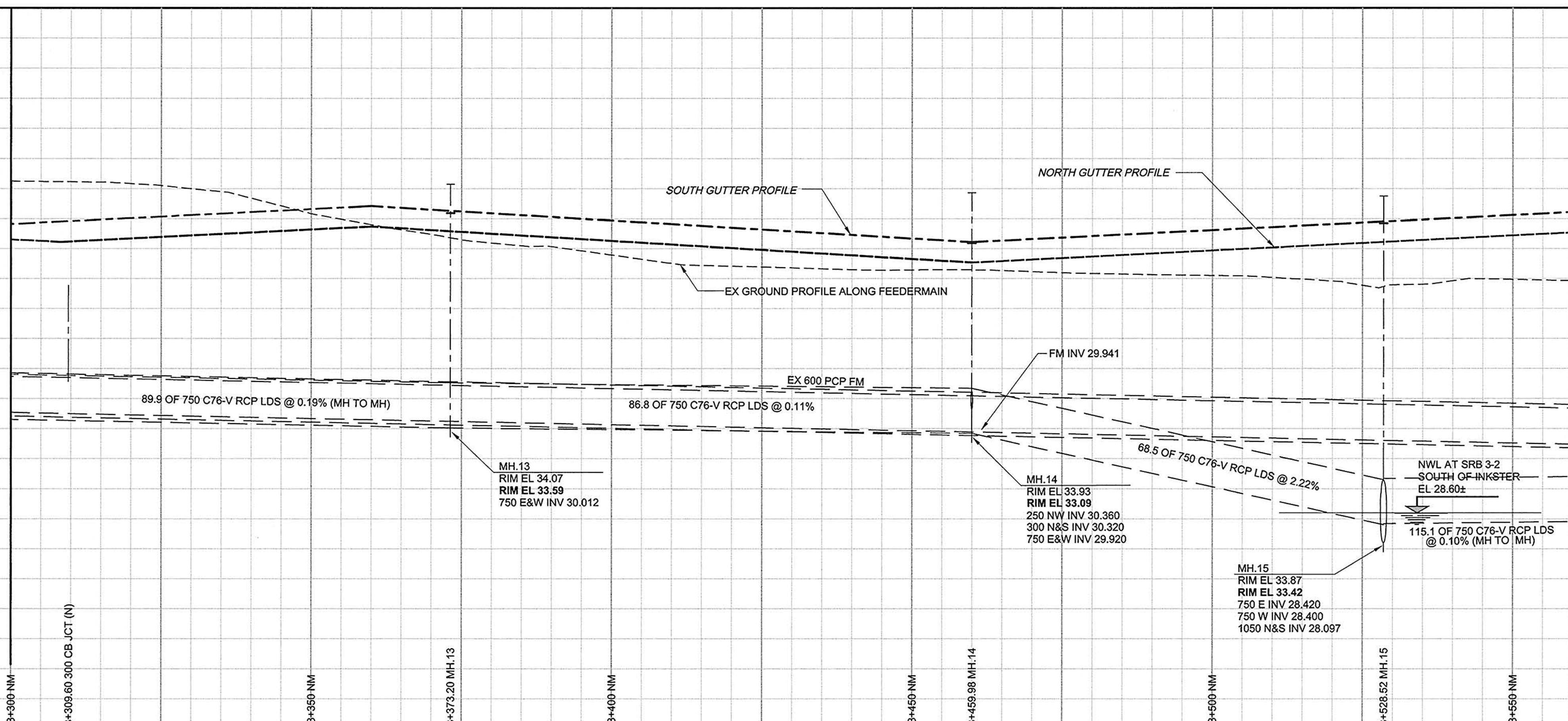

CHAINAGE ALONG NORTH MEDIAN CONTROL LINE

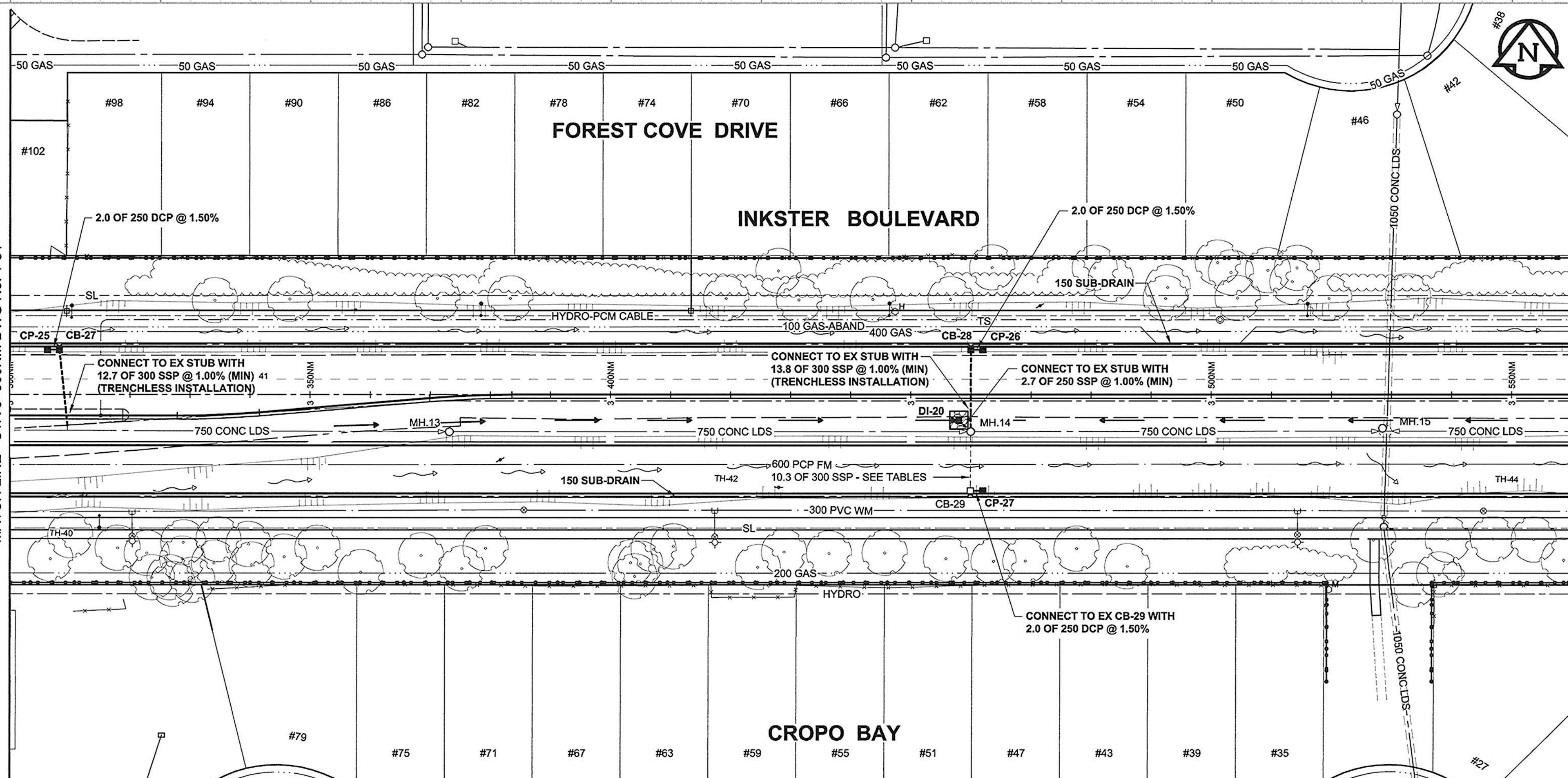

GENERAL CONSTRUCTION NOTES:

- BACKFILL TO BE CLASS 2 UNLESS NOTED OTHERWISE.
- INSTALLATION OF ALL LDS TO BE IN A TRENCH UNLESS OTHERWISE NOTED.
- SEE SPECIFICATION FOR DETAILS & RESTRICTIONS WHEN WORKING AROUND EXISTING 600 FEEDERMAIN.
- REFER TO STRUCTURE & LOCATION SCHEDULE ON DRAWING 38 FOR FURTHER CATCHBASIN, CATCH PIT, DITCH INLET & MANHOLE DETAILS.
- TEMPORARILY PLUG SSP STUBS & BACKFILL AS PER THE DIRECTION OF THE CONTRACT ADMINISTRATOR.

MATCH LINE - STA 3+300NM DWG No. 1-31

MATCH LINE - STA 3+560NM DWG No. 1-33

AECOM
Certificate of Authorization
AECOM Canada Ltd.
No. 4671 Date: 10/19/10
BID OPPORTUNITY NO. 232-2010

METRIC
WHOLE NUMBERS INDICATE MILLIMETRES
DECIMALIZED NUMBERS INDICATE METRES

THE CITY OF WINNIPEG
PUBLIC WORKS DEPARTMENT
ENGINEERING DIVISION

**INKSTER BOULEVARD
WIDENING PROJECT
BROOKSIDE BOULEVARD
TO KEEWATIN STREET**

LAND DRAINAGE SYSTEM
STA 3+300 TO STA 3+560

CITY DRAWING NUMBER
P-3301-64

SHEET 32 OF 82

DRAWING No. 1-32 REV 0

PROFESSIONAL'S SEAL
A. NAGY
REGISTERED PROFESSIONAL ENGINEER
CONSULTANT DRAWING NO.
0265-411-00_02-C-1008_RX.dwg

AECOM

DESIGNED BY DME
DRAWN BY KMB
HOR. SCALE 1:500
VERT. SCALE 1:50
DATE 10/19/10

CHECKED BY [Signature]
APPROVED BY [Signature]
RELEASED FOR CONSTRUCTION
DATE April 19, 2010

LOCATION APPROVED UNDERGROUND STRUCTURES

NOTE:
LOCATION OF UNDERGROUND STRUCTURES AS SHOWN ARE BASED ON THE BEST INFORMATION AVAILABLE. BUT NO GUARANTEE IS GIVEN THAT ALL EXISTING UTILITIES ARE SHOWN OR THAT THE GIVEN LOCATIONS ARE EXACT. CONFIRMATION OF EXISTENCE AND EXACT LOCATION OF ALL SERVICES MUST BE OBTAINED FROM THE INDIVIDUAL UTILITIES BEFORE PROCEEDING WITH CONSTRUCTION.

ISSUED FOR CONSTRUCTION 10/04/21 KMB
NO. REVISIONS YYMMDD BY

150 WM	WATERMAIN	150 WM	CURB STOP	150 WM	WATERMAIN	150 WM	WATERMAIN
300 LDS	LAND DRAINAGE SEWER	300 LDS	REDUCER	300 LDS	HYDRANT	300 LDS	LAND DRAINAGE SEWER
250 WWS	WASTE WATER SEWER	250 WWS	COUPLING	250 WWS	VALVE	250 WWS	WASTE WATER SEWER
MANHOLE		MANHOLE	HYDRO	MANHOLE	ANODE	MANHOLE	MANHOLE
CATCH BASIN		CATCH BASIN	MTS	CATCH BASIN	GAS	CATCH BASIN	CATCH BASIN
CURB INLET		CURB INLET	TESTHOLE	CURB INLET	N/W PROPERTY LINE	CURB INLET	CURB INLET
CULVERT		CULVERT	LAMP STANDARD	CULVERT	S/E PROPERTY LINE	CULVERT	CULVERT
PIPE ABANDONMENTS		PIPE ABANDONMENTS	TREE	PIPE ABANDONMENTS	N/W GUTTER	PIPE ABANDONMENTS	PIPE ABANDONMENTS
SURVEY BAR		SURVEY BAR		SURVEY BAR	S/E GUTTER	SURVEY BAR	SURVEY BAR
EXISTING	LEGEND - PLAN	NEW	LEGEND - PLAN	NEW	LEGEND - PROFILE	NEW	LEGEND - PROFILE