

CIRCULAR CURVE DATA				
CURVE	LENGTH	RADIUS	DELTA	TANGENT
C78	19.627	12.500	89°57'50"	12.492
C79	2.513	22.500	6°23'56"	1.258
C80	3.077	31.000	5°41'14"	1.540
C81	13.718	50.000	15°43'10"	6.902
C82	19.753	25.000	45°16'13"	10.425
C83	20.136	50.000	23°04'26"	10.206
C84	13.718	165.000	4°45'49"	6.863
C85	13.718	165.000	4°45'49"	6.863
C86	6.714	25.000	15°23'17"	3.378
C87	2.555	22.500	6°30'24"	1.279
C88	2.681	22.500	6°49'38"	1.342

INKSTER BOULEVARD

CIRCULAR CURVE DATA				
CURVE	LENGTH	RADIUS	DELTA	TANGENT
C89	6.520	22.500	16°36'09"	3.283
C90	20.136	50.000	23°04'26"	10.206
C91	19.040	25.000	43°38'13"	10.009
C92	20.136	50.000	23°04'26"	10.206
C93	2.941	31.000	5°26'09"	1.472
C94	5.697	22.500	14°30'30"	2.864
C95	4.344	25.000	9°57'17"	2.177
C96	14.217	100.000	8°08'45"	7.121
C97	14.217	100.000	8°08'45"	7.121

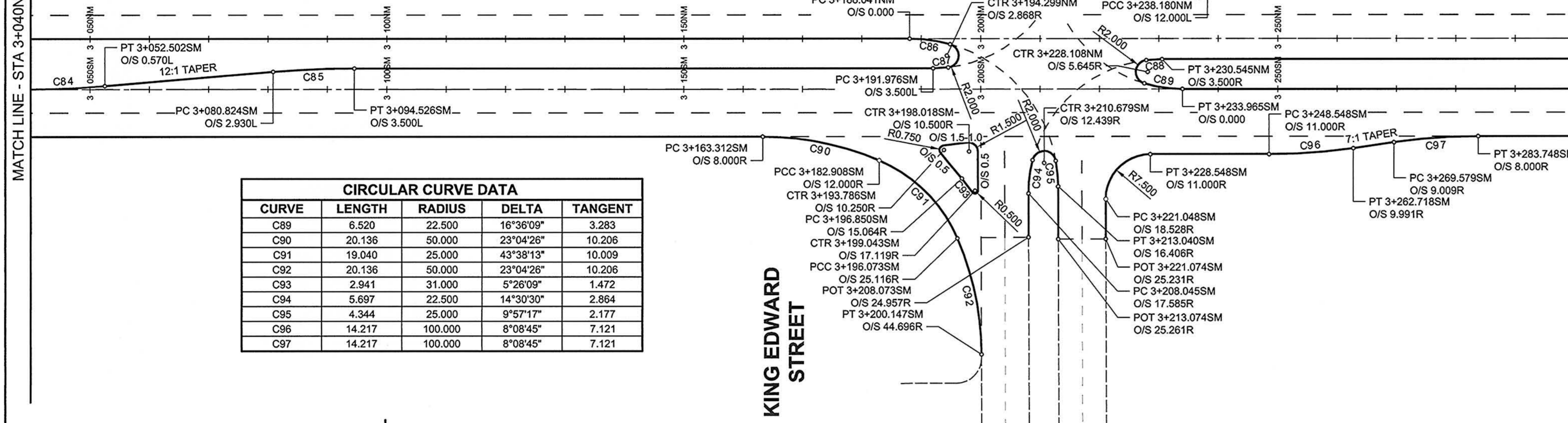

CIRCULAR CURVE DATA				
CURVE	LENGTH	RADIUS	DELTA	TANGENT
C98	13.718	165.000	4°45'49"	6.863
C99	13.718	165.000	4°45'49"	6.863

MATCH LINE - STA 3+300NM

MATCH LINE - STA 3+560NM DWG No.1-6

INKSTER BOULEVARD

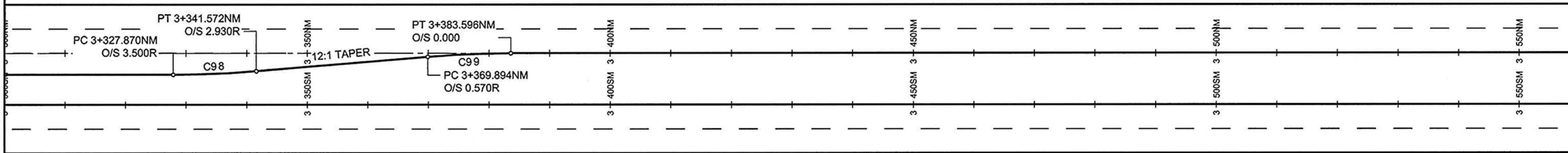

METRIC
WHOLE NUMBERS INDICATE MILLIMETRES
DECIMALIZED NUMBERS INDICATE METRES

LOCATION APPROVED UNDERGROUND STRUCTURES

SUPR. U/G STRUCTURES DATE COMMITTEE
NOTE: LOCATION OF UNDERGROUND STRUCTURES AS SHOWN ARE BASED ON THE BEST INFORMATION AVAILABLE. BUT NO GUARANTEE IS GIVEN THAT ALL EXISTING UTILITIES ARE SHOWN OR THAT THE GIVEN LOCATIONS ARE EXACT. CONFIRMATION OF EXISTENCE AND EXACT LOCATION OF ALL SERVICES MUST BE OBTAINED FROM THE INDIVIDUAL UTILITIES BEFORE PROCEEDING WITH CONSTRUCTION.

NO.	REVISIONS	YYMMDD	BY
0	ISSUED FOR CONSTRUCTION	10/04/21	DID

AECOM		DESIGNED BY: WRJ		CHECKED BY: RPB	
DRAWN BY: DID		APPROVED BY: TGS		RELEASED FOR CONSTRUCTION	
HOR. SCALE: 1:500		VERT. SCALE: N/A		DATE: April 19, 2020	

PROFESSIONAL'S SEAL
PROVINCE OF MANITOBA
REGISTERED PROFESSIONAL ENGINEER
R. P. BRUCE
CONSULTANT DRAWING NO. 0265-411-00-04-CT1005_RX.dwg

THE CITY OF WINNIPEG
PUBLIC WORKS DEPARTMENT
ENGINEERING DIVISION
INKSTER BOULEVARD WIDENING PROJECT
BROOKSIDE BOULEVARD TO KEEWATIN STREET
HORIZONTAL GEOMETRY
CITY DRAWING NUMBER: P-3301-37
SHEET 5 OF 82
DRAWING No. 1-5 REV 0

AECM
Certificate of Authorization
AECOM Canada Ltd.
No. 4671 Date: April 19, 2020
BID OPPORTUNITY NO. 232-2010

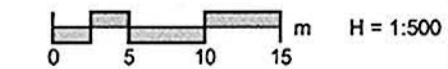

KING EDWARD STREET

KING EDWARD STREET EAST MEDIAN CONTROL POINT COORDINATES		
POINT/STATION	NORTHING	EASTING
POT 0+100.000	10042.963	10822.915
POT 0+406.027	10348.911	10815.947

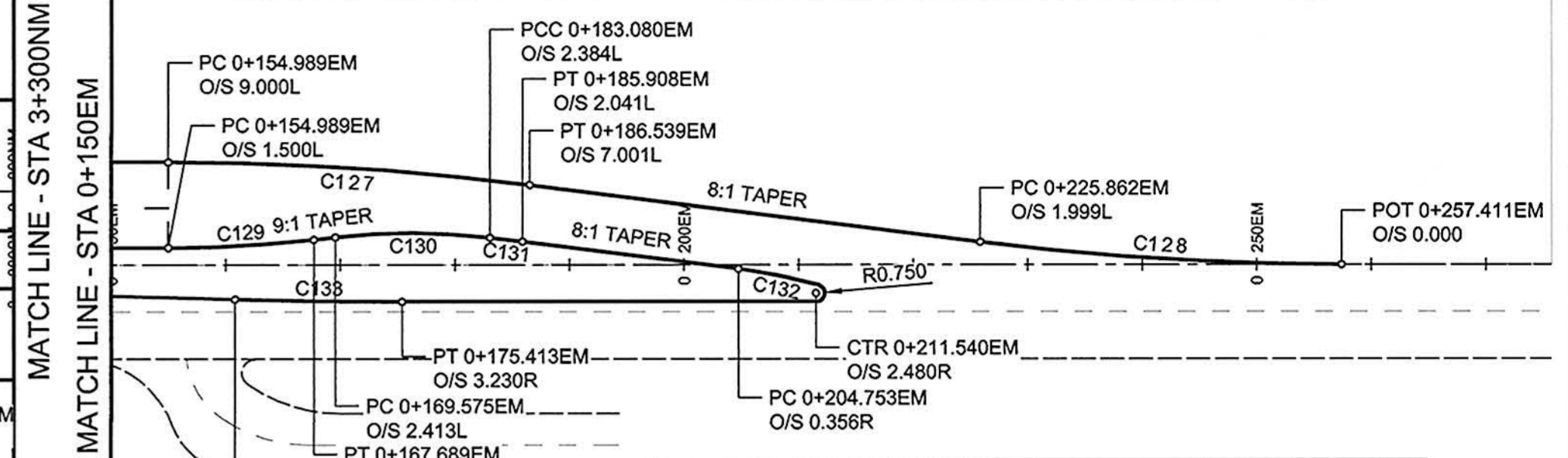

CIRCULAR CURVE DATA				
CURVE	LENGTH	RADIUS	DELTA	TANGENT
C127	31.634	250.000	7°15'00"	15.838
C128	31.634	250.000	7°15'00"	15.838
C129	12.726	115.000	6°20'25"	6.369
C130	13.534	60.000	12°55'27"	6.796
C131	2.848	245.000	0°39'58"	1.424
C132	7.131	50.000	8°10'16"	3.571
C133	14.587	500.000	1°40'18"	7.294

MATCH LINE - STA 3+300NM

MATCH LINE - STA 0+150EM