

**MOUNTABLE CURB (SEPARATE)**

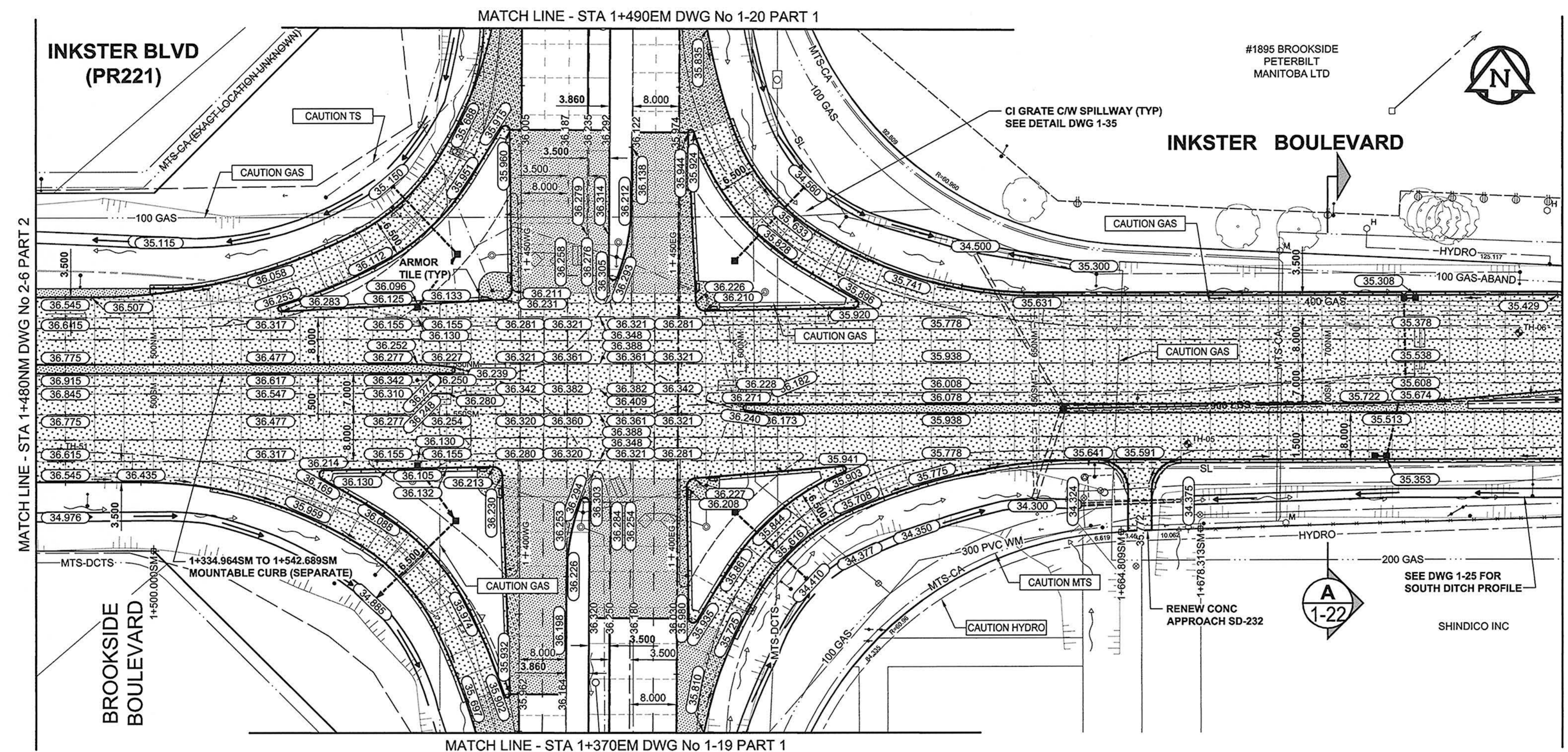

- NOTES**
- ADJUST EXST. MH AND CB RIMS TO NEW GRADES AS SHOWN.
  - LIGHT STANDARDS, HYDRO POLES, AND ANCHORS MAY REQUIRE TEMPORARY SUPPORT/REMOVAL OR REPLACEMENT AT THE EXPENSE OF THE CONTRACTOR. LIGHT STANDARD BASES TO BE PERMANENTLY REMOVED FROM SITE BY CONTRACTOR AT LOCATIONS INDICATED.
  - CONTRACTOR SHALL TAKE PRECAUTIONARY STEPS TO PROTECT EXISTING BOULEVARD TREES FROM DAMAGE RESULTING FROM CONSTRUCTION ACTIVITIES WITHIN THE LIMITS OF CONSTRUCTION AS OUTLINED IN THE SPECIFICATIONS.
  - ADD 200.000m TO ABBREVIATED ELEVATIONS TO OBTAIN GEODETIC ELEVATIONS.
  - CONTRACTOR SHALL TAKE PRECAUTIONARY STEPS TO CONTROL EROSION BY INSTALLING STRAW WATTLE AT LOCATIONS DIRECTED BY CONTRACT ADMINISTRATOR.

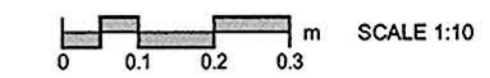
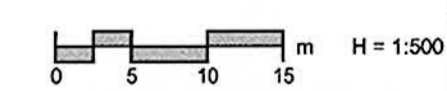

**AECOM**  
 Certificate of Authorization  
 AECOM Canada Ltd.  
 No. 4671 Date: April 19, 2010

BID OPPORTUNITY NO. 232-2010

**METRIC**  
 WHOLE NUMBERS INDICATE MILLIMETRES  
 DECIMALIZED NUMBERS INDICATE METRES

---	GAS	○	MANHOLE	●	CONCRETE PAVEMENT
---	MTS	□	CATCH BASIN / CATCH PIT	■	ASPHALT PAVEMENT
---	HYDRO	△	CURB INLET WITH BOX	▲	CONC. SIDEWALK/MEDIAN
---	CAT/W/O	○	TREE	○	PAVING STONE
---	TRAFFIC SIGNALS/PIT	⊕	TEST HOLE	⊕	GRAVEL
---	LAND DRAINAGE SEWER	⊕	PROPERTY LINE	---	RAMP CURB
---	SANITARY/COMBINED SEWER	⊕	SURVEY BAR	---	PLANING/REMOVAL
---	SSP/DCP	---	FENCE	---	
---	WATERMAIN	---	BOC/EOPAVT	---	
---	SUBDRAIN	---	ELEVATION	---	
---	DITCH	---	TRAFFIC SIGN	---	
---	EXISTING	---	LEGEND - PLAN	---	
---	NEW	---	LEGEND - PLAN	---	

**LOCATION APPROVED**  
 UNDERGROUND STRUCTURES

DATE COMMITTEE

**NOTE:**  
 LOCATION OF UNDERGROUND STRUCTURES AS SHOWN ARE BASED ON THE BEST INFORMATION AVAILABLE. BUT NO GUARANTEE IS GIVEN THAT ALL EXISTING UTILITIES ARE SHOWN OR THAT THE GIVEN LOCATIONS ARE EXACT. CONFIRMATION OF EXISTENCE AND EXACT LOCATION OF ALL SERVICES MUST BE OBTAINED FROM THE INDIVIDUAL UTILITIES BEFORE PROCEEDING WITH CONSTRUCTION.

BM REFER TO ELEV DWG 1-1

NO.	ISSUED FOR CONSTRUCTION	10/04/21	DID
NO.	REVISIONS	YYMM/DD	BY

**AECOM**

DESIGNED BY	WRJ/RPB	CHECKED BY	WRJ
DRAWN BY	DID/KLC	APPROVED BY	TGS
HOR. SCALE	1:500	RELEASED FOR CONSTRUCTION	
VERT. SCALE	1:20	DATE	April 19, 2010
DATE	10/04/21	DATE	April 19, 2010

PROFESSIONAL'S SEAL

PROVINCE OF MANITOBA REGISTERED PROFESSIONAL ENGINEER

R. P. BRUCE

CONSULTANT DRAWING NO. 0265-411-00\_04-CT1032\_RX.dwg

**THE CITY OF WINNIPEG**  
 PUBLIC WORKS DEPARTMENT  
 ENGINEERING DIVISION

**INKSTER BOULEVARD WIDENING PROJECT**  
 430m WEST OF OAK POINT HIGHWAY TO BROOKSIDE BOULEVARD  
 HORIZONTAL ALIGNMENT  
 BROOKSIDE BOULEVARD TO STA 1+740

CITY DRAWING NUMBER	P-3301-98
SHEET	66 OF 82
DRAWING No.	2-7
REV	0