

**SEWER JUNCTION INFORMATION
FOR SEWER ID MA60015662**

REFERENCE—METERS SOUTH OF MANHOLE MH60013382

DIST. FROM REF. MANHOLE	JUNCTION DIA.	CLOCK REF.	SERVICE TYPE	DESCRIPTION
9.3	150	02	CNI	-
10.7	150	10	CNI	-
11.8	150	03	CNI	W EM
26.7	150	02	CNI	-
27.1	150	10	CNI	LIVE

REFERENCE—METERS NORTH OF MANHOLE MH60013383

DIST. FROM REF. MANHOLE	JUNCTION DIA.	CLOCK REF.	SERVICE TYPE	DESCRIPTION
8.9	150	10	CNI	W RM
9.3	150	02	CNI	LIVE, W RF
24.4	150	02	CX	FRACTURED/CHIPPED
24.7	150	10	CX	FRACTURED

ALL JUNCTION INFORMATION
BASED ON CCTV INSPECTION

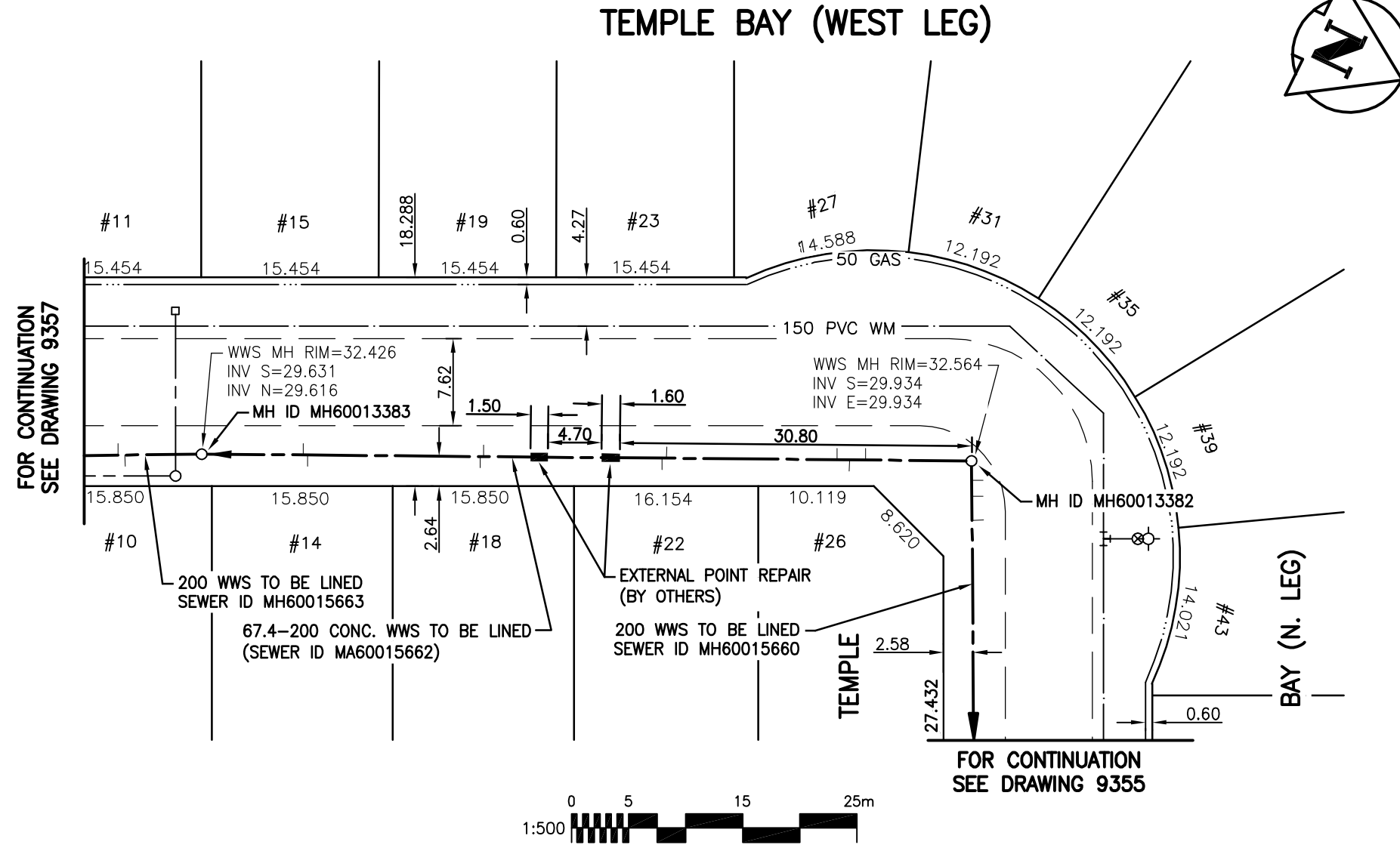

WARNING

IF POWER EQUIPMENT OR EXPLOSIVES ARE TO BE USED FOR EXCAVATION ON THIS PROJECT THE CONTRACTOR MUST:

- 1) NOTIFY THE GAS COMPANY OF THE PROPOSED LOCATION OF EXCAVATION.
- 2) TAKE PRECAUTION TO AVOID DAMAGE TO GAS COMPANY INSTALLATIONS.

SEE PROVINCIAL REGULATION 140/92 FOR DETAILS

METRIC

WHOLE NUMBERS INDICATE MILLIMETRES
DECIMALIZED NUMBERS INDICATE METRES

BENCH MARK: S. side Pasadena Ave. @ Temple Bay, Tblt. in E. Conc. foundation of No. 764 Pasadena Ave., 3.8 m S. & 0.2 m below stucco of N.E. Cor. of house.



Certificate of Authorization

Stantec Consulting Ltd.

No. 1301 Date: _____

BID OPPORTUNITY 245-2010

LOCATION APPROVED UNDERGROUND STRUCTURES

B.M. 77-13
ELEV. 233.155m

SUPV. U/G STRUCTURES COMMITTEE DATE

NOTE:
LOCATION OF UNDERGROUND STRUCTURES AS SHOWN ARE BASED ON THE BEST INFORMATION AVAILABLE BUT NO GUARANTEE IS GIVEN THAT ALL EXISTING UTILITIES ARE SHOWN OR THAT THE GIVEN LOCATIONS ARE EXACT. CONFIRMATION OF EXISTENCE AND EXACT LOCATION OF ALL SERVICES MUST BE OBTAINED FROM THE INDIVIDUAL UTILITIES BEFORE PROCEEDING WITH CONSTRUCTION.

NO.	REVISIONS	DATE	BY



Stantec Consulting Ltd.

905 Waverley Street, Winnipeg, Manitoba
Tel 204-489-5900 Fax 204-453-9012

DESIGNED BY	J.K.H.	CHECKED BY	W.A.B.
DRAWN BY	J.K.H.	APPROVED BY	C.L.D.
HOR. SCALE:	1:500	RELEASED FOR CONSTRUCTION:	
VERTICAL:	N/A		
NO.	REVISIONS	DATE	BY
		10.06.21	

ENGINEER'S SEAL



CONSULTANT DRAWING NO.
C-103



THE CITY OF WINNIPEG

WATER AND WASTE DEPARTMENT

**2010 SEWER RENEWALS
BY CIPP LINING - CONTRACT 14
TEMPLE BAY (WEST LEG)**

**1ST MH N. OF PASADENA AVE. TO
MH AT TEMPLE BAY (N. LEG)**

SHEET	OF
3	26
CAD FILE DRAWING NUMBER 12350c-103-735.dwg	
CITY DRAWING NUMBER 9356	